

STATE OF ILLINOIS  
DEPARTMENT OF TRANSPORTATION

F.A. PTE.	SECTION	COUNTY	TOTAL SHEETS	SHEET NO.
885	*	POPE	16	6
STA. 709+74.60		TO STA. 714+62.27		
FED. ROAD DIST. NO.	ILLINOIS	FED. AID PROJECT		

\* - D-9 BSMART FY 07-1

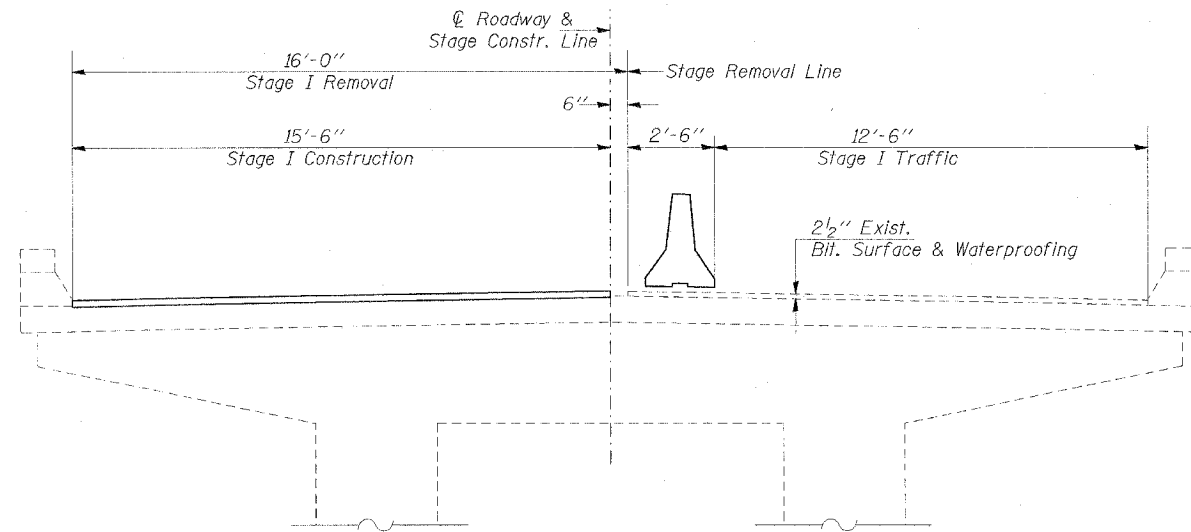

STAGE I

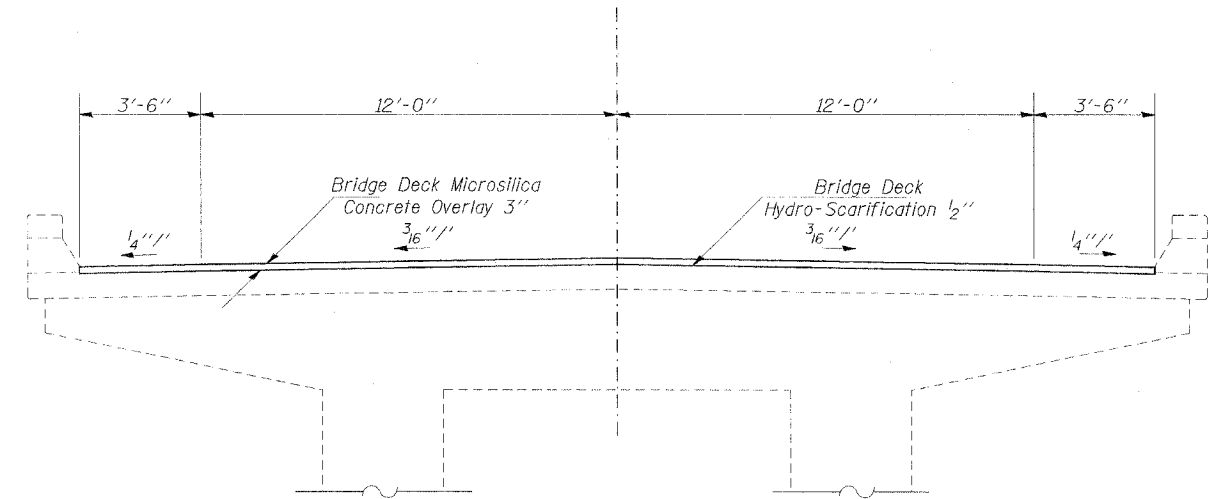

TYPICAL CROSS SECTION

(Proposed Cross Slope matches the Existing)

Notes: Cross sections are looking West

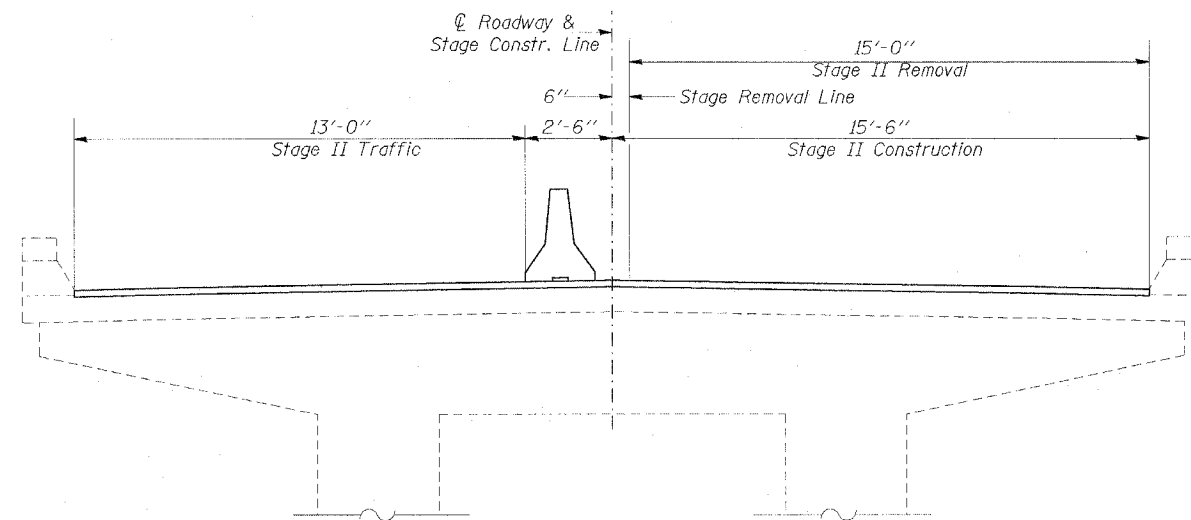

STAGE II

STAGE CONSTRUCTION  
DETAILS  
ILL 146 OVER HILLS BRANCH  
POPE COUNTY  
STA. 712+18.3  
SN 076-0007