

STATE OF ILLINOIS
DEPARTMENT OF TRANSPORTATION
DIVISION OF HIGHWAYS
PROPOSED
HIGHWAY PLANS

RECEIVED
 JUL 14 2017
 BUREAU OF
 DESIGN & ENVIRONMENT

F.A.P. RTE.	SECTION	COUNTY	TOTAL SHEETS	SHEET NO.
310	32(I)	WARREN	1	11
		ILLINOIS	CONTRACT NO. 68D91	

INDEX OF SHEETS:

- 1 COVER SHEET
- 2 COMMITMENTS, GENERAL NOTES, JOB SPECIFIC NOTES
- 3 SUMMARY OF QUANTITIES
- 4 LINE DIAGRAM
- 5 DIP AND PAVEMENT REPAIR DETAILS
- 6 SCHEDULE OF QUANTITIES
- 7 BRIDGE APPROACH PAVEMENT DETAIL
- 8-10 BUTT JOINTS
- 11 HOT MIX ASPHALT SURFACE REMOVAL (COLD MILLING)

HIGHWAY STANDARDS

701101-05 701411-09
 701400-09 701901-06
 701401-10

DISTRICT STANDARDS:

406101
 440001

DESIGN DESIGNATION:

OTHER ARTERIAL
 ADT: 4550 (2015)
 SU: 4.2 % (2015)
 MU: 12 % (2015)

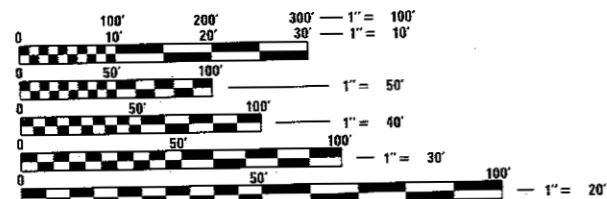

FULL SIZE PLANS HAVE BEEN PREPARED USING STANDARD ENGINEERING SCALES. REDUCED SIZED PLANS WILL NOT CONFORM TO STANDARD SCALES. IN MAKING MEASUREMENTS ON REDUCED PLANS, THE ABOVE SCALES MAY BE USED.

J.U.L.I.E.
 JOINT UTILITY LOCATION INFORMATION FOR EXCAVATION
 1-800-892-0123
 OR 811

PROJECT ENGINEER: MIKE LEWIS (309) 671-3454
 PROJECT MANAGER: SOBHI LABABIDI/RAYMOND SAMARA (309) 671-3460

CONTRACT NO. 68D91
 CATALOG NO. 035523-00D

FAP ROUTE 310 (US 67 & IL 110)
 SECTION 32(I)

TYPE of IMPROVEMENT: CONTRACT MAINTENANCE
 WARREN COUNTY

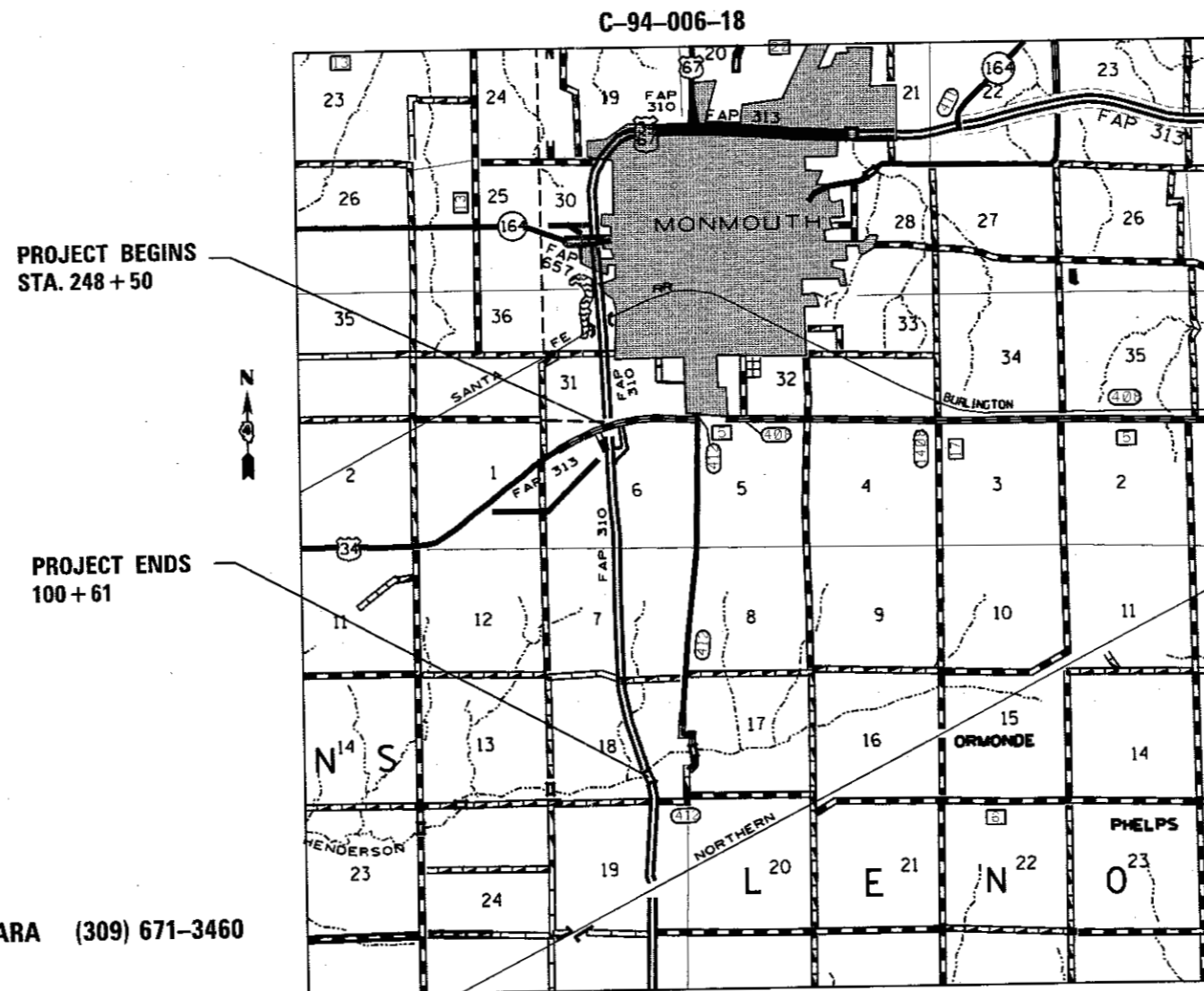

GROSS LENGTH = 14,789 FT. = 2.8 MILE
 NET LENGTH = 910 FT. = 0.17 MILE

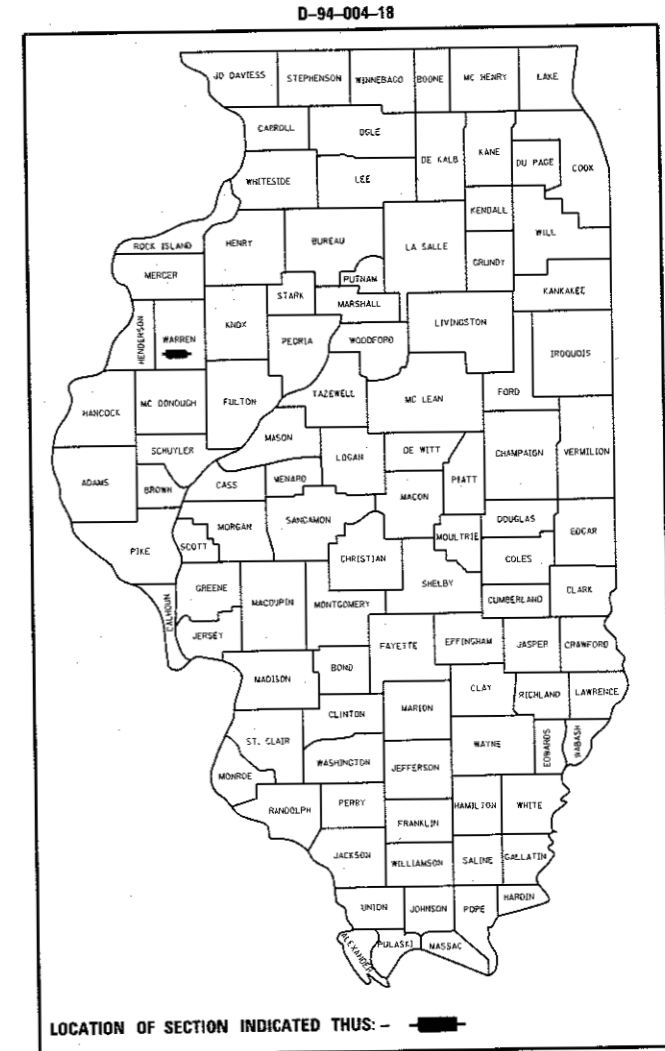

PROJECT DESCRIPTION:

PAVEMENT REPAIR ALONG US 67 AT TWO LOCATIONS:
 LOCATION 1: UNDER US 34 STRUCTURE
 LOCATION 2: AT THE SOUTH HENDERSON CREEK STRUCTURES IN MONMOUTH

STATE OF ILLINOIS
 DEPARTMENT OF TRANSPORTATION
 DIVISION OF HIGHWAYS

SUBMITTED July 10 2017
Paul C. James
 REGION THREE ENGINEER

Maureen M. Todd
 ENGINEER OF DESIGN AND ENVIRONMENT

Amel
 DIRECTOR OF PROGRAM DEVELOPMENT

**PRINTED BY THE AUTHORITY
 OF THE STATE OF ILLINOIS**

REV

COMMITMENTS

Commitments are not to be altered without the written approval of all parties to which the commitment was made.

NO COMMITMENT HAVE BEEN MADE FOR THIS PROJECT

ENVIRONMENTAL REVIEWS

Prior to the use of any proposed borrow areas, use areas (temporary access roads, detours, run-arounds, etc.) and/or waste areas, the Contractor shall file the required environmental resource request surveys according to Section 107.22 of the Standard Specifications. These surveys are required in order for the Department to conduct cultural and biological resource surveys for the proposed site.

Prior to any waste materials being removed from the construction site the required environmental resource surveys will need to be obtained and filed by the Contractor. Excess waste products removed from the construction site shall be disposed of as required in Section 202.03 of the Standard Specifications.

Any protruding metal bars shall be removed prior to the disposal of broken concrete at approved disposal sites.

The required environmental resource documentation shall include the following:

- * BDE Form 2289 (Environmental Survey Request)
- * BDE Form 2290 (Waste/Use Area Review)
- * A location map showing the size limits and location of the use area
- * Color photographs depicting the use area
- * Borrow Area Entry Agreement form-D4 PI0101

Please note that a minimum of four weeks shall be allowed for the District to obtain the required environmental clearances and six weeks for the required borrow site environmental clearances.

HOT-MIX ASPHALT MIXTURE REQUIREMENTS:

Mixture Use(s):	SURFACE MIX
AC/PG:	SBS OR SBR 76-28
Design Air Voids:	4.0% @ N=70
Mixture Composition: (Mixture Gradation)	IL 9.5
Friction Aggregate:	Mix D
Quality Management Program:	QC QA

Notes: Individual lift thickness of each mix type will be no less than 3 times nominal maximum aggregate size and no more than 6 times nominal aggregate size.

JOB SPECIFIC NOTES:

- 1- AT LOCATIONS WHERE THE DROP OFF BETWEEN THE TRAVELED LANES IS MORE THAN 2 INCHES; THE CONTRACTOR - PRIOR TO REOPENING LANES TO TRAFFIC - SHALL MILL THE EXPOSED EDGE AND AT 1:3 SLOPE RATE AS DIRECTED BY THE RESIDENT ENGINEER. THE ABOVE WORK SHALL BE INCLUDED IN THE BID PRICE FOR "HOT MIX ASPHALT SURFACE REMOVAL VARIABLE DEPTH"
- 2- AT LOCATIONS WHERE THE ROADWAY DIP IS MORE THAN 2 INCHES; THE CONTRACTOR SHALL PLACE AND COMPACT A SCRATCH PASS OF SURFACE MIX PRIOR TO PAVING AS DIRECTED BY THE RESIDENT ENGINEER. THIS WORK WILL BE PAID FOR AT THE CONTRACT UNIT PRICE PER TON FOR "POLYMERIZED HOT-MIX ASPHALT SURFACE COURSE, MIX D, N70"
- 3- IN ORDER TO ACHIEVE THE CORRECT ROADWAY PROFILE IN THE FIELD; THE LIMITS OF THE OVERLAY MAYBE EXTENDED OR SHORTENED AS DIRECTED BY THE RESIDENT ENGINEER
- 4- FOR BOTH MILLING AND PLACING HMA AT EACH LOCATION; AN AUTOMATED ELECTRONIC GRADE CONTROL SHALL BE OPERATED FROM A PRESENT GRADE CONTROL STRINGLINE. THE CONTRACTOR WILL ALLOW TIME AFTER THE SET UP OF THE TRAFFIC CONTROL TO ALLOW THE RESIDENT ENGINEER TO SURVEY THE EXISTING ROADWAY AND ESTABLISH THE PROFILE GRADE
- 5- THE RESIDENT ENGINEER SHALL NOTIFY THE TRAFFIC OPERATION ENGINEER ANNA GHIDINA AT 309-671-4477 WHEN THE JOB IS COMPLETED TO PROVIDE HER WITH THE FINAL LIMITS OF THE OVERLAY.

CODE NO.	ITEM	UNIT	TOTAL QUANTITY	CONST. CODE
				WARREN COUNTY 100 % STATE 0005 ✓
40600295	POLYMERIZED BITUMINOUS MATERIALS (TACK COAT)	POUND	2787	2787
40600982	HOT - MIX ASPHALT SURFACE REMOVAL - BUTT JOINT	SQ YD	338	338
40600985	PORTLAND CEMENT CONCRETE SURFACE REMOVAL - BUTT JOINT	SQ YD	533	533
40600990	TEMPORARY RAMP	SQ YD	356	356
40603540	POLYMERIZED HOT - MIX ASPHALT SURFACE COURSE, MIX "D", N70	TON	349	349
44000155	HOT - MIX ASPHALT SURFACE REMOVAL, 1 1/2"	SQ YD	956	956
60260100	INLETS TO BE ADJUSTED	EACH	3	3
67100100	MOBILIZATION	L SUM	1	1
70100420	TRAFFIC CONTROL AND PROTECTION, STANDARD 701411	EACH	1	1
70100800	TRAFFIC CONTROL AND PROTECTION, STANDARD 701401	L SUM	1	1
78300200	RAISED REFLECTIVE PAVEMENT MARKER REMOVAL	EACH	10	10
X4401198	HOT-MIX ASPHALT SURFACE REMOVAL, VARIABLE DEPTH	SQ YD	2044	2044
X7015005	CHANGEABLE MESSAGE SIGN	CAL DA	14	14

URBAN

15

FILE NAME =	USER NAME = labobidjan	DESIGNED -	REVISED -
S:\DEN\DRFT\ST0&PLNS\SQUAD 8\US 67	Pavement Jacking 2017\68091 Revised plans 7.7	20170707	20170707
	PLOT SCALE = 400.0000 / in.	CHECKED -	REVISED -
	PLOT DATE = 7/8/2017	DATE -	REVISED -

STATE OF ILLINOIS
DEPARTMENT OF TRANSPORTATION

SUMMARY OF QUANTITIES

F.A. RTE.	SECTION	COUNTY	TOTAL SHEETS	SHEET NO.
310	32(1)	WARREN	11	3
			CONTRACT NO. 68091	
ILLINOIS FED. AID PROJECT				

REV

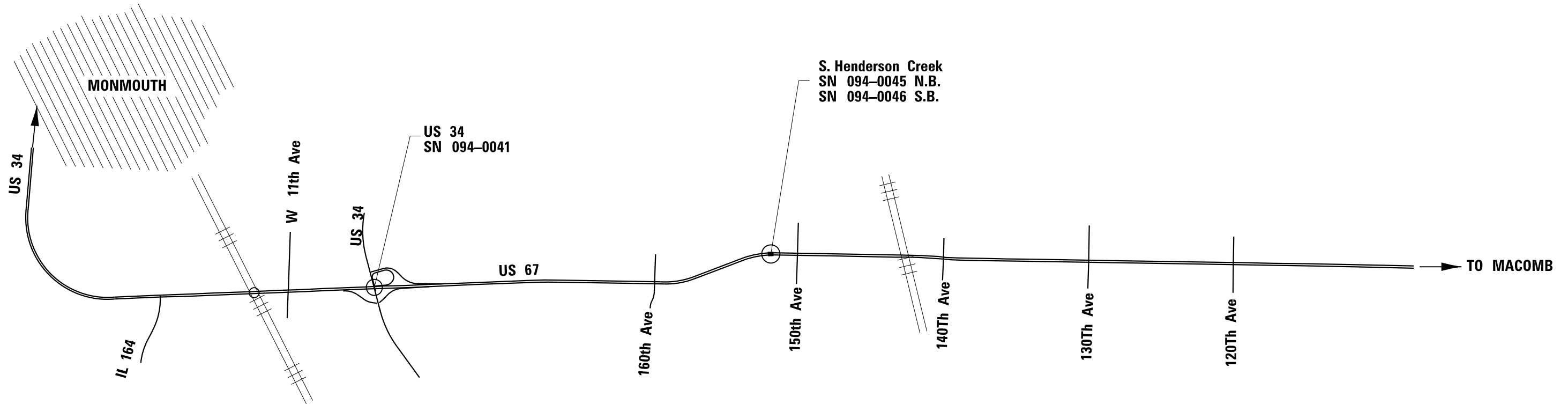

DISTANCE BETWEEN STRUCTURES IN MILES (FOR INFORMATION ONLY)	
CROSSING NAME	DISTANCE
	MILES
PAVEMENT REPAIR UNDER US 34 STRUCTURE	
S. HENDERSON CREEK	2.80

NOT TO SCALE

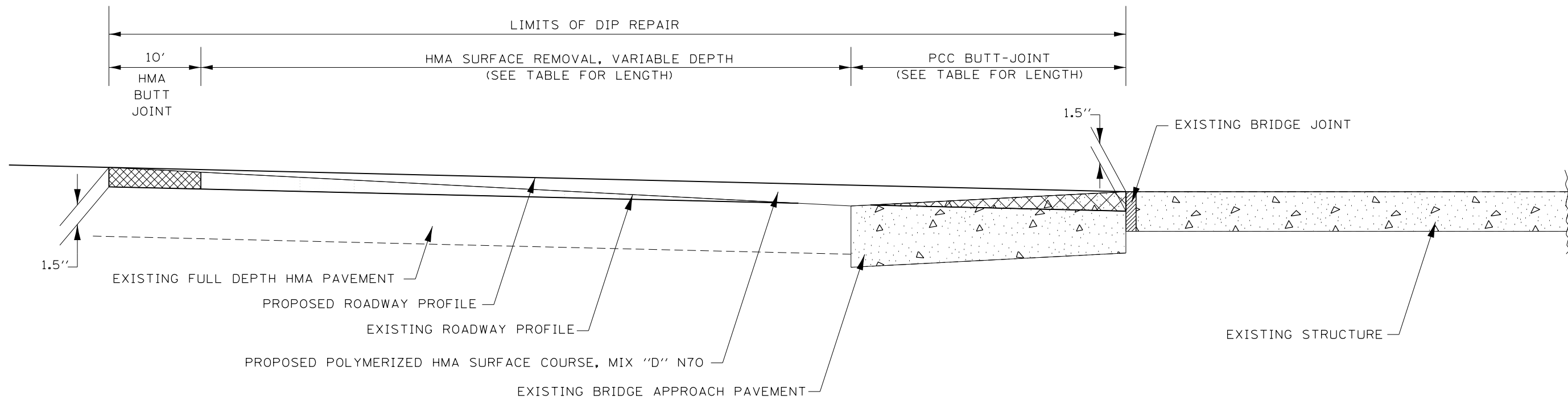

DIP REPAIR ADJACENT TO STRUCTURES

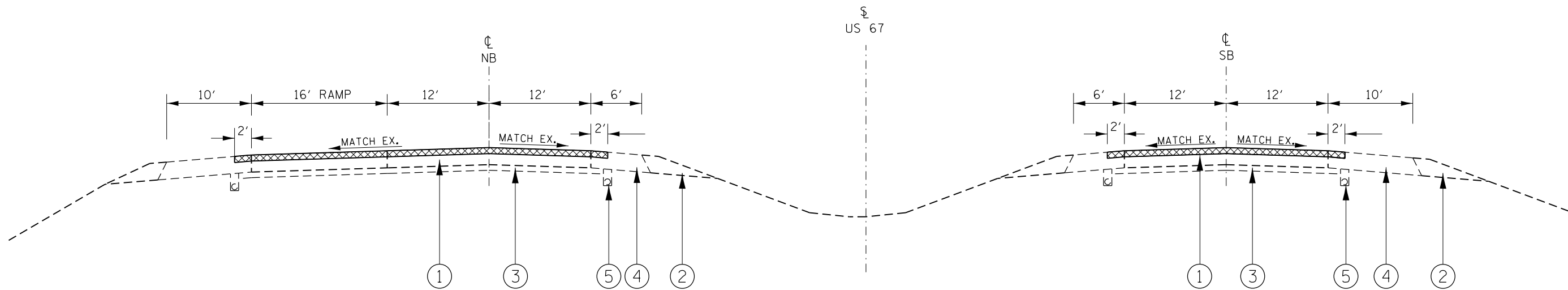

- ① EXISTING FULL DEPTH HMA PAVEMENT
- ② EXISTING AGGREGATE SHOULDER
- ③ EXISTING LIME MODIFIED SUB GRADE
- ④ EXISTING HMA SHOULDER
- ⑤ EXISTING SUB-SURFACE DRAINS

PROPOSED HMA SURFACE REMOVAL 1.5"//
 PROPOSED POLYMERIZED HMA SURFACE COURSE, MIX "D" N70

PAVEMENT REPAIR UNDER US 34 STRUCTURE

NOT TO SCALE

FILE NAME =	USER NAME = lababidism	DESIGNED -	REVISED -
S:\GEN\DRAW\STD&PLNS\SQUAD 0\US 67 Pavement Jacking 2017\68D91.Revised plans 7.7.2017\Rev...line.....dgn		CHECKED -	REVISED -
Default	PLOT DATE = 7/7/2017	DATE -	REVISED -

**STATE OF ILLINOIS
DEPARTMENT OF TRANSPORTATION**

DIP AND PAVEMENT REPAIR DETAILS

NOT TO SCALE SHEET OF SHEETS STA. TO STA.

F.A.P. RTE.	SECTION	COUNTY	TOTAL SHEETS	SHEET NO.
310	32(1)	WARREN	11	5
CONTRACT NO. 68D91				
ILLINOIS FED. AID PROJECT				

HMA RESURFACING QUANTITIES

LOCATION	NBL / SBL	S.N.	APPROACH / DEPARTURE	STA.	TO	STA.	LENGTH	WIDTH	PORTLAND CEMENT CONCRETE SURFACE REMOVAL BUTT JOINT	HOT-MIX ASPHALT SURFACE REMOVAL, VARIABLE DEPTH	HOT-MIX ASPHALT SURFACE REMOVAL BUTT JOINT	POLYMERIZED BITUMINOUS MATERIALS (TACK COAT)***	TEMPORARY RAMP	HOT-MIX ASPHALT SURFACE REMOVAL 1.5"	AVERAGE DEPTH USED) FOR INFORMATION ONLY)	POLYMERIZED HOT-MIX ASPHALT SURFACE COURSE, MIX "D" N70
							FT	FT	SQ YD	SQ YD	SQ YD	POUND	SQ YD	SQ YD	IN	TON
MILL & OVERLAY UNDER US 34 STRUCTURE 094-0041	SBL			STA. 248 + 50	TO	STA. 248 + 60	10	28			31.11	22.4	26.67		1.5	2.61
				STA. 248 + 60	TO	STA. 250 + 10	150					336	466.67	1.5	39.20	
				STA. 250 + 10	TO	STA. 250 + 20	10				31.11	22.4	26.67	1.5	2.61	
	NBL			STA. 248 + 90	TO	STA. 249 + 00	10	44			48.89	35.2	44.44		1.5	4.11
				STA. 249 + 00	TO	STA. 250 + 00	100					352	488.89	1.5	41.07	
		STA. 250 + 00	TO	STA. 250 + 10	10			48.89	35.2	44.44		1.5	4.11			
DIP REPAIR AT S. HENDERSON CREEK STRUCTURE	NBL	094-0045	Approach	STA. 100 + 61	TO	STA. 100 + 71	10	40			44.44	32	26.67		1.5	3.73
				STA. 100 + 71		TO	STA. 102 + 11		140		622.22	448		1.7	59.24	
				STA. 102 + 11		TO	STA. 102 + 41		30	133.33		96	26.67	2.5	18.67	
			Departure	STA. 103 + 82	TO	STA. 104 + 12	30	40	133.33		96	26.67	1.6	11.95		
				STA. 104 + 12		TO	STA. 105 + 52		140		622.22	448		1.5	52.27	
				STA. 105 + 52		TO	STA. 105 + 62		10			44.44	32	26.67	1.5	3.73
	SBL	094-0046	Approach	STA. 103 + 82	TO	STA. 104 + 12	30	40	133.33		96	26.67	2.7	20.16		
				STA. 104 + 12		TO	STA. 105 + 02		90		400.00	288		1.5	33.60	
				STA. 105 + 02		TO	STA. 105 + 12		10			44.44	32	26.67	1.5	3.73
			Departure	STA. 101 + 08	TO	STA. 101 + 18	10	40			44.44	32	26.67		1.5	3.73
				STA. 101 + 18		TO	STA. 102 + 08		90		400.00	288		1.5	33.60	
				STA. 102 + 08		TO	STA. 102 + 38		30	133.33		96	26.67	1.5	11.2	
GRAND TOTAL									533	2,044	338	2,787	356	956	30	349

*** RESIDUAL PRIME COAT RATE USED 0.08 LB/SQ FT

STA.	MOBILIZATION
	L SUM
JOB SITE	1
TOTAL	1

STA.	TRAFFIC CONTROL AND PROTECTION, STANDARD 701411
	EACH
JOB SITE	1
TOTAL	1

STA.	RAISED REFLECTIVE PAVEMENT MARKER REMOVAL
	EACH
JOB SITE	10
TOTAL	10

STA.	TRAFFIC CONTROL AND PROTECTION, STANDARD 701401
	L SUM
JOB SITE	1
TOTAL	1

STA.	CHANGEABLE MESSAGE SIGN
	CAL DAY
USE 2 7 DAYS EACH	14
TOTAL	14

STA.	INLETS TO BE ADJUSTED
	EACH
JOB SITE	3
TOTAL	3

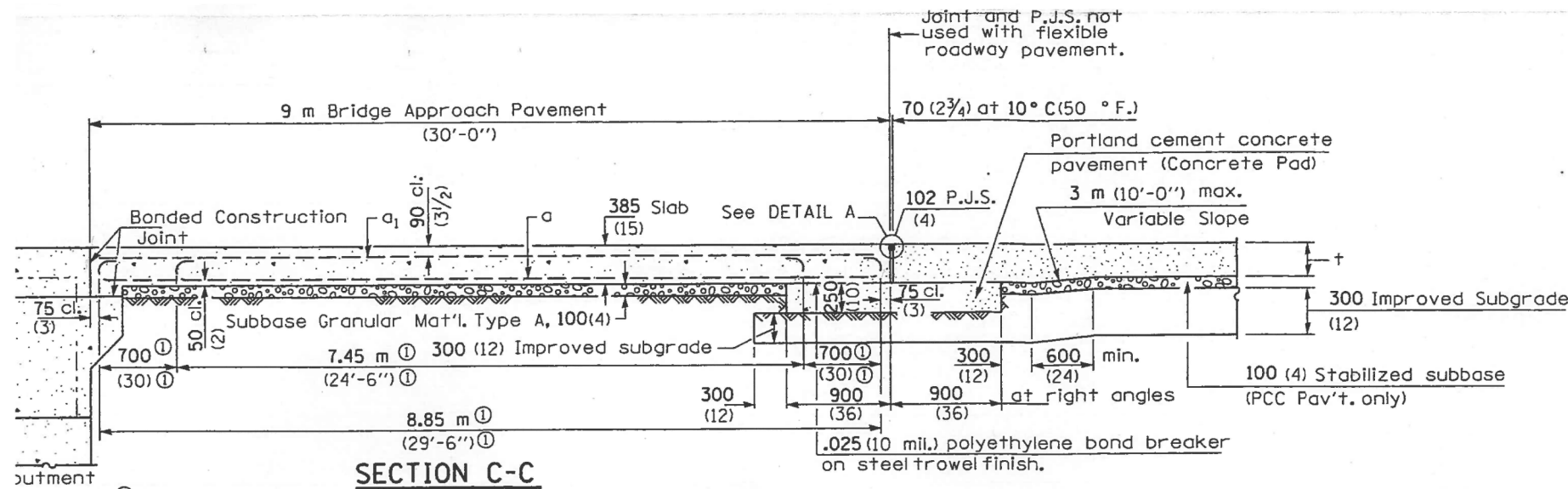

① Stagger No. 30 (No. 9) a bars as shown on plan - full width

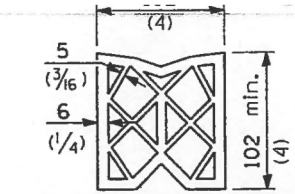

PREFORMED JOINT SEAL

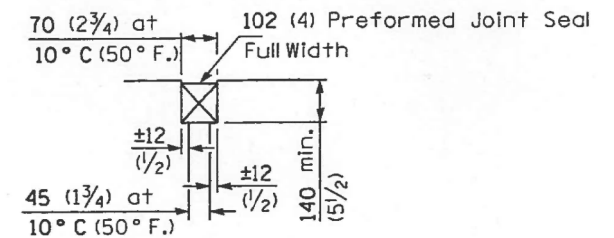

DETAIL A

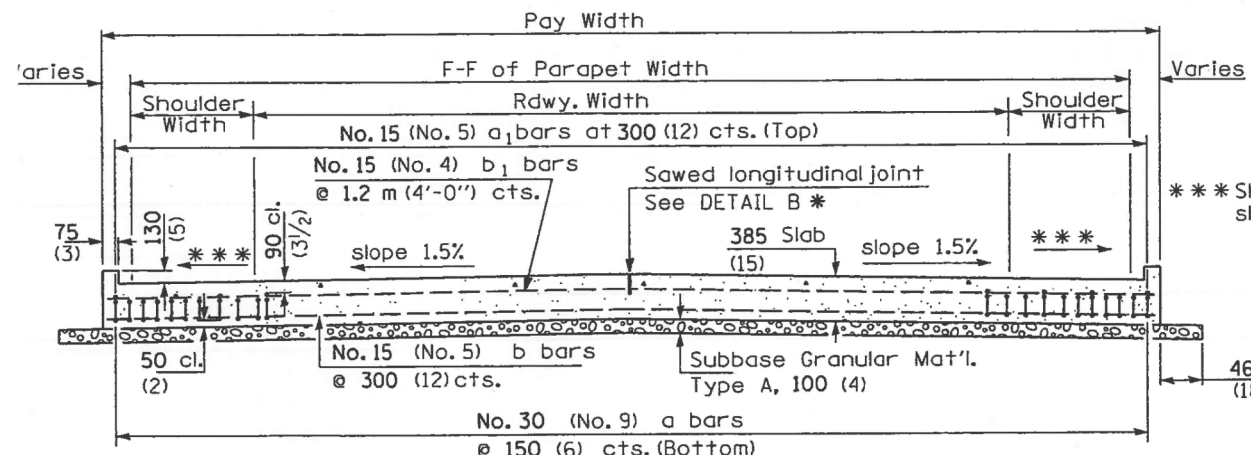

SECTION D-D
(See Plan for Dimensions not shown)
All reinforcement bars shall be epoxy coated.

Longitudinal Construction Joint in accordance with details shown on Standard 420001.

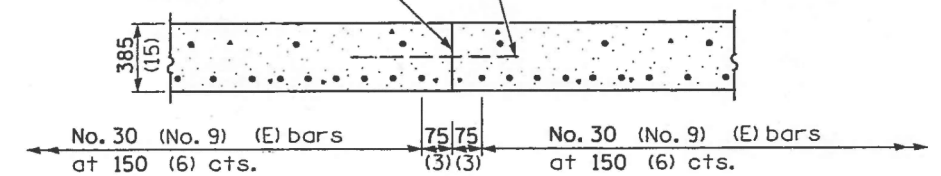

OPTIONAL LONGITUDINAL CONSTRUCTION JOINT

As approved by the Engineer, the Contractor may elect to reduce the widths of pour by use of the Optional Longitudinal Construction Joint shown. Joints shall be located at the edge of a traffic lane.

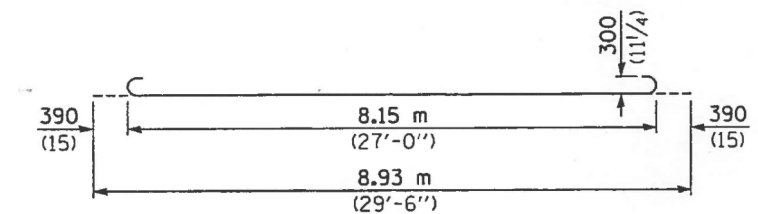

BAR a

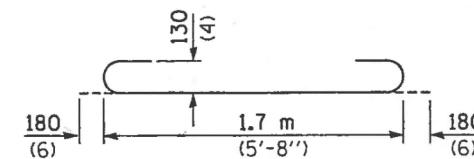

BAR a2

All dimensions are in millimeters (inches) unless otherwise shown.

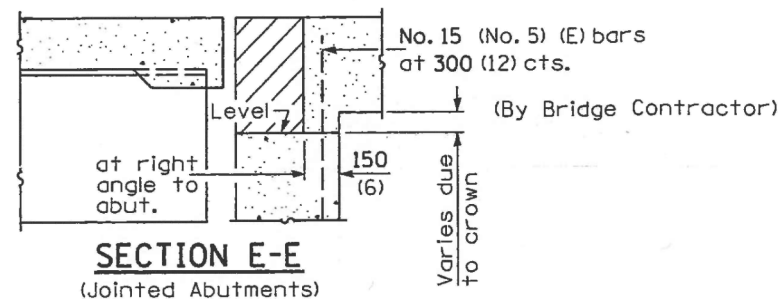
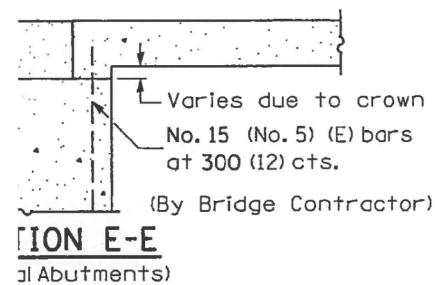

DESIGN STRESSES
 $f_y = 400 \text{ MPa (60,000 p.s.i.)}$
 $f'_c = 24 \text{ MPa (3,500 p.s.i.)}$
 $n = 8$

FILE NAME =	USER NAME = lababidism	DESIGNED -	REVISED -	STATE OF ILLINOIS DEPARTMENT OF TRANSPORTATION	BRIDGE APPROACH PAVEMENT DETAIL (FOR INFORMATION ONLY)	F.A.P. R.T.E.	SECTION	COUNTY	TOTAL SHEETS	SHEET NO.
S:\GEN\DRAW\STD&PLNS\SQUAD 8\US 67 Pavement Jacking 2017\68D91 Revised plans 7.7.2017\Drawn\line.....dgn	2017.07.07	CHECKED -	REVISED -			310	32(1)	WARREN	11	7
Default	PLOT SCALE = 400.0000 / in.	DATE -	REVISED -			CONTRACT NO. 68D91				
	PLOT DATE = 7/7/2017					ILLINOIS FED. AID PROJECT				

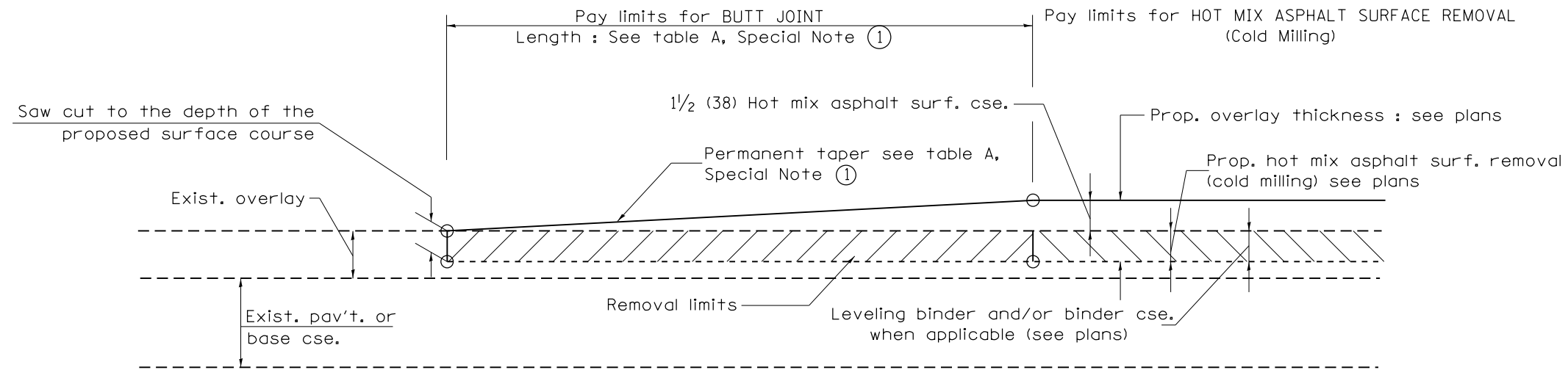

CASE 1 : WITH HOT MIX ASPHALT SURFACE REMOVAL (COLD MILLING)

**TABLE A
TAPER RATES**

SPECIAL NOTE NUMBER	ELEMENT	MAINLINE INTERSTATES & 4-LANE EXPRESSWAYS	ALL OTHERS
①	BUTT JOINT TAPER RATE	1:480	1:240
②	TEMPORARY RAMP TAPER RATE	1:80	1:40

GENERAL NOTES

1. The work shall be done in accordance with Article 406.08 and the Special Provision for Butt Joints.
2. The pavement surface to be removed may be either bituminous or P.C. concrete. The work shall be performed in accordance with Article 440.04 and the Special Provisions for Butt Joints.
3. The saw cut joints shall be primed just prior to the placing of bituminous material. The work will be in accordance with the applicable portions of Article 406.05.
4. The length of butt joint is based on the taper rate times change in cold milling depth within the butt joint pay limits, unless otherwise indicated.

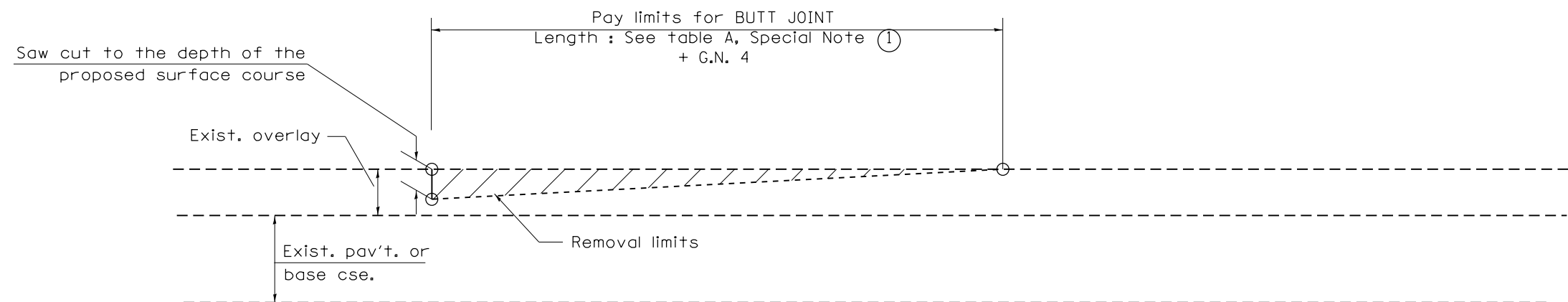

CASE 2 : NO HOT MIX ASPHALT SURFACE REMOVAL (COLD MILLING)

All dimensions are in inches (millimeters) unless otherwise noted.

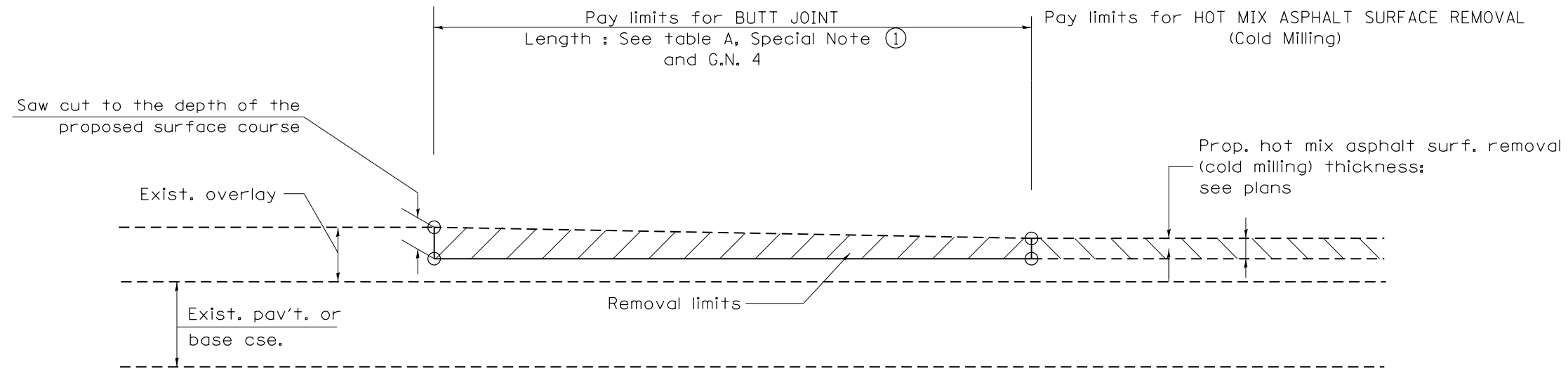

CASE 3 : HOT MIX ASPHALT SURFACE REMOVAL (COLD MILLING)
TIE-IN TO EXISTING BITUMINOUS TAPER

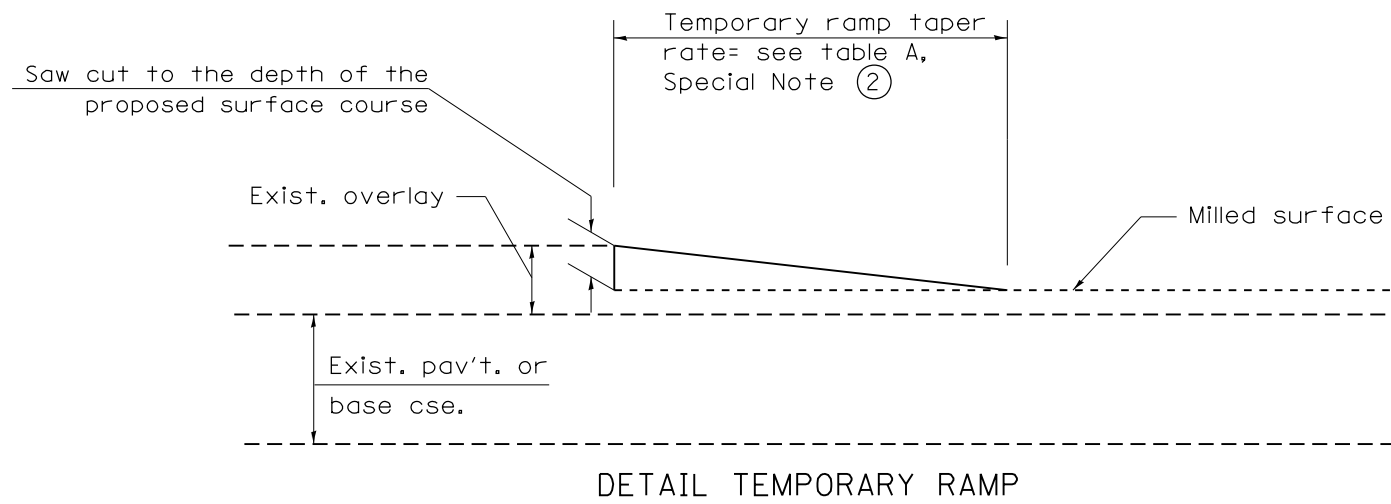

All dimensions are in inches (millimeters) unless otherwise noted.

				STATE OF ILLINOIS DEPARTMENT OF TRANSPORTATION		BUTT JOINTS		SHT. 2 OF 3 CADD STD. 406101-D4	
F.A.P. RTE.	SECTION	COUNTY	TOTAL SHEETS	SHEET NO.					
310	32(1)	WARREN	11	9					
				CONTRACT NO. 68D91					
FED. ROAD DIST. NO.		ILLINOIS FED. AID PROJECT							

NOT TO SCALE

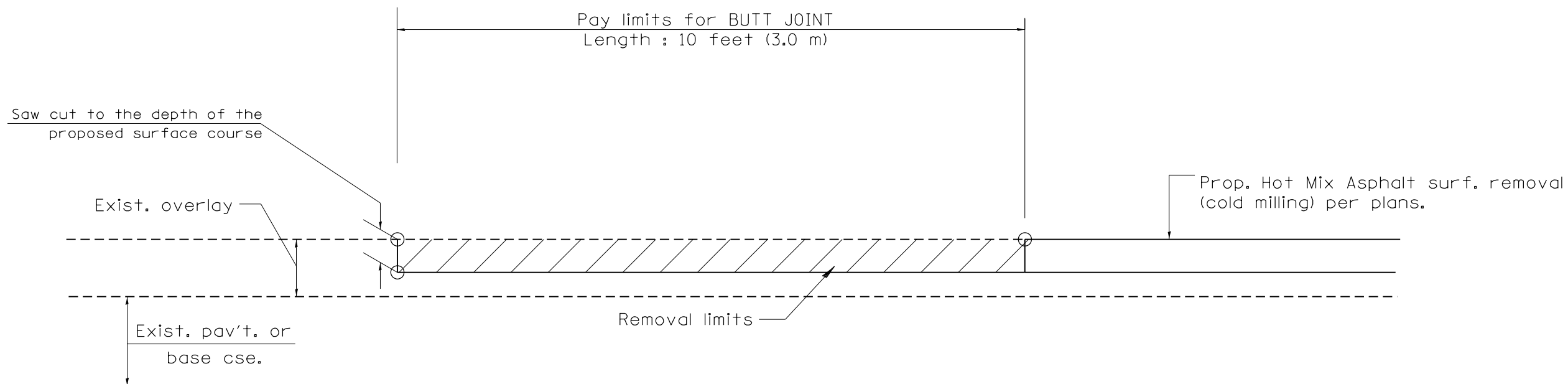

CASE 4 : SINGLE LIFT OVERLAY WITH EQUIVALENT DEPTH
HOT MIX ASPHALT SURFACE REMOVAL (COLD MILLING)
TIE-IN TO EXISTING BITUMINOUS TAPER

All dimensions are in inches (millimeters) unless otherwise noted.

				STATE OF ILLINOIS DEPARTMENT OF TRANSPORTATION		BUTT JOINTS		SHT. 3 OF 3 CADD STD. 406101-D4		<table border="1"> <tr> <th>F.A.P. RTE.</th> <th>SECTION</th> <th>COUNTY</th> <th>TOTAL SHEETS</th> <th>SHEET NO.</th> </tr> <tr> <td>310</td> <td>32(1)</td> <td>WARREN</td> <td>11</td> <td>10</td> </tr> <tr> <td colspan="3">FED. ROAD DIST. NO.</td> <td colspan="2">ILLINOIS FED. AID PROJECT</td> </tr> </table>		F.A.P. RTE.	SECTION	COUNTY	TOTAL SHEETS	SHEET NO.	310	32(1)	WARREN	11	10	FED. ROAD DIST. NO.			ILLINOIS FED. AID PROJECT	
F.A.P. RTE.	SECTION	COUNTY	TOTAL SHEETS	SHEET NO.																						
310	32(1)	WARREN	11	10																						
FED. ROAD DIST. NO.			ILLINOIS FED. AID PROJECT																							
						NOT TO SCALE				CONTRACT NO. 68D91																

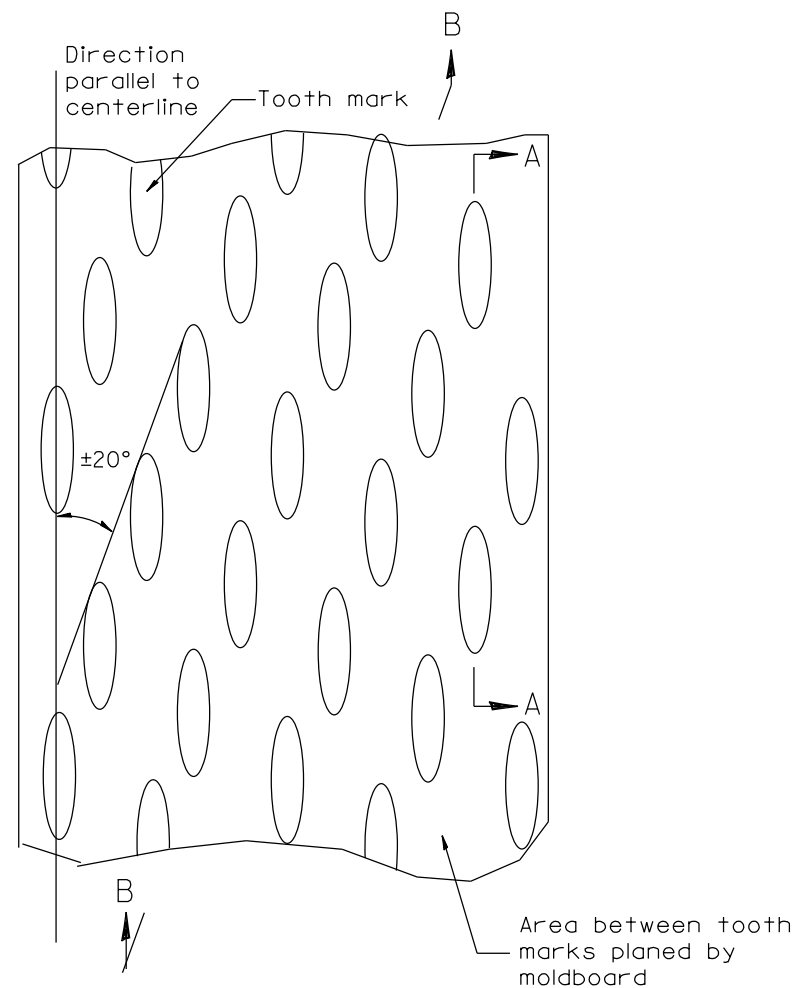

PLAN

General notes:

1. Coldmilling shall consist of two processes: Cutting with carbide teeth mounted on a rotating drum, and planing with a moldboard mounted immediately behind the cutting drum.
2. Other similar patterns will be acceptable if they consist of a smooth, flat, planed surface interspersed with a pattern of discontinuous longitudinal striations.

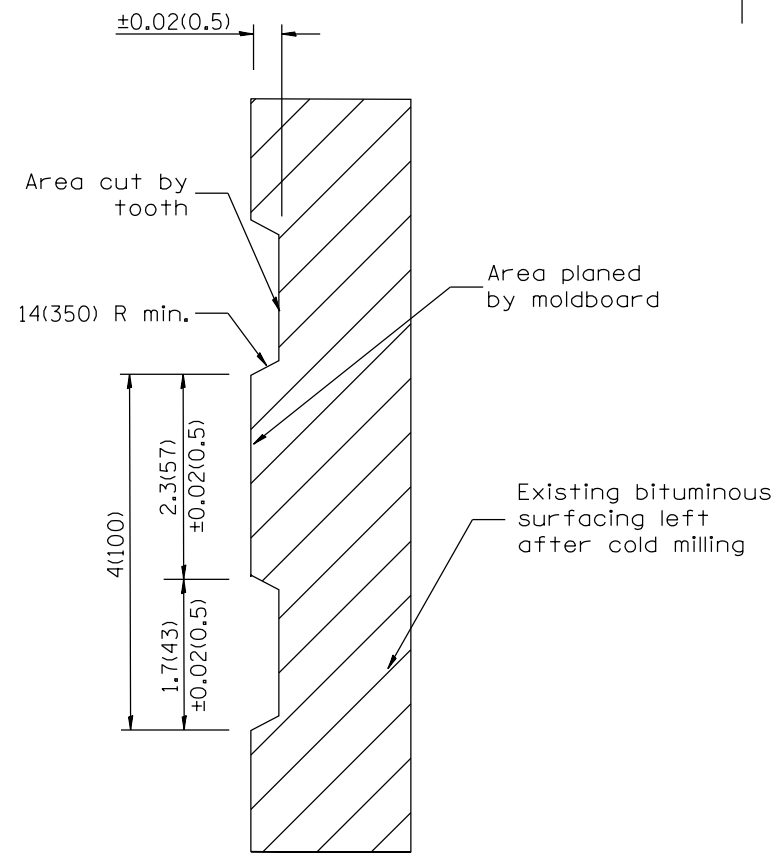

SECTION A-A

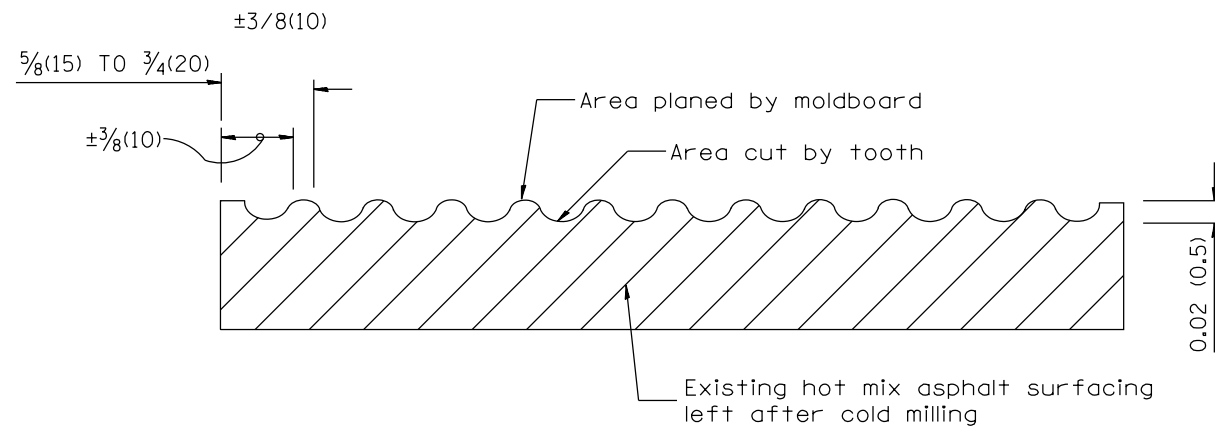

SECTION B-B PROJECTED
PERPENDICULAR TO CENTERLINE

All dimensions are in inches (millimeters) unless otherwise noted.

DESIGNER NOTES:
1. INCLUDE DISTRICT SPECIAL PROVISION, IF APPLICABLE.

01-01-97	RENUM. C-104.01, NEW REVISION BOX	T.P.
04-20-98	REMOVED MILLING DETAIL FROM STANDARD	J.A.
09-08-98	CORRECT NOTE LEADER PLACEMENT	R.W.
10-16-06	REVISED TO 2007 SPEC.	M.A.

STATE OF ILLINOIS
DEPARTMENT OF TRANSPORTATION

HOT MIX ASPHALT SURFACE REMOVAL (COLD MILLING)

NOT TO SCALE

CADD STD. 440001-D4

F.A.P. RTE.	SECTION	COUNTY	TOTAL SHEETS	SHEET NO.
310	32(1)	WARREN	11	11
FED. ROAD DIST. NO. ILLINOIS FED. AID PROJECT			CONTRACT NO. 68D91	