

STATE OF ILLINOIS  
DEPARTMENT OF TRANSPORTATION

F.A.P. RTE.	SECTION	COUNTY	TOTAL SHEETS	SHEET NO.
592	121-1RS-3	ST. CLAIR	13	1
		ILLINOIS	CONTRACT NO. 76K52	

FOR INDEX OF SHEETS, SEE SHEET NO. 2

**PROPOSED  
HIGHWAY PLANS**

FAP ROUTE 592 (IL 157 /IL 013)  
SECTION 121-1RS-3  
RESURFACING  
ST. CLAIR COUNTY

C-98-043-17



PROJECT BEGINS  
AT STA 424+25.00  
LAT.: 38.55920  
LONG.: -90.10017

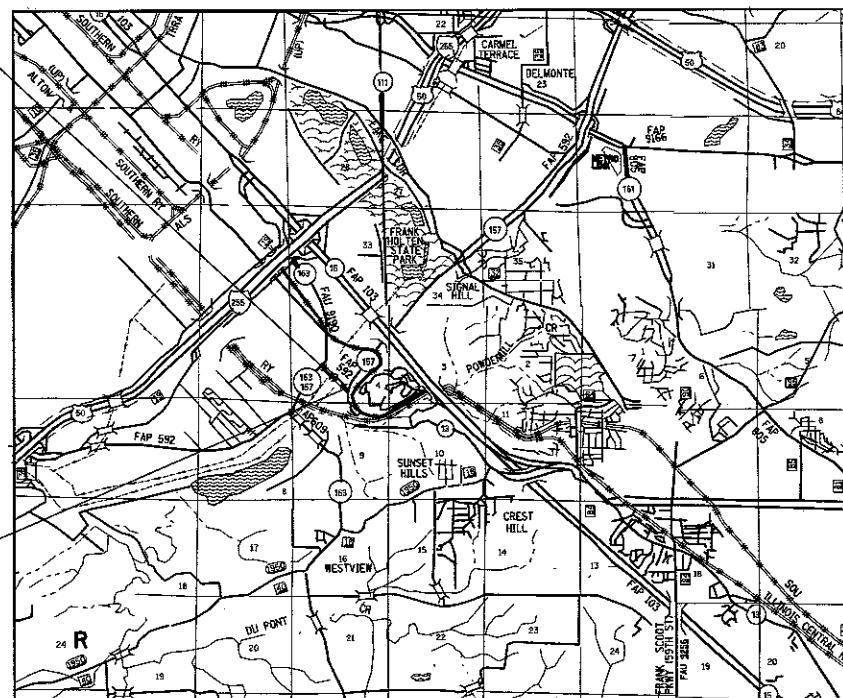

PROJECT ENDS  
AT STA 431+00.00  
LAT.: 38.56047  
LONG.: -90.10217

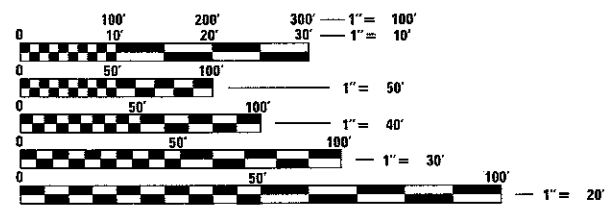

FULL SIZE PLANS HAVE BEEN PREPARED USING STANDARD ENGINEERING SCALES. REDUCED SIZED PLANS WILL NOT CONFORM TO STANDARD SCALES. IN MAKING MEASUREMENTS ON REDUCED PLANS, THE ABOVE SCALES MAY BE USED.

J.U.L.I.E.  
JOINT UTILITY LOCATION INFORMATION FOR EXCAVATION  
1-800-892-0123  
OR 811

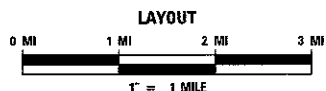

GROSS LENGTH = 675 FT. = 0.128 MILE  
NET LENGTH = 675 FT. = 0.128 MILE

TRAFFIC DATA  
ADT: 6800 (2018)  
7800 (2038)  
SU: 3.4%  
MU: 1.5%

STATE OF ILLINOIS  
DEPARTMENT OF TRANSPORTATION

SUBMITTED *July 3 20 17*  
*Jeffrey E. Kan*  
REGIONAL ENGINEER

*Aug 18 20 17*  
*Maxwell M. Addis*  
ENGINEER OF DESIGN AND ENVIRONMENT

*Aug 18 20 17*  
*Maxwell M. Addis*  
DIRECTOR OF PROGRAM DEVELOPMENT

PROJECT ENGINEER: HERVE GELIN (618) 346-3179  
PROJECT MANAGER: CECIL DOWNING (618) 346-3186

CONTRACT NO. 76K52

PRINTED BY THE AUTHORITY  
OF THE STATE OF ILLINOIS

**GENERAL NOTES**

**INDEX OF SHEETS**

1. COVER PAGE
2. INDEX OF SHEETS/HIGHWAY STANDARDS/GENERAL NOTES
3. COMMITMENTS/LOCATION MAP
4. SUMMARY OF QUANTITIES
5. TYPICAL SECTIONS
6. SCHEDULE OF QUANTITIES
7. TIE POINTS & BUTT-JOINT DETAILS
8. PLAN AND PROFILE SHEETS
9. PAVEMENT MARKING DETAILS
- 10.-13. CROSS SECTIONS

1. THE STANDARDS AND REVISION NUMBERS SHALL APPLY TO THIS PROJECT.
2. THE CONTRACTOR SHALL VERIFY ALL DIMENSIONS AND CONDITIONS IN THE FIELD PRIOR TO CONSTRUCTION AND ORDERING MATERIALS.
3. THE THICKNESS OF THE HMA MIXTURES SHOWN ON THE PLANS IS THE NORMAL THICKNESS. DEVIATIONS MAY OCCUR DUE TO IRREGULARITIES IN THE EXISTING SURFACE OR BASE ON WHICH THE HMA MIXTURE IS PLACED.
4. ILLINOIS STATE LAW REQUIRES A 48-HOUR NOTICE BE GIVEN TO ALL UTILITIES WITHIN THE PROJECT AREA BEFORE DIGGING. FIELD MARKING OF FACILITIES MAY BE OBTAINED BY CONTACTING J.U.L.I.E. OR FOR NON-MEMBERS, THE UTILITY COMPANY DIRECTLY. AGENCIES KNOWN TO HAVE FACILITIES WITHIN THE PROJECT AREA ARE AS FOLLOWS:

UTILITY	ABOVE GROUND	BELOW GROUND
*AMEREN ILLINOIS	X	X
*AT&T ILLINOIS	X	X
*CITY OF CENTREVILLE	X	X
*CHARTER COMMUNICATIONS, INC.	X	X
*COMMONFIELDS OF CAHOKA PUBLIC WATER DISTRICT		X

MEMBERS OF J.U.L.I.E. CALL TOLL FREE (800) 892-0123 OR 811 AND ARE INDICATED BY \* . NON-J.U.L.I.E. MEMBERS MUST BE NOTIFIED INDIVIDUALLY.

9. NO OVERNIGHT LANE CLOSURES ALLOWED.
10. THE CONTRACTOR SHALL PROVIDE POSITIVE AND ADEQUATE DRAINAGE AT ALL TIMES.
11. SHORT TERM PAVEMENT MARKING SHALL BE APPLIED TO MILLED, PRIMED, LB, AND FINAL SURFACE. ONLY REMOVAL FROM FINAL SURFACE PAID AS WORK ZONE PAVEMENT MARKING REMOVAL.

**HIGHWAY STANDARDS**

- 000001-06
- 001006
- 482001-02
- 482011-03
- 630001-11
- 630301-07
- 701201-04
- 701306-03
- 701901-06
- 780001-05
- 781001-04
- 701901-06

5. ALL TURF AREAS DISTURBED BY THE CONTRACTOR SHALL BE SEEDED WITH THE APPROPRIATE EROSION CONTROL, AS DIRECTED BY THE ENGINEER, AT THE CONTRACTOR'S EXPENSE.
6. THE RESIDENT ENGINEER SHALL VERIFY THE EXISTENCE OF HIGHWAY LIGHTING AND/OR INTELLIGENT TRANSPORTATION SYSTEMS (I.T.S.) UTILITIES WITHIN THE PROJECT LIMITS. IF HIGHWAY LIGHTING AND/OR I.T.S. EXISTS WITHIN THE PROJECT LIMITS, AND IF THESE ITEMS REQUIRE LOCATING, THE CONTRACTOR SHALL BE DIRECTED TO DO SO ACCORDING TO SECTION 803 OF THE STANDARD SPECIFICATIONS. THIS WORK SHALL BE PAID FOR ACCORDING TO ARTICLE 803.04 OF THE STANDARD SPECIFICATIONS. IF "LOCATING UNDERGROUND CABLE" IS NOT INCLUDED AS PART OF THE PLANS, THIS WORK SHALL BE PAID FOR ACCORDING TO ARTICLE 109.04 OF THE STANDARD SPECIFICATIONS.
7. PROPOSED PAVEMENT MARKING SHALL MATCH EXISTING AS DIRECTED BY THE RESIDENT ENGINEER.
8. THE DEPARTMENT STRONGLY ENCOURAGES THE PRIME CONTRACTOR AND THEIR APPROVED SUB-CONTRACTORS TO HIRE MINORITY, WOMEN AND DISADVANTAGED INDIVIDUALS FROM ITS FEDERALLY FUNDED HIGHWAY CONSTRUCTION CAREERS TRAINING PROGRAM (HCCTP) TO HELP MEET WORKFORCE AND TRAINEE GOALS. THIS PROGRAM IS TRAINING MINORITIES, WOMEN AND DISADVANTAGED INDIVIDUALS IN HIGHWAY CONSTRUCTION-RELATED SKILLS, E.G., MATH FOR THE TRADES, JOB READINESS, TECHNICAL SKILLS COURSEWORK (CARPENTRY, CONCRETE FLATWORK, BLUEPRINT READING, SITE PLANS, SITE WORK, TOOLS USE, ETC.) AND OSHA 10 HOUR CERTIFICATION, TO PREPARE THEM FOR A CAREER IN THE HIGHWAY CONSTRUCTION TRADES. GRADUATES ARE WELL-TRAINED AND READY TO BECOME PRODUCTIVE ENTRY-LEVEL CONSTRUCTION WORKERS. CONTACT THE DISTRICT 8 EEO OFFICE AT 618-346-3360 AND/OR THE HCCTP COORDINATOR AT 618-874-6528 TO LEARN MORE ABOUT THE PROGRAM AND FOR ASSISTANCE IN MEETING WORKFORCE AND TRAINEE GOALS.

**COMMITMENTS**

NONE

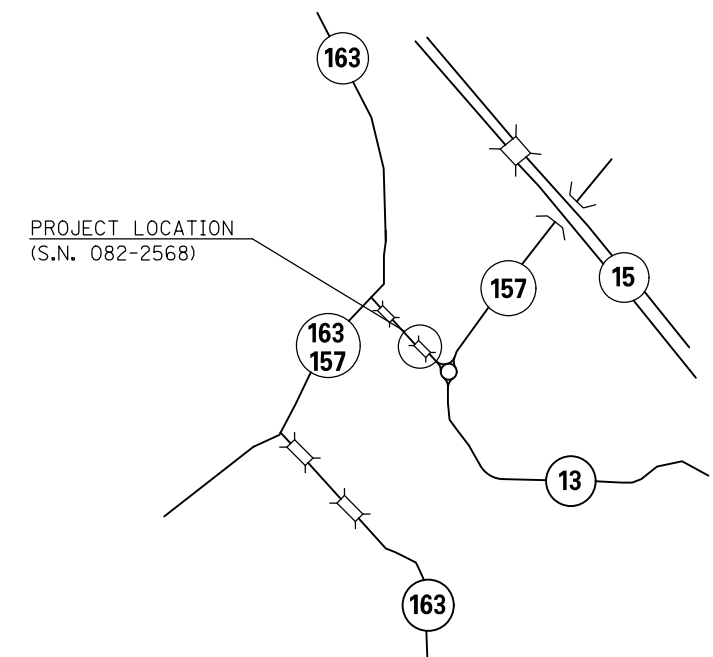

**LOCATION MAP**

FILE NAME =	USER NAME = DintelmanJN	DESIGNED -	REVISED -	<b>STATE OF ILLINOIS DEPARTMENT OF TRANSPORTATION</b>	<b>INDEX OF SHEETS /HIGHWAY STANDARDS GENERAL NOTES /COMMITMENTS /LOCATION MAP</b>	F.A.P. RTE.	SECTION	COUNTY	TOTAL SHEETS	SHEET NO.
pw:\IL\084EBIDINTEG.illinois.gov\PIDOT\Documents\DOT Offices\District 8\Projects\0876\Drawings\EA\Sheets\0876K52-sht-gennot	DESIGNED -	REVISED -	592			121-IRS-3	ST CLAIR	13	2	
PLOT SCALE = 100.0000' / in.	CHECKED -	REVISED -	CONTRACT NO. 76K52							
PLOT DATE = 6/30/2017	DATE -	REVISED -	SCALE:			SHEET NO. 1 OF 1 SHEETS	STA. TO STA.	ILLINOIS FED. AID PROJECT		



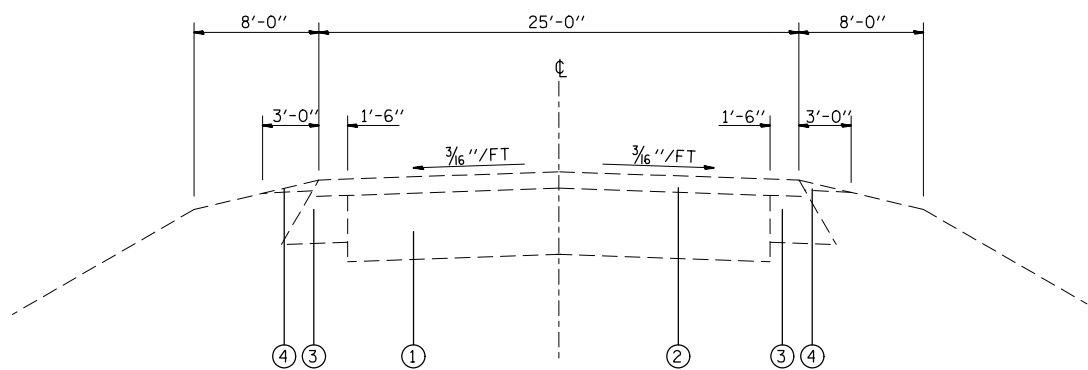

**EXISTING TANGENT SECTION**  
STA. 424+25.00 TO STA. 431+00.00

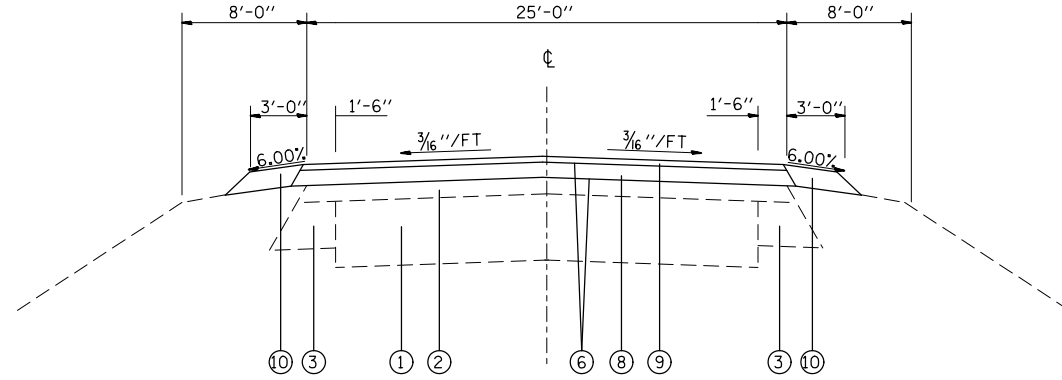

**PROPOSED TANGENT SECTION**  
STA. 427+75.00 TO STA. 431+00.00

**NOTE:**  
REFER TO THE CROSS SECTION SHEETS FOR THE VARIABLE THICKNESS OF THE AGGREGATE SHOULDERS.

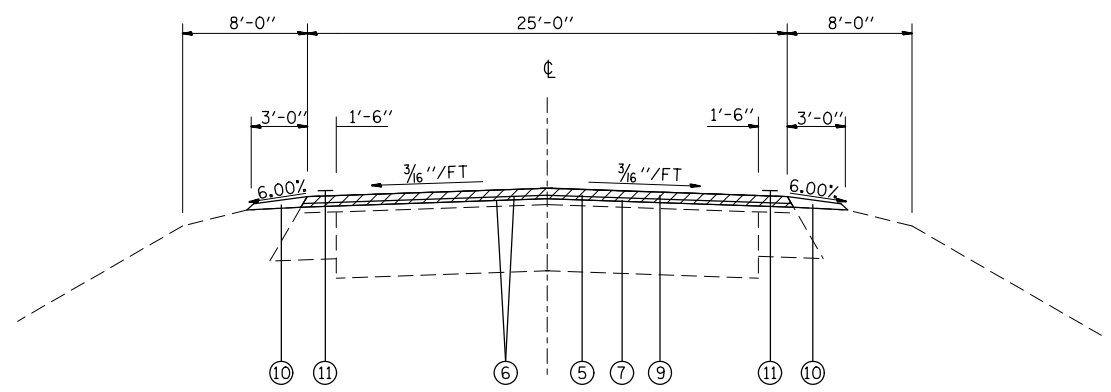

**PROPOSED TANGENT SECTION**  
STA. 424+25.00 TO STA. 427+75.00

**MIXTURE REQUIREMENTS**

MIXTURE USE	SURFACE	LEVEL BINDER	BINDER
AC/PG	PG 64-22	PG 64-22	PG 64-22
RAP % (MAX)	SEE SPEC.	SEE SPEC.	SEE SPEC.
DESIGN AIR VOIDS	4.0% @ Ndes=70	4.0% @ Ndes=70	4.0% @ Ndes=70
MIX COMPOSITION (GRADATION MIXTURE)	IL 9.5	IL 9.5FG	IL 19.0
FRICTION AGG	MIXTURE "D"	MIXTURE "C"	MIXTURE "B"
QUALITY MGMT PROGRAM	QC/QA	QC/QA	QC/QA

••TOP LIFT SHOULDERS - DESIGN THIS MIX AT 2.0% VOIDS AND ADD ASPHALT TO REDUCE VOIDS TO 1.5%.  
PLAN QUANTITIES FOR HOT-MIX ASPHALT SURFACE COURSE ITEMS ARE CALCULATED USING A UNIT WEIGHT OF 112 LB/SQ YD/IN (59.8 KG/SQ M/25 MM THICKNESS).

**LEGEND**

- ① EXISTING PAVEMENT
- ② EXISTING HMA RESURFACING, 3" AND VARIES
- ③ EXISTING HMA WIDENING
- ④ EXISTING AGGREGATE SHOULDERS
- ⑤ PROPOSED HMA SURFACE REMOVAL, 2 1/4"
- ⑥ PROPOSED BITUMINOUS MATERIAL (TACK COAT)
- ⑦ PROPOSED LEVELING BINDER, 3/4"
- ⑧ PROPOSED HMA BINDER COURSE, (VARIES 1 1/4" TO 7")
- ⑨ PROPOSED HMA SURFACE COURSE 1 1/2"
- ⑩ PROPOSED AGGREGATE SHOULDERS, TYPE B
- ⑪ PROPOSED THERMOPLASTIC PAVEMENT MARKING

RESURFACING SCHEDULE							
LOCATION			HMA SURFACE REMOVAL, 2.25"	BIT. MAT'L (TACK COAT)	LEVELING BINDER	HMA BINDER COURSE	HMA SURFACE COURSE
			(SQ YD)	(POUND)	(TON)	(TON)	(TON)
STA.	TO	STA.					
424+25.00	TO	427+75.00	972.22	656.25	40.83	0.00	81.67
427+75.00	TO	428+00.00		62.50		2.37	5.83
428+00.00	TO	428+25.00		62.50		6.40	5.83
428+25.00	TO	428+50.00		62.50		11.10	5.83
428+50.00	TO	428+75.00		62.50		11.73	5.83
428+75.00	TO	429+00.00		62.50		17.69	5.83
429+00.00	TO	429+25.00		62.50		26.64	5.83
429+25.00	TO	429+50.00		62.50		19.35	5.83
429+50.00	TO	429+75.00		62.50		11.01	5.83
429+75.00	TO	430+00.00		62.50		10.07	5.83
430+00.00	TO	430+25.00		62.50		7.62	5.83
430+25.00	TO	430+50.00		62.50		4.00	5.83
430+50.00	TO	430+75.00		62.50		0.00	5.83
430+75.00	TO	431+00.00		62.50		0.00	5.83
TOTAL			973	1469	41	128	158

PAVEMENT MARK. SCHEDULE								
LOCATION			THERMOPLASTIC PAVEMENT MARKING		RAISED RELFLECTIVE PAVEMENT MARKER REMOVAL	RAISED RELFLECTIVE PAVEMENT MARKERS	SHORT TERM PAVEMENT MARKING	SHORT TERM PAVEMENT MARKING REMOVAL
			4"					
STA.	TO	STA.	SOLID WHITE EDGE LINE	SOLID YELLOW LINE				
			FOOT	FOOT	EACH	EACH	FOOT	SQ FT
424+25	TO	431+00	1350	1350	5	9	168	56
TOTAL			2700		5	9	168	56

TEMP. PAV. MARK. SCHEDULE					
LOCATION			TEMPORARY PAVEMENT MARKING		TEMPORARY PAVEMENT MARKING REMOVAL
			4"		
STA.	TO	STA.	SOLID WHITE EDGE LINE	SOLID YELLOW LINE	SQ FT
			FOOT	FOOT	
424+25	TO	431+00	1350	1350	900
TOTAL			2700		900

DEPTH SCHEDULE							
STATION	EXIST. ELEV.	PROP. ELEV.	ELEV. DIFFERENCE	SURFACE THICKNESS	LEVELING BINDER THICKNESS	BINDER THICKNESS	MILLING DEPTH
	(FOOT)	(FOOT)	(IN)	(IN)	(IN)	(IN)	(IN)
424+25.00	422.54	422.54	0.00	1.5	0.75		2.25
424+50.00	422.58	422.58	0.00	1.5	0.75		2.25
424+75.00	422.62	422.62	0.00	1.5	0.75		2.25
425+00.00	422.67	422.67	0.00	1.5	0.75		2.25
425+25.00	422.71	422.71	0.00	1.5	0.75		2.25
425+50.00	422.82	422.82	0.00	1.5	0.75		2.25
425+75.00	422.94	422.94	0.00	1.5	0.75		2.25
426+00.00	423.09	423.09	0.00	1.5	0.75		2.25
426+25.00	423.25	423.25	0.00	1.5	0.75		2.25
426+50.00	423.45	423.45	0.00	1.5	0.75		2.25
426+75.00	423.67	423.67	0.00	1.5	0.75		2.25
427+00.00	423.83	423.83	0.00	1.5	0.75		2.25
427+25.00	423.94	423.94	0.00	1.5	0.75		2.25
427+50.00	424.03	424.03	0.00	1.5	0.75		2.25
427+75.00	424.08	424.08	0.00	1.5	0.75		2.25
428+00.00	423.84	424.07	2.72	1.5		1.22	0.00
428+25.00	423.71	424.01	3.57	1.5		2.07	0.00
428+50.00	423.62	424.04	5.14	1.5		3.64	0.00
428+75.00	423.70	424.02	3.89	1.5		2.39	0.00
429+00.00	423.22	423.91	8.21	1.5		6.71	0.00
429+25.00	422.98	423.69	8.49	1.5		6.99	0.00
429+50.00	423.00	423.38	4.46	1.5		2.96	0.00
429+75.00	422.61	422.96	4.20	1.5		2.70	0.00
430+00.00	422.10	422.44	3.98	1.5		2.48	0.00
430+25.00	421.57	421.81	2.94	1.5		1.44	0.00
430+50.00	420.96	421.10	1.73	1.5			0.52
430+75.00	420.29	420.38	1.02	1.5			1.23
431+00.00	419.65	419.65	0.00	1.5			2.25

TEMPORARY RAMP SCHEDULE		
LOCATION	TEMPORARY RAMP	HMA SURFACE REMOVAL-BUTT JOINT
STATION	SQ YD	SQ YD
424+25	20.83	
431+00	20.83	25
TOTAL	42	25

AGG. SHLDR. SCHEULE				
LOCATION			AGGREGATE SHOULDERS, TYPE B (LEFT)	AGGREGATE SHOULDERS, TYPE B (RIGHT)
STA.	TO	STA.	(TONS)	(TONS)
424+25.00	TO	424+50.00	0.8	0.5
424+50.00	TO	425+00.00	3.7	1.7
425+00.00	TO	425+50.00	3.9	1.5
425+50.00	TO	426+00.00	3.5	1.1
426+00.00	TO	426+50.00	3.7	0.4
426+50.00	TO	427+00.00	4.1	0
427+00.00	TO	427+50.00	5	0
427+50.00	TO	428+00.00	10.6	2
428+00.00	TO	428+50.00	24.1	7.6
428+50.00	TO	429+00.00	28	13
429+00.00	TO	429+50.00	18.8	12.4
429+50.00	TO	430+00.00	11.1	7.8
430+00.00	TO	430+50.00	5.5	4.4
430+50.00	TO	431+00.00	1.6	1.6
SUB-TOTAL			124.4	54
GRAND TOTAL				178

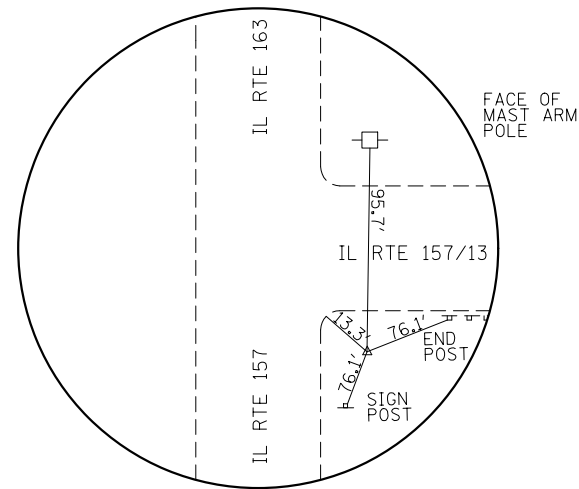

**CONTROL POINT #5**

PIN W/CAP

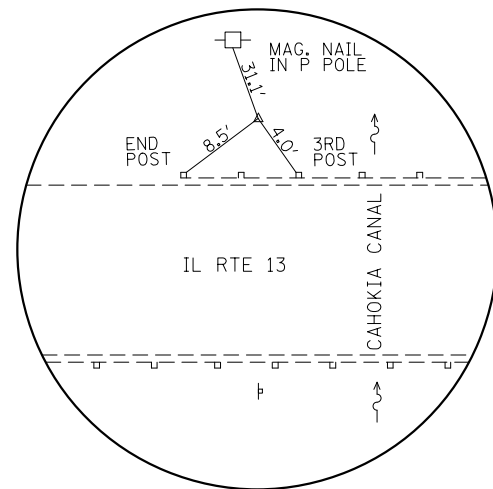

**CONTROL POINT #6**

PIN W/CAP

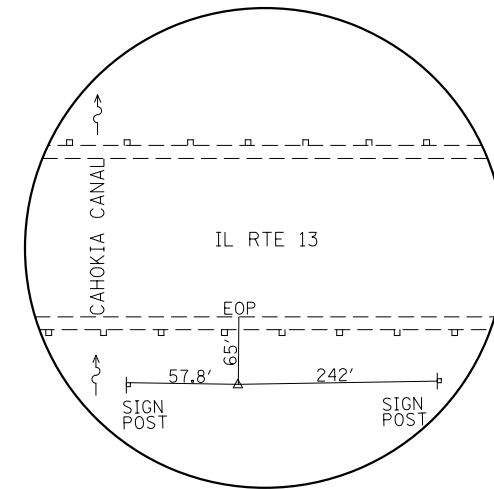

**CONTROL POINT #7**

PIN W/CAP

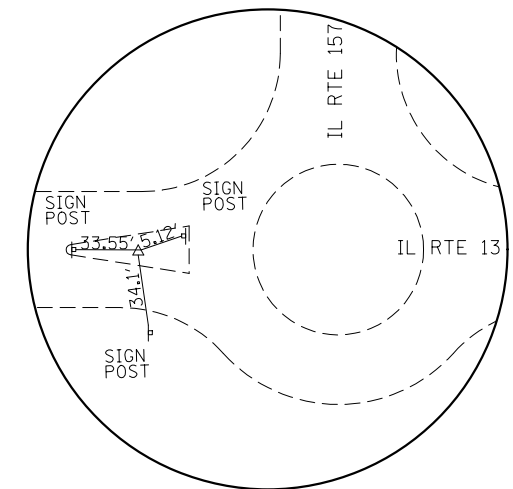

**CONTROL POINT #8**

MAG NAIL  
IN ISLAND

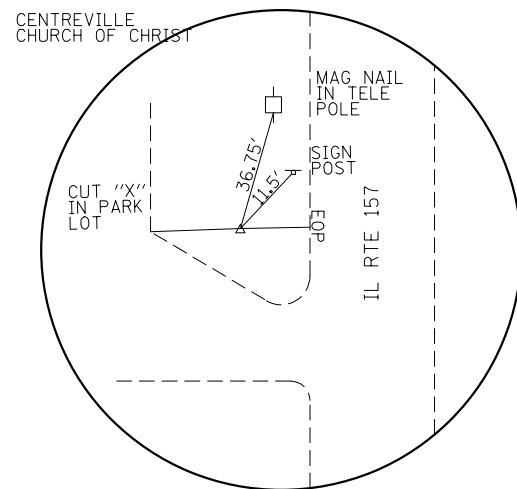

**CONTROL POINT #2**

PIN W/CAP

**BENCH MARKS**

BM 157/13-4: RR SPIKE IN NE SIDE OF P. POLE IN FRONT OF EASTMOST CORNER OF PT'S PARK. LOT SOUTHEAST OF IL 157/13 ROUND-A-BOUT  
ELEVATION = 429.628'

SITE BM: RR SPIKE IN SW SIDE OF P. POLE ON NORTH SIDE OF IL 157, +/- 280' W OF W SIDE OF STRUCT. OVER CAHOKIA CANAL (SN 082-0087) W OF IL 157/IL 13 ROUND-A-BOUT.  
ELEVATION = 417.626'

**BUTT JOINT**  
DRAWING NOT TO SCALE

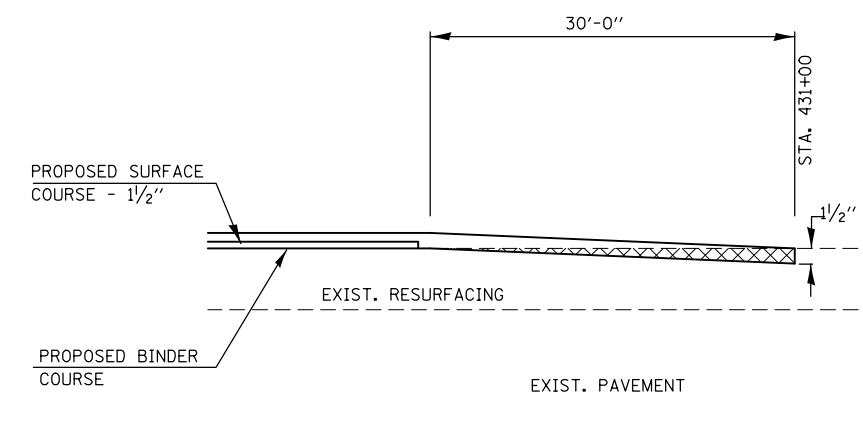

NOTES:  
NOT TO SCALE.  
ALL MEASUREMENTS ARE PULLED DIRECT, UNLESS OTHERWISE NOTED.

FILE NAME =	USER NAME = DintelmanJN	DESIGNED -	REVISED -
pw:\IL\084EBIDINTEG\illinois.gov\PIDOT\Documents\IDOT Offices\District 8\Projects\0875\KBR\Drawings\EA0\Sheets\D876K52-sht-typos		DRAWN -	REVISED -
	PLOT SCALE = 100.0000' / in.	CHECKED -	REVISED -
	PLOT DATE = 6/30/2017	DATE -	REVISED -

**STATE OF ILLINOIS  
DEPARTMENT OF TRANSPORTATION**

**TIE POINT / BUTT JOINT DETAILS**

SCALE: SHEET NO. 1 OF 1 SHEETS STA. TO STA.

F.A.P. RTE.	SECTION	COUNTY	TOTAL SHEETS	SHEET NO.
592	121-IRS-3	ST CLAIR	13	6
CONTRACT NO. 76K52				
FED. ROAD DIST. NO. ILLINOIS FED. AID PROJECT				

PLAN	SURVEYED	BY	DATE
	PLOTTED		
	ALIGNMENT CHECKED		
	NOTE BOOK NO.		
	CADD FILE NAME		

PROFILE	SURVEYED	BY	DATE
	PLOTTED		
	GRADES CHECKED		
	NOTE BOOK NO.		
	STRUCTURE NOTATION		

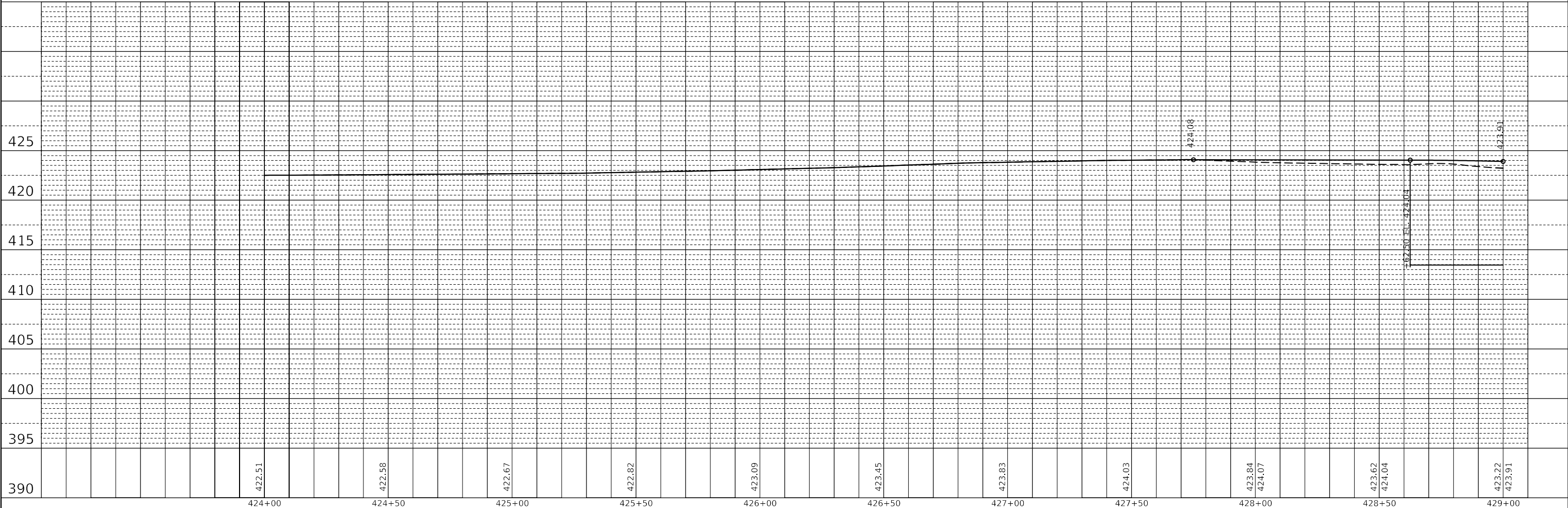
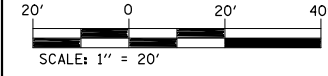
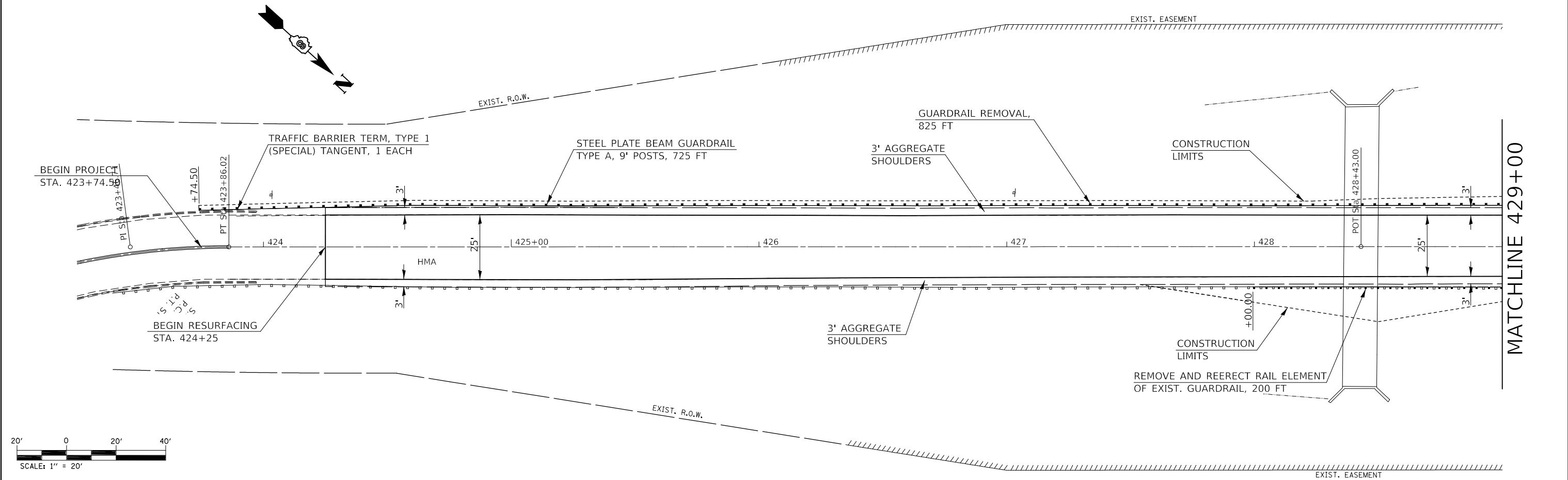

FILE NAME =	USER NAME = DintelmanJN	DESIGNED -	REVISED -	<b>STATE OF ILLINOIS DEPARTMENT OF TRANSPORTATION</b>	<b>PLAN AND PROFILE</b>			F.A.P. RTE. 592	SECTION 121-1RS-3	COUNTY ST. CLAIR	TOTAL SHEETS 13	SHEET NO. 7
pww:\IL084EBIDINTEG\Illinois.gov\PWIDOT\Documents\DOT Offices\District 8\Projects\0876K52\CADDData\CADs\DRAWN\52-sit-plnprf.dgn		CHECKED -	REVISED -		SCALE:	SHEET 1	OF 2 SHEETS	STA. 424+25	TO STA. 429+00	CONTRACT NO. 76K52		
		DATE -	REVISED -		ILLINOIS FED. AID PROJECT							
Default												

PLAN	SURVEYED	DATE
	PLOTTED	BY
	ALIGNMENT CHECKED	
	CADD FILE NAME	
	NO.	

PROFILE	SURVEYED	DATE
	PLOTTED	BY
	GRADES CHECKED	
	STRUCTURE NOTATIONS CHECKED	
	NO.	

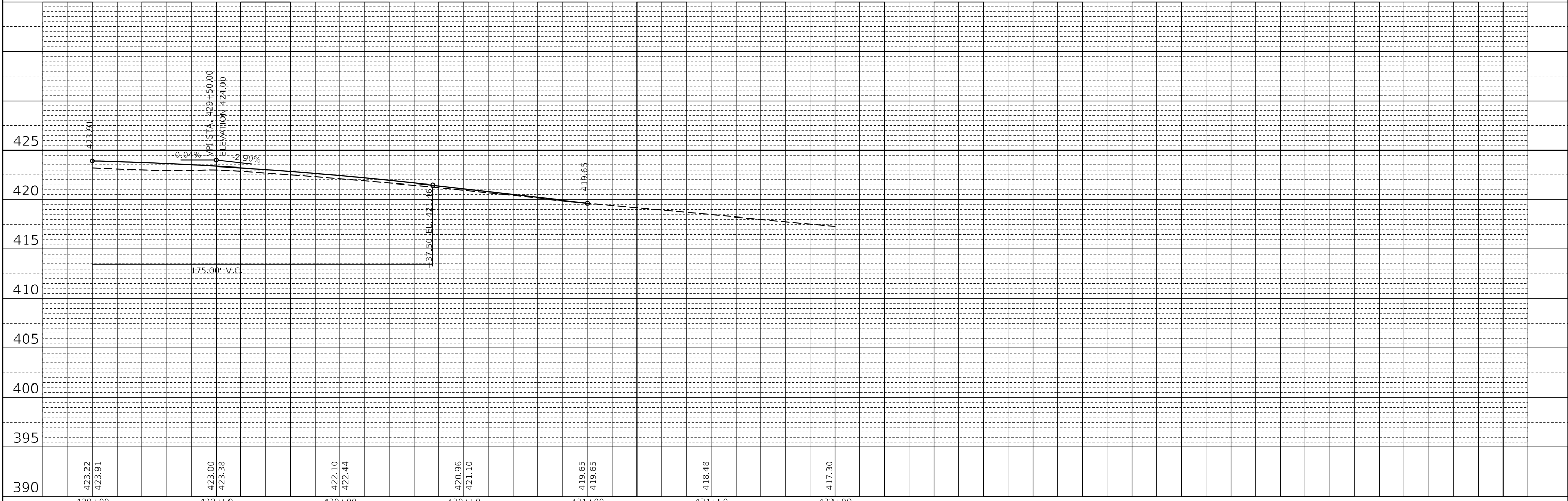
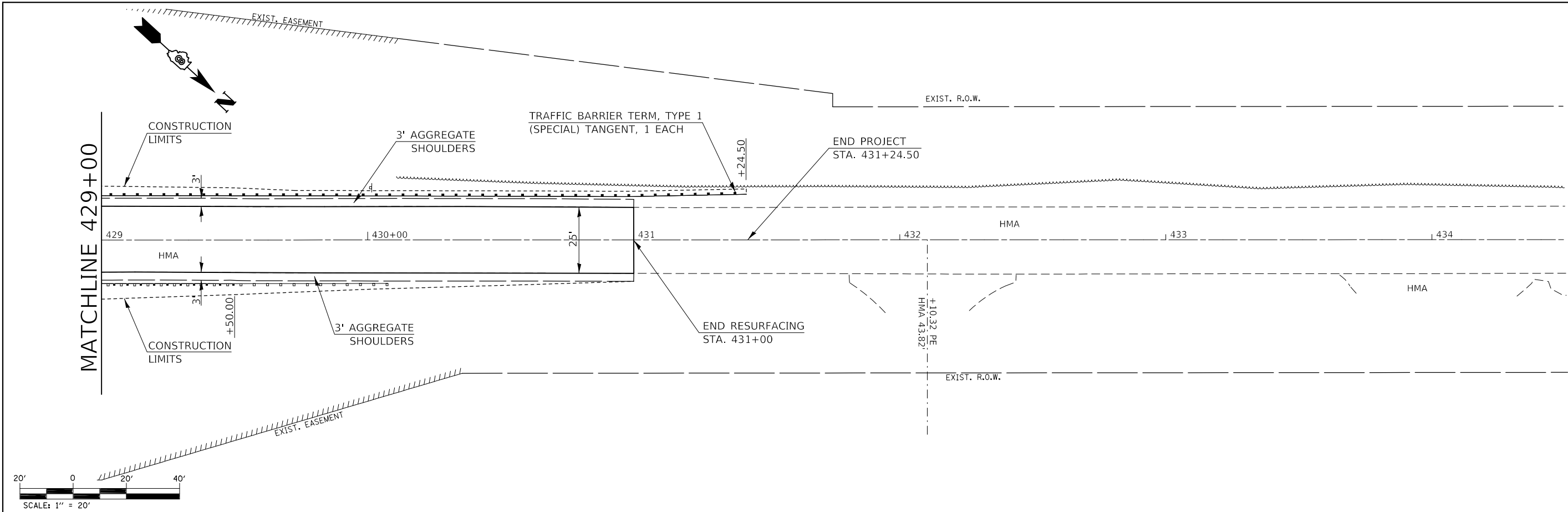

FILE NAME =	USER NAME = DintelmanJN	DESIGNED -	REVISED -
pww:\IL084EBIDINTEG\Illinois.gov\PWIDOT\Documents\DOT Offices\District 8\Projects\0876K52\CADDData\CADs\DRAWN\52-sht-plnprf.dgn		REVISOR -	REVISED -
Default	PLOT SCALE = 40.0000 ' / in.	CHECKED -	REVISED -
	PLOT DATE = 6/30/2017	DATE -	REVISED -

**STATE OF ILLINOIS  
DEPARTMENT OF TRANSPORTATION**

**PLAN AND PROFILE**

SCALE: SHEET 2 OF 2 SHEETS STA. 429+00 TO STA. 431+00

F.A.P. RTE.	SECTION	COUNTY	TOTAL SHEETS	SHEET NO.
592	121-1RS-3	ST. CLAIR	13	8
CONTRACT NO. 76K52				
ILLINOIS FED. AID PROJECT				



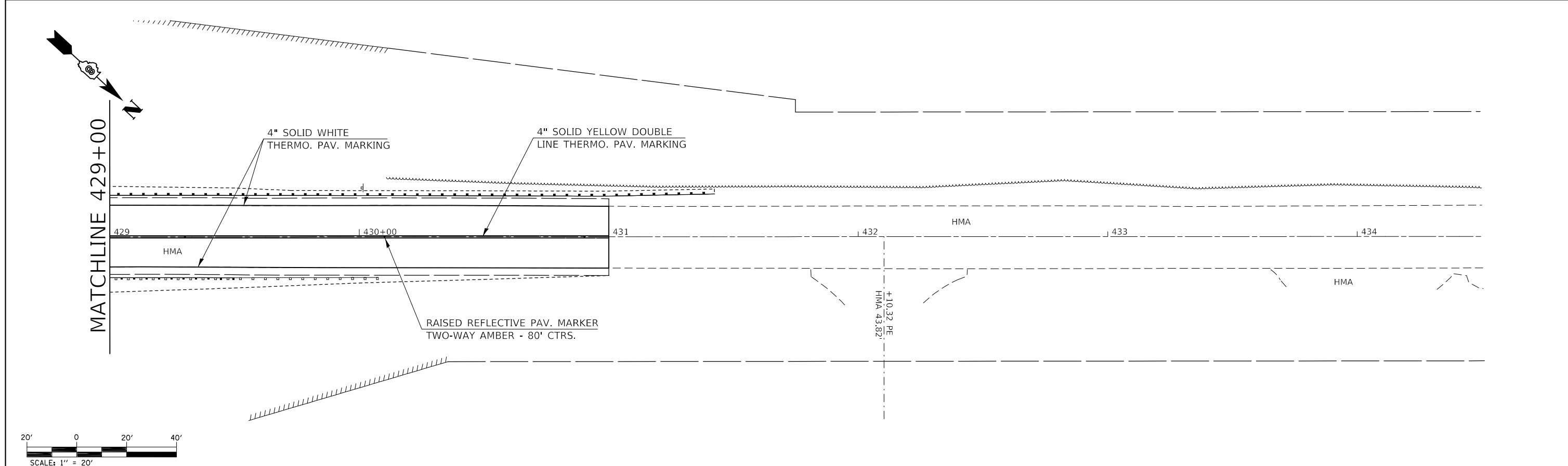
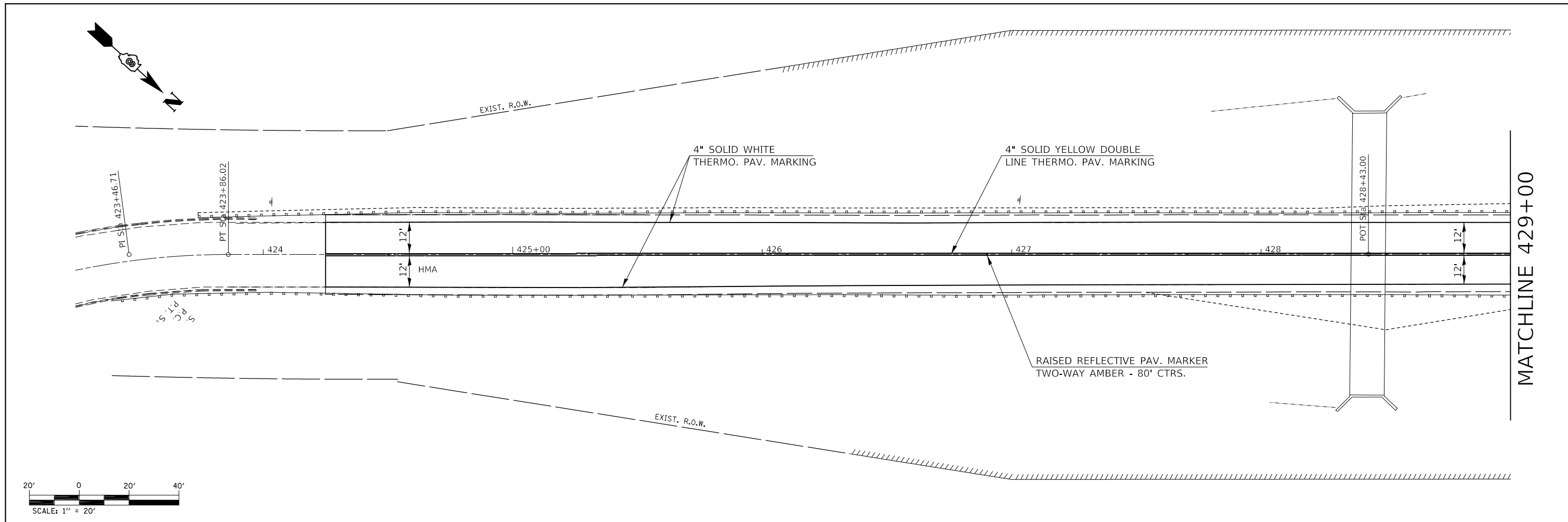

FILE NAME =	USER NAME = DintelmanJN	DESIGNED -	REVISED -	<b>STATE OF ILLINOIS DEPARTMENT OF TRANSPORTATION</b>	<b>PAVEMENT MARKING</b>				F.A.P. RTE.	SECTION	COUNTY	TOTAL SHEETS	SHEET NO.
Default	PLTSCALE = 40.0000 ' / in.	CHECKED -	REVISED -						592	121-1RS-3	ST. CLAIR	13	9
	PLOT DATE = 6/30/2017	DATE -	REVISED -		SCALE: SHEET OF SHEETS STA. TO STA.				CONTRACT NO. 76K52				
									ILLINOIS FED. AID PROJECT				

ORIGINAL SURVEY	SURVEYED	BY	DATE
NOTE BOOK	PLOTTED		
NO.	TEMPLATE		
	AREAS		
	AREAS CHECKED		

FINAL SURVEY	SURVEYED	BY	DATE
NOTE BOOK	PLOTTED		
NO.	TEMPLATE		
	AREAS		
	AREAS CHECKED		

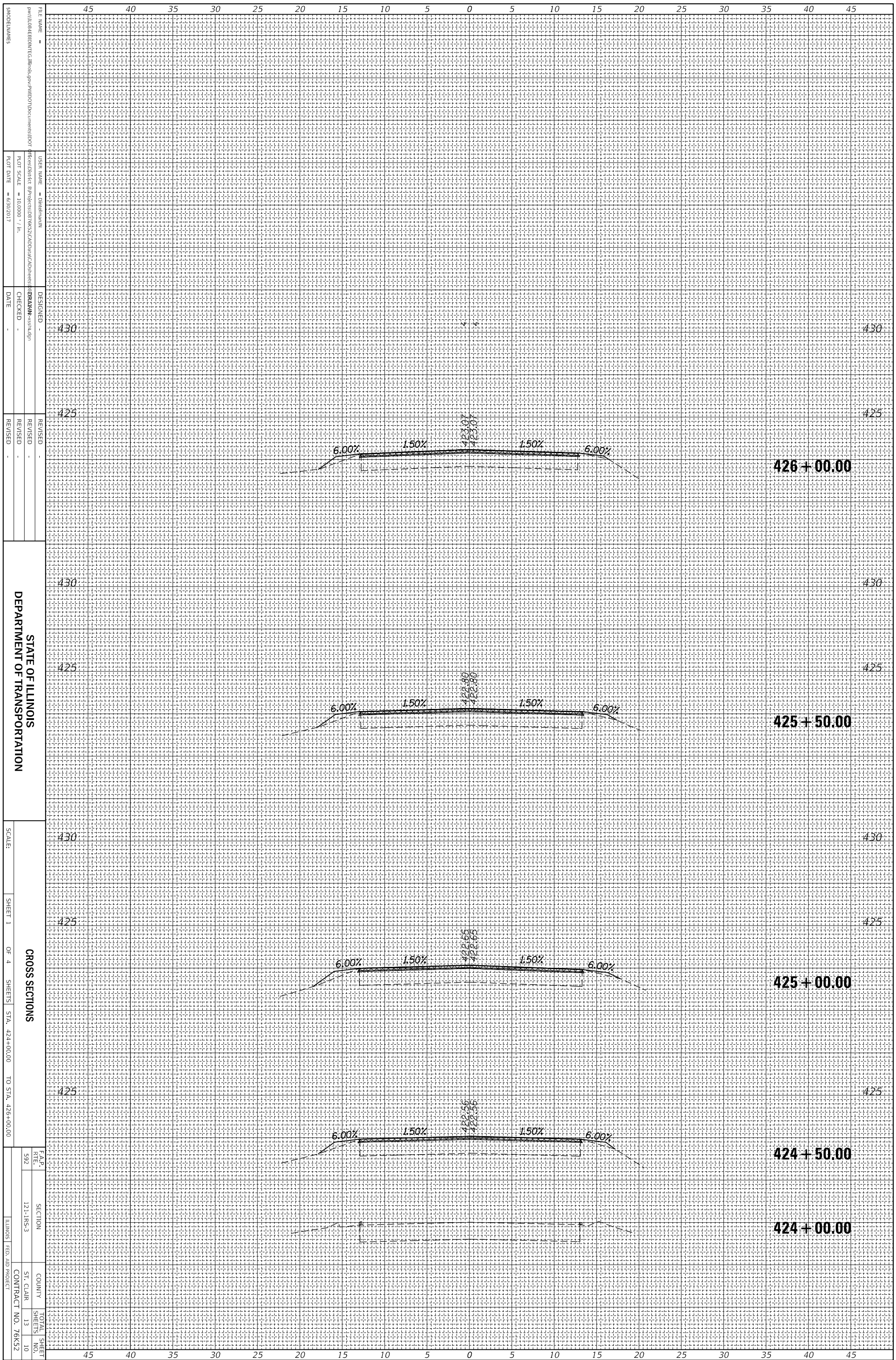

FILE NAME =  
 USER NAME =  
 PROJECT =  
 PLOT SCALE = 1:10,000  
 PLOT DATE = 09/30/2017

DESIGNED -  
 CHECKED -  
 DATE -

REVISED -  
 REVISIONS -

STATE OF ILLINOIS  
 DEPARTMENT OF TRANSPORTATION

CROSS SECTIONS

SCALE: SHEET 1 OF 4 SHEETS STA. 424+00.00 TO STA. 426+00.00

F.A.P. RITE	SECTION	COUNTY	TOTAL SHEET NO.
592	121-1A5.3	ST. CLAIR	13
		CONTRACT NO. 76K52	10

ILLINOIS FED. AID PROJECT

ORIGINAL SURVEY	SURVEYED _____	BY _____	DATE _____
NOTE BOOK	PLOTTED _____		
	TEMPLATE _____		
	AREAS _____		
	AREAS CHECKED _____		

FINAL SURVEY	SURVEYED _____	BY _____	DATE _____
NOTE BOOK	PLOTTED _____		
	TEMPLATE _____		
	AREAS _____		
	AREAS CHECKED _____		

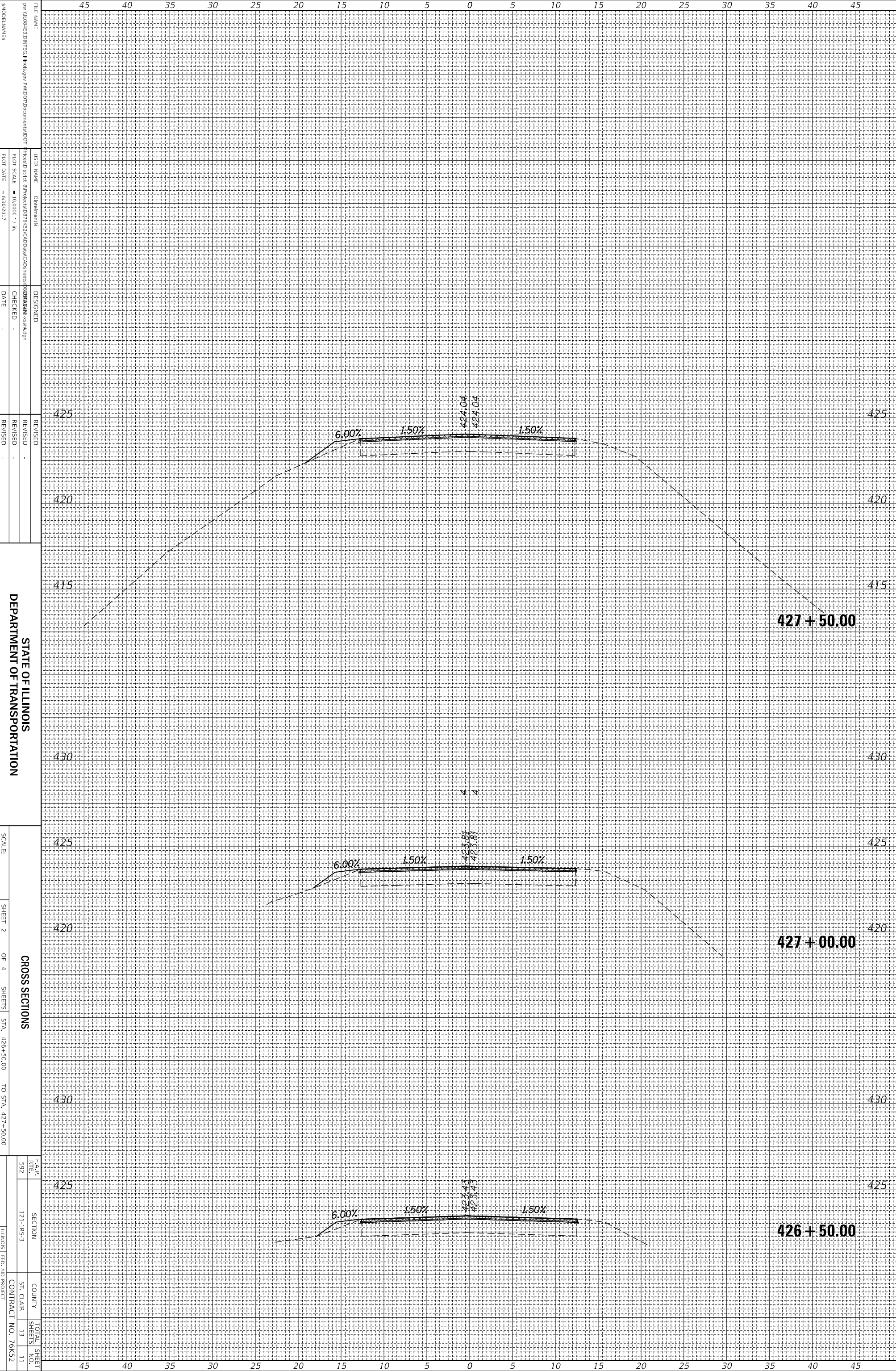

FILE NAME =  
 USER NAME =  
 PLOT SCALE = 1/8" = 10.000' - 1" =  
 PLOT DATE = 03/20/17

DESIGNED -  
 CHECKED -  
 DATE -

REVISIONS  
 REVISION -  
 REVISION -  
 REVISION -

STATE OF ILLINOIS  
 DEPARTMENT OF TRANSPORTATION

SCALE: SHEET 2 OF 4 SHEETS STA. 426+50.00 TO STA. 427+50.00

CROSS SECTIONS

F.A.P. RITE. SECTION COUNTY TOTAL SHEET NO.  
 592 121-185.3 ST. CLAIR 13 11

ILLINOIS FED. AID PROJECT CONTRACT NO. 76K52

ORIGINAL SURVEY	SURVEYED _____	BY _____	DATE _____
NOTE BOOK	PLOTTED _____		
	TEMPLATE _____		
	AREAS _____		
	AREAS CHECKED _____		

FINAL SURVEY	SURVEYED _____	BY _____	DATE _____
NOTE BOOK	PLOTTED _____		
	TEMPLATE _____		
	AREAS _____		
	AREAS CHECKED _____		

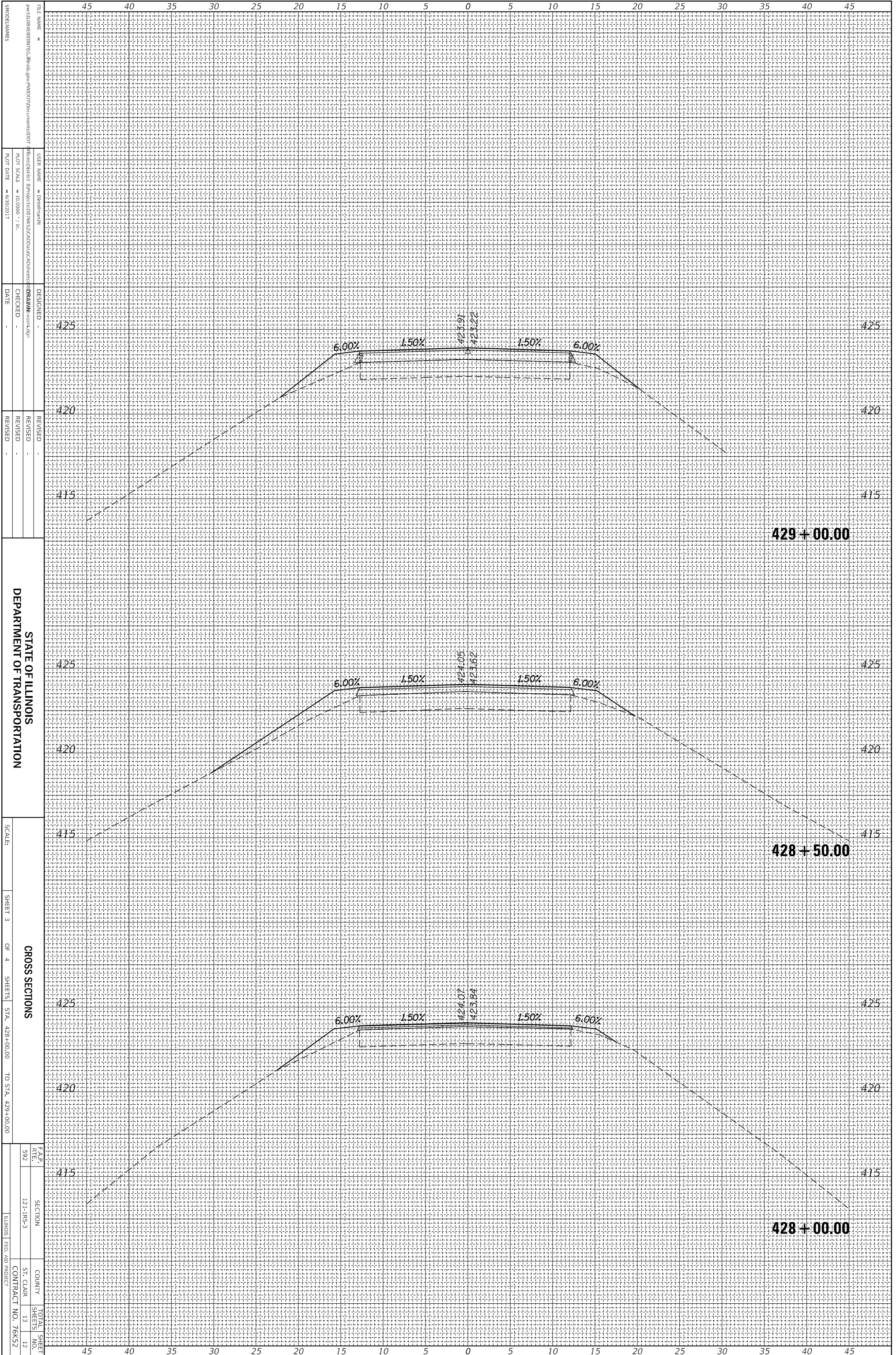

FILE NAME =  
 USER NAME =  
 PROJECT =  
 PLOT SCALE = 1/8" = 10.000' - 1/8"  
 PLOT DATE = 03/20/17

DESIGNED -  
 CHECKED -  
 DATE -

REVISED -  
 REVISED -  
 REVISED -

STATE OF ILLINOIS  
 DEPARTMENT OF TRANSPORTATION

SCALE: SHEET 3 OF 4 SHEETS STA. 428+00.00 TO STA. 429+00.00

CROSS SECTIONS

F.A.P. RITE. SECTION COUNTY TOTAL SHEET NO. 592 121-1RS-3 ST. CLAIR 13 12

ILLINOIS FED. AID PROJECT CONTRACT NO. 76K52

ORIGINAL SURVEY	SURVEYED _____	BY _____	DATE _____
NOTE BOOK	PLOTTED _____		
	TEMPLATE _____		
	AREAS _____		
	AREAS CHECKED _____		

FINAL SURVEY	SURVEYED _____	BY _____	DATE _____
NOTE BOOK	PLOTTED _____		
	TEMPLATE _____		
	AREAS _____		
	AREAS CHECKED _____		

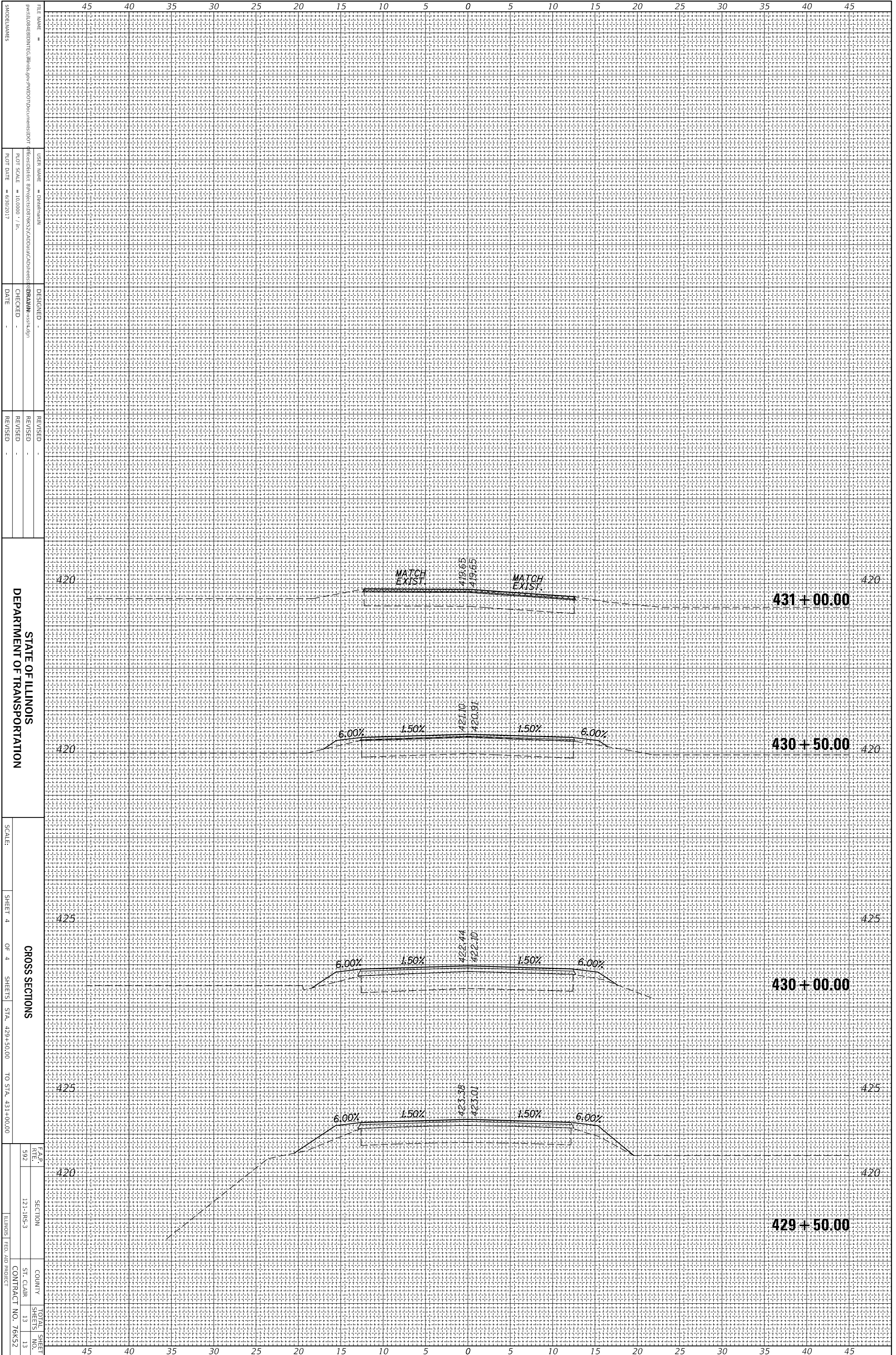

FILE NAME =   
 USER NAME =   
 PLOT SCALE = 1/8" = 10.000' - 1"   
 PLOT DATE = 03/20/17

DESIGNED -   
 CHECKED -   
 DATE -

REVISIONS   
 REVISION NO.   
 REVISION DESCRIPTION   
 DATE

STATE OF ILLINOIS   
 DEPARTMENT OF TRANSPORTATION   
 SCALE:   
 SHEET 4 OF 4 SHEETS   
 STA. 429+50.00 TO STA. 431+00.00   
 CROSS SECTIONS   
 F.A.P. RITE. 592   
 SECTION 121-1A5.3   
 COUNTY ST. CLAIR   
 TOTAL SHEET NO. 13   
 CONTRACT NO. 76K52   
 ILLINOIS FED. AID PROJECT