

CODE NO.	ITEM	UNIT	TOTAL QUANTITY	CONSTRUCTION CODE	
				90% FED 10% STATE ROADWAY	90% FED 10% STATE LIGHTING
				0005	0021
20200100	EARTH EXCAVATION	CU YD	370	370	-
20400800	FURNISHED EXCAVATION	CU YD	185	185	-
21101505	TOPSOIL EXCAVATION AND PLACEMENT	CU YD	2,159	2,159	-
21101625	TOPSOIL FURNISH AND PLACE, 6"	SQ YD	1,000	1,000	-
25000210	SEEDING, CLASS 2A	ACRE	3	3	-
25000400	NITROGEN FERTILIZER NUTRIENT	POUND	241	241	-
25000500	PHOSPHORUS FERTILIZER NUTRIENT	POUND	241	241	-
25000600	POTASSIUM FERTILIZER NUTRIENT	POUND	241	241	-
28000250	TEMPORARY EROSION CONTROL SEEDING	POUND	1,500	1,500	-
28000305	TEMPORARY DITCH CHECKS	FOOT	500	500	-
28000400	PERIMETER EROSION BARRIER	FOOT	9,148	9,148	-
67000400	ENGINEER'S FIELD OFFICE, TYPE A	CAL MO	15	15	-
67100100	MOBILIZATION	L SUM	1	1	-
70100310	TRAFFIC CONTROL AND PROTECTION, STANDARD 701421	L SUM	1	1	-
70102630	TRAFFIC CONTROL AND PROTECTION, STANDARD 701601	L SUM	1	1	-
80400100	ELECTRIC SERVICE INSTALLATION	EACH	2	-	2
80400200	ELECTRIC UTILITY SERVICE CONNECTION	L SUM	1	-	1
81028240	UNDERGROUND CONDUIT, GALVANIZED STEEL, 4" DIA.	FOOT	75	-	75
81028390	UNDERGROUND CONDUIT, PVC, 4" DIA.	FOOT	1,915	-	1,915
81100320	CONDUIT ATTACHED TO STRUCTURE, 1" DIA., PVC COATED GALVANIZED STEEL	FOOT	1,454	-	1,454



REVISED SHEET 9/13/2023

S0Q-01

MODEL: Default; FILE NAME: J:\18235\0204_CADD\CADD_Sheets\0162U48-SP-S0Q-01.dgn



USER NAME = mgarvda	DESIGNED - VN/MAG	REVISED -
PLOT SCALE = 2" = 1'	DRAWN - MAG	REVISED -
PLOT DATE = 6/29/2023	CHECKED - MG	REVISED -
	DATE - 6/30/2023	REVISED -

STATE OF ILLINOIS
DEPARTMENT OF TRANSPORTATION

SUMMARY OF QUANTITIES

SCALE: SHEET OF SHEETS STA.

F.A.P. RTE.	SECTION	COUNTY	TOTAL SHEETS	SHEET NO.
57	2022 TRAFFIC LT	COOK	77	4
CONTRACT NO. 62U48				
ILLINOIS FED. AID PROJECT				

CODE NO.	ITEM	UNIT	TOTAL QUANTITY	CONSTRUCTION CODE	
				90% FED 10% STATE	90% FED 10% STATE
				ROADWAY 0005	LIGHTING 0021
			URBAN		
81100805	CONDUIT ATTACHED TO STRUCTURE, 3" DIA., PVC COATED GALVANIZED STEEL	FOOT	100	-	100
81300220	JUNCTION BOX, STAINLESS STEEL, ATTACHED TO STRUCTURE, 6" X 6" X 4"	EACH	26	-	26
81300530	JUNCTION BOX, STAINLESS STEEL, ATTACHED TO STRUCTURE, 12" X 10" X 6"	EACH	13	-	13
81300830	JUNCTION BOX, STAINLESS STEEL, ATTACHED TO STRUCTURE, 18" X 18" X 8"	EACH	7	-	7
81603081	UNIT DUCT, 600V, 3-1C NO.2, 1/C NO.4 GROUND, (XLP-TYPE USE), 1 1/2" DIA. POLYETHYLENE	FOOT	48,570	-	48,570
81702110	ELECTRIC CABLE IN CONDUIT, 600V (XLP-TYPE USE) 1/C NO. 10	FOOT	4,577	-	4,577
81702220	ELECTRIC CABLE IN CONDUIT, 600V (XLP-TYPE USE) 1/C 350MCM	FOOT	381	-	381
82110008	LUMINAIRE, LED, ROADWAY, OUTPUT DESIGNATION H	EACH	189	-	189
82110027	LUMINAIRE, LED, UNDERPASS, SUSPENDED, OUTPUT DESIGNATION E	EACH	26	-	26
83050810	LIGHT POLE, ALUMINUM, 47.5 FT. M.H., 15 FT. MAST ARM	EACH	189	-	189
83600365	LIGHT POLE FOUNDATION, METAL, 15" BOLT CIRCLE, 10" X 8"	EACH	189	-	189
83800205	BREAKAWAY DEVICE, TRANSFORMER BASE, 15 INCH BOLT CIRCLE	EACH	189	-	189
84500110	REMOVAL OF LIGHTING CONTROLLER	EACH	2	-	2
84500120	REMOVAL OF ELECTRIC SERVICE INSTALLATION	EACH	2	-	2
84500130	REMOVAL OF LIGHTING CONTROLLER FOUNDATION	EACH	2	-	2
X1400190	REMOVAL OF HIGH MAST LUMINAIRES, SALVAGE	EACH	163	-	163
X2511630	EROSION CONTROL BLANKET (SPECIAL)	SQ YD	12,951	12,951	
X7010216	TRAFFIC CONTROL AND PROTECTION, (SPECIAL)	L SUM	1	1	-
X1400402	LIGHTING CONTROLLER, BASE MOUNTED, 480VOLT, 200AMP (DUAL), RADIO SCADA, FIBER OPTIC	EACH	2	-	2

2

2

2

2

2 REVISED SHEET 9/13/2023

SOQ-02

MODEL: Default FILE NAME: \\snp\projects\12235.0206_CADD\CADD_Sheets\02\48-entire-soq2.dgn



USER NAME	• vnlunez	DESIGNED	- VNMAG	REVISED	-
		DRAWN	- MAG	REVISED	-
PLOT SCALE	• 1" = 1'	CHECKED	- MG	REVISED	-
PLOT DATE	• 6/26/2023	DATE	- 6/30/2023	REVISED	-

**STATE OF ILLINOIS
DEPARTMENT OF TRANSPORTATION**

SUMMARY OF QUANTITIES

SCALE: SHEET OF SHEETS STA.

F.A.P. RTE.	SECTION	COUNTY	TOTAL SHEETS	SHEET NO.
57	2022 TRAFFIC LT	COOK	77	5
CONTRACT NO. 62U48				
ILLINOIS FED. AID PROJECT				

REV-SEP

CODE NO.	ITEM	UNIT	TOTAL QUANTITY	CONSTRUCTION CODE	
				90% FED 10% STATE	90% FED 10% STATE
				ROADWAY	LIGHTING
				0005	0021
X8420111	REMOVAL OF UNDERPASS LIGHTING UNIT, NO SALVAGE	EACH	38	-	38
84200605	REMOVAL OF LIGHT TOWER, NO SALVAGE	EACH	50	-	50
66901001	REGULATED SUBSTANCES PRE-CONSTRUCTION PLAN	L SUM	1	1	
X8420510	REMOVAL OF TOWER FOUNDATION	EACH	50		50
66901003	REGULATED SUBSTANCES FINAL CONSTRUCTION REPORT	L SUM	1	1	
Z0013798	CONSTRUCTION LAYOUT	L SUM	1	1	-
66901006	REGULATED SUBSTANCES MONITORING	CAL DA	175	175	
Z0030850	TEMPORARY INFORMATION SIGNING	SQ FT	155	155	-
Z0033020	LUMINAIRE SAFETY CABLE ASSEMBLY	EACH	189	-	189
Z0033028	MAINTENANCE OF LIGHTING SYSTEM	CAL MO	15	-	15
Z0076600	TRAINEES	HOURS	1500	1500	
Z0076604	TRAINEES - TRAINING PROGRAM GRADUATE	HOURS	1500	1500	

URBAN

2

2

MODEL: Default
FILE NAME: J:\10235\0204_CADD\CADD_Sheets\0162U48-01-02-03.dgn



USER NAME = mgarvda	DESIGNED - VN/MAG	REVISED -
	DRAWN - MAG	REVISED -
PLOT SCALE = 2" / 1"	CHECKED - MG	REVISED -
PLOT DATE = 6/29/2023	DATE - 6/30/2023	REVISED -

STATE OF ILLINOIS
DEPARTMENT OF TRANSPORTATION

SUMMARY OF QUANTITIES

SCALE: SHEET OF SHEETS STA.

REVISED SHEET 9/13/2023

0042
SQ-03

F.A.P. RTE.	SECTION	COUNTY	TOTAL SHEETS	SHEET NO.
57	2022 TRAFFIC LT	COOK	77	6
CONTRACT NO. 62U48				
ILLINOIS FED. AID PROJECT				

REV-SEP

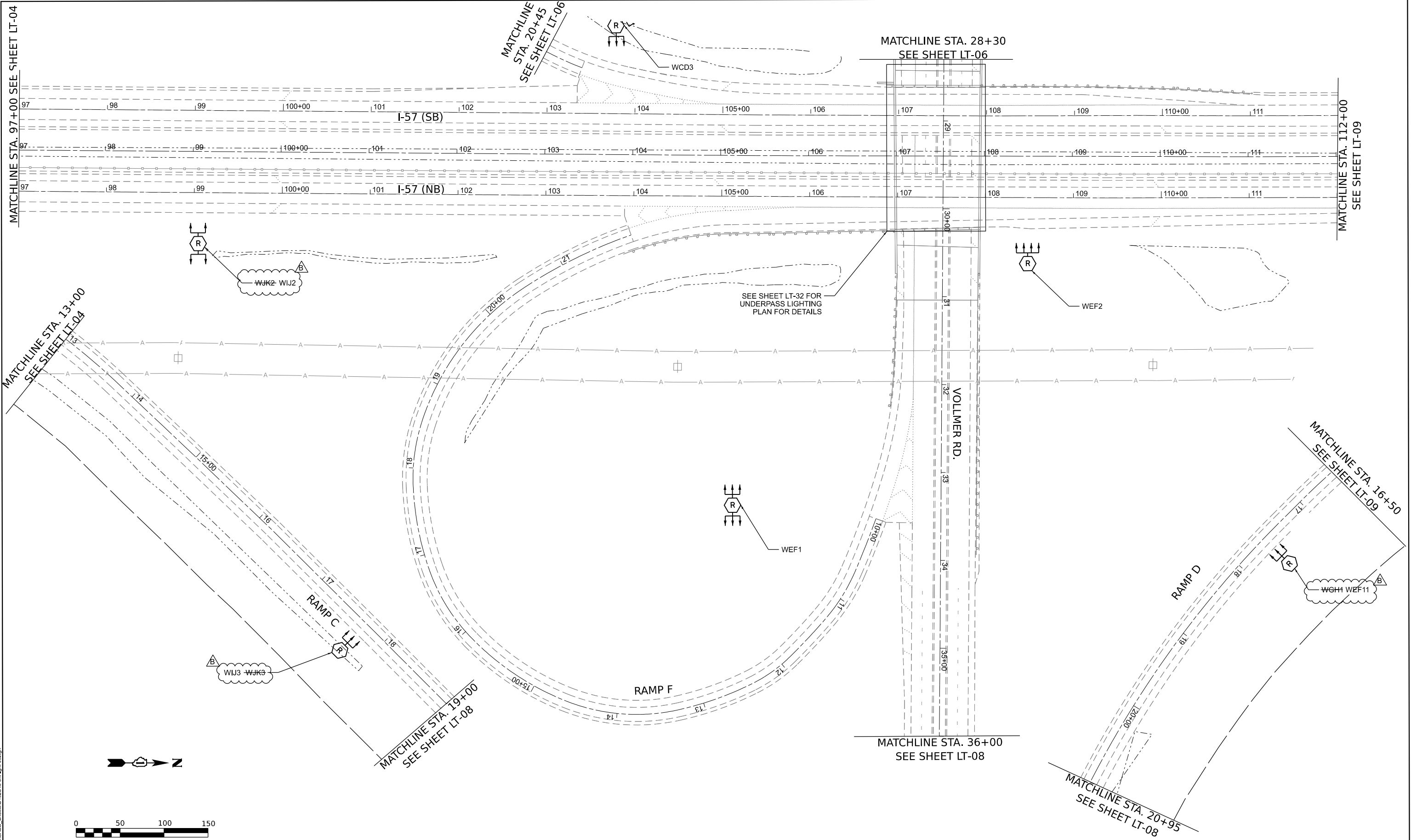

MATCHLINE STA. 97+00 SEE SHEET LT-04

MATCHLINE STA. 112+00
SEE SHEET LT-09

MATCHLINE STA. 13+00
SEE SHEET LT-04

MATCHLINE STA. 16+50
SEE SHEET LT-09

MATCHLINE STA. 19+00
SEE SHEET LT-08

MATCHLINE STA. 36+00
SEE SHEET LT-08

MATCHLINE STA. 20+95
SEE SHEET LT-08

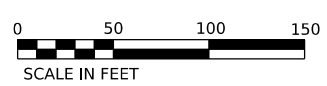
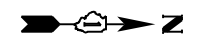

REVISED SHEET 9/13/2023 **LT-05**

MODEL: Default
FILE NAME: J:\18235\0204_CADD\CADD_Sheets\Drawings\LT-05.dgn



USER NAME = vruwez	DESIGNED - VN/MAG	REVISED - ADDENDUM B 9/12/2023
PLOT SCALE = 1/8" = 1'-0"	DRAWN - MAG	REVISED -
PLOT DATE = 9/12/2023	CHECKED - MG	REVISED -
	DATE - 6/30/2023	REVISED -

**STATE OF ILLINOIS
DEPARTMENT OF TRANSPORTATION**

LIGHTING REMOVAL PLAN
I-57 HIGH MAST LIGHTING IMPROVEMENTS US 30 TO 183RD STREET

F.A.P. RTE.	SECTION	COUNTY	TOTAL SHEETS	SHEET NO.
57	2022 TRAFFIC LT	COOK	77	25
CONTRACT NO. 62U48			ILLINOIS FED. AID PROJECT	

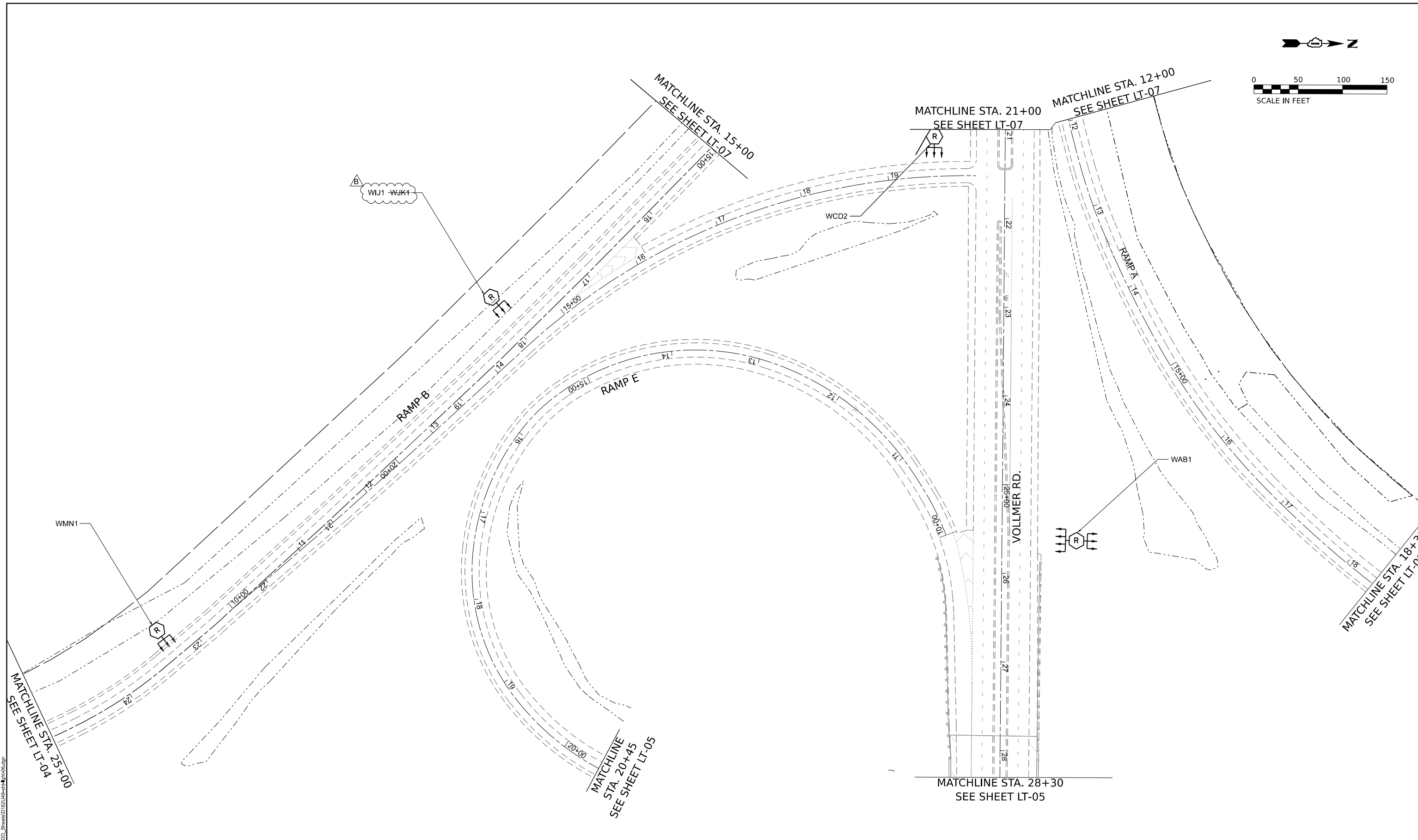
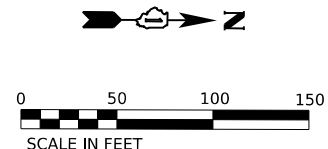

MODEL: D:\Illin...
 FILE NAME: J:\023529204_CADD\CADD_Sheets\0162\U4\Permit\Lighting\06.dgn



USER NAME = vnunez	DESIGNED - VN/MAG	REVISED - ADDENDUM B 9/12/2023
PLOT SCALE = 100,0000' / in.	DRAWN - MAG	REVISED -
PLOT DATE = 9/12/2023	CHECKED - MG	REVISED -
	DATE - 6/30/2023	REVISED -

**STATE OF ILLINOIS
DEPARTMENT OF TRANSPORTATION**

**LIGHTING REMOVAL PLAN
I-57 HIGH MAST LIGHTING IMPROVEMENTS US 30 TO 183RD STREET**

SCALE: SHEET OF SHEETS STA.

2 REVISED SHEET 9/13/2023

LT-06

F.A.P. RTE.	SECTION	COUNTY	TOTAL SHEETS	SHEET NO.
57	2022 TRAFFIC LT	COOK	77	26
CONTRACT NO. 62U48			ILLINOIS FED. AID PROJECT	

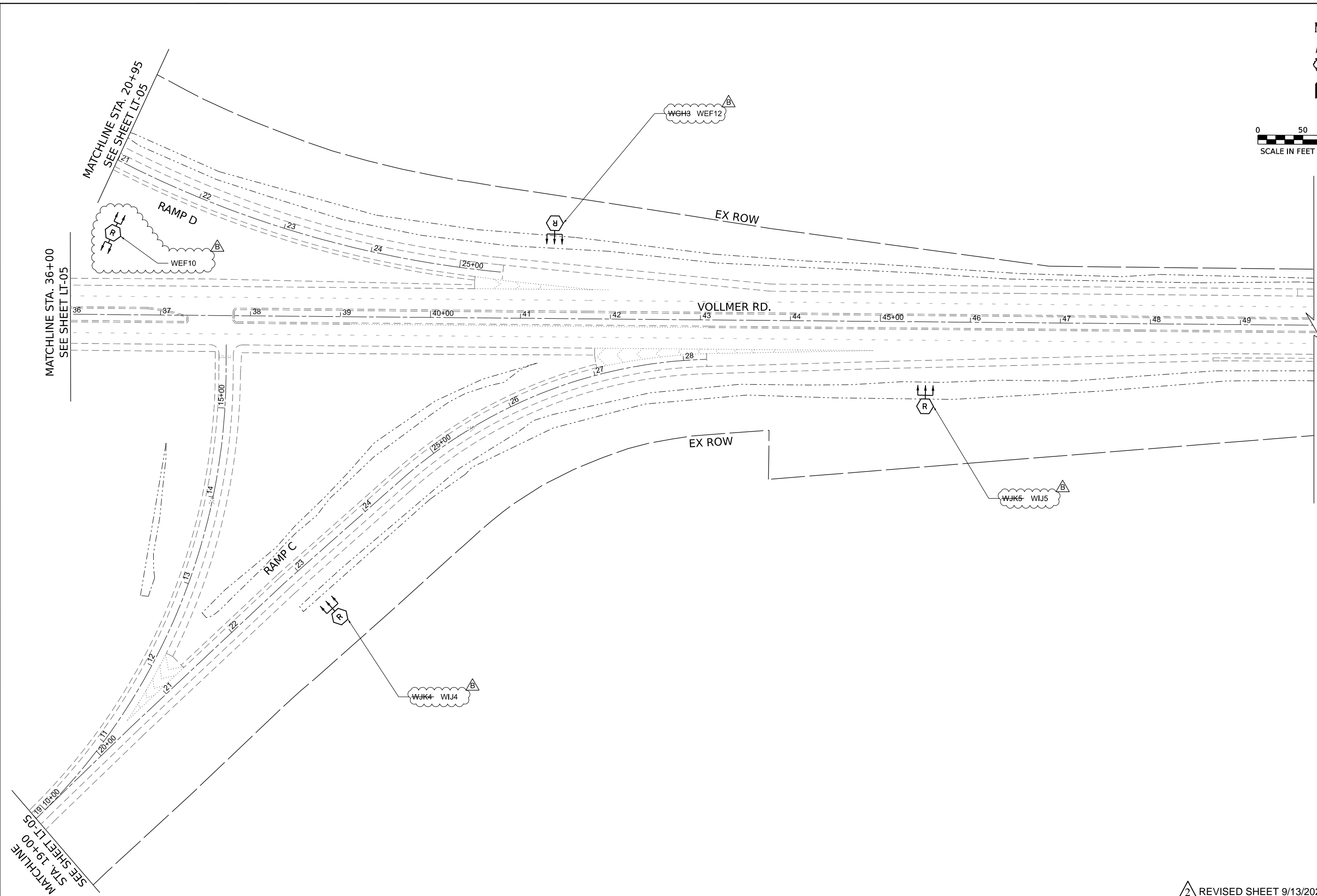
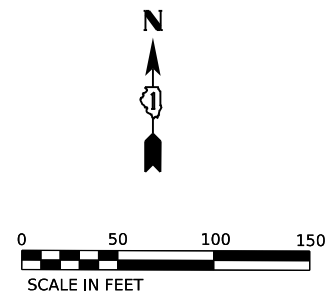

MODEL: D:\in\11...
 FILE NAME: J:\23\230204_CADD\CADD_Sheets\162U48\Lighting\LT-08.dgn



USER NAME = vnunez	DESIGNED - VN/MAG	REVISED - ADDENDUM B 9/12/2023
PLOT SCALE = 100,0000' / in.	DRAWN - MAG	REVISED -
PLOT DATE = 9/12/2023	CHECKED - MG	REVISED -
	DATE - 6/30/2023	REVISED -

STATE OF ILLINOIS
DEPARTMENT OF TRANSPORTATION

LIGHTING REMOVAL PLAN
I-57 HIGH MAST LIGHTING IMPROVEMENTS US 30 TO 183RD STREET

F.A.P. RTE.	SECTION	COUNTY	TOTAL SHEETS	SHEET NO.
57	2022 TRAFFIC LT	COOK	77	28
CONTRACT NO. 62U48			ILLINOIS FED. AID PROJECT	

REVISED SHEET 9/13/2023

LT-08

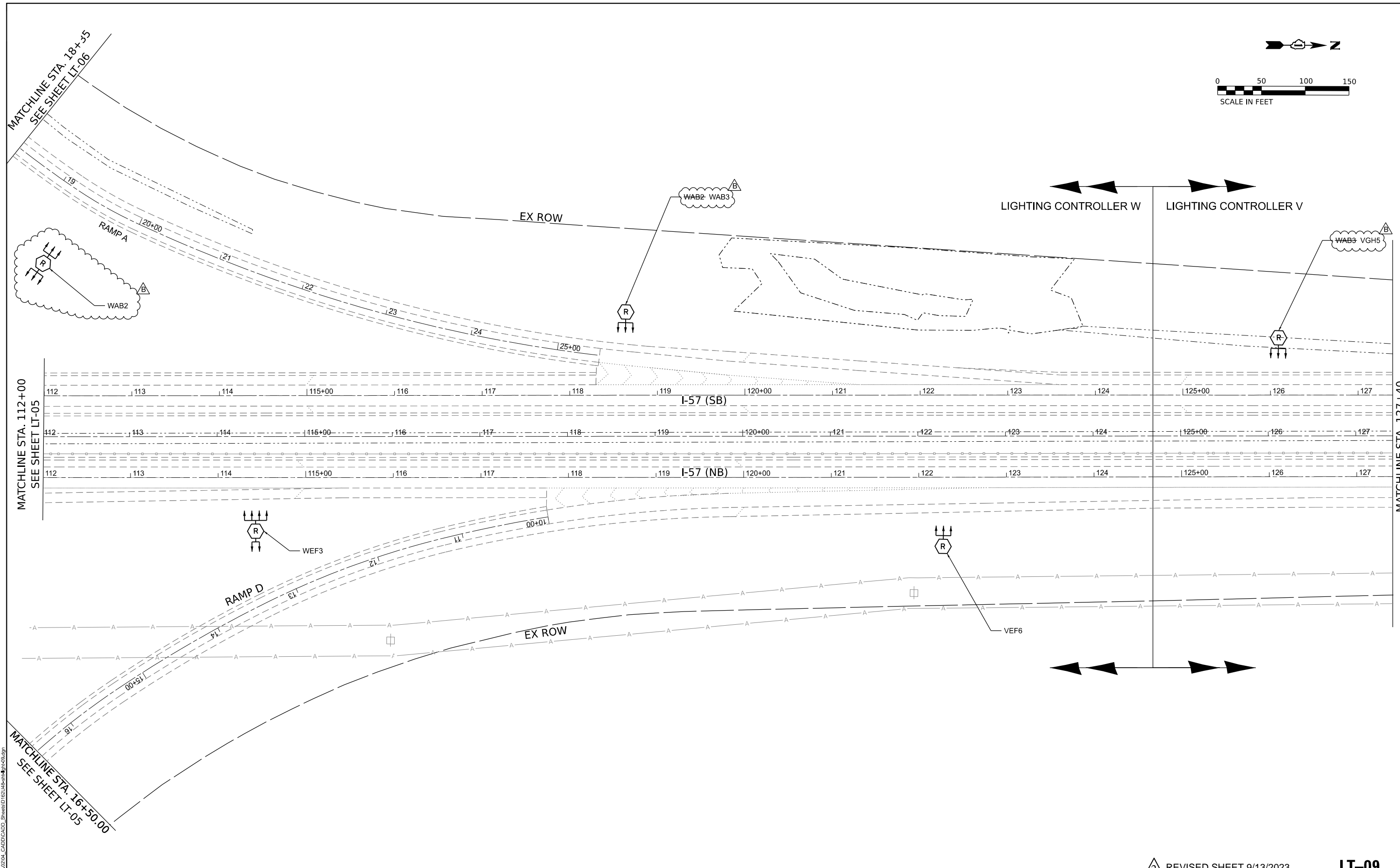
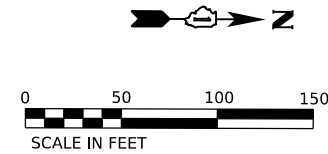

MATCHLINE STA. 18+35
SEE SHEET LT-06

MATCHLINE STA. 112+00
SEE SHEET LT-05

MATCHLINE STA. 16+50.00
SEE SHEET LT-05

MATCHLINE STA. 127+40

LIGHTING CONTROLLER W LIGHTING CONTROLLER V

REVIS²ED SHEET 9/13/2023 **LT-09**

MODEL: D:\in\it... FILE NAME: J:\023529204_CADD\CADD_Sheets\162145Per\Light-09.dgn



USER NAME = vnunez	DESIGNED - VN/MAG	REVISED - ADDENDUM B 9/12/2023
DRAWN - MAG	REVISIONS	
PLOT SCALE = 100,0000' / in.	CHECKED - MG	REVISIONS
PLOT DATE = 9/12/2023	DATE - 6/30/2023	REVISIONS

**STATE OF ILLINOIS
DEPARTMENT OF TRANSPORTATION**

LIGHTING REMOVAL PLAN
I-57 HIGH MAST LIGHTING IMPROVEMENTS US 30 TO 183RD STREET

F.A.P. RTE.	SECTION	COUNTY	TOTAL SHEETS	SHEET NO.
57	2022 TRAFFIC LT	COOK	77	29
CONTRACT NO. 62U48				
ILLINOIS FED. AID PROJECT				

SCALE: SHEET OF SHEETS STA.

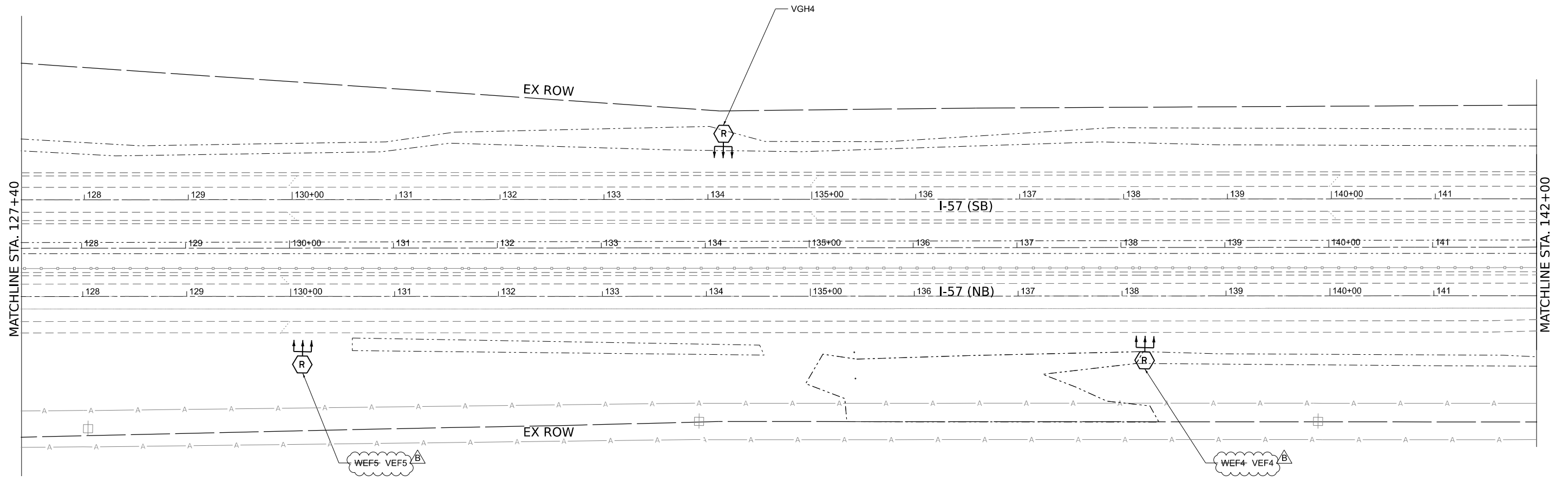
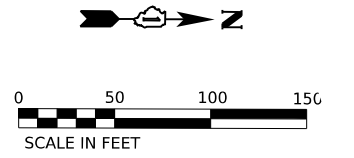

MODEL: D:\Illin...
 FILE NAME: J:\02352024_CADD\CADD_Sheets\162U48\Lighting-10.dgn



USER NAME = vnunez	DESIGNED - VN/MAG	REVISED - ADDENDUM B 9/12/2023
DRAWN - MAG	CHECKED - MG	REVISED -
PLOT SCALE = 100,0000' / in.	DATE - 6/30/2023	REVISED -
PLOT DATE = 9/12/2023		

STATE OF ILLINOIS
DEPARTMENT OF TRANSPORTATION

LIGHTING REMOVAL PLAN
I-57 HIGH MAST LIGHTING IMPROVEMENTS US 30 TO 183RD STREET

SCALE: SHEET OF SHEETS STA.

REVISED SHEET 9/13/2023

LT-10

F.A.P. RTE.	SECTION	COUNTY	TOTAL SHEETS	SHEET NO.
57	2022 TRAFFIC LT	COOK	77	30
CONTRACT NO. 62U48			ILLINOIS FED. AID PROJECT	

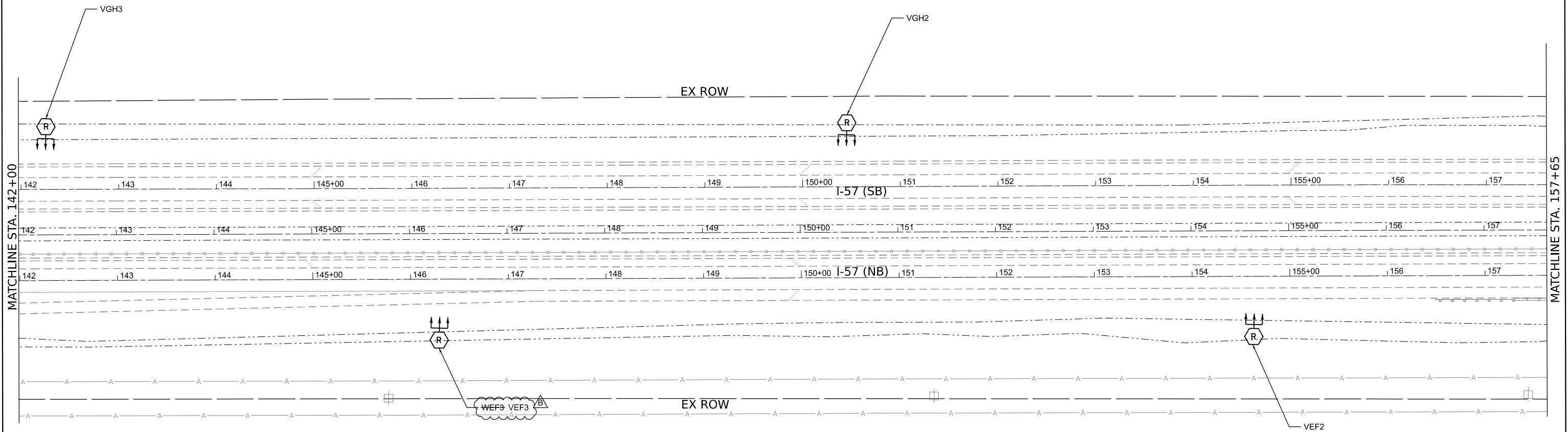
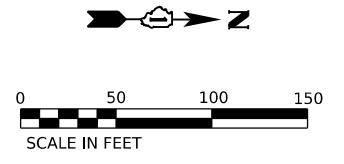

MODEL: Default
FILE NAME: J:\1823\07204_CADD\CADD_Sheets\Drawings\Sheet\11-LT-11.dgn



USER NAME = vnunez	DESIGNED - VN/MAG	REVISED - ADDENDUM B 9/12/2023
DRAWN - MAG	CHECKED - MG	REVISED -
PLOT SCALE = 100.3497' / in.	DATE - 6/30/2023	REVISED -
PLOT DATE = 9/12/2023		

**STATE OF ILLINOIS
DEPARTMENT OF TRANSPORTATION**

**LIGHTING REMOVAL PLAN
I-57 HIGH MAST LIGHTING IMPROVEMENTS US 30 TO 183RD STREET**

2 REVISED SHEET 9/13/2023 **LT-11**

F.A.P. RTE.	SECTION	COUNTY	TOTAL SHEETS	SHEET NO.
57	2022 TRAFFIC LT	COOK	77	31
CONTRACT NO. 62U48			ILLINOIS FED. AID PROJECT	

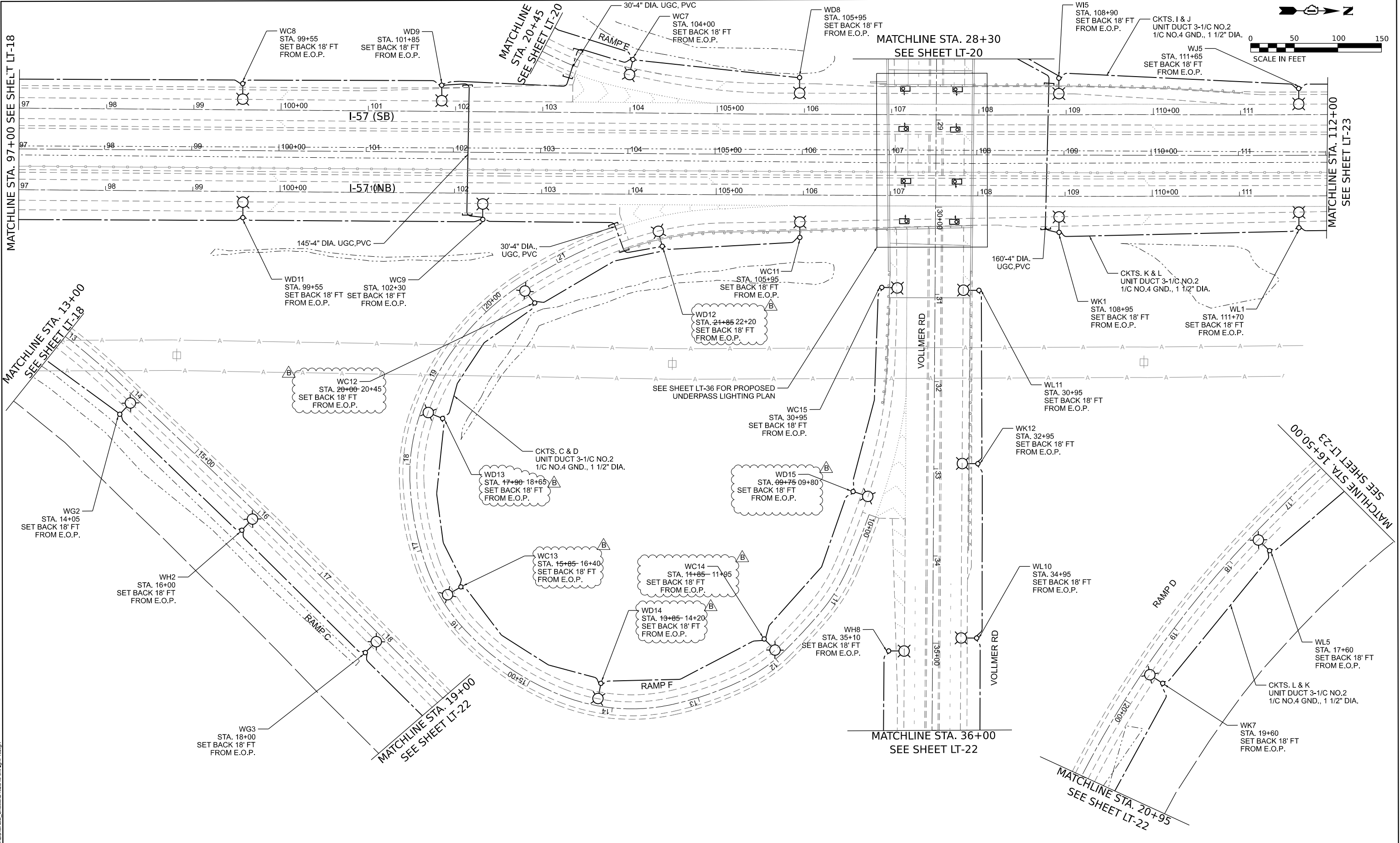

MATCHLINE STA. 97+00 SEE SHEET LT-18

MATCHLINE STA. 13+00
SEE SHEET LT-18

MATCHLINE
STA. 20+45
SEE SHEET LT-20

MATCHLINE STA. 28+30
SEE SHEET LT-20

MATCHLINE STA. 112+00
SEE SHEET LT-23

MATCHLINE STA. 16+50+00
SEE SHEET LT-23

MATCHLINE STA. 19+00
SEE SHEET LT-22

MATCHLINE STA. 36+00
SEE SHEET LT-22

MATCHLINE STA. 20+95
SEE SHEET LT-22

REVISI**ED** SHEET 9/13/2023

LT-19

MODEL: Default
FILE NAME: J:\18235\0204_CADD\CADD_Sheets\LT19\LT19.dgn



USER NAME = vnunez	DESIGNED - VN/MAG	REVISED - ADDENDUM B 9/12/2023
PLOT SCALE = 100.3497' / in.	DRAWN - MAG	REVISED -
PLOT DATE = 9/12/2023	CHECKED - MG	REVISED -
	DATE - 6/30/2023	REVISED -

**STATE OF ILLINOIS
DEPARTMENT OF TRANSPORTATION**

**PROPOSED LIGHTING PLAN
I-57 HIGH MAST LIGHTING IMPROVEMENTS US 30 TO 183RD STREET**

SCALE: SHEET 10 OF SHEETS STA.

F.A.P. RTE.	SECTION	COUNTY	TOTAL SHEETS	SHEET NO.
57	2022 TRAFFIC LT	COOK	77	39
				CONTRACT NO. 62U48
		ILLINOIS FED. AID PROJECT		

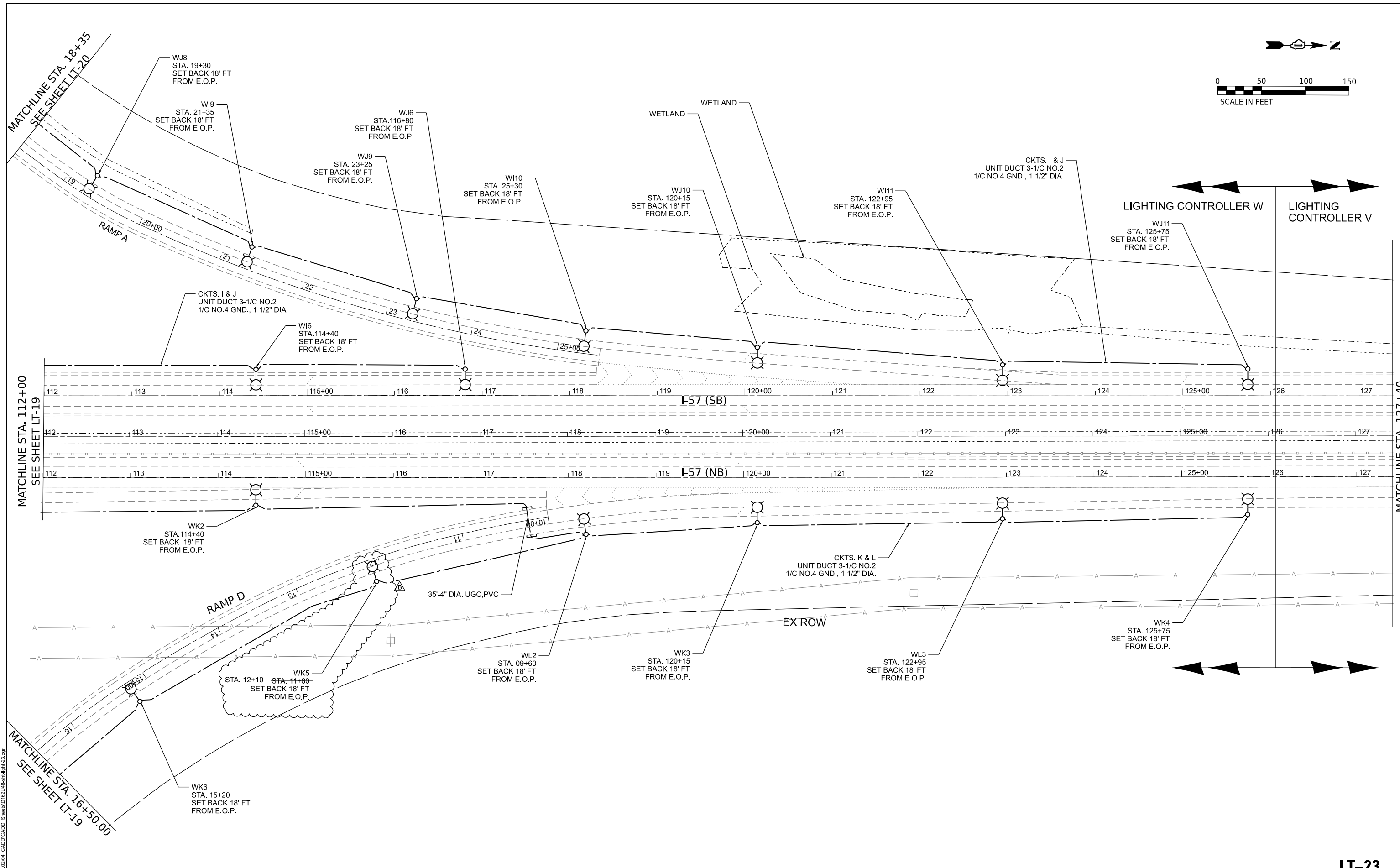
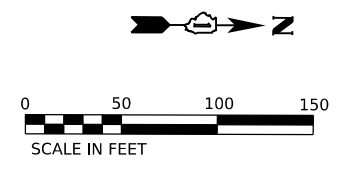

LIGHTING CONTROLLER W LIGHTING CONTROLLER V

MATCHLINE STA. 112+00
SEE SHEET LT-19

MATCHLINE STA. 127+40

MATCHLINE STA. 16+50.00
SEE SHEET LT-19

MODEL: D:\Illin\...
FILE NAME: J:\2023\2023-04-CADD\CADD_Sheets\162\162.dwg



USER NAME = vnunez	DESIGNED - VN/MAG	REVISED - ADDENDUM B 9/12/2023
DRAWN - MAG	REVISIONS	
PLOT SCALE = 100,0000' / in.	CHECKED - MG	REVISIONS
PLOT DATE = 9/12/2023	DATE - 6/30/2023	REVISIONS

STATE OF ILLINOIS
DEPARTMENT OF TRANSPORTATION

PROPOSED LIGHTING PLAN
I-57 HIGH MAST LIGHTING IMPROVEMENTS US 30 TO 183RD STREET

SCALE: SHEET OF SHEETS STA.

F.A.P. RTE.	SECTION	COUNTY	TOTAL SHEETS	SHEET NO.
57	2022 TRAFFIC LT	COOK	77	43
CONTRACT NO. 62U48				
ILLINOIS FED. AID PROJECT				

LT-23

LOAD TABLE							
LIGHTING CONTROLLER "W", 240/480V, 1-Φ, 3-WIRE							
RED PHASE	NO. LUM. *	AMPS	WATTS	BLACK PHASE	NO. LUM. *	AMPS	WATTS
A	10-260W 1-100W	11.25	2700.0	B	10-260W 1-100W	11.25	2700.0
C	15-260W 2-100W	17.08	4100.0	D	15-260W 2-100W	17.08	4100.0
E	6-260W	6.50	1560.0	F	6-260W	6.50	1560.0
G	9-260W	9.75	2340.0	H	8-260W	8.67	2080.0
I	11-260W	11.92	2860.0	J	11-260W	11.92	2860.0
K	12-260W 2-100W	13.83	3320.0	L	11-260W 2-100W	12.75	3060.0
M	SPARE			N	SPARE		
O	SPARE			P	SPARE		
TOTAL	63-260W 5-100W	70.3	16880.0	TOTAL	61-260W 5-100W	68.2	16360.0
TOTAL CONNECTED LOAD CAPACIT 33.24 KVA							
LED H=260W; UNDERPASS=100W							

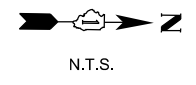

LEGEND

- PROPOSED IDOT LIGHTING UNIT, LED LUMINAIRE
- PROPOSED LIGHTING CONTROLLER, 480V, 200 AMP
- PROPOSED ELECTRIC UTILITY SERVICE
- PROPOSED UNDERPASS LIGHTING UNIT, LED
- PROPOSED UNIT DUCT

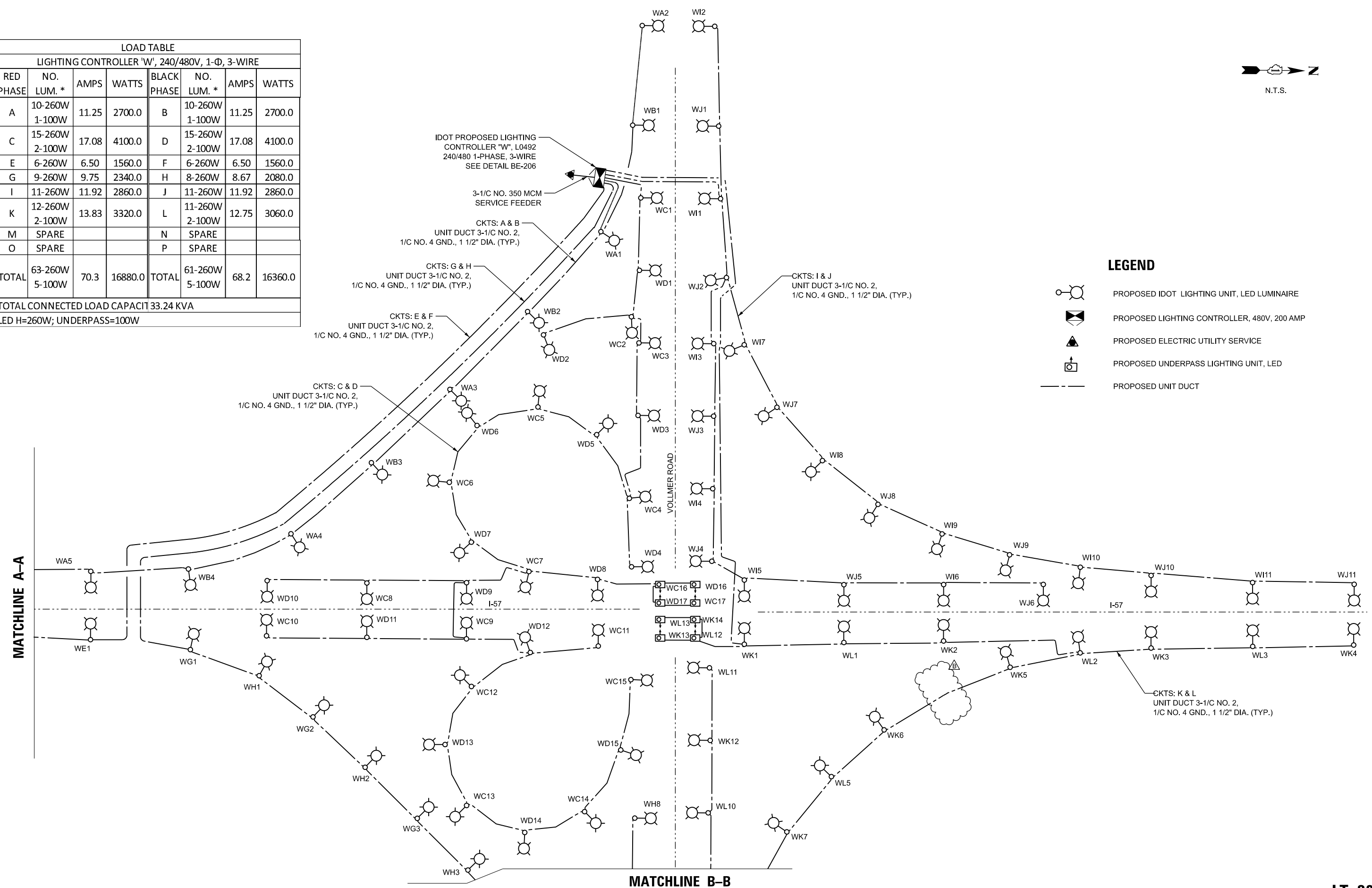

MODEL: D:\in\1... FILE NAME: J:\2325204_CADD\CADD_Sheets\162145\Lighting\LT-38.dgn



USER NAME = vnunez	DESIGNED - VN/MAG	REVISED - ADDENDUM B 9/12/2023
DRAWN - MAG	REVISIONS -	
CHECKED - MG	REVISIONS -	
DATE - 6/30/2023	REVISIONS -	

STATE OF ILLINOIS
DEPARTMENT OF TRANSPORTATION

**LIGHTING CONTROLLER "W" WIRING DIAGRAM
(SHEET 1 OF 2)**

SCALE: SHEET OF SHEETS STA.

F.A.P. RTE.	SECTION	COUNTY	TOTAL SHEETS	SHEET NO.
57	2022 TRAFFIC LT	COOK	77	58
CONTRACT NO. 62U48				
ILLINOIS FED. AID PROJECT				

LT-38