

STA. 1+160 TO STA. 1+260
STAGE I

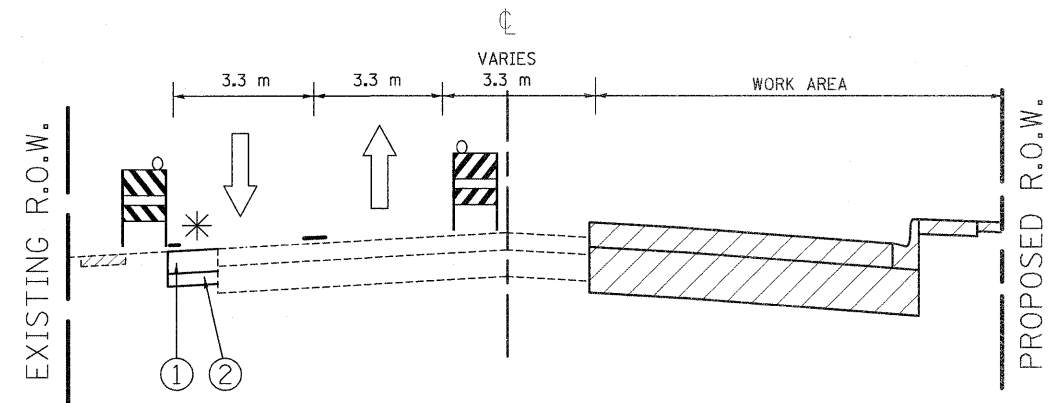

STA. 1+375 TO STA. 1+396.2
STAGE I

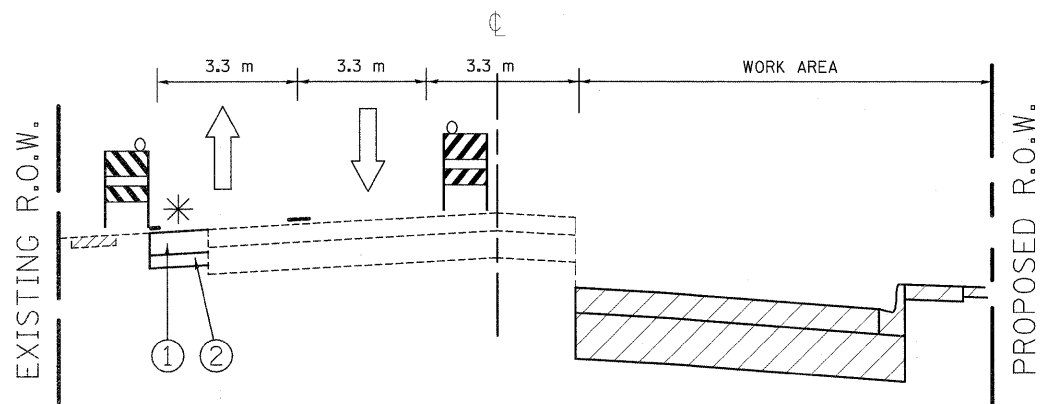

STA. 1+260 TO STA. 1+375
STAGE I

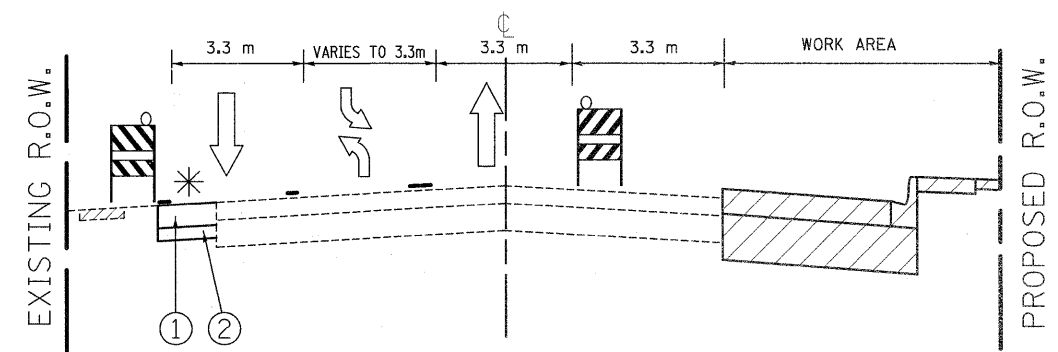

STA. 1+396.2 TO STA. 1+534
STAGE I

HOT - MIX ASPHALT MIXTURE
REQUIERMENT FOR TEMPORARY PAVEMENT

MIXTURE USES	DESIGN AIR VOIDS
HMA SURFACE COURSE MIX 'D', N50, (IL-9.5 mm), 38 mm (1½'')	4% @ 50 GYR
HMA BINDER, IL-19, N50, 120 mm (4¾'')	4% @ 50 GYR

* TEMPORARY WIDENING

① TEMPORARY PAVEMENT
(SEE MIXTURE TABLE FOR MIX REQUIREMENT)

② SUB-BASE GRANULAR MATERIAL, TYPE B, 100 mm (4'')

NOTE: WIDTH VARIES (1M TO 1.75M)

REVISIONS	
NAME	DATE

Rev. 9-7-11

ILLINOIS DEPARTMENT OF TRANSPORTATION
IL-50
TYPICAL CROSS SECTIONS FOR SUGGESTED
CONSTRUCTION STAGING
STAGE I

SCALE: _____ DRAWN BY _____
DATE: 9/1/2011 CHECKED BY _____