

SUMMARY OF QUANTITIES			CONSTRUCTION TYPE CODE							
CODE NO	ITEM	UNIT	TOTAL QUANTITIES	FED/ST	FED/ST	FED/ST/CITY	FED/ST	FED/ST	CITY	FED/ST
				0004 ROADWAY (80/20)	0021 LIGHTING (80/20)	0021 TRAFFIC SIGNAL (80/10/10)	0021 SIDEWALK (80/20)	0040 RETAINING WALL (80/20)	0021 PRE-EMPTION EQUIPMENT (100% CITY)	0031 LAND-SCAPING (80/20)
M2020010	EARTHWORK EXCAVATION	CU M	15,802	15,802						
M2020050	EARTH EXCAVATION (WIDENING)	CU M	1584	1584						
M2021200	REMOVAL AND DISPOSAL OF UNSUITABLE MATERIAL	CU M	233	233						
M2070220	POROUS GRANULAR EMBANKMENT	CU M	233	233						
M2080150	TRENCH BACKFILL	CU M	1156	1156						
M2113100	TOPSOIL FURNISH AND PLACE, 100MM	SQ M	4673						4673	
M2140100	GRADING AND SHAPING DITCHES	METER	83						83	
M2500210	SEEDING, CLASS 2A	HA	0.07						0.07	
M2500400	NITROGEN FERTILIZER NUTRIENT	KG	36						36	
M2500500	PHOSPHORUS FERTILIZER NUTRIENT	KG	36						36	
M2500600	POTASSIUM FERTILIZER NUTRIENT	KG	36						36	
M2510630	EROSION CONTROL BLANKET	SQ M	627						627	
M2520110	SODDING, SALT TOLERANT	SQ M	4046						4046	
M2520200	SUPPLEMENTAL WATERING	UNIT	45						45	
M2800250	TEMPORARY EROSION CONTROL SEEDING	KG	8						8	
M2800305	TEMPORARY DITCH CHECKS	METER	16						16	
M2800400	PERIMETER EROSION BARRIER	METER	1387						1387	
M3111100	SUB-BASE GRANULAR MATERIAL, TYPE B 100MM	SQ M	707	707						
M3550500	HOT-MIX ASPHALT BASE COURSE, 200MM	SQ M	574	574						
M3560525	HOT-MIX ASPHALT BASE COURSE WIDENING, 225MM	SQ M	317	317						
M4060200	BITUMINOUS MATERIALS (PRIME COAT)	M TON	9	9						
M4060300	AGGREGATE (PRIME COAT)	M TON	46	46						
M4060400	MIXTURE FOR CRACKS, JOINTS, AND FLANGEWAYS	M TON	4	4						
M4075275	HOT-MIX ASPHALT PAVEMENT (FULL DEPTH) 275MM	SQ M	1623	1623						
M4063310	HOT-MIX ASPHALT SURFACE COURSE, MIX "C", N50	M TON	70	70						
M4063335	HOT-MIX ASPHALT SURFACE COURSE, MIX "D", N50	M TON	64	64						
M4075325	HOT-MIX ASPHALT PAVEMENT (FULL DEPTH) 325MM	SQ M	9362	9362						
M4240125	PORTLAND CEMENT CONCRETE SIDEWALK 125MM	SQ M	1505				1505			
M4063340	HOT-MIX ASPHALT SURFACE COURSE, MIX "D", N70	M TON	387	387						

SUMMARY OF QUANTITIES			CONSTRUCTION TYPE CODE							
CODE NO	ITEM	UNIT	TOTAL QUANTITIES	FED/ST	FED/ST	FED/ST/CITY	FED/ST	FED/ST	CITY	FED/ST
				0004 ROADWAY (80/20)	0021 LIGHTING (80/20)	0021 TRAFFIC SIGNAL (80/10/10)	0021 SIDEWALK (80/20)	0040 RETAINING WALL (80/20)	0021 PRE-EMPTION EQUIPMENT (100% CITY)	0031 LAND-SCAPING (80/20)
M4400750	HOT-MIX ASPHALT SURFACE REMOVAL, 50MM	SQ M	2021	2021						
M4402000	PAVEMENT REMOVAL	SQ M	8787	8787						
M4402010	DRIVEWAY PAVEMENT REMOVAL	SQ M	576	576						
M4402040	COMBINATION CURB AND GUTTER REMOVAL	METER	248	248						
M4402050	SIDEWALK REMOVAL	SQ M	372					372		
M4402530	PAVED SHOULDER REMOVAL	SQ M	1425	1425						
M4428230	CLASS D PATCHES, TYPE II, 250 MM	SQ M	190	190						
M4428330	CLASS D PATCHES, TYPE III, 250 MM	SQ M	180	180						
M4428430	CLASS D PATCHES, TYPE IV, 250 MM	SQ M	16	16						
M4812150	AGGREGATE SHOULDERS, TYPE B 150MM	SQ M	289	289						
M4816000	AGGREGATE WEDGE SHOULDER, TYPE B	M TON	23	23						
M4820600	HOT-MIX ASPHALT SHOULDER, 200 MM (8")	SQ M	28	28						
<del>M4512205</del>	<del>FURNISHING SOLDIER PILES HP SECTION</del>	<del>METER</del>	<del>261</del>							
<del>M5000205</del>	<del>REINFORCEMENT BARS, EPOXY COATED</del>	<del>KG</del>	<del>5290</del>							
<del>M5090010</del>	<del>ALUMINUM RAILING, TYPE L</del>	<del>METER</del>	<del>85</del>							
M542E128	PRECAST REINFORCED CONCRETE FLARED END SECTIONS 600MM	EACH	1	1						
M5500030	STORM SEWERS, CLASS A, TYPE 1 300MM	METER	58	58						
M5500045	STORM SEWERS, CLASS A, TYPE 1 400MM	METER	99	99						
M5500055	STORM SEWERS, CLASS A, TYPE 1 500MM	METER	125	125						
M5500430	STORM SEWERS, CLASS A, TYPE 2 300MM	METER	474	474						
M5500455	STORM SEWERS, CLASS A, TYPE 2 500MM	METER	119	119						
M5500465	STORM SEWERS, CLASS A, TYPE 2 600MM	METER	82	82						
M6010605	PIPE UNDERDRAINS 100MM	METER	110	110						
M6020180	CATCH BASINS, TYPE A, 1.2M DIAMETER, TYPE 23 FRAME AND GRATE	EACH	36	36						
M6021405	MANHOLES, TYPE A, 1.2M DIAMETER, TYPE 1 FRAME, OPEN LID	EACH	1	1						
M6021410	MANHOLES, TYPE A, 1.2M DIAMETER, TYPE 1 FRAME, CLOSED LID	EACH	23	23						
M6060500	COMBINATION CONCRETE CURB AND GUTTER, TYPE B-15.30	METER	1276	1276						
M6063600	CONCRETE MEDIAN SURFACE, 100 MM (4")	SQ M	36	36						
M6690200	NON-SPECIAL WASTE DISPOSAL	CU M	200	200						
M7030100	SHORT-TERM PAVEMENT MARKING	METER	526	526						

\* Specialty Items

Rev. 9-7-11  
Rev. 7-26-11

REVISIONS	
NAME	DATE

ILLINOIS DEPARTMENT OF TRANSPORTATION  
SUMMARY OF QUANTITIES  
IL. 50 AT COURT STREET

Rev.



F.A.P. RTE.	SECTION	COUNTY	TOTAL SHEETS	SHEET NO.
840	143 N	WILL	121	7
STA.	TO STA.			
FED. ROAD DIST. NO. 1	ILLINOIS	FED. AID PROJECT		
CONTRACT NO. - 60445				

### LEGEND

- ① EXISTING PCC PAVEMENT (+/-) 200MM
- ② EXISTING BITUMINOUS SURFACE (+/-) 190MM
- ③ EXISTING STABILIZED SHOULDER
- ④ EXISTING PCC SIDEWALK
- ⑤ PROPOSED AGGREGATE SUBGRADE 300MM (12")
- ⑥ PROPOSED HMA PAVEMENT (FULL DEPTH), 325MM (13") (SEE MIXTURE TABLE FOR MIX. REQUIREMENT)
- ⑦ PROPOSED COMBINATION CONCRETE CURB & GUTTER B-15.30 (B-6.12)
- ⑧ PROPOSED PCC SIDEWALK 125MM (5")
- ⑨ PROPOSED FURNISH AND PLACE TOP SOIL 100MM (4")
- ⑩ PROPOSED HMA SHOULDER 200MM (8")
- ⑪ PROPOSED AGGREGATE WEDGE SHOULDER TYPE B 150MM (6")
- ⑫ POROUS GRANULAR EMBANKMENT

- \* EXISTING SIDEWALK REMOVAL LOCATIONS MARKED ON THE PLANS
- \*\* MATCH THE EXISTING SIDEWALK AT STA. 1+514
- \*\*\* STA.1+470 TO STA. 1+495 (1.5 M SIDEWALK)  
STA. 1+495 TO STA. 1+520 (2.0 M SIDEWALK)
- # SUPER ELEVATION VARIES TO MATCH THE EXISTING CROSS SECTION (SEE THE CROSS SECTIONS AND THE DETAILED PROPOSED PAVEMENT ELEVATION PLAN)

HOT MIX ASPHALT MIXTURE REQUIREMENTS	
MIXTURE USES	DESIGN AIR VOIDS
HMA SURFACE COURSE MIX "D", N70, IL-9.5mm (2"), OF FULL DEPTH PAVEMENTS)	4% @ 70 GYR.
HMA BINDER COURSE IL-19mm, N70, 275mm (11") AND 225mm (9") HMA BINDER (IL-19mm)	4% @ 70 GYR.
HMA BASE COURSE, 225mm (9") & 200mm (8") HMA BINDER (IL-19mm)	4% @ 50 GYR.
HMA SHOULDER, 200mm (8"), (BINDER COURSE IL-19mm)	4% @ 70 GYR.
HMA SURFACE COURSE MIX "C", N50, 50mm (2"), IL-9.5mm (3/8")	4% @ 50 GYR.
HMA SURFACE COURSE MIX "D", N50, 38mm (1 1/2"), IL-9.5mm (3/8")	4% @ 50 GYR.
CLASS "D" PATCHES, (HMA BINDER), IL-19mm, (3/4")	4% @ 70 GYR.

**NOTES:**

THE UNIT WEIGHT USED TO CALCULATE ALL HMA SURFACE MIXTURE QUANTITIES IS 112 LBS/SQ YD/IN.

**AC TYPE NOTE**

"THE "AC TYPE" FOR POLYMERIZED HMA MIXES SHALL BE "SBS/SBR PG 70-22" AND FOR NON-POLYMERIZED HMA THE "AC TYPE" SHALL BE "PG 64-22" UNLESS MODIFIED BY DISTRICT ONE SPECIAL PROVISIONS."  
"FOR "PERCENT OF RAP" SEE DISTRICT ONE SPECIAL PROVISIONS."

CONTRACTOR SHALL MILL BEFORE PATCHING.

Rev. 9-7-11

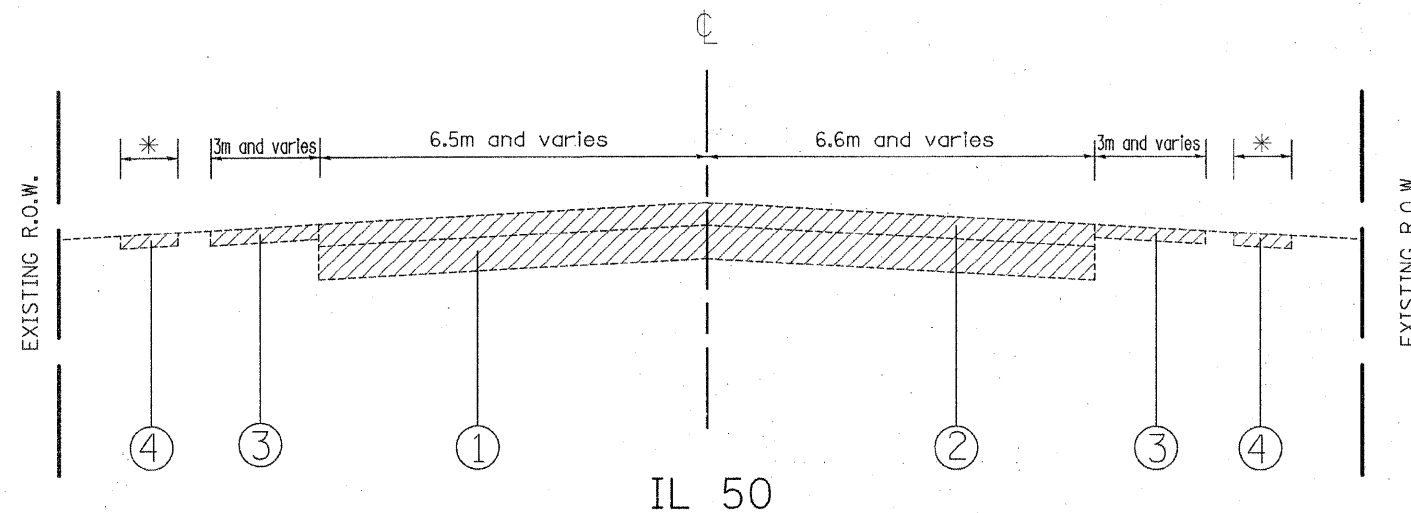

EXISTING TYPICAL CROSS SECTION  
STA. 1+160 TO STA. 1+640

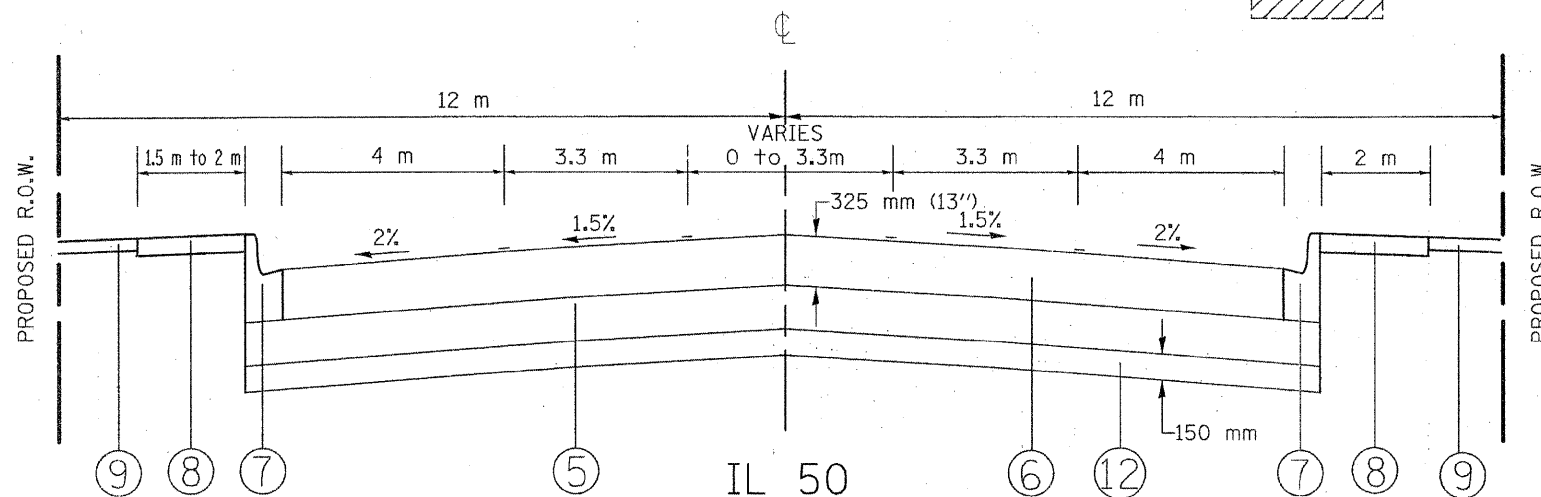
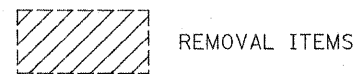

PROPOSED TYPICAL CROSS SECTION  
STA. 1+160 TO STA. 1+265

(X) NOTE: PGES (FULL WIDTH) FROM STA. 1+160 TO STA. 1+250 ONLY

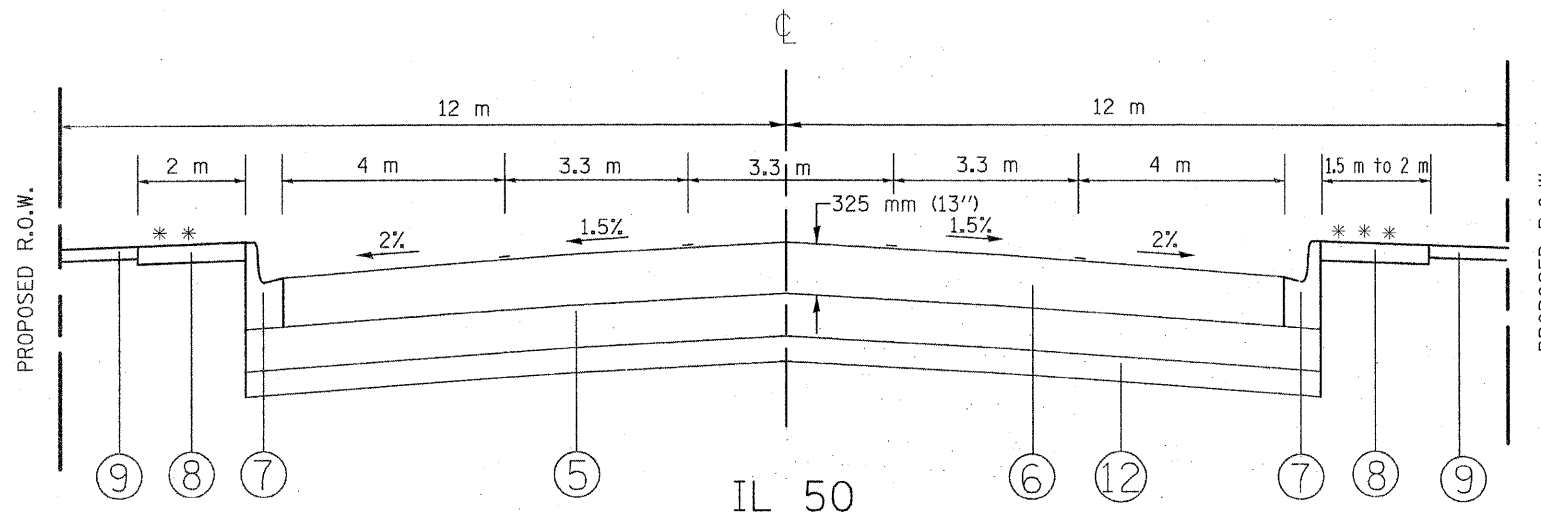

PROPOSED TYPICAL CROSS SECTION  
STA. 1+265 TO STA. 1+521

TO DRAIN THE AGGREGATE SUB GRADE 300 mm, PROVIDE 100 mm DIAMETER TRAVERSE PIPE UNDER DRAIN AT 90 METER SPACING.

REVISIONS	
NAME	DATE

ILLINOIS DEPARTMENT OF TRANSPORTATION  
IL - 50 (GOVERNOR'S HIGHWAY)  
TYPICAL CROSS SECTION  
SCALE: NONE  
DATE: 8/17/2011  
DRAWN BY  
CHECKED BY

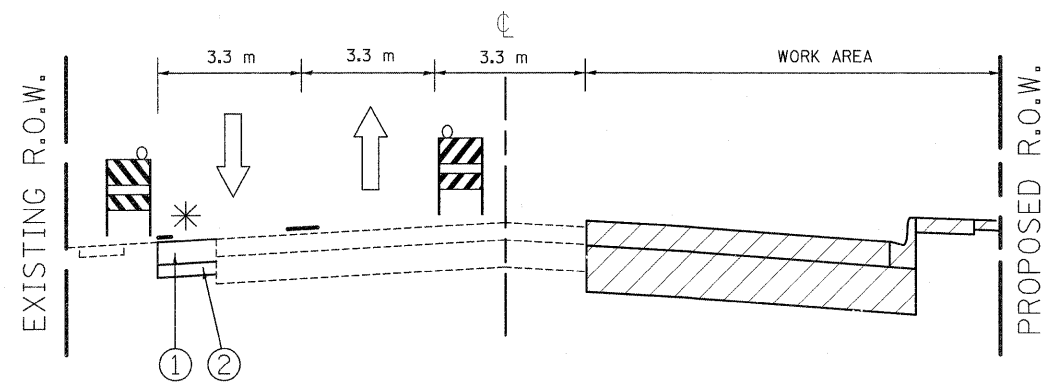

STA. 1+160 TO STA. 1+260  
STAGE I

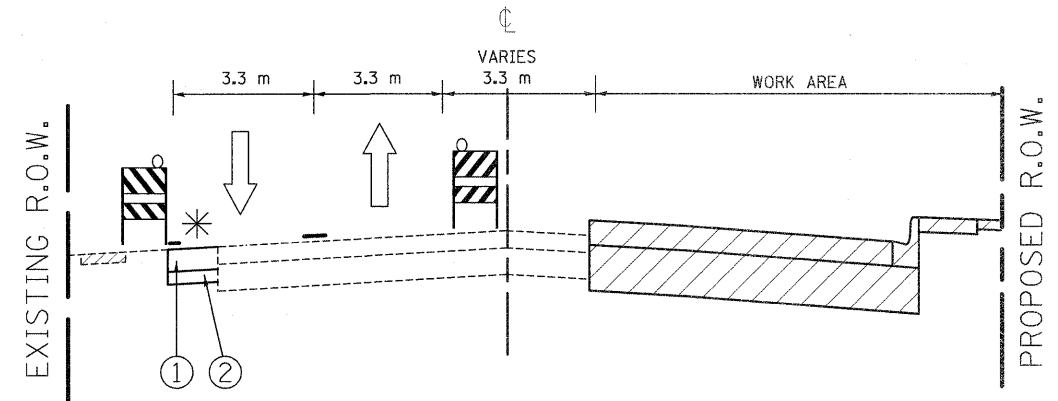

STA. 1+375 TO STA. 1+396.2  
STAGE I

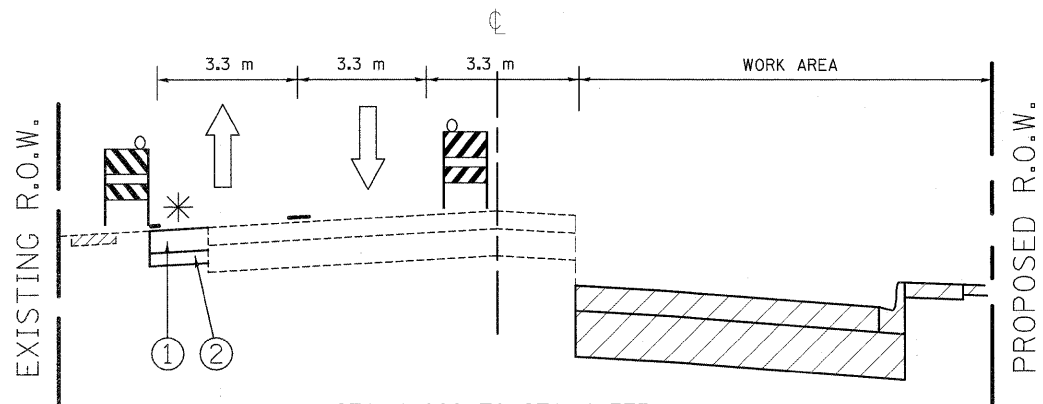

STA. 1+260 TO STA. 1+375  
STAGE I

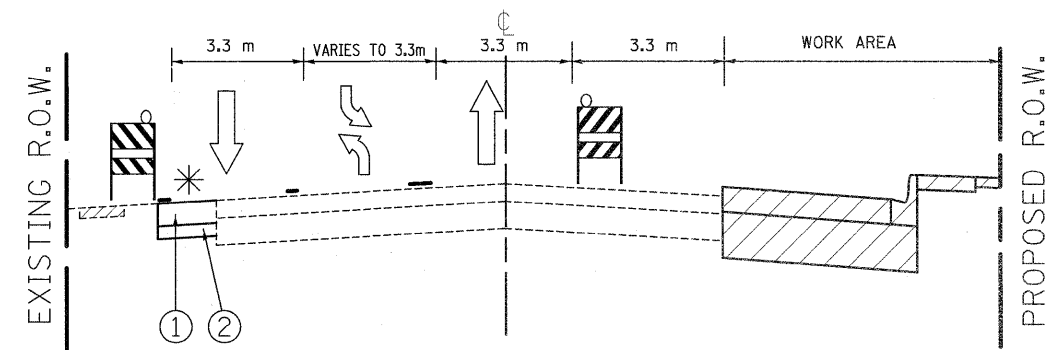

STA. 1+396.2 TO STA. 1+534  
STAGE I

HOT - MIX ASPHALT MIXTURE  
REQUIERMENT FOR TEMPORARY PAVEMENT

MIXTURE USES	DESIGN AIR VOIDS
HMA SURFACE COURSE MIX 'D', N50, (IL-9.5 mm), 38 mm (1½'')	4% @ 50 GYR
HMA BINDER, IL-19, N50, 120 mm (4¾'')	4% @ 50 GYR

\* TEMPORARY WIDENING

① TEMPORARY PAVEMENT  
(SEE MIXTURE TABLE FOR MIX REQUIREMENT)

② SUB-BASE GRANULAR MATERIAL, TYPE B, 100 mm (4'')

NOTE: WIDTH VARIES (1M TO 1.75M)

REVISIONS	
NAME	DATE

Rev. 9-7-11

**ILLINOIS DEPARTMENT OF TRANSPORTATION**  
**IL-50**  
TYPICAL CROSS SECTIONS FOR SUGGESTED  
CONSTRUCTION STAGING  
STAGE I

SCALE: \_\_\_\_\_ DRAWN BY \_\_\_\_\_  
DATE: 9/1/2011 CHECKED BY \_\_\_\_\_







F.A.P. RTE.	SECTION	COUNTY	TOTAL SHEETS	SHEET NO.
840	143 N	WILL	121	19
STA.		TO STA.		
FED. ROAD DIST. NO. 1		ILLINOIS FED. AID PROJECT		
CONTRACT NO. - 60445				

**STAGES OF CONSTRUCTION AND TRAFFIC CONTROL**

GENERAL NOTES

- 1 THE STAGES OF CONSTRUCTION AND TRAFFIC CONTROL PLAN SHOWN FOR THIS CONTRACT SHALL SERVE AS A GUIDE FOR SAFE DIVERSION OF TRAFFIC DURING EXECUTION OF THIS CONTRACT. THE CONTRACTOR MAY IMPROVE OR MODIFY THE TRAFFIC CONTROL PLANS FOR CONSTRUCTION NEEDS. THE CONTRACTOR'S PROPOSED TRAFFIC CONTROL PLANS/REVISIONS SHALL BE SUBMITTED IN ADVANCE FOR THE APPROVAL OF THE ENGINEER.
- 2 THE CONTRACTOR SHALL MAINTAIN A MINIMUM OF ONE THROUGH TRAFFIC LANE IN EACH DIRECTION THROUGH THE PROJECT AREA AT ALL TIMES. THE CONTRACTOR SHALL BE REQUIRED TO MAINTAIN TRAFFIC IN ACCORDANCE WITH THE SPECIAL PROVISIONS, APPLICABLE STATE STANDARDS, AND AS DIRECTED BY THE ENGINEER.
- 3 THE EXACT NUMBER, LOCATION AND SPACING OF ALL SIGNS AND TRAFFIC CONTROL DEVICES MAY BE ADJUSTED TO FIT FIELD CONDITIONS AS DIRECTED BY THE ENGINEER. EXISTING STOP SIGNS AND HIGHWAY SIGNS ALONG ILLINOIS ROUTE 50 AT COURT STREET SHALL BE RELOCATED TO CONTROL THE TRAFFIC FOR THE VARIOUS STAGES OF CONSTRUCTION AS SHOWN ON THE STAGING PLANS OR AS DIRECTED BY THE ENGINEER.
- 4 ALL DRIVEWAYS AND SIDEWALKS TO HOUSES AND BUSINESSES AND CROSSROADS SHALL REMAIN IN SERVICE THROUGHOUT THE LIFE OF THIS CONTRACT AND SHALL BE CONSTRUCTED IN STAGES, AS SHOWN ON THE CONSTRUCTION STAGING PLANS AND DISTRICT DETAILS FOR TEMPORARY ACCESS DRIVES AND SIDE STREETS. NO RESIDENTIAL OR COMMERCIAL DRIVEWAYS SHALL BE CLOSED OR REMOVED FROM SERVICE WITHOUT PRIOR APPROVAL OF ENGINEER. STORM SEWER SYSTEMS AND DITCHES SHALL BE MAINTAINED AT ALL TIMES EXCEPT AT PERIODS OF CONNECTING TO THE PROPOSED STORM SEWER LINES. ALL COMMERCIAL ENTRANCES SHALL HAVE "ENTRANCE" SIGN THROUGH OUT THE CONSTRUCTION DURATION.
- 5 THE CONTRACTOR SHALL PROVIDE ALL BARRIERS, SIGNS AND TEMPORARY SIGNALS NECESSARY FOR THE MAINTENANCE OF TRAFFIC, UNLESS IDENTIFIED IN THE SPECIAL PROVISIONS. "STOP HERE ON RED" AND DO NOT PASS" SIGNS SHALL BE USED AS NECESSARY AS DIRECTED BY THE ENGINEER.
- 6 REMOVE EXISTING PAVEMENT MARKINGS IF IN CONFLICT WITH THE TEMPORARY PAVEMENT MARKINGS FOR TRAFFIC CONTROL AND PROTECTION PLANS AND SHALL BE PAID FOR AS PAVEMENT MARKING REMOVAL. SQUARE METER TEMPORARY PAVEMENT MARKINGS SHALL BE PROVIDED FOR ALL LOCATIONS AS SHOWN ON THE CONSTRUCTION STAGING PLANS OR AS DIRECTED BY THE ENGINEER. TEMPORARY PAVEMENT MARKING TAPE. TYPE III SHALL BE USED ON FINISHED SURFACES AND ON THE APPROACHES TO THE CONSTRUCTION AREA.
- 7 TAPER LENGTH FOR TRAFFIC CONTROL DEVICES IS DEFINED BY:  
 $L = WS^2/150$  WHERE L = TAPER LENGTH IN METERS  
W = WIDTH OF OFFSET IN METERS  
S = POSTED SPEED IN K.P.H.
- 8 ADEQUATE TURNING RADII FOR VEHICLES, INCLUDING TRUCKS AND BUSES SHALL BE MAINTAINED AT ALL INTERSECTIONS DURING CONSTRUCTION OPERATIONS.
- 9 CHANGEABLE MESSAGE SIGNS SHALL BE USED AND ITS PLACEMENT SHALL BE AS DIRECTED BY THE ENGINEER AND SHALL BE PAID FOR AS "CHANGEABLE MESSAGE SIGN" PER CALENDAR MONTH.
- 10 ALL TRAFFIC CONTROL DEVICES SHALL CONFORM TO THE LATEST EDITION OF THE STATE OF ILLINOIS MANUAL ON UNIFORM TRAFFIC CONTROL DEVICES FOR STREETS AND HIGHWAYS, AND SHALL BE IN PLACE BEFORE ANY WORK IS STARTED.
- 11 BARRICADES/DRUMS SPACING TO BE AS FOLLOWS:  
TAPERS - 7.5 m OR 15 m C-C SPACING  
MAINLINE - 15 m C-C SPACING  
COMMERCIAL DRIVEWAY AND SIDEROAD RETURNS - 3 m C-C SPACING
- 12 ALL TEMPORARY PAVEMENT MARKINGS AND REMOVAL WILL BE PAID FOR SEPARATELY ACCORDING TO THE APPLICABLE PAY ITEMS SHOWN IN THE SUMMARY OF QUANTITIES.
- 13 THE CONTRACTOR SHALL INSTALL AND MAINTAIN TEMPORARY TRAFFIC SIGNALS AT ILL. ROUTE 50 AND COURT STREET INTERSECTION.
- 14 THE REMOVAL OF THE TEMPORARY PAVEMENT WIDENING SHALL BE PAID AS TEMPORARY PAVEMENT REMOVAL. 
- 15 TYPE I OR II BARRICADES EQUIPPED WITH MONO-DIRECTIONAL STEADY BURN LIGHTS SHALL BE PLACED AT 15 m CENTER TO CENTER INTERVALS ALONG ROADWAY, 7.5 m CENTER TO CENTER INTERVALS WITHIN THE TAPER SECTIONS AND AT 4 m INTERVALS FOR RADII AS INDICATED ON THE PLANS OR AS DIRECTED BY THE ENGINEER.
- 16 100 mm SOLID WHITE LINES SHALL BE USED TO DEFINE OUTSIDE LANE LINES DURING MAINTENANCE OF TRAFFIC WHERE NO CURB AND GUTTER EXIST.
- 17 A DOUBLE SOLID 100 mm YELLOW LINE AT 280 mm SHALL BE USED TO SEPARATE OPPOSING TRAFFIC.
- 18 TEMPORARY RAISED REFLECTIVE PAVEMENT MARKERS SHALL BE PROVIDED ALONG ALL OF THE ROADWAY CENTER LINES DURING ALL PHASES OF CONSTRUCTION. THE MARKERS SHALL BE YELLOW AND SPACED 15 m CENTER TO CENTER.
- 19 THE CONTRACTOR SHALL PROVIDE ADEQUATE TEMPORARY DRAINAGE AND EROSION PROTECTION FOR THE DURATION OF THIS PROJECT.
- 20 SIDE STREETS WILL BE CONSTRUCTED UTILIZING ALTERNATE STREET CLOSURES.
- 21 THE CONTRACTOR SHALL INFORM THE VILLAGE OF MONEE POLICE DEPT., FIRE DEPT., AND PUBLIC WORKS DEPT OF ROAD CLOSURES AT LEAST 48 HOURS IN ADVANCE OF ANTICIPATED CLOSURE TIMES. IN ADDITION, THE TRANSPORTATION DEPT. OF THE LOCAL SCHOOL SYSTEMS SHALL BE KEPT INFORMED OF ANTICIPATED ROAD CLOSURE SCHEDULES.

*Rev. 9-7-11*

REVISIONS		ILLINOIS DEPARTMENT OF TRANSPORTATION ILL. RTE. 50 STAGES OF CONSTRUCTION AND TRAFFIC CONTROL GENERAL NOTES
NAME	DATE	
		SCALE 1:500 DATE 9/1/2011 DRAWN BY CHECKED BY