

F.A.P. RTE.	SECTION	COUNTY	TOTAL SHEETS	SHEET NO.
840	143N	WILL	171	28
STA.	TO STA.		ILLINOIS FED. AID PROJECT	
FED. ROAD DIST. NO.			CONTRACT NO. - 60445	

NOTE:
FOR TRAFFIC CONTROL & PROTECTION USE STATE STD. #701301, 701606, 701701 AND DIST. DETAILS FOR SIDE ROAD, INTERSECTION AND DRIVEWAYS.

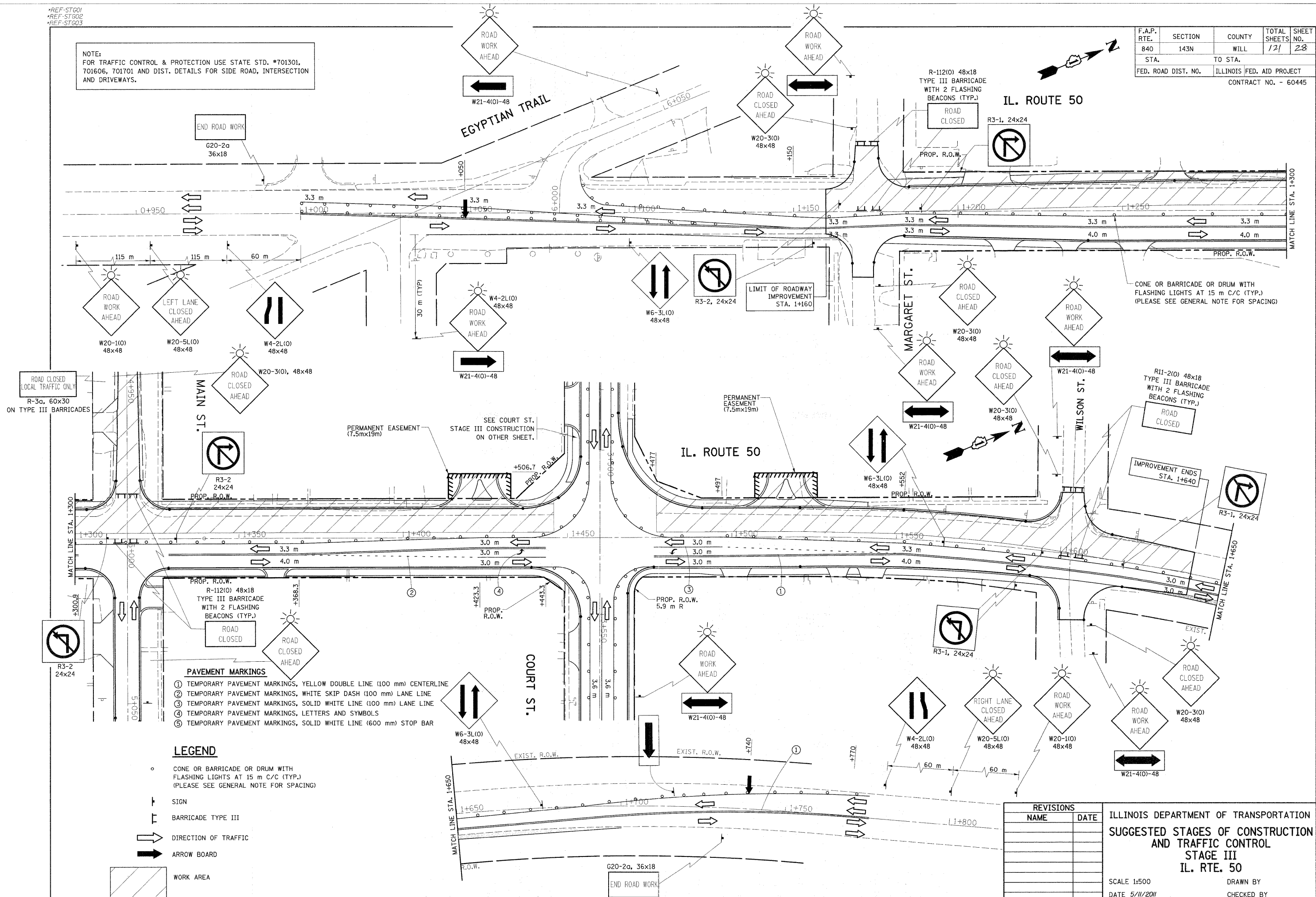

- PAVEMENT MARKINGS**
- TEMPORARY PAVEMENT MARKINGS, YELLOW DOUBLE LINE (100 mm) CENTERLINE
 - TEMPORARY PAVEMENT MARKINGS, WHITE SKIP DASH (100 mm) LANE LINE
 - TEMPORARY PAVEMENT MARKINGS, SOLID WHITE LINE (100 mm) LANE LINE
 - TEMPORARY PAVEMENT MARKINGS, LETTERS AND SYMBOLS
 - TEMPORARY PAVEMENT MARKINGS, SOLID WHITE LINE (600 mm) STOP BAR

- LEGEND**
- CONE OR BARRICADE OR DRUM WITH FLASHING LIGHTS AT 15 m C/C (TYP.) (PLEASE SEE GENERAL NOTE FOR SPACING)
 - SIGN
 - BARRICADE TYPE III
 - DIRECTION OF TRAFFIC
 - ARROW BOARD
 - WORK AREA

REVISIONS	
NAME	DATE

ILLINOIS DEPARTMENT OF TRANSPORTATION
SUGGESTED STAGES OF CONSTRUCTION
AND TRAFFIC CONTROL
STAGE III
IL. RTE. 50

SCALE 1:500
DATE 5/11/2011
DRAWN BY
CHECKED BY