

F.A.P. RTE.	SECTION	COUNTY	TOTAL SHEETS	SHEET NO.
840	143N	WILL	121	43
STA. 3+400		TO STA. 3+675		
FED. ROAD DIST. NO.		ILLINOIS FED. AID PROJECT		

NOTE: TREE DIMENSIONS ARE IN MILLIMETERS.

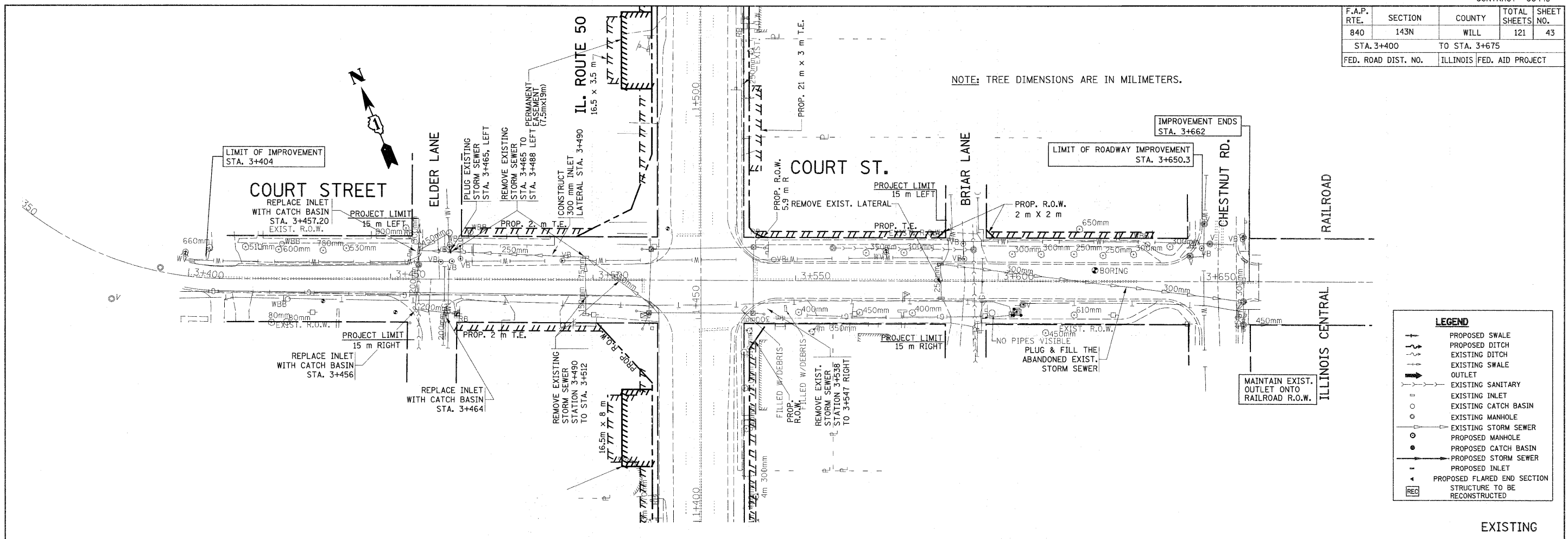

LEGEND

- PROPOSED SWALE
- - - PROPOSED DITCH
- - - EXISTING DITCH
- - - EXISTING SWALE
- OUTLET
- EXISTING SANITARY
- EXISTING INLET
- EXISTING CATCH BASIN
- EXISTING MANHOLE
- EXISTING STORM SEWER
- PROPOSED MANHOLE
- PROPOSED CATCH BASIN
- PROPOSED STORM SEWER
- PROPOSED INLET
- △ PROPOSED FLARED END SECTION
- REC STRUCTURE TO BE RECONSTRUCTED

EXISTING

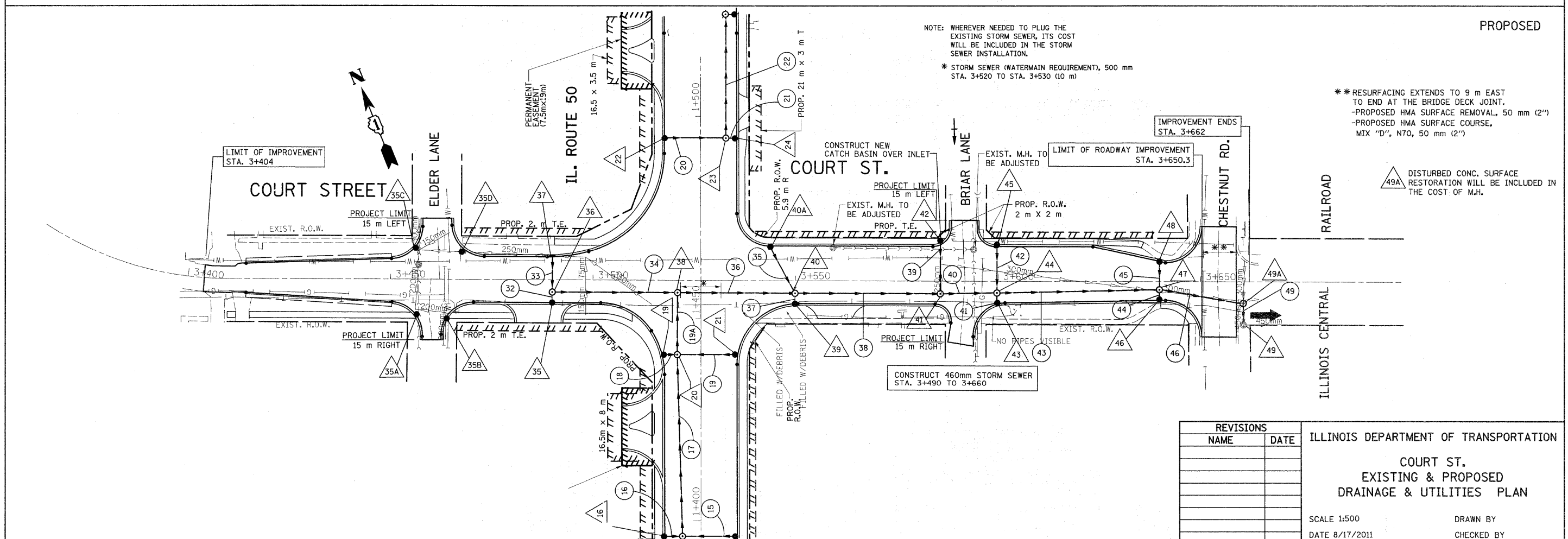

NOTE: WHEREVER NEEDED TO PLUG THE EXISTING STORM SEWER, ITS COST WILL BE INCLUDED IN THE STORM SEWER INSTALLATION.
 * STORM SEWER (WATERMAIN REQUIREMENT), 500 mm STA. 3+520 TO STA. 3+530 (10 m)

* RESURFACING EXTENDS TO 9 m EAST TO END AT THE BRIDGE DECK JOINT.
 - PROPOSED HMA SURFACE REMOVAL, 50 mm (2")
 - PROPOSED HMA SURFACE COURSE, MIX "D", N70, 50 mm (2")

△ 49A DISTURBED CONC. SURFACE RESTORATION WILL BE INCLUDED IN THE COST OF M.H.

PROPOSED

REVISIONS		ILLINOIS DEPARTMENT OF TRANSPORTATION
NAME	DATE	
		COURT ST. EXISTING & PROPOSED DRAINAGE & UTILITIES PLAN

SCALE 1:500
DATE 8/17/2011
DRAWN BY
CHECKED BY