

F.A.P. RTE.	SECTION	COUNTY	TOTAL SHEETS	SHEET NO.
840	143N	WILL	121	44
STA. 4+900		TO STA. 5+150		
FED. ROAD DIST. NO.		ILLINOIS FED. AID PROJECT		

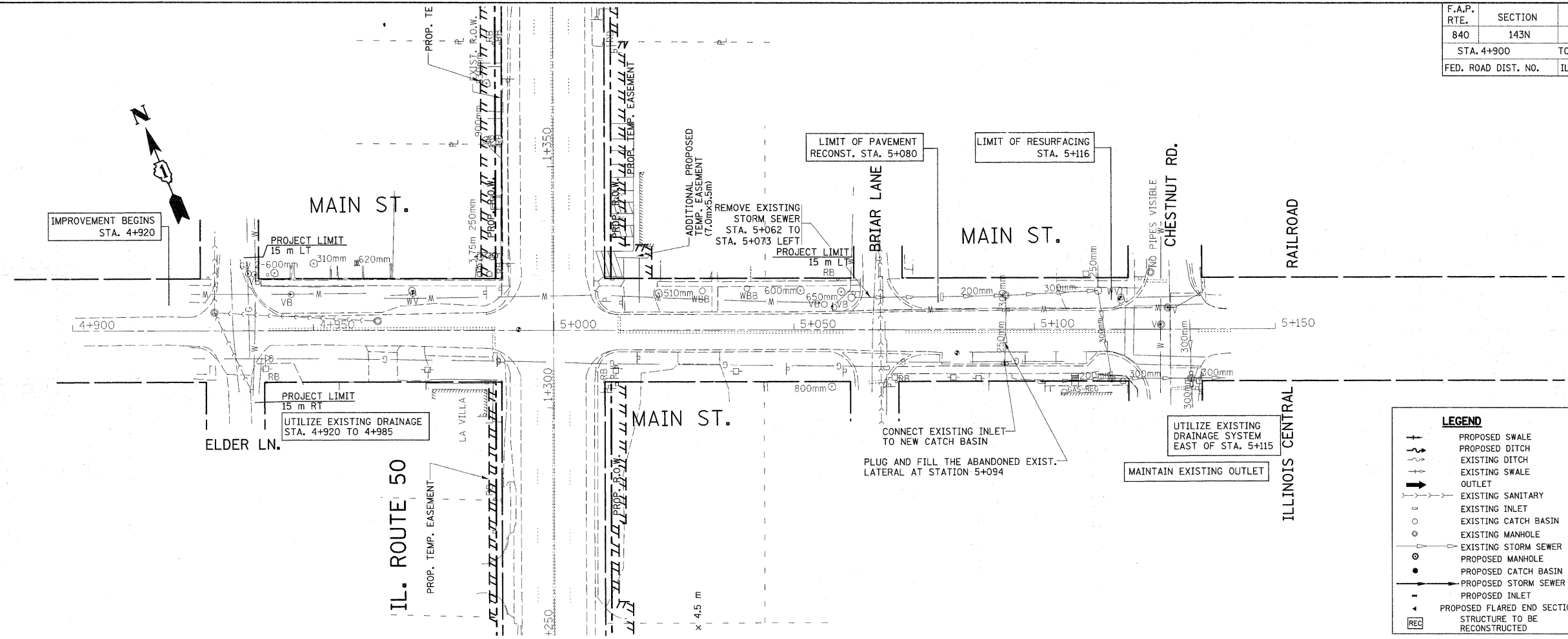

LEGEND

	PROPOSED SWALE
	PROPOSED DITCH
	EXISTING DITCH
	EXISTING SWALE
	OUTLET
	EXISTING SANITARY
	EXISTING INLET
	EXISTING CATCH BASIN
	EXISTING MANHOLE
	EXISTING STORM SEWER
	PROPOSED MANHOLE
	PROPOSED CATCH BASIN
	PROPOSED STORM SEWER
	PROPOSED INLET
	PROPOSED FLARED END SECTION
	STRUCTURE TO BE RECONSTRUCTED

EXISTING

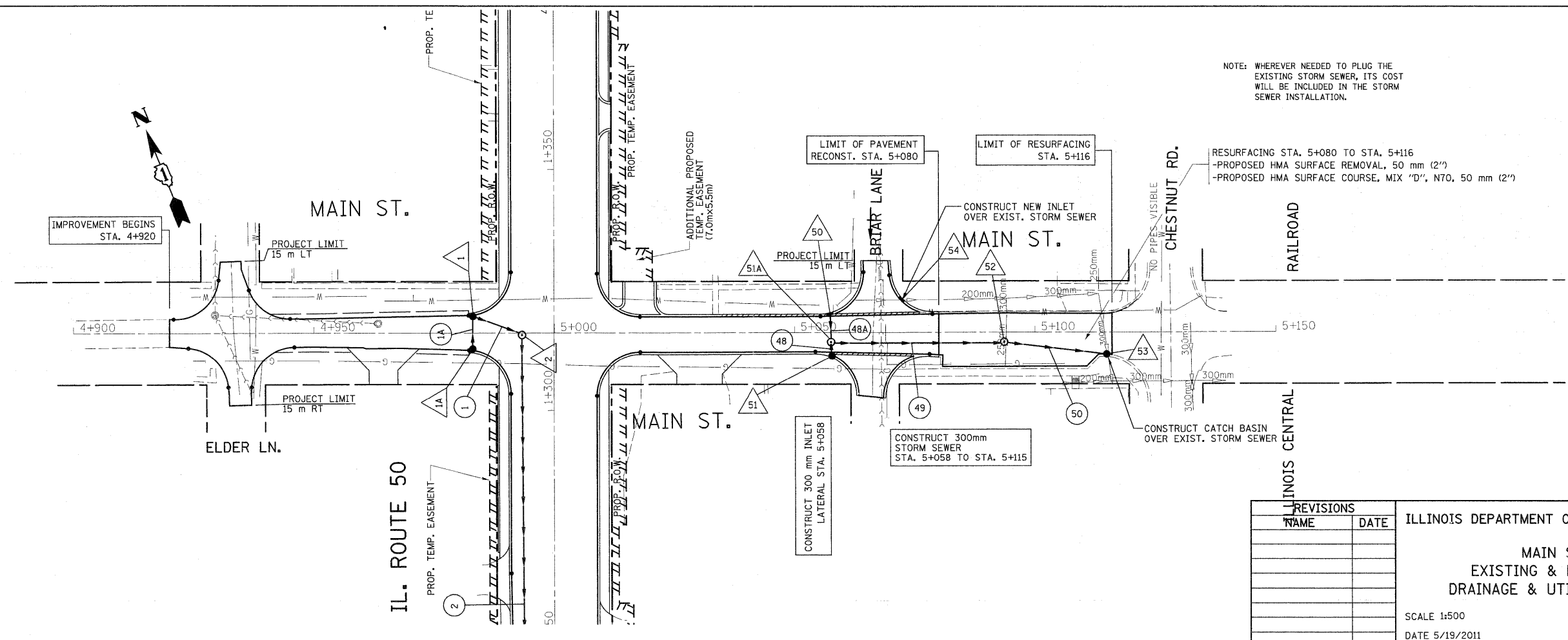

PROPOSED

NOTE: WHEREVER NEEDED TO PLUG THE EXISTING STORM SEWER, ITS COST WILL BE INCLUDED IN THE STORM SEWER INSTALLATION.

RESURFACING STA. 5+080 TO STA. 5+116
 -PROPOSED HMA SURFACE REMOVAL, 50 mm (2")
 -PROPOSED HMA SURFACE COURSE, MIX "D", N70, 50 mm (2")

REVISIONS

NO.	NAME	DATE

ILLINOIS DEPARTMENT OF TRANSPORTATION

**MAIN ST.
 EXISTING & PROPOSED
 DRAINAGE & UTILIES PLAN**

SCALE 1:500
 DATE 5/19/2011

DRAWN BY
 CHECKED BY