

F.A.P. RTE.	SECTION	COUNTY	TOTAL SHEETS	SHEET NO.
840	143N	WILL	129	55
STA.		TO STA.		
FED. ROAD DIST. NO.		ILLINOIS FED. AID PROJECT		

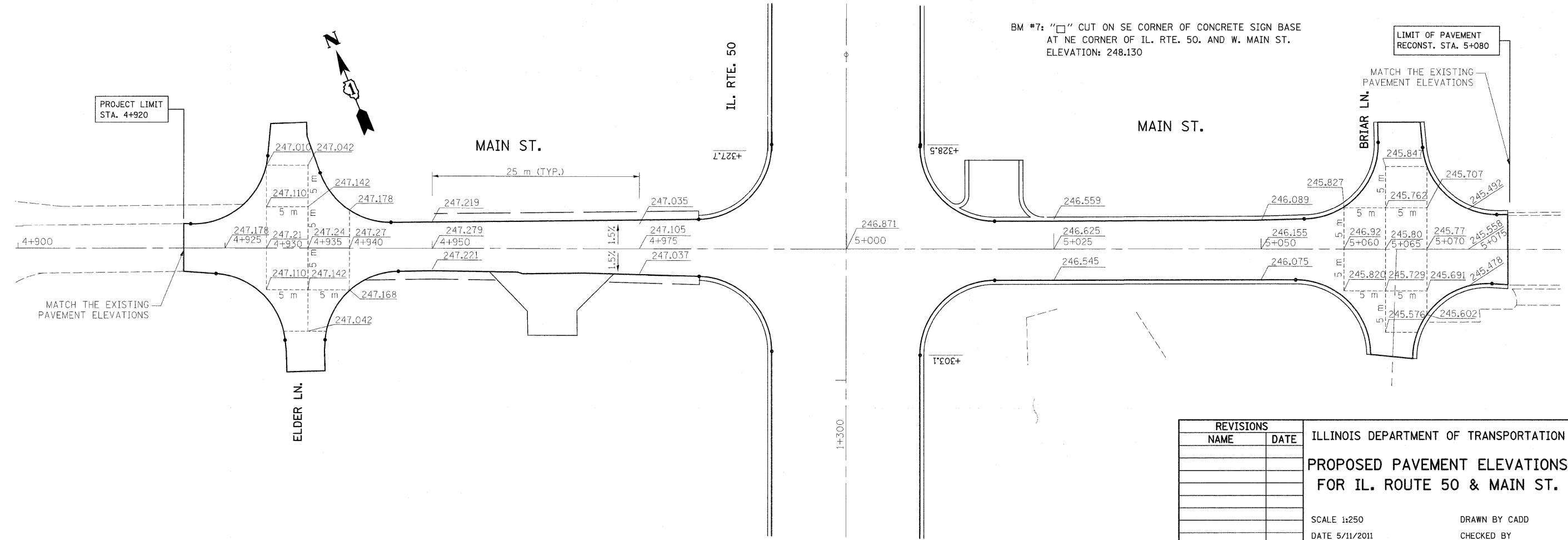
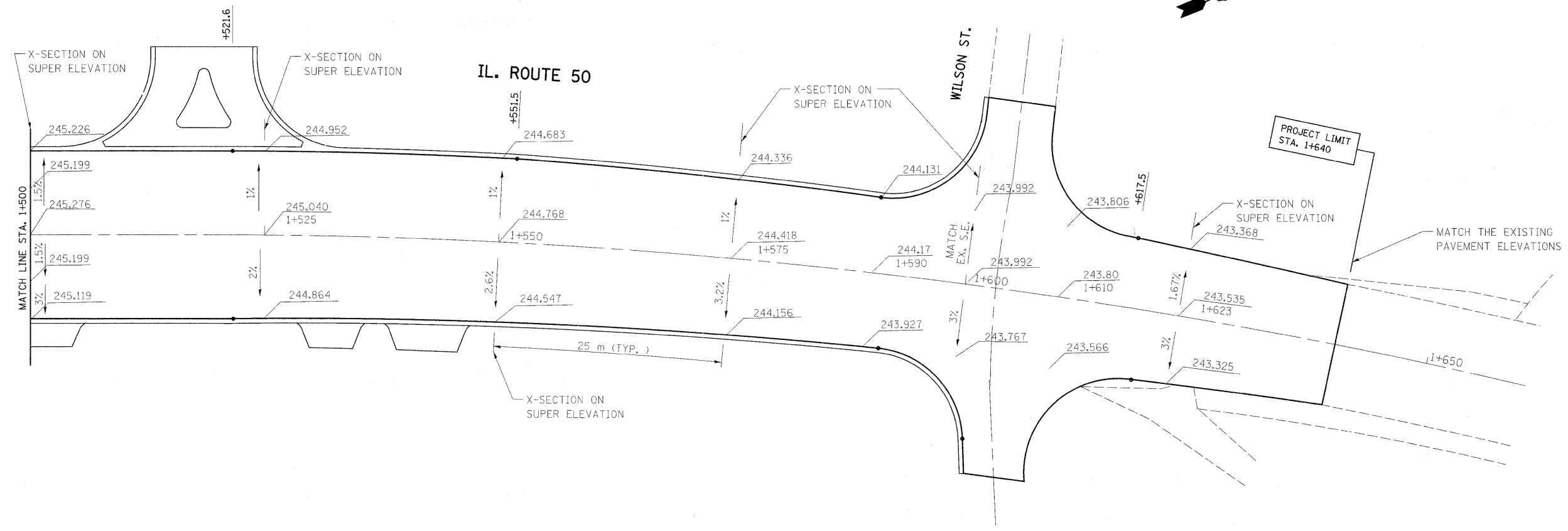

REVISIONS	
NAME	DATE

ILLINOIS DEPARTMENT OF TRANSPORTATION

PROPOSED PAVEMENT ELEVATIONS FOR IL. ROUTE 50 & MAIN ST.

SCALE 1:250

DATE 5/11/2011

DRAWN BY CADD

CHECKED BY