

F.A.P. RTE.	SECTION	COUNTY	TOTAL SHEETS	SHEET NO.
840		WILL	12	58
STA.		TO STA.		
FED. ROAD DIST. NO.		ILLINOIS	FED. AID PROJECT	

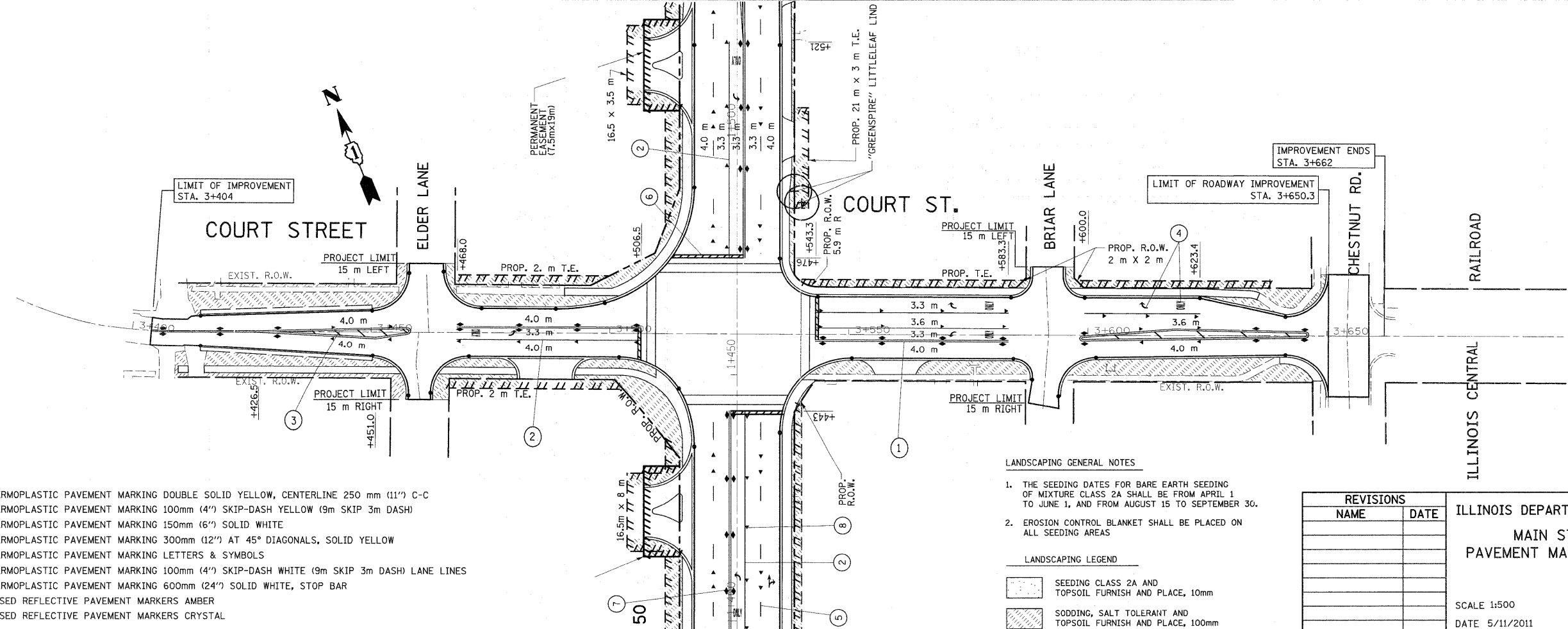
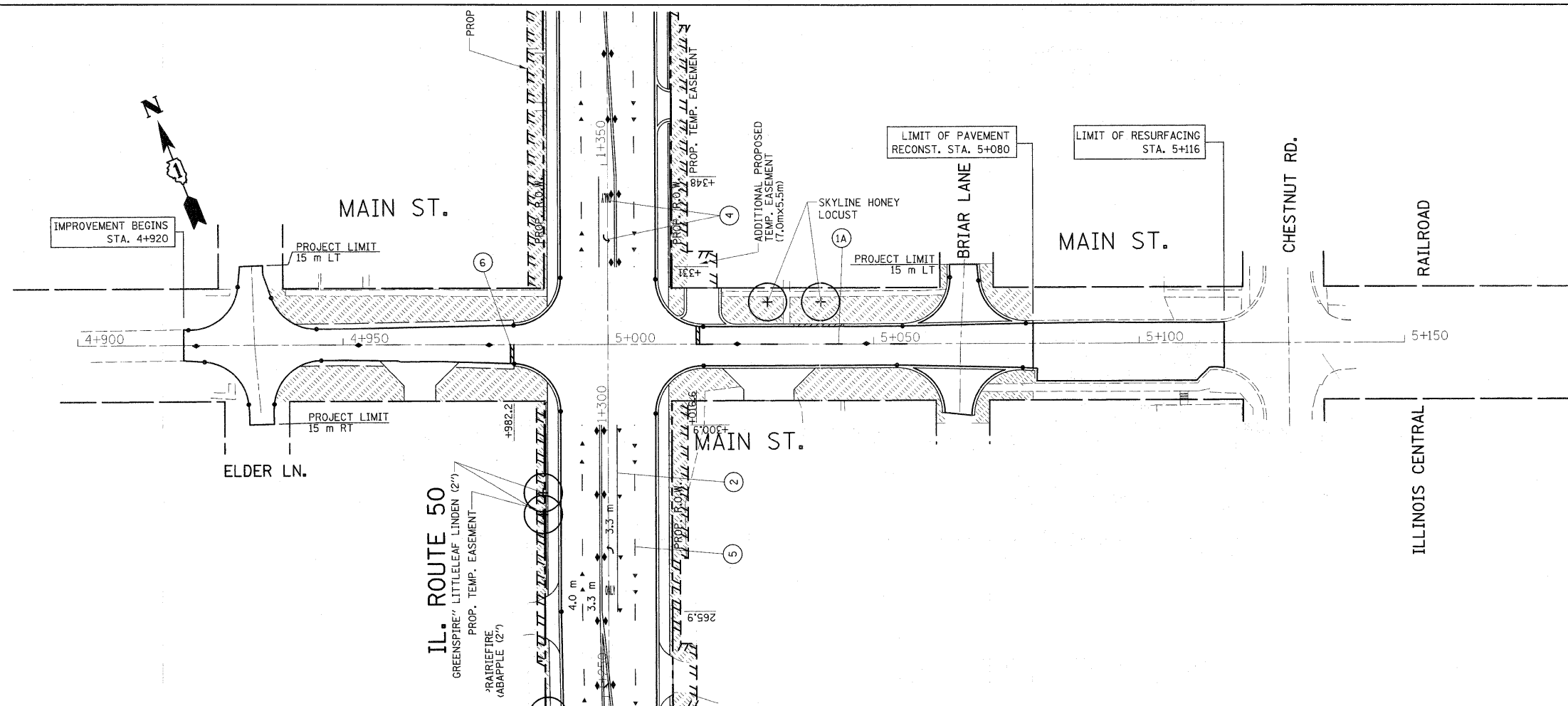

- ① THERMOPLASTIC PAVEMENT MARKING DOUBLE SOLID YELLOW, CENTERLINE 250 mm (11") C-C
- ①A THERMOPLASTIC PAVEMENT MARKING 100mm (4") SKIP-DASH YELLOW (9m SKIP 3m DASH)
- ② THERMOPLASTIC PAVEMENT MARKING 150mm (6") SOLID WHITE
- ③ THERMOPLASTIC PAVEMENT MARKING 300mm (12") AT 45° DIAGONALS, SOLID YELLOW
- ④ THERMOPLASTIC PAVEMENT MARKING LETTERS & SYMBOLS
- ⑤ THERMOPLASTIC PAVEMENT MARKING 100mm (4") SKIP-DASH WHITE (9m SKIP 3m DASH) LANE LINES
- ⑥ THERMOPLASTIC PAVEMENT MARKING 600mm (24") SOLID WHITE, STOP BAR
- ⑦ RAISED REFLECTIVE PAVEMENT MARKERS AMBER
- ⑧ RAISED REFLECTIVE PAVEMENT MARKERS CRYSTAL

- LANDSCAPING GENERAL NOTES
- THE SEEDING DATES FOR BARE EARTH SEEDING OF MIXTURE CLASS 2A SHALL BE FROM APRIL 1 TO JUNE 1, AND FROM AUGUST 15 TO SEPTEMBER 30.
 - EROSION CONTROL BLANKET SHALL BE PLACED ON ALL SEEDING AREAS

LANDSCAPING LEGEND

[Symbol]	SEEDING CLASS 2A AND TOPSOIL FURNISH AND PLACE, 10mm
[Symbol]	SODDING, SALT TOLERANT AND TOPSOIL FURNISH AND PLACE, 100mm

REVISIONS	
NAME	DATE

ILLINOIS DEPARTMENT OF TRANSPORTATION
**MAIN ST. & COURT ST.
 PAVEMENT MARKING & LANDSCAPING PLAN**

SCALE 1:500
 DATE 5/11/2011
 DRAWN BY
 CHECKED BY