

STA. 233+00 TO STA. 248+00
INSTALL 25 INLET FILTERS

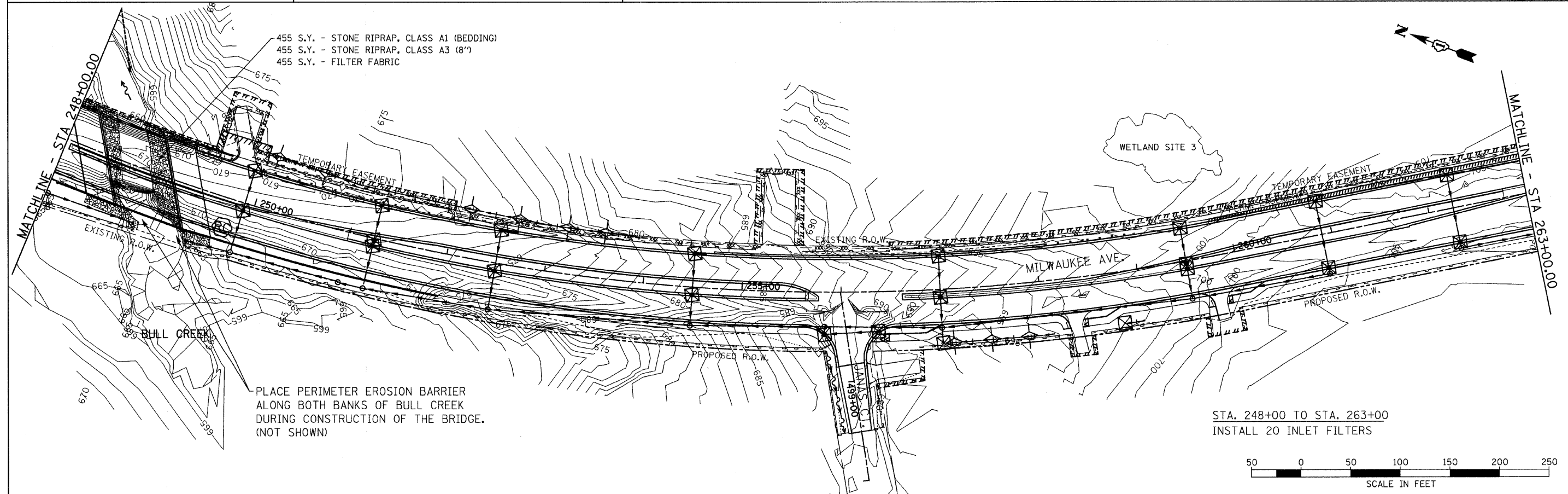

STA. 248+00 TO STA. 263+00
INSTALL 20 INLET FILTERS

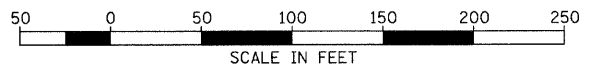

FILE NAME = u:\10290\10add sheets\sh1-eros03.dgn	USER NAME = 100T	DESIGNED - EJM	REVISED -	STATE OF ILLINOIS DEPARTMENT OF TRANSPORTATION	EROSION AND SEDIMENT CONTROL PLAN IL RTE 21 (MILWAUKEE AVE)			F.A.P. RTE.	SECTION	COUNTY	TOTAL SHEETS	SHEET NO.	
	PLOT SCALE = 5/8" = 1' / IN.	DRAWN - BK	REVISED -		SCALE: 1" = 50'	SHEET NO.	OF	SHEETS	330	128R-3	LAKE	518	90
	PLOT DATE = 8/11/2011	CHECKED - GFL	REVISED -		STA. 233+00.00 TO STA. 263+00.00	CONTRACT NO. 60953							
		DATE - 4/30/2011	REVISED -		ILLINOIS FED. AID PROJECT								