

STA. 445+00 TO STA. 457+75
INSTALL 12 INLET FILTERS

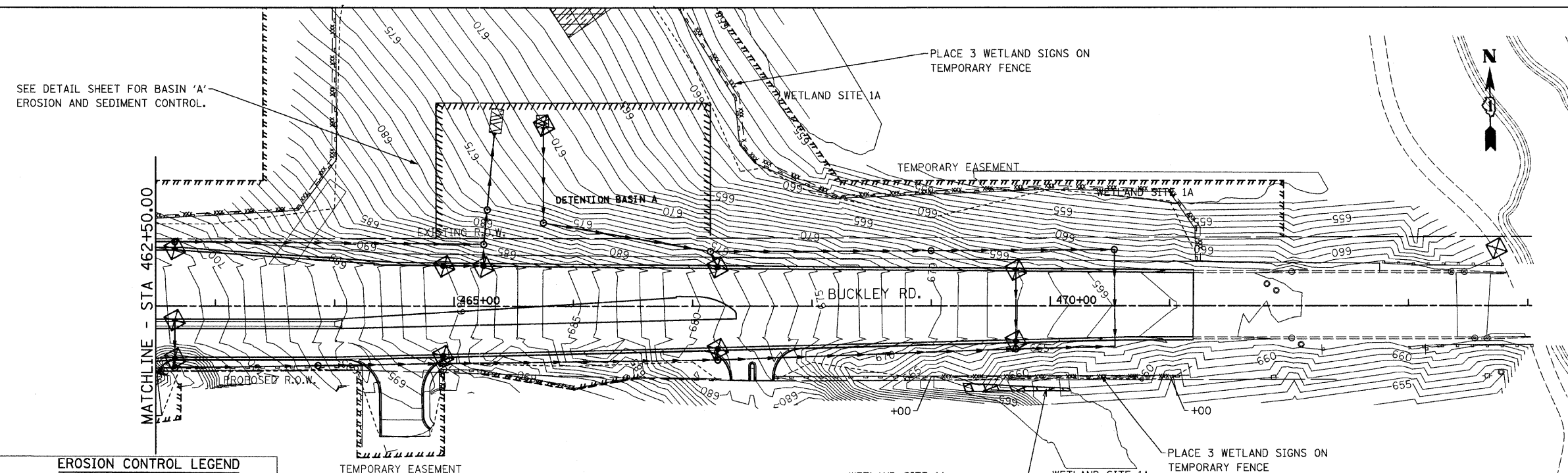

SEE DETAIL SHEET FOR BASIN 'A'
EROSION AND SEDIMENT CONTROL.

STA. 462+50 TO STA. 471+20
INSTALL 10 INLET FILTERS

EROSION CONTROL LEGEND

	TURF REINFORCEMENT MAT		PERIMETER EROSION BARRIER
	TEMPORARY FENCE		INLET AND PIPE PROTECTION OR HEADWALL PROTECTION
	RIPRAP		TEMPORARY DITCH CHECK (SEE NOTE)
	ROCK CHECK DAM		

NOTE: MAXIMUM SPACING BETWEEN THE DITCH CHECKS SHOULD BE SUCH THAT THE TOE OF THE UPSTREAM DITCH CHECK IS AT THE SAME ELEVATION AS THE OVERFLOW AT THE CENTER OF THE DOWNSTREAM DITCH CHECK.

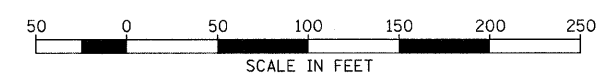

FILE NAME =	USER NAME = IDOT	DESIGNED - EJM	REVISED -	STATE OF ILLINOIS DEPARTMENT OF TRANSPORTATION	EROSION AND SEDIMENT CONTROL PLAN IL RTE 137 (BUCKLEY ROAD)	F.A.P. RTE.	SECTION	COUNTY	TOTAL SHEETS	SHEET NO.	
\\102981\oadd sheets\sh-eros05.dgn		DRAWN - BK	REVISED -			330	128R-3	LAKE	518	92	
PLOT SCALE = 58.0000' / IN.		CHECKED - GFL	REVISED -			SCALE: 1" = 50'		SHEET NO. OF SHEETS		STA. 444+90.00 TO STA. 474+02.90	
PLOT DATE = 8/11/2011		DATE - 4/30/2011	REVISED -			CONTRACT NO. 60953					
ILLINOIS FED. AID PROJECT											