

463+40.00  
335.00' LT

BASIN A N.W.L. 661.00 OVERFLOW ELEV 664.50 TRIBUTARY AREA 16.6 ACRES			
BASIN A - 1-HR STORM			
STORM	DETENTION VOL. - AC.FT.	HIGH WATER ELEVATION	OVERFLOW WEIR (CFS)
1 YR	1.07	663.41	0
2 YR	1.18	663.65	0
5 YR	1.32	663.96	0
10 YR	1.41	664.15	0
25 YR	1.56	664.46	0
50 YR	1.62	664.60	6.35
100 YR	1.65	664.64	10.99

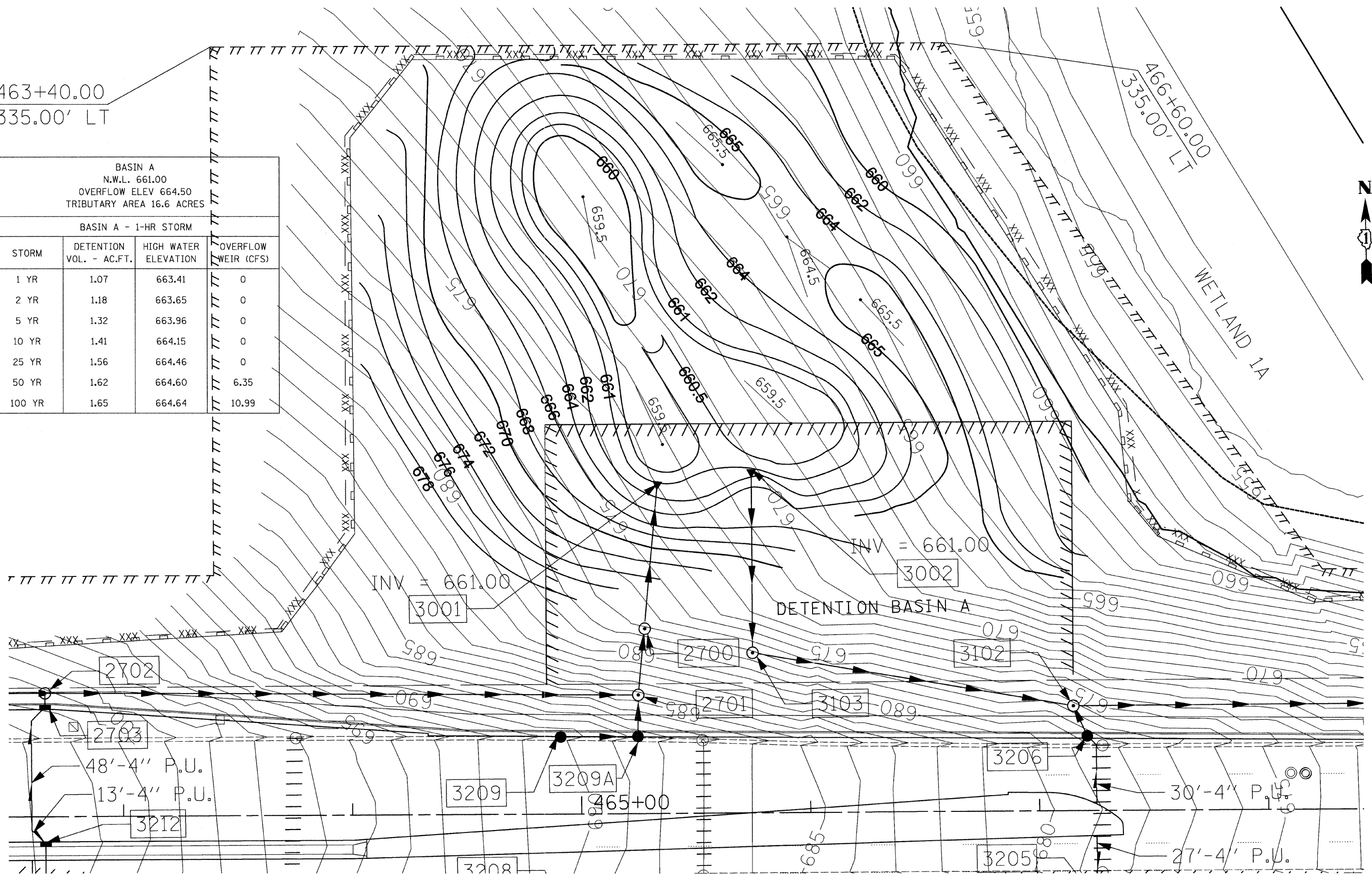

FILE NAME =	USER NAME = IDOT	DESIGNED - EJM	REVISED -	<b>STATE OF ILLINOIS DEPARTMENT OF TRANSPORTATION</b>	<b>DRAINAGE PLAN RETENTION/DETENTION SITE A</b>	F.A.P. RTE.	SECTION	COUNTY	TOTAL SHEETS	SHEET NO.	
I:\102981\CADD Sheets\shft-detentionA.2011.dgn		DRAWN - BK	REVISED -			330	128R-3	LAKE	518	105	
PLOT SCALE = 20.0000' / IN.		CHECKED - GFL	REVISED -			SCALE: 1" = 20' SHEET NO. OF SHEETS STA. TO STA.					
PLOT DATE = 6/11/2011		DATE - 4/30/2011	REVISED -			CONTRACT NO. 60953 ILLINOIS FED. AID PROJECT					