

LEGEND

- (A) COMBINATION CONCRETE CURB & GUTTER, TYPE B-6.24
- (B) COMBINATION CONCRETE CURB & GUTTER, TYPE B-6.24 (SPECIAL)
- (C) COMBINATION CONCRETE CURB & GUTTER, TYPE B-6.12
- (D) CONCRETE MEDIAN SURFACE, 4"
- (E) CONCRETE MEDIAN, TYPE M-2.12
- (F) TRAFFIC BARRIER TERMINAL, TYPE 1 (SPECIAL) TANGENT
- (G) TRAFFIC BARRIER TERMINAL, TYPE 2
- (H) TRAFFIC BARRIER TERMINAL, TYPE 6
- (I) STEEL PLATE BEAM GUARDRAIL, TYPE A, 9 FOOT POST
- (J) CONCRETE MEDIAN, TYPE SB-6.24

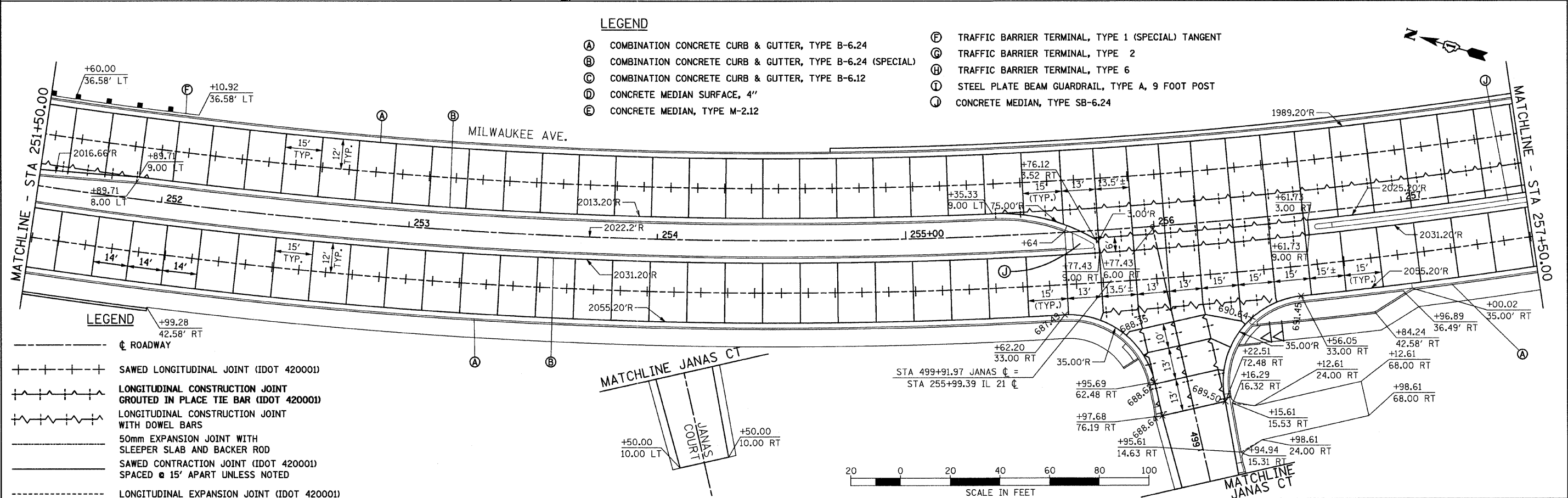

LEGEND

- ☐ ROADWAY
- SAWED LONGITUDINAL JOINT (IDOT 420001)
- LONGITUDINAL CONSTRUCTION JOINT GROUTED IN PLACE TIE BAR (IDOT 420001)
- LONGITUDINAL CONSTRUCTION JOINT WITH DOWEL BARS
- 50mm EXPANSION JOINT WITH SLEEPER SLAB AND BACKER ROD
- SAWED CONTRACTION JOINT (IDOT 420001) SPACED @ 15' APART UNLESS NOTED
- LONGITUDINAL EXPANSION JOINT (IDOT 420001)

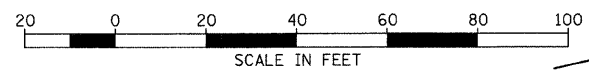

FILE NAME =	USER NAME = IDOT	DESIGNED - EJM	REVISED -	STATE OF ILLINOIS DEPARTMENT OF TRANSPORTATION	JOINTING AND LAYOUT PLAN IL RTE 21 (MILWAUKEE AVE)	F.A.P. RTE.	SECTION	COUNTY	TOTAL SHEETS	SHEET NO.	
1:\1022981\oadd sheets\shjt-join1007.dgn		DRAWN - BK	REVISED -			330	128R-3	LAKE	518	161	
PLOT SCALE = 28.0000' / IN.		CHECKED - GFL	REVISED -			SCALE: 1" = 20'		SHEET NO. OF SHEETS		STA. 245+50.00 TO STA. 257+50.00	
PLOT DATE = 8/11/2011		DATE - 4/30/2011	REVISED -					ILLINOIS FED. AID PROJECT		CONTRACT NO. 60953	