

PROJECT BEGINS
STA 175+00.00
MATCH IDOT
PROJECT 82309

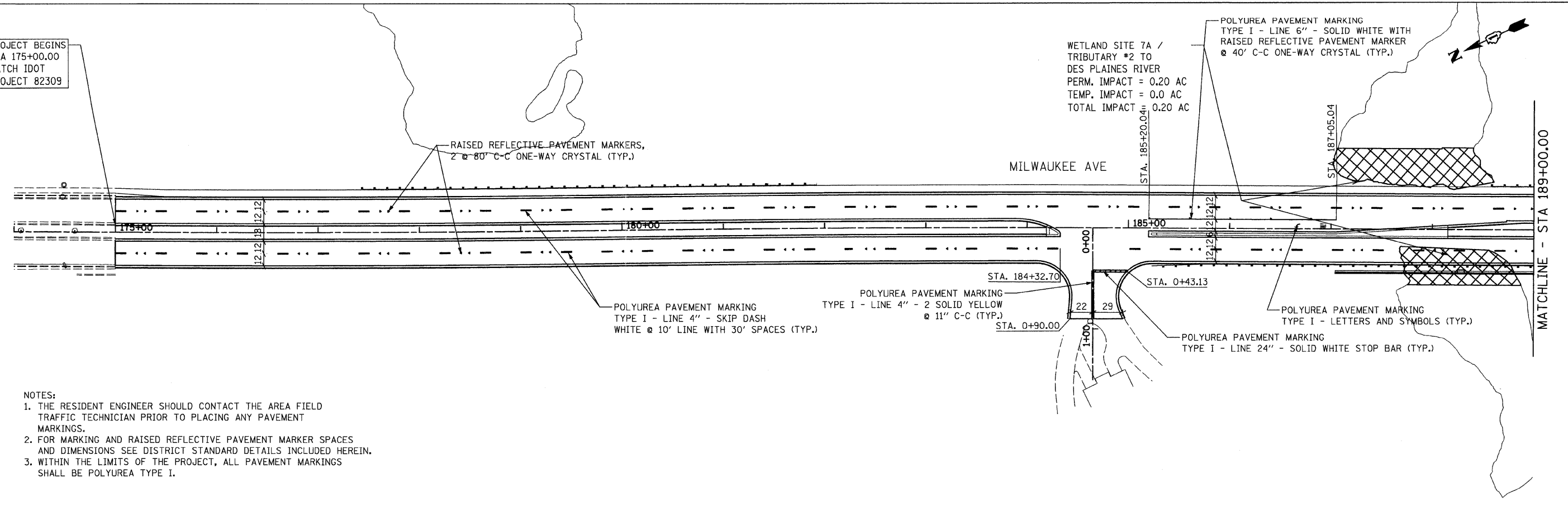

NOTES:

1. THE RESIDENT ENGINEER SHOULD CONTACT THE AREA FIELD TRAFFIC TECHNICIAN PRIOR TO PLACING ANY PAVEMENT MARKINGS.
2. FOR MARKING AND RAISED REFLECTIVE PAVEMENT MARKER SPACES AND DIMENSIONS SEE DISTRICT STANDARD DETAILS INCLUDED HEREIN.
3. WITHIN THE LIMITS OF THE PROJECT, ALL PAVEMENT MARKINGS SHALL BE POLYUREA TYPE I.

WETLAND SITE 7A /
TRIBUTARY #2 TO
DES PLAINES RIVER
PERM. IMPACT = 0.20 AC
TEMP. IMPACT = 0.0 AC
TOTAL IMPACT = 0.20 AC

POLYUREA PAVEMENT MARKING
TYPE I - LINE 6" - SOLID WHITE WITH
RAISED REFLECTIVE PAVEMENT MARKER
@ 40' C-C ONE-WAY CRYSTAL (TYP.)

POLYUREA PAVEMENT MARKING
TYPE I - LINE 4" - SKIP DASH
WHITE @ 10' LINE WITH 30' SPACES (TYP.)

POLYUREA PAVEMENT MARKING
TYPE I - LINE 4" - 2 SOLID YELLOW
@ 11" C-C (TYP.)

POLYUREA PAVEMENT MARKING
TYPE I - LINE 24" - SOLID WHITE STOP BAR (TYP.)

POLYUREA PAVEMENT MARKING
TYPE I - LETTERS AND SYMBOLS (TYP.)

MATCHLINE - STA 189+00.00

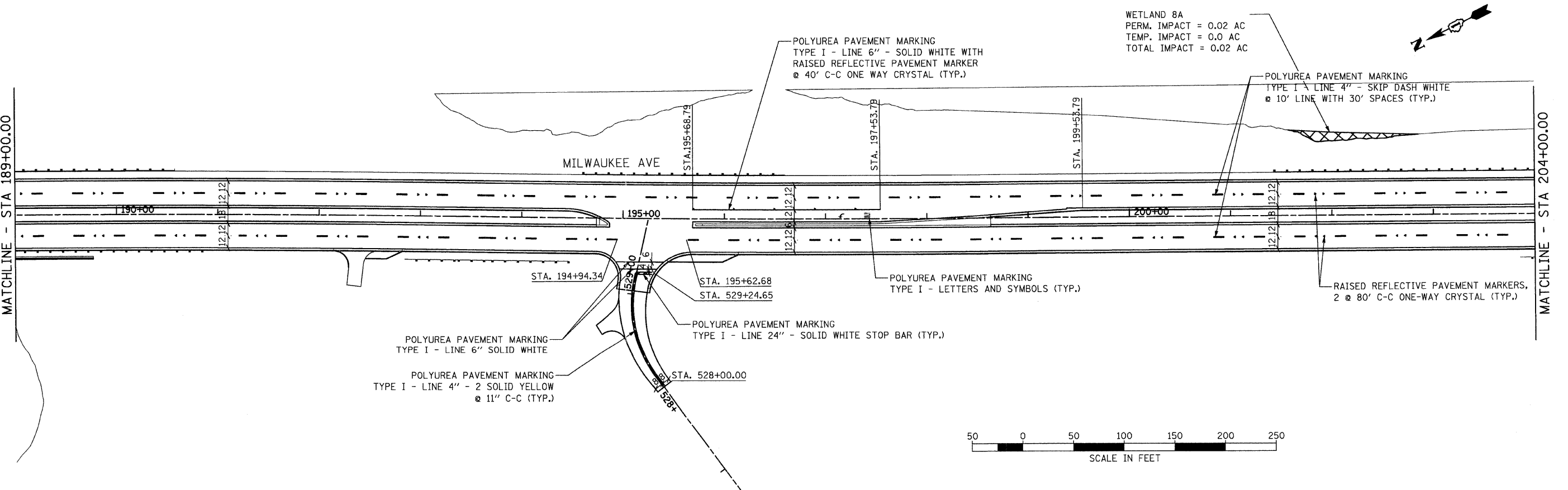

WETLAND 8A
PERM. IMPACT = 0.02 AC
TEMP. IMPACT = 0.0 AC
TOTAL IMPACT = 0.02 AC

POLYUREA PAVEMENT MARKING
TYPE I - LINE 6" - SOLID WHITE WITH
RAISED REFLECTIVE PAVEMENT MARKER
@ 40' C-C ONE WAY CRYSTAL (TYP.)

POLYUREA PAVEMENT MARKING
TYPE I - LINE 4" - SKIP DASH WHITE
@ 10' LINE WITH 30' SPACES (TYP.)

POLYUREA PAVEMENT MARKING
TYPE I - LETTERS AND SYMBOLS (TYP.)

RAISED REFLECTIVE PAVEMENT MARKERS,
2 @ 80' C-C ONE-WAY CRYSTAL (TYP.)

POLYUREA PAVEMENT MARKING
TYPE I - LINE 6" SOLID WHITE

POLYUREA PAVEMENT MARKING
TYPE I - LINE 4" - 2 SOLID YELLOW
@ 11" C-C (TYP.)

POLYUREA PAVEMENT MARKING
TYPE I - LINE 24" - SOLID WHITE STOP BAR (TYP.)

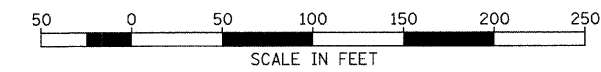

FILE NAME =
s:\102901\cadd sheets\sh-pmk01.dgn

USER NAME = IDOT

DESIGNED - EJM

REVISED -

PLOT SCALE = 50.0000' / IN.

DRAWN - BK

REVISED -

PLOT DATE = 8/11/2011

CHECKED - GFL

REVISED -

DATE - 4/30/2011

REVISED -

STATE OF ILLINOIS
DEPARTMENT OF TRANSPORTATION

PAVEMENT MARKING PLAN
IL RTE 21 (MILWAUKEE AVE)

SCALE: 1" = 50' SHEET NO. OF SHEETS STA. 174+00.00 TO STA. 204+00.00

F.A.P. RTE.	SECTION	COUNTY	TOTAL SHEETS	SHEET NO.
330	128R-3	LAKE	518	168
				CONTRACT NO. 60953

ILLINOIS FED. AID PROJECT