

RESTORATION OF WORK AREA, RESTORATION OF THE TRAFFIC SIGNAL WORK AREA SHALL BE INCIDENTAL TO THE RELATED PAY ITEM SUCH AS FOUNDATION, CONDUIT, HANDHOLE, TRENCH AND BACKFILL, ETC., AND NO EXTRA COMPENSATION SHALL BE ALLOWED. ALL ROADWAY SURFACES SUCH AS SHOULDERS, MEDIANS, SIDEWALKS, PAVEMENT, ETC. SHALL BE REPLACED IN KIND. ALL DAMAGE TO MOWED LAWNS SHALL BE REPLACED WITH AN APPROVED SOD, AND ALL DAMAGE TO UNMOWED FIELDS SHALL BE SEEDED IN ACCORDANCE WITH STANDARD SPECIFICATIONS 252 AND 250 RESPECTIVELY.

NOTE:
THE TRAFFIC SIGNAL CONTROLLER EQUIPMENT FOR THIS PROJECT SHALL BE "ECONOLITE" TO MATCH THE EXISTING ADJACENT SYSTEM.

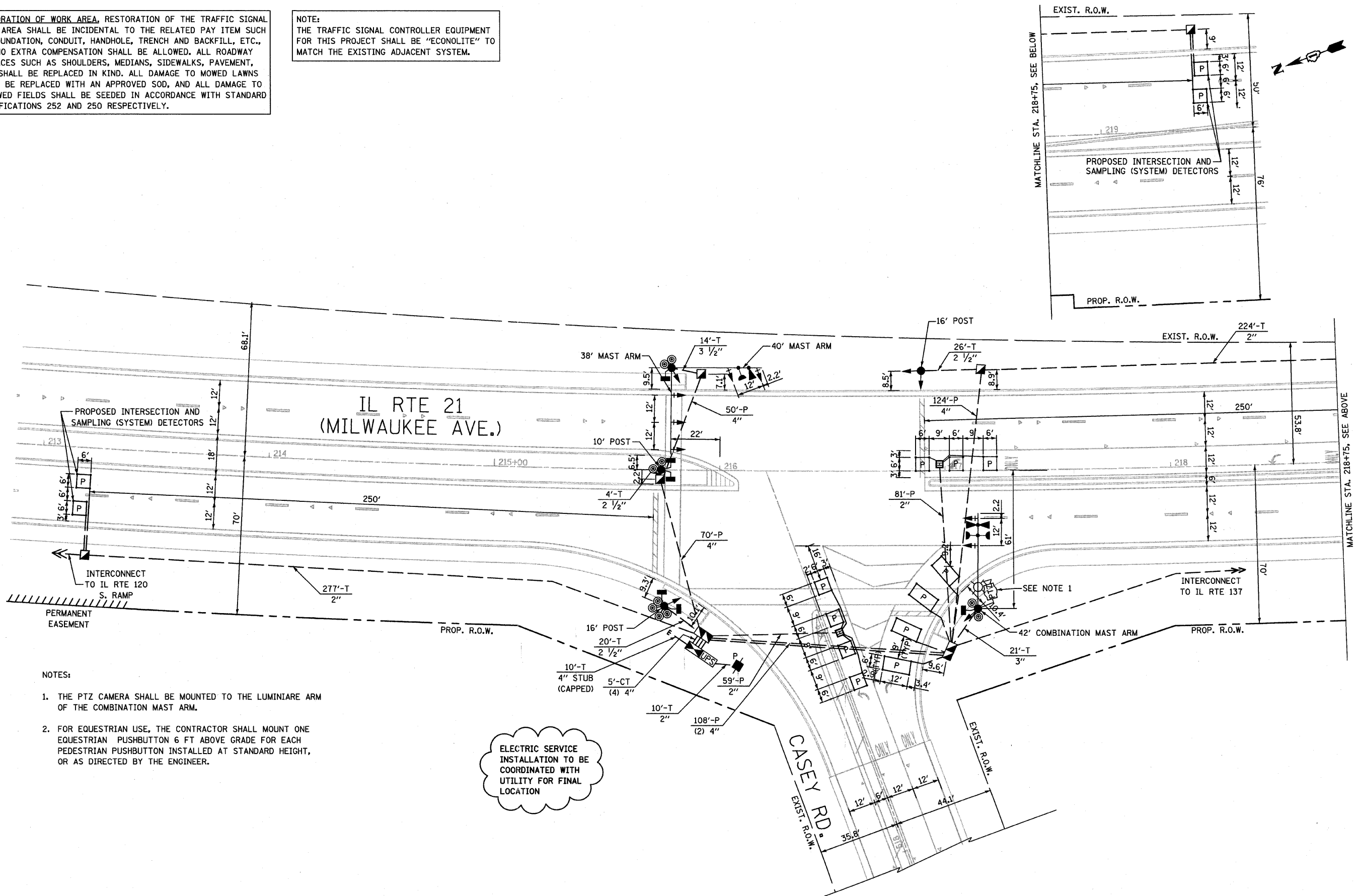

- NOTES:
1. THE PTZ CAMERA SHALL BE MOUNTED TO THE LUMINIAIRE ARM OF THE COMBINATION MAST ARM.
 2. FOR EQUESTRIAN USE, THE CONTRACTOR SHALL MOUNT ONE EQUESTRIAN PUSHBUTTON 6 FT ABOVE GRADE FOR EACH PEDESTRIAN PUSHBUTTON INSTALLED AT STANDARD HEIGHT, OR AS DIRECTED BY THE ENGINEER.

ELECTRIC SERVICE INSTALLATION TO BE COORDINATED WITH UTILITY FOR FINAL LOCATION

FILE NAME = P:\11305.000 - CRD IL Rte 21\Correspondence\11305\11305-Handoff * Ref Files\Revised\07-TS-Camaj.dgn

| | | | | | | | | | | | |
|--------------------------------|------------|-----------|---|---|--------------------------|---------------|----------------|-------------|--------------------|---------------|--|
| USER NAME = IDOT - District 01 | DESIGNED - | REVISED - | STATE OF ILLINOIS DEPARTMENT OF TRANSPORTATION | TRAFFIC SIGNAL INSTALLATION PLAN IL RTE 21 (MILWAUKEE AVE) AT CASEY ROAD | | F.A. RTE. 330 | SECTION 128R-3 | COUNTY LAKE | TOTAL SHEETS 518 | SHEET NO. 195 | |
| PLOT SCALE = 48.0000' / 1" = | DRAWN - | REVISED - | | SCALE: 1"=20' | SHEET NO. 7 OF 41 SHEETS | STA. | TO STA. | | CONTRACT NO. 60953 | | |
| PLOT DATE = 7/13/2011 | CHECKED - | REVISED - | | ILLINOIS FED. AID PROJECT | | | | | | | |
| DATE 07/08/11 | DATE | REVISED - | | | | | | | | | |