

SCHEDULE OF QUANTITIES		
ITEM	UNIT	QTY
SIGN PANEL - TYPE 1	SQ.FT	13.5
SIGN PANEL - TYPE 2	SQ.FT	16.25
CONDUIT IN TRENCH, 2" DIA., GALVANIZED STEEL	FT	511
CONDUIT IN TRENCH, 2 1/2" DIA., GALVANIZED STEEL	FT	50
CONDUIT IN TRENCH, 3" DIA., GALVANIZED STEEL	FT	21
CONDUIT IN TRENCH, 3 1/2" DIA., GALVANIZED STEEL	FT	14
CONDUIT IN TRENCH, 4" DIA., GALVANIZED STEEL	FT	30
CONDUIT PUSHED, 2" DIA., GALVANIZED STEEL	FT	140
CONDUIT PUSHED, 4" DIA., GALVANIZED STEEL	FT	460
HANDHOLE	EA	5
HEAVY-DUTY HANDHOLE	EA	2
DOUBLE HANDHOLE	EA	1
TRENCH AND BACKFILL FOR ELECTRICAL WORK	EA	626
FULL-ACTUATED CONTROLLER AND TYPE IV CABINET (SPECIAL)	EA	1
ELECTRIC CABLE IN CONDUIT, SIGNAL NO. 14 2C	FT	1159
ELECTRIC CABLE IN CONDUIT, SIGNAL NO. 14 3C	FT	1380
ELECTRIC CABLE IN CONDUIT, SIGNAL NO. 14 5C	FT	1811
ELECTRIC CABLE IN CONDUIT, SIGNAL NO. 14 7C	FT	882
ELECTRIC CABLE IN CONDUIT, SIGNAL NO. 14 1 PAIR	FT	2077
ELECTRIC CABLE IN CONDUIT, SERVICE, NO. 6 2/C	FT	27
TRAFFIC SIGNAL POST, GALVANIZED STEEL 10 FT.	EA	1
TRAFFIC SIGNAL POST, GALVANIZED STEEL 16 FT.	EA	2
STEEL MAST ARM ASSEMBLY AND POLE WITH DUAL MAST ARMS, 38 FT. AND 40 FT.	EA	1
STEEL COMBINATION MAST ARM ASSEMBLY AND POLE, 42 FT.	EA	1
CONCRETE FOUNDATION, TYPE A	FT	12
CONCRETE FOUNDATION, TYPE C	FT	4
CONCRETE FOUNDATION, TYPE E 36 INCH DIAMETER	FT	13
CONCRETE FOUNDATION, TYPE E 42 INCH DIAMETER	FT	25
SIGNAL HEAD, LED, 1 FACE, 3 SECTION, MAST-ARM MOUNTED	EA	6
SIGNAL HEAD, LED, 1 FACE, 3 SECTION, BRACKET MOUNTED	EA	1
SIGNAL HEAD, LED, 1 FACE, 5 SECTION, BRACKET MOUNTED	EA	2
SIGNAL HEAD, LED, 1 FACE, 5 SECTION, MAST-ARM MOUNTED	EA	1
SIGNAL HEAD, LED, 2 FACE, 1-3 SECTION, 1-5 SECTION, BRACKET MOUNTED	EA	1
PEDESTRIAN SIGNAL HEAD, 1-FACE, LED, BRACKET MOUNTED WITH COUNTDOWN TIMER	EA	2
PEDESTRIAN SIGNAL HEAD, 2-FACE, LED, BRACKET MOUNTED WITH COUNTDOWN TIMER	EA	2
TRAFFIC SIGNAL BACKPLATE, LOUVERED, ALUMINIUM	EA	7
INDUCTIVE LOOP DETECTOR	EA	7
# LIGHT DETECTOR	EA	2
# LIGHT DETECTOR AMPLIFIER	EA	1
PEDESTRIAN PUSH-BUTTON	EA	10
PERFORMED DETECTOR LOOP	FT	483
SERVICE INSTALLATION, POLE MOUNT	EA	1
UNINTERRUPTIBLE POWER SUPPLY	EA	1
ELECTRIC CABLE IN CONDUIT, GROUNDING NO. 6 1/C	FT	469
# ELECTRIC CABLE IN CONDUIT, SIGNAL NO. 20 3/C, TWISTED, SHIELDED	FT	450
ELECTRIC CABLE IN CONDUIT, VIDEO NO. 20 4C	FT	212
ELECTRIC CABLE IN CONDUIT, COAXIAL	FT	212
REMOTE-CONTROLLED VIDEO SYSTEM	EA	1
LAYER II (DATA LINK) SWITCH	EA	1
VIDEO ENCODER	EA	1

100% VILLAGE OF LIBERTYVILLE COST

I.D.O.T. TRAFFIC SIGNAL INSTALLATION ELECTRICAL SERVICE REQUIREMENTS					
TYPE	NO. OF LAMPS	WATTAGE		% OPERATIONS	TOTAL WATTAGE
		INCAND.	LED		
SIGNAL (RED)	12		17	0.50	204.0
(YELLOW)	12		25	0.25	75.0
(GREEN)	12		15	0.25	45.0
ARROW	8		12	0.10	9.6
PED. SIGNAL	6		25	1.00	150
CONTROLLER	1	100	100	1.00	100
FLASHER			25	0.50	
TOTAL = 583.6					
ENERGY COSTS TO: VILLAGE OF LIBERTYVILLE 118 WEST COOK AVENUE LIBERTYVILLE, ILLINOIS 60048					
ENERGY SUPPLY: CONTACT: <u>JOE HURLEY</u> PHONE: <u>(847) 816-5503</u> COMPANY: <u>COM ED</u>					

RESTORATION OF WORK AREA. RESTORATION OF THE TRAFFIC SIGNAL WORK AREA SHALL BE INCIDENTAL TO THE RELATED PAY ITEM SUCH AS FOUNDATION, CONDUIT, HANDHOLE, TRENCH AND BACKFILL, ETC., AND NO EXTRA COMPENSATION SHALL BE ALLOWED. ALL ROADWAY SURFACES SUCH AS SHOULDERS, MEDIANS, SIDEWALKS, PAVEMENT, ETC. SHALL BE REPLACED IN KIND. ALL DAMAGE TO MOWED LAWNS SHALL BE REPLACED WITH AN APPROVED SOD, AND ALL DAMAGE TO UNMOWED FIELDS SHALL BE SEEDED IN ACCORDANCE WITH STANDARD SPECIFICATIONS 252 AND 250 RESPECTIVELY.

NOTE: THE TRAFFIC SIGNAL CONTROLLER EQUIPMENT FOR THIS PROJECT SHALL BE "ECONOLITE" TO MATCH THE EXISTING ADJACENT SYSTEM.

THE TRACER CABLE SHALL BE CONTINUOUS AND EXTEND INTO THE CONTROLLER CABINET.

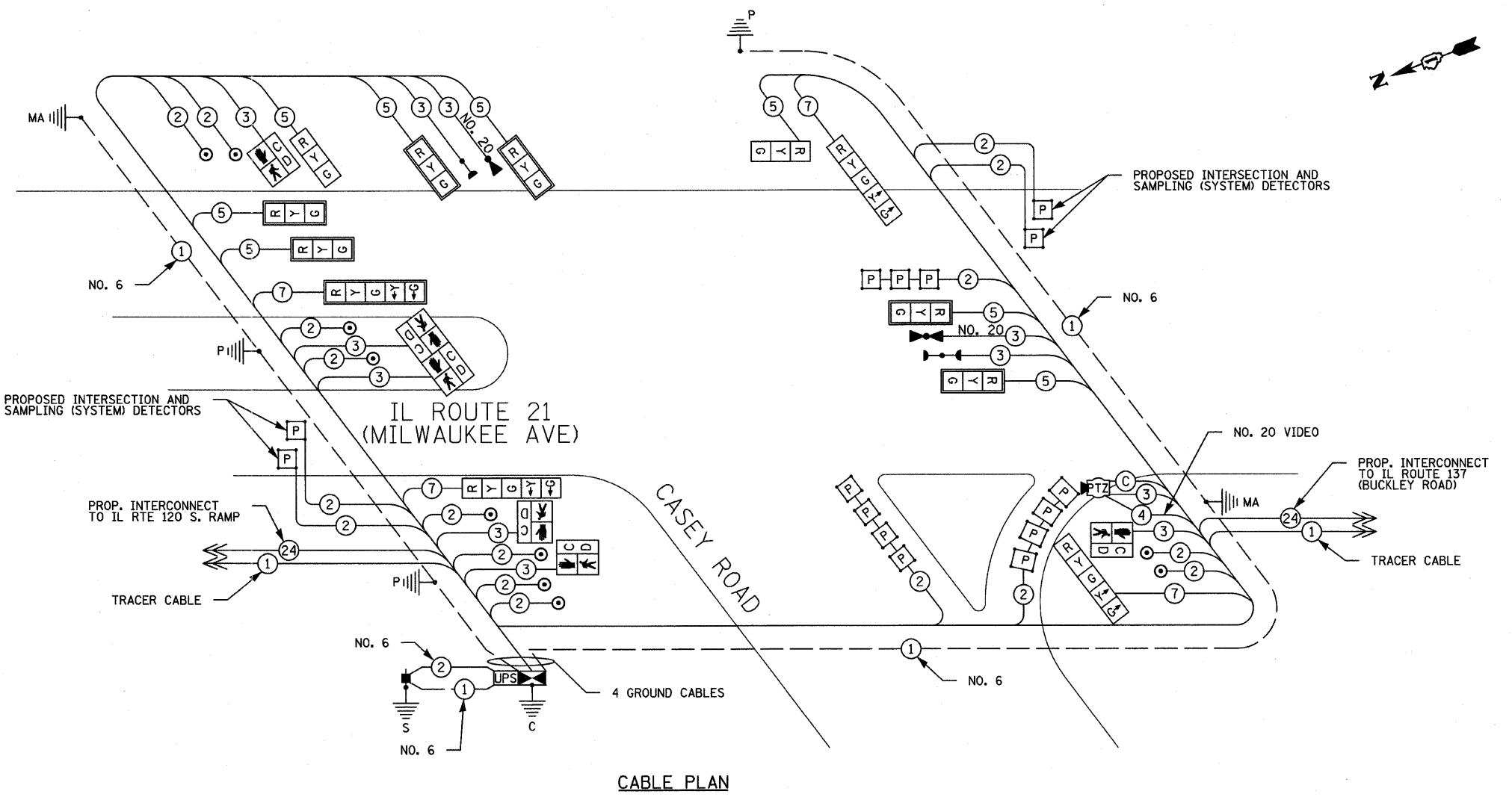

EMERGENCY VEHICLE PRE-EMPTION SEQUENCE

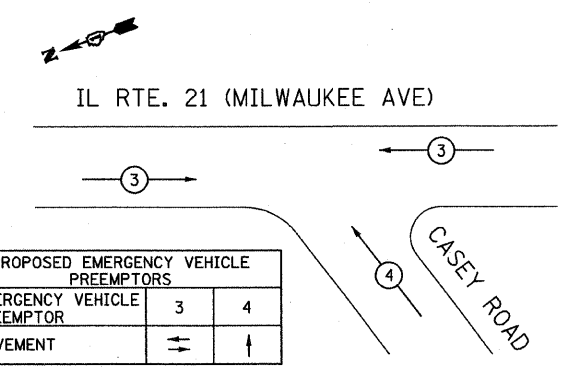

PROPOSED EMERGENCY VEHICLE PREEMPTORS		
EMERGENCY VEHICLE PREEMPTOR	3	4
MOVEMENT	← →	↑ ↓

CONTROLLER SEQUENCE

