

SCHEDULE OF QUANTITIES		
ITEM	UNIT	QTY
SIGN PANEL - TYPE 1	SQ.FT	40
SIGN PANEL - TYPE 2	SQ.FT	60
CONDUIT IN TRENCH, 2" DIA., GALVANIZED STEEL	FT	639
CONDUIT IN TRENCH, 2 1/2" DIA., GALVANIZED STEEL	FT	221
CONDUIT IN TRENCH, 3" DIA., GALVANIZED STEEL	FT	66
CONDUIT IN TRENCH, 4" DIA., GALVANIZED STEEL	FT	30
CONDUIT PUSHED, 2" DIA., GALVANIZED STEEL	FT	546
CONDUIT PUSHED, 2 1/2" DIA., GALVANIZED STEEL	FT	154
CONDUIT PUSHED, 4" DIA., GALVANIZED STEEL	FT	929
HANDHOLE	EA	7
HEAVY-DUTY HANDHOLE	EA	4
DOUBLE HANDHOLE	EA	3
TRENCH AND BACKFILL FOR ELECTRICAL WORK	FT	956
FULL-ACTUATED CONTROLLER AND TYPE IV CABINET (SPECIAL)	EA	1
ELECTRIC CABLE IN CONDUIT, SIGNAL NO. 14 2C	FT	2533
ELECTRIC CABLE IN CONDUIT, SIGNAL NO. 14 3C	FT	4569
ELECTRIC CABLE IN CONDUIT, SIGNAL NO. 14 5C	FT	3575
ELECTRIC CABLE IN CONDUIT, SIGNAL NO. 14 7C	FT	2251
ELECTRIC CABLE IN CONDUIT, SIGNAL NO. 14 1 PAIR	FT	7421
ELECTRIC CABLE IN CONDUIT, SERVICE, NO. 6 2/C	FT	37
TRAFFIC SIGNAL POST, GALVANIZED STEEL 16 FT.	EA	4
STEEL COMBINATION MAST ARM ASSEMBLY AND POLE, 64 FT.	EA	2
STEEL COMBINATION MAST ARM ASSEMBLY AND POLE, 66 FT.	EA	1
STEEL COMBINATION MAST ARM ASSEMBLY AND POLE, 70 FT.	EA	1
CONCRETE FOUNDATION, TYPE A	FT	16
CONCRETE FOUNDATION, TYPE C	FT	4
CONCRETE FOUNDATION, TYPE E 42 INCH DIAMETER	FT	92
SIGNAL HEAD, LED, 1 FACE, 3 SECTION, MAST-ARM MOUNTED	EA	8
SIGNAL HEAD, LED, 5 SECTION, MAST-ARM MOUNTED	EA	4
SIGNAL HEAD, LED, 2 FACE, 1-3 SECTION, 1-5 SECTION, BRACKET MOUNTED	EA	4
PEDESTRIAN SIGNAL HEAD, 1-FACE, LED, BRACKET MOUNTED WITH COUNTDOWN TIMER	EA	2
PEDESTRIAN SIGNAL HEAD, 2-FACE, LED, BRACKET MOUNTED WITH COUNTDOWN TIMER	EA	2
PEDESTRIAN SIGNAL HEAD, 3-FACE, LED, BRACKET MOUNTED WITH COUNTDOWN TIMER	EA	2
TRAFFIC SIGNAL BACKPLATE, LOUVERED, ALUMINIUM	EA	12
INDUCTIVE LOOP DETECTOR	EA	21
# LIGHT DETECTOR	EA	4
# LIGHT DETECTOR AMPLIFIER	EA	1
# PEDESTRIAN PUSH-BUTTON	EA	10
TEMPORARY TRAFFIC SIGNAL INSTALLATION	EA	1
REMOVE EXISTING TRAFFIC SIGNAL EQUIPMENT	EA	1
REMOVE EXISTING HANDHOLE	EA	14
REMOVE EXISTING CONCRETE FOUNDATION	EA	8
PREFORMED DETECTOR LOOP	FT	1283
TEMPORARY TRAFFIC SIGNAL TIMING	EA	1
RELOCATE EXISTING REMOTE-CONTROLLED VIDEO SYSTEM (SPECIAL)	EA	1
RELOCATE EXISTING SWITCH (SPECIAL)	EA	1
SERVICE INSTALLATION, POLE MOUNT	EA	1
UNINTERRUPTIBLE POWER SUPPLY	EA	1
ELECTRIC CABLE IN CONDUIT, GROUNDING NO. 6 1/C	FT	801
# ELECTRIC CABLE IN CONDUIT, SIGNAL NO. 20 3/C, TWISTED, SHIELDED	FT	1252
ELECTRIC CABLE IN CONDUIT, VIDEO NO. 20 4C	FT	102
ELECTRIC CABLE IN CONDUIT, COAXIAL	FT	102

100% VILLAGE OF LIBERTYVILLE COST

NOTE:
EXISTING RED LIGHT RUNNING (RLR) EQUIPMENT IS PRESENT AT THIS LOCATION. RELOCATION OF THE EQUIPMENT IS BY OTHERS. THE CONTRACTOR SHALL CONTACT GATSO-USA AT (480) 315-1386 AND THE VILLAGE OF LIBERTYVILLE AT (847) 362-2430 TO COORDINATE THE REMOVAL/RELOCATION OF THE RLR EQUIPMENT BY OTHERS.

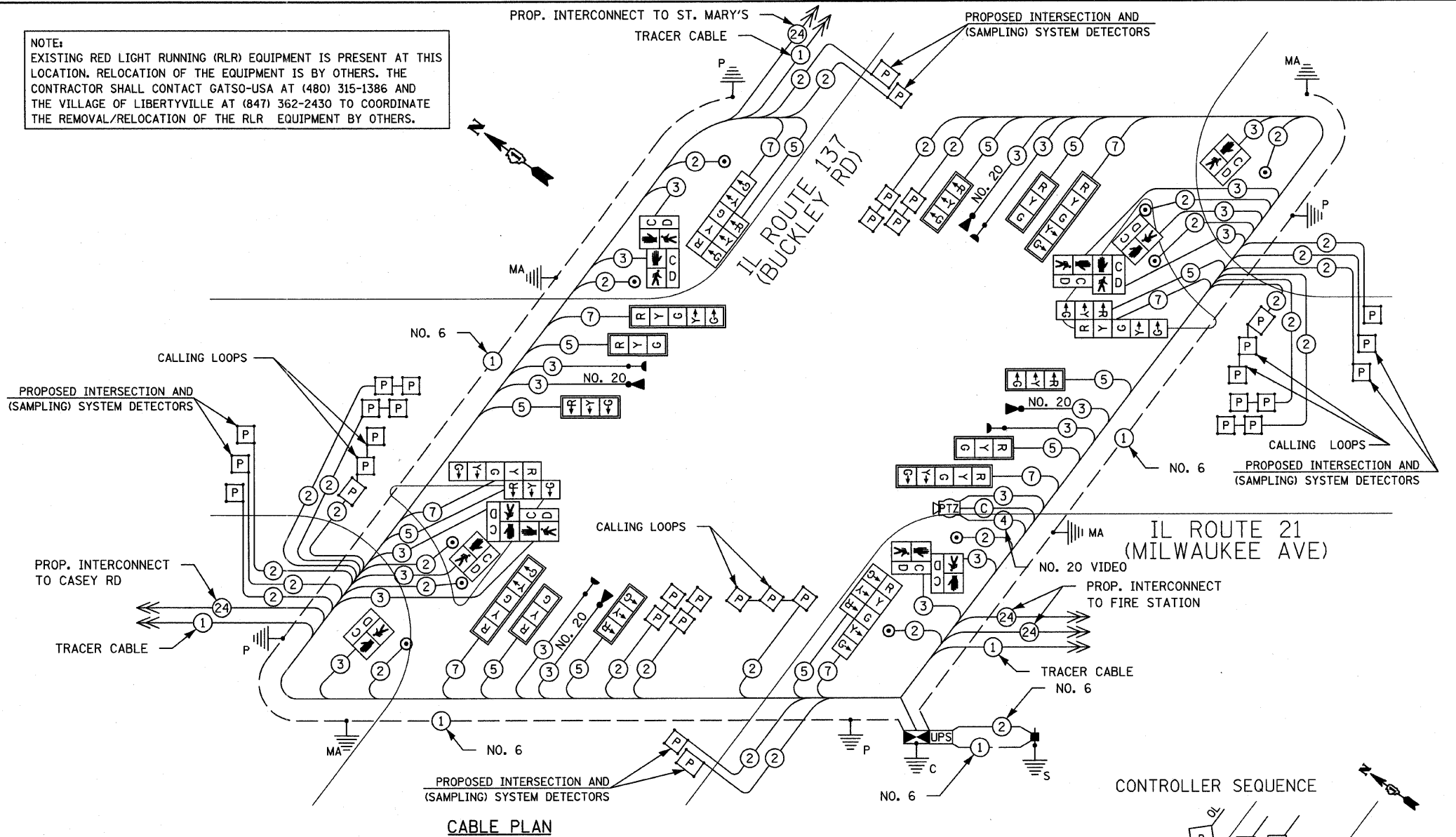

I.D.O.T. TRAFFIC SIGNAL INSTALLATION ELECTRICAL SERVICE REQUIREMENTS				
TYPE	NO. OF LAMPS	WATTAGE	% OPERATIONS	TOTAL WATTAGE
		INCAND.		
SIGNAL (RED)	20	17	0.50	170
(YELLOW)	20	25	0.25	125
(GREEN)	20	15	0.25	75
ARROW	16	12	0.10	19.2
PED. SIGNAL	12	25	1.00	300
CONTROLLER	1	100	1.00	100
FLASHER		25	0.50	

ENERGY COSTS TO: TOTAL = 789.2
VILLAGE OF LIBERTYVILLE
 118 WEST COOK AVENUE
 LIBERTYVILLE, ILLINOIS 60048
 ENERGY SUPPLY: CONTACT: JOE HURLEY
 PHONE: (847) 816-5503
 COMPANY: COM ED

RESTORATION OF WORK AREA. RESTORATION OF THE TRAFFIC SIGNAL WORK AREA SHALL BE INCIDENTAL TO THE RELATED PAY ITEM SUCH AS FOUNDATION, CONDUIT, HANDHOLE, TRENCH AND BACKFILL, ETC., AND NO EXTRA COMPENSATION SHALL BE ALLOWED. ALL ROADWAY SURFACES SUCH AS SHOULDERS, MEDIANS, SIDEWALKS, PAVEMENT, ETC. SHALL BE REPLACED IN KIND. ALL DAMAGE TO MOWED LAWNS SHALL BE REPLACED WITH AN APPROVED SOD, AND ALL DAMAGE TO UNMOWED FIELDS SHALL BE SEEDING IN ACCORDANCE WITH STANDARD SPECIFICATIONS 252 AND 250 RESPECTIVELY.

NOTE:
THE TRAFFIC SIGNAL CONTROLLER EQUIPMENT FOR THIS PROJECT SHALL BE "ECONOLITE" TO MATCH THE EXISTING ADJACENT SYSTEM.

THE TRACER CABLE SHALL BE CONTINUOUS AND EXTEND INTO THE CONTROLLER CABINET.

EMERGENCY VEHICLE PRE-EMPTION SEQUENCE

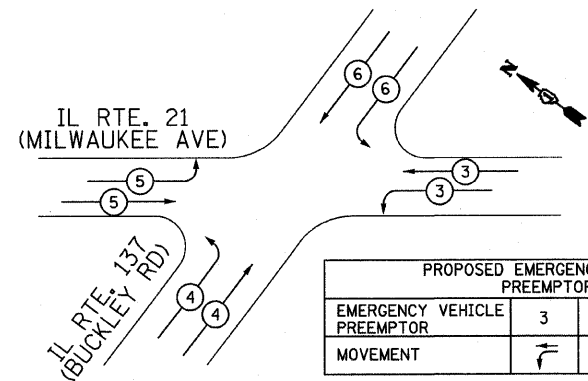

PROPOSED EMERGENCY VEHICLE PREEMPTORS				
EMERGENCY VEHICLE PREEMPTOR	3	4	5	6
MOVEMENT	↔	↔↔	↔↔↔	↔↔↔↔

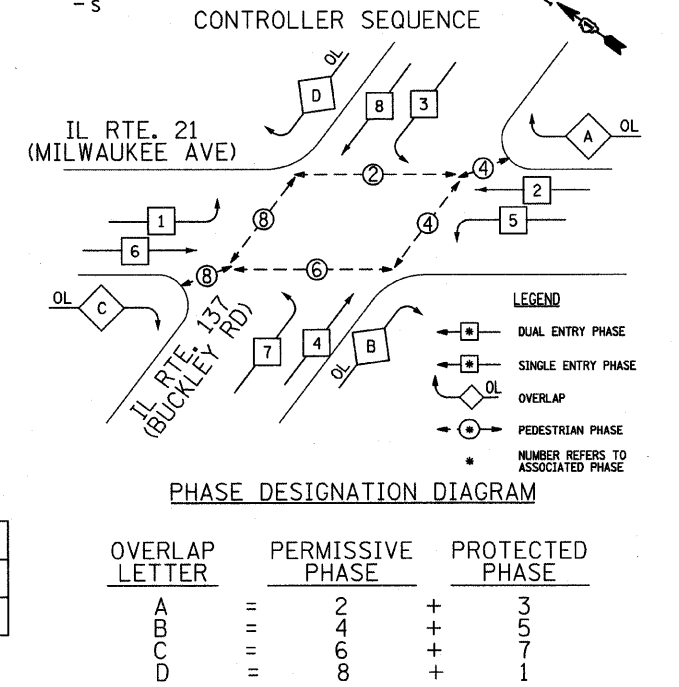

FILE NAME = P:\11386.000 - CRA IL Rte 21\Correspondence\IN\201107-Handoff w Ref Files ReAttach\DRAWING-Buckley.dgn	USER NAME = IDOT - District 01	DESIGNED -	REVISED -
PLOT SCALE = 48,0000 / in.	CHECKED -	REVISED -	REVISED -
PLOT DATE = 7/13/2011	DATE 07/08/11	REVISED -	REVISED -

STATE OF ILLINOIS
DEPARTMENT OF TRANSPORTATION

SCHEDULE OF QUANTITIES, CABLE PLAN, PHASE DESIGNATION DIAGRAM, AND EMERGENCY VEHICLE PREEMPTION SEQUENCE
 ILL RTE 21 (MILWAUKEE AVE.) AT ILL RTE 137 (BUCKLEY RD.)
 SCALE: NTS SHEET NO. 17 OF 41 SHEETS STA. TO STA.

F.A. RTE. 330	SECTION 128R-3	COUNTY LAKE	TOTAL SHEETS 518	SHEET NO. 205
				CONTRACT NO. 60953
ILLINOIS FED. AID PROJECT				