

**EAST EDGE OF NB SHOULDER**

Location	Station	Offset	Theoretical Grade Elevations
N. End North Appr. Pav't.	247+88.68	-34.99	671.51
A1	247+98.86	-35.10	671.56
A2	248+09.08	-35.14	671.61
S. End North Appr. Pav't.	248+19.33	-35.14	671.66

**EAST EDGE OF NB PAVEMENT**

Location	Station	Offset	Theoretical Grade Elevations
N. End North Appr. Pav't.	247+89.78	-33.00	671.57
A1	248+00.20	-33.00	671.62
A2	248+10.44	-33.00	671.68
S. End North Appr. Pav't.	248+20.66	-33.00	671.73

**EAST EDGE OF SB SHOULDER**

Location	Station	Offset	Theoretical Grade Elevations
N. End North Appr. Pav't.	248+15.26	7.00	672.86
A1	248+25.22	7.00	672.91
A2	248+35.17	7.00	672.96
S. End North Appr. Pav't.	248+45.12	7.00	673.01

**SB PGL, STAGE CONST. JT.  
EAST EDGE OF SB PAVEMENT**

Location	Station	Offset	Theoretical Grade Elevations
N. End North Appr. Pav't.	248+16.50	9.00	672.92
A1	248+26.44	9.00	672.97
A2	248+36.37	9.00	673.02
S. End North Appr. Pav't.	248+46.31	9.00	673.07

**NB PGL**

Location	Station	Offset	Theoretical Grade Elevations
N. End North Appr. Pav't.	248+05.29	-9.00	672.35
A1	248+15.35	-9.00	672.40
A2	248+25.42	-9.00	672.45
S. End North Appr. Pav't.	248+35.48	-9.00	672.50

**WEST EDGE OF NB PAVEMENT**

Location	Station	Offset	Theoretical Grade Elevations
N. End North Appr. Pav't.	248+12.79	3.00	672.73
A1	248+22.77	3.00	672.78
A2	248+32.75	3.00	672.83
S. End North Appr. Pav't.	248+42.73	3.00	672.88

**WEST EDGE OF SB PAVEMENT**

Location	Station	Offset	Theoretical Grade Elevations
N. End North Appr. Pav't.	248+31.07	33.00	673.69
A1	248+40.85	33.00	673.74
A2	248+50.64	33.00	673.79
S. End North Appr. Pav't.	248+60.42	33.00	673.84

**WEST EDGE OF NB SHOULDER**

Location	Station	Offset	Theoretical Grade Elevations
N. End North Appr. Pav't.	248+13.41	4.00	672.76
A1	248+23.38	4.00	672.81
A2	248+33.35	4.00	672.86
S. End North Appr. Pav't.	248+43.33	4.00	672.91

**WEST EDGE OF SB SHOULDER**

Location	Station	Offset	Theoretical Grade Elevations
N. End North Appr. Pav't.	248+32.27	34.99	672.76
A1	248+42.02	34.96	672.80
A2	248+51.79	34.98	672.85
S. End North Appr. Pav't.	248+61.60	35.04	672.90

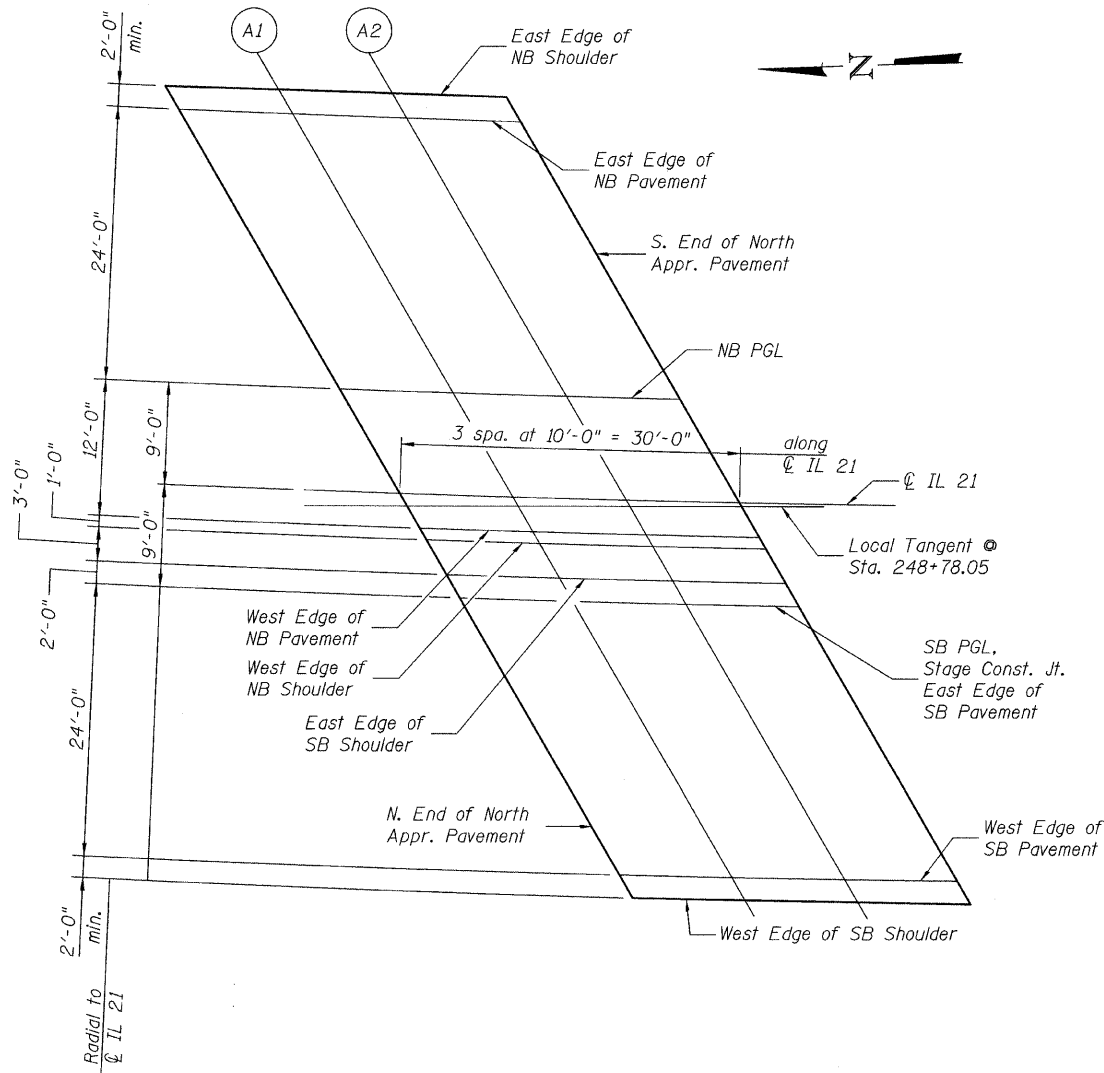

**NORTH APPROACH SLAB PLAN**

