

B.M.: Chiseled box on top of S.E. wingwall of the existing bridge over Bull Creek. Elevation 669.64

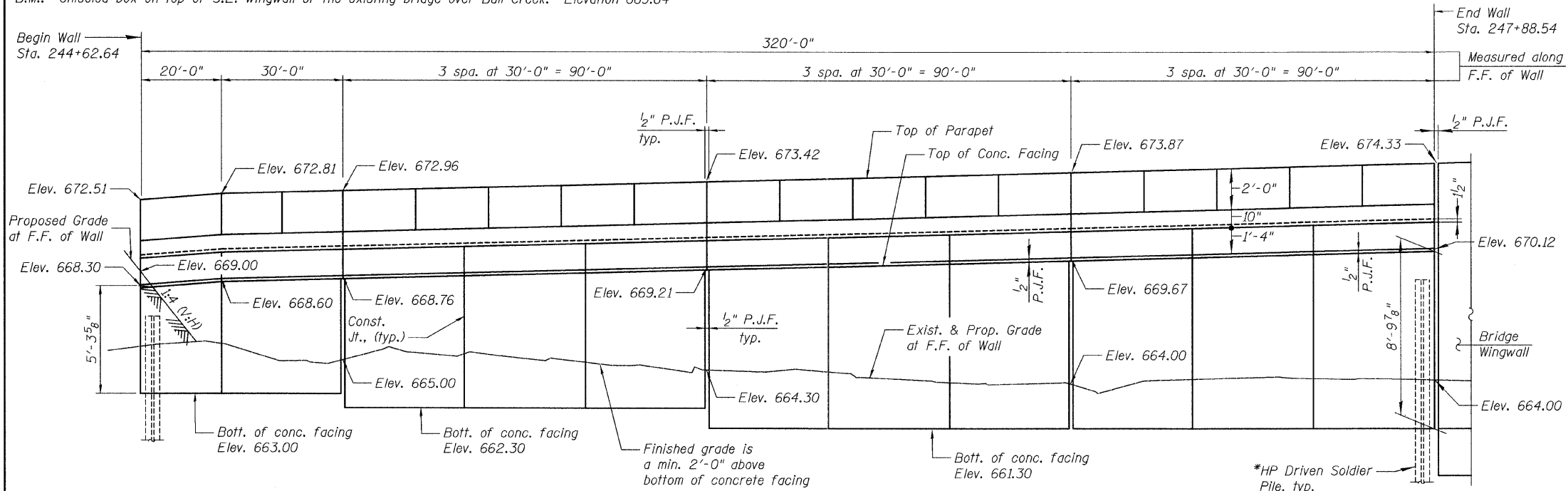

ELEVATION
(Looking at B.F. of Wall)

*See Sht's. S3-2 thru S3-6 for pile sections, spacings and tip elevations

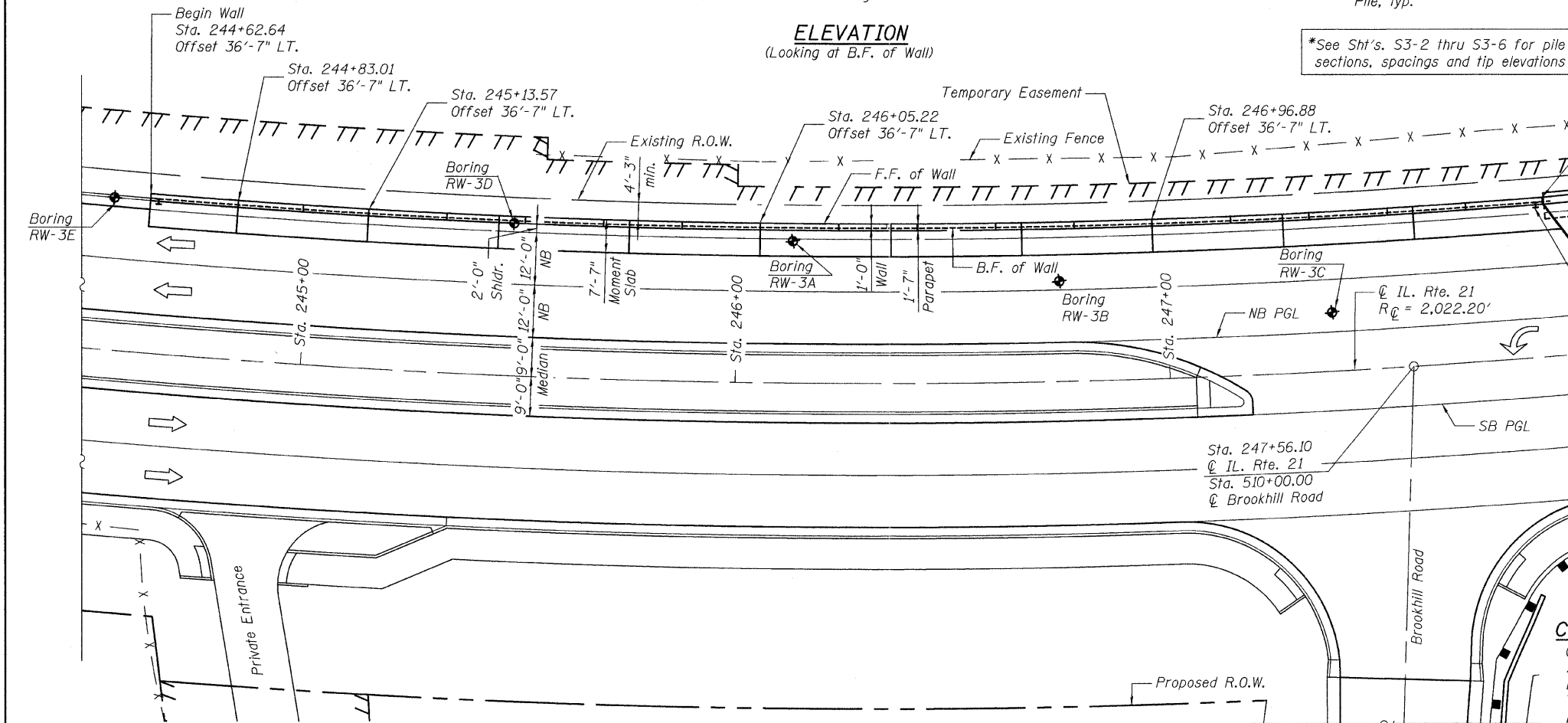

PLAN

Note: Offsets are measured from the C of IL. Rte. 21

Indicates Boring Locations

INDEX OF SHEETS

- S3-1 GENERAL PLAN & ELEVATION
- S3-2 PLAN & ELEVATION-I
- S3-3 PLAN & ELEVATION-II
- S3-4 PLAN & ELEVATION-III
- S3-5 RETAINING WALL SECTION
- S3-6 SOLDIER PILE SCHEDULE & DETAILS
- S3-7 SOIL BORING LOGS-I
- S3-8 SOIL BORING LOGS-II
- S3-9 SOIL BORING LOGS-III

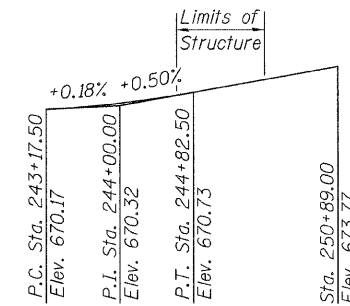

PROFILE GRADE
(along NB PGL)

DESIGN STRESSES
FIELD UNITS

$f'_c = 3,500$ psi
 $f_y = 60,000$ psi (Reinforcement)
 $f_y = 36,000$ psi (Structural Steel AASHTO M 270, Gr. 36 Soldier Piles)

DESIGN SPECIFICATIONS

AASHTO 2002 Standard Specifications for Highway Bridges

APPROVED
FOR STRUCTURAL ADEQUACY ONLY

ENGINEER OF BRIDGES AND STRUCTURES



Bh. Shah, N. R. H.
 BHADRESH N. SHAH ASCE, 15, 2011
 LICENSED STRUCTURAL ENGINEER
 STATE OF ILLINOIS LIC. NO. 081-004476
 EXPIRES: 11-30-12

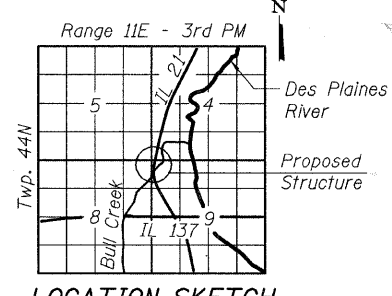

LOCATION SKETCH

CURVE DATA

C IL. Rte. 21
 $\Delta = 46^\circ-11'-38''$
 $D = 2^\circ-50'-00''$
 $T = 862.41'$
 $L = 1,630.37'$
 $E = 176.22'$
 $R = 2,022.20'$
 $\text{S.E.} = 2.90\%$
 $\text{P.C. Sta.} = 243+66.70$
 $\text{P.T. Sta.} = 259+97.07$
 $\text{P.I. Sta.} = 252+29.11$

GENERAL PLAN & ELEVATION
ILLINOIS ROUTE 21 - RETAINING WALL NO. 3
F.A.P. 330 SEC. 128R-3
LAKE COUNTY
STATION 244+62.64 TO 247+88.54
STRUCTURE NO. 049-W019

CHRISTIAN-ROGE & ASSOCIATES, INC.

FILE NAME = D168953-01-GPE.dgn	USER NAME =	DESIGNED - J.C.N./B.N.S.	REVISIONS -	STATE OF ILLINOIS DEPARTMENT OF TRANSPORTATION	GENERAL PLAN & ELEVATION STRUCTURE NO. 049-W019	F.A.P. R.T.E. = 330	SECTION = 128R-3	COUNTY = LAKE	TOTAL SHEETS = 518	SHEET NO. = 301		
PLOT SCALE =	CHECKED - B.N.S.	REVISIONS -	SHEET NO. S3-1 OF S3-9 SHEETS			CONTRACT NO. 60953		ILLINOIS FED. AID PROJECT				
PLOT DATE =	DRAWN - F.M.	REVISIONS -										
	CHECKED - B.N.S./J.C.N.	REVISIONS -										