

- GENERAL NOTES:**
1. Reinforcement Bars shall conform to the requirements of ASTM A 706, Gr. 60. See Special Provisions.
  2. All Exposed Concrete edges shall be chamfered  $\frac{3}{4}$ " unless otherwise noted.
  3. Reinforcement Bars designated (E) shall be Epoxy Coated.

**BILL OF MATERIAL**

Bar	No.	Size	Length	Shape
h(E)	40	#5	28'-6"	—
h1(E)	22	#5	25'-10"	—
h2(E)	18	#5	21'-3"	—
h3(E)	6	#5	11'-3"	—
h4(E)	8	#5	4'-0"	—
n(E)	100	#5	4'-1"	L
n1(E)	100	#7	5'-10"	L
t(E)	104	#7	11'-5"	—
t1(E)	110	#5	11'-5"	—
v(E)	52	#5	8'-0"	—
v1(E)	52	#5	8'-7"	—
v2(E)	52	#5	9'-2"	—
v3(E)	24	#5	9'-9"	—
v4(E)	20	#5	7'-11"	—
w(E)	66	#5	32'-3"	—
w1(E)	22	#5	9'-8"	—
w2(E)	11	#5	5'-7"	—
w3(E)	11	#5	7'-2"	—
Reinforcement Bars, Epoxy Coated			Pound	12,030
Concrete Structures			Cu Yd	80.2

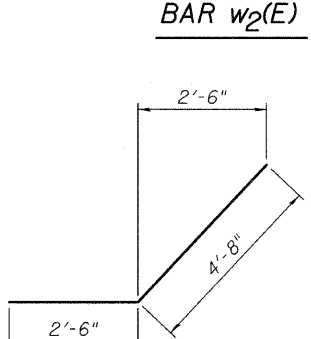
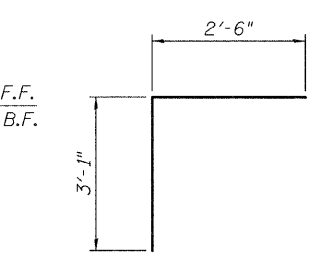
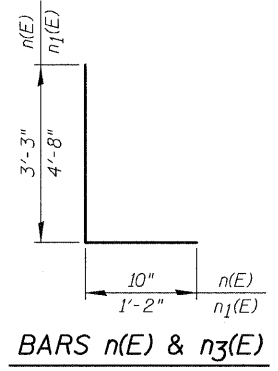

**MIN. BAR LAP:**  
 #5 bars = 2'-6"  
 #7 bars = 3'-11"

- LEGEND:**
- E.F. = Each Face
  - F.F. = Front Face
  - B.F. = Back Face
  - C.I.P. = Cast-In-Place
  - ⊙ = Construction Joint
  - ⊕ = Expansion Joint
  - 1 = Panel Numbers

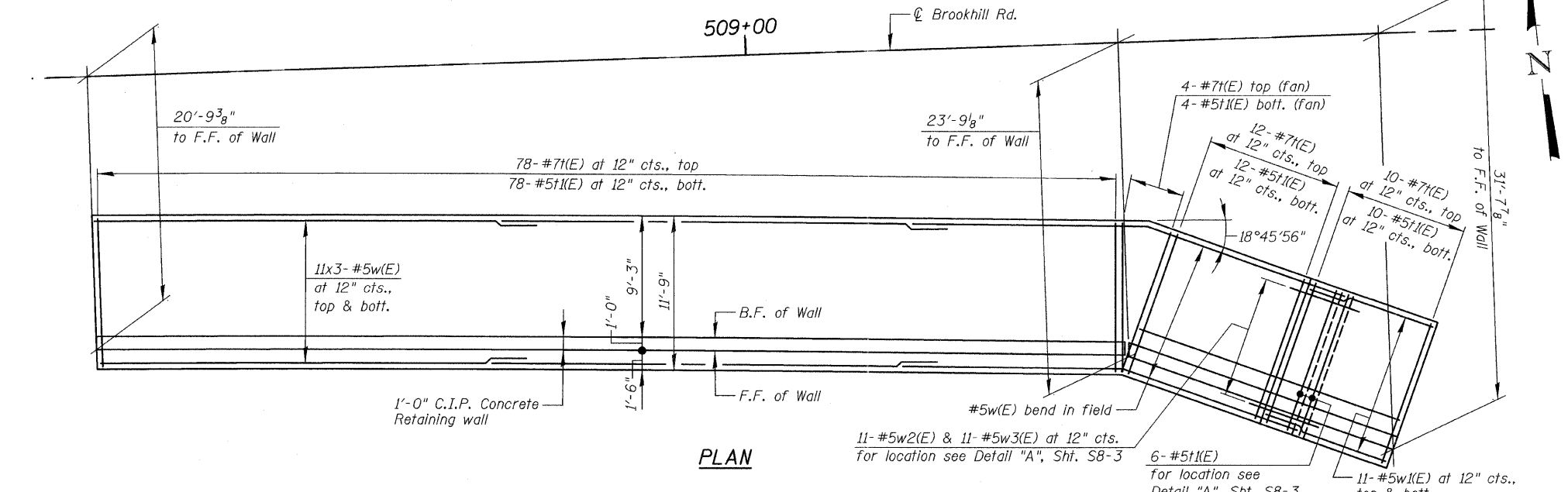

**PLAN & ELEVATION  
 STRUCTURE NO. 049-W042**



FILE NAME = D168953-02-plan.elev.dgn	USER NAME =	DESIGNED - J.C.N./B.N.S.	REVISED -	<b>STATE OF ILLINOIS DEPARTMENT OF TRANSPORTATION</b>	<b>PLAN &amp; ELEVATION STRUCTURE NO. 049-W042</b>	F.A.P. RTE. = 330	SECTION = 128R-3	COUNTY = LAKE	TOTAL SHEETS = 518	SHEET NO. = 337
PLOT SCALE =	CHECKED - B.N.S.	REVISED -	CONTRACT NO. 60953							
PLOT DATE =	DRAWN - F.M.	REVISED -								
	CHECKED - B.N.S./J.C.N.	REVISED -								

SHEET NO. S8-2 OF S8-4 SHEETS

ILLINOIS FED. AID PROJECT