

DATE	
BY	
SURVEYED	
PLOTTED	
NOTE BOOK	
AREAS CHECKED	
NO.	

DATE	
BY	
ORIGINAL SURVEY	
NOTE BOOK	
AREAS CHECKED	
NO.	

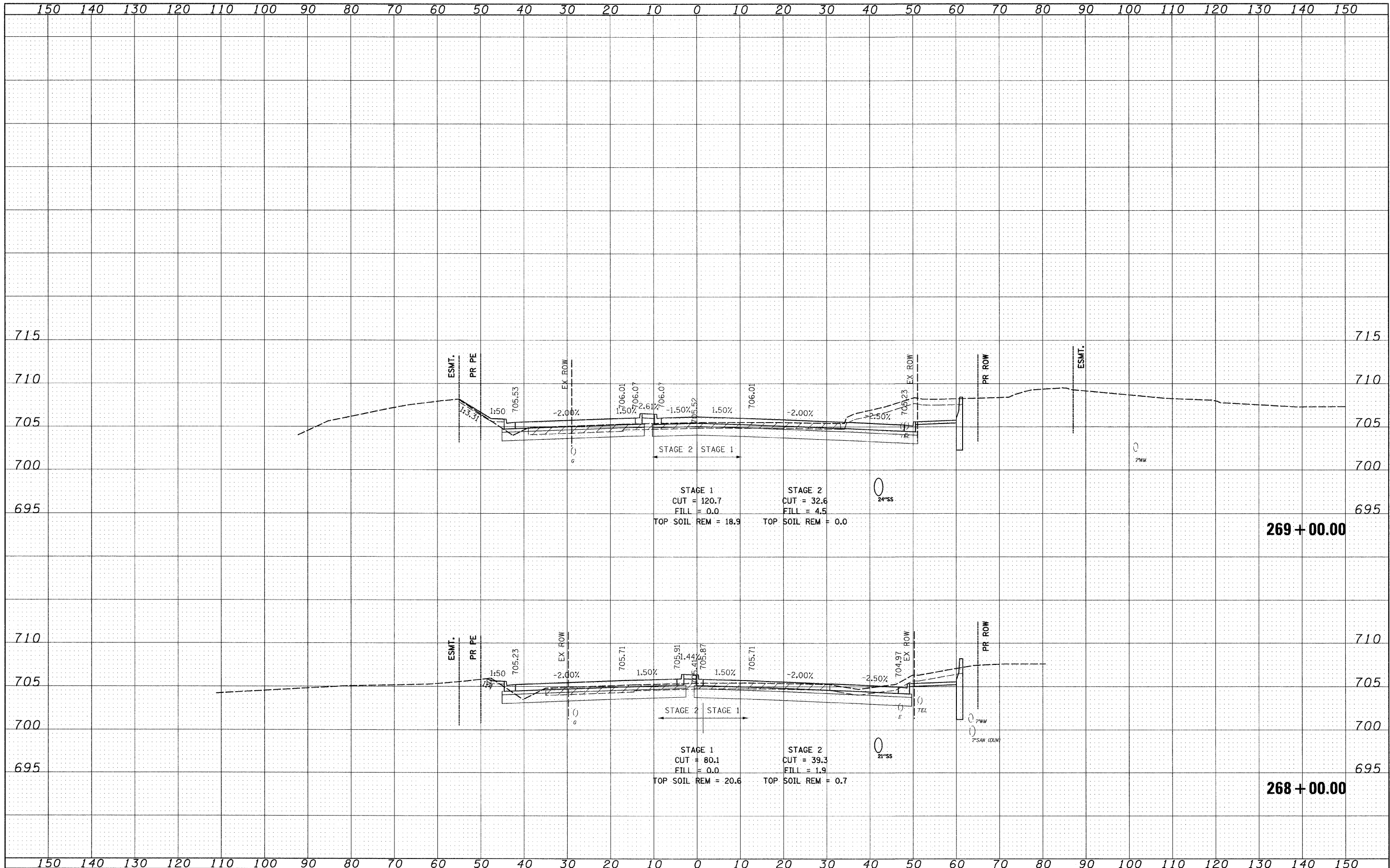

FILE NAME = I:\102901\CADD Sheets\shh-xsec-IL21-12-16-10.dgn	USER NAME = IDOT	DESIGNED - PDK	REVISED -	STATE OF ILLINOIS DEPARTMENT OF TRANSPORTATION	IL RTE 21 CROSS SECTIONS			F.A. RTE 330	SECTION 128R-3	COUNTY LAKE	TOTAL SHEETS 518	SHEET NO. 463
PLOT SCALE = 10.0000' / IN.	CHECKED - MRH	REVISED -	REVISED -		SCALE:	SHEET NO.	OF SHEETS	STA. 268+00.00	TO STA. 269+00.00	CONTRACT NO. 60953		
PLOT DATE = 7/8/2011	DATE - 12/22/2010	REVISED -	REVISED -		ILLINOIS FED. AID PROJECT							