

F.A. RTE.	SECTION	COUNTY	TOTAL SHEETS	SHEET NO.
VAR.	2010-124-1	VAR.	21	1
FED. ROAD DIST. NO 1	ILLINOIS	CONTRACT NO. 60M86		

STATE OF ILLINOIS
DEPARTMENT OF TRANSPORTATION
DIVISION OF HIGHWAYS

**PROPOSED
HIGHWAY PLANS**

VARIOUS ROUTES
SECTION 2010-124-1
VARIOUS LOCATIONS
SCOUR COUNTERMEASURES
LAKE AND MCHENRY COUNTIES
C-91-182-11

FOR INDEX OF SHEETS, SEE SHEET NO. 2

IMPROVEMENTS LOCATED IN THE
VILLAGE OF GURNEE
VILLAGE OF SPRING GROVE
VILLAGE OF RICHMOND

DISTRICT ONE - PLAN PREPARATION ENGINEER: KEN ENG: (847) 705-4247

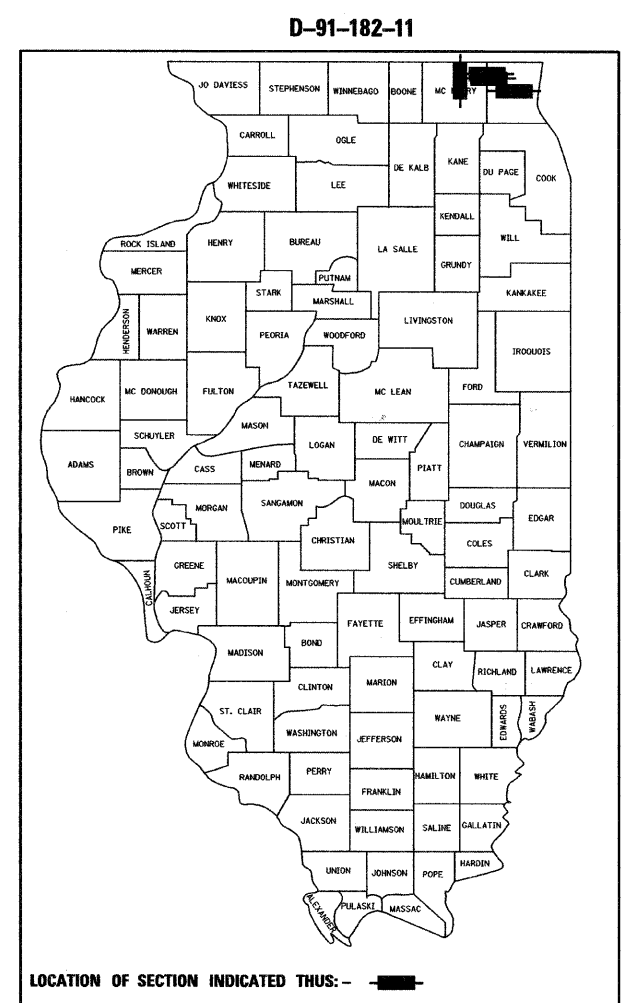

STATE OF ILLINOIS
DEPARTMENT OF TRANSPORTATION
DIVISION OF HIGHWAYS

SUBMITTED JULY 21 20 11

Diane M. O'Keefe
DEPUTY DIRECTOR OF HIGHWAYS, REGION ENGINEER

August 19 20 11
Scott E. Stitt P.E.
ENGINEER OF DESIGN AND ENVIRONMENT

August 19 20 11
Christine M. Rooden
DIRECTOR OF HIGHWAYS, CHIEF ENGINEER

PROFESSIONAL ENGINEER'S SIGN & SEAL

Christopher M. Huetten

EXPIRES: 11-30-2011

PRINTED BY THE AUTHORITY
OF THE STATE OF ILLINOIS

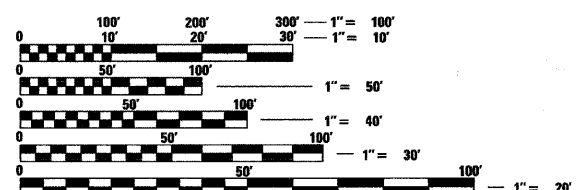

FULL SIZE PLANS HAVE BEEN PREPARED USING STANDARD ENGINEERING SCALES. REDUCED SIZED PLANS WILL NOT CONFORM TO STANDARD SCALES. IN MAKING MEASUREMENTS ON REDUCED PLANS, THE ABOVE SCALES MAY BE USED.

J.U.L.I.E.
JOINT UTILITY LOCATION INFORMATION FOR EXCAVATION
1-800-892-0123
OR 811

CONTRACT NO. 60M86

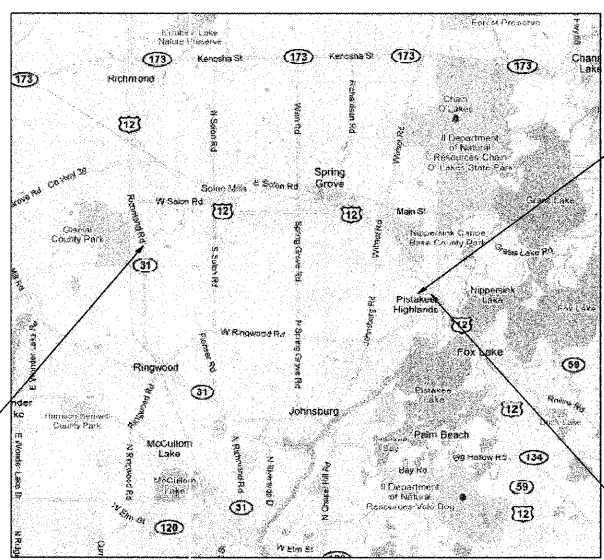

LOCATION 4: S.N. 056-0037, ILLINOIS ROUTE 31 OVER NIPPERSINK CREEK

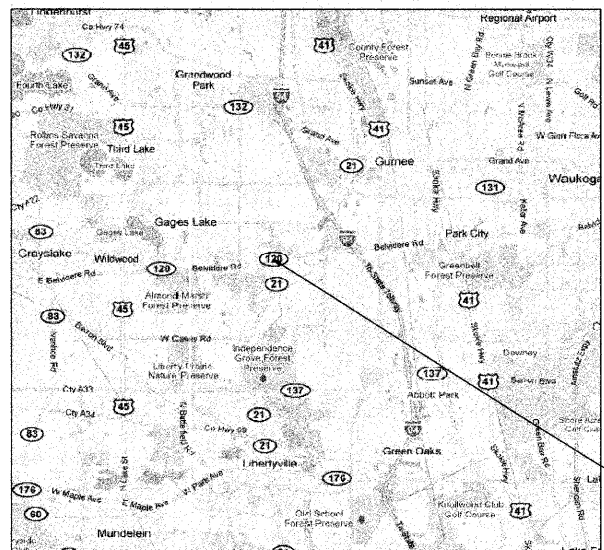

INDEX OF SHEETS

1	COVER SHEET
2	INDEX OF SHEETS, LIST OF STATE STANDARDS, AND GENERAL NOTES SCOUR COUNTERMEASURES
3	SUMMARY OF QUANTITIES
4	LOCATION MAPS
5-6	SCOUR COUNTERMEASURES - ILLINOIS ROUTE 120 OVER A STREAM
7-8	SCOUR COUNTERMEASURES - U.S. ROUTE 12 OVER NIPPERSINK CREEK
9-10	SCOUR COUNTERMEASURES - U.S. ROUTE 12 OVER NIPPERSINK CREEK OVERFLOW
11-12	SCOUR COUNTERMEASURES - ILLINOIS ROUTE 31 OVER NIPPERSINK CREEK
13-16	CROSS SECTIONS SCOUR COUNTERMEASURES
17	TRAFFIC CONTROL AND PROTECTION FOR SIDE ROADS, INTERSECTIONS, AND DRIVEWAYS
18	ARTERIAL ROAD INFORMATION SIGN
19-21	DEWATERING SYSTEM DETAILS SCOUR COUNTERMEASURES

LIST OF STATE STANDARDS

STANDARD NO.	DESCRIPTION
701006-03	OFF-RD OPERATIONS, 2L, 2W, 15' TO 24" FROM PAVEMENT EDGE
701426-04	LANE CLOSURE, MULTILANE, INTERMITTENT OR MOVING OPER., FOR SPEEDS >= 45 MPH
701501-06	URBAN LANE CLOSURE, 2L, 2W, UNDIVIDED
701601-07	URBAN LANE CLOSURE, MULTILANE, 1W OR 2W WITH NONTRAVERSABLE MEDIAN
701602-05	URBAN LANE CLOSURE, MULTILANE, 2W WITH BIDIRECTIONAL LEFT TURN LANE
701901-01	TRAFFIC CONTROL DEVICES

GENERAL NOTES

1. BEFORE STARTING ANY EXCAVATION, THE CONTRACTOR SHALL CALL "JULIE" (JOINT UTILITY LOCATION INFORMATION FOR EXCAVATION) AT 8-1-1 OR (800) 892-0123 FOR FIELD LOCATIONS OF BURIED ELECTRIC, TELEPHONE, AND GAS FACILITIES (48 HOUR NOTIFICATION IS REQUIRED).
2. THE CONTRACTOR WILL NOT BE ALLOWED TO SET UP A YARD OR FIELD OFFICE ON STATE PROPERTY WITHOUT WRITTEN PERMISSION FROM THE DEPARTMENT.
3. EXCAVATION INTO THE STREAM BED FOR STONE RIPRAP INSTALLATION SHALL NOT BE DEEPER THAN THE BOTTOM OF THE FOOTING ON THE PIER OR ABUTMENT TO BE PROTECTED.
4. DEBRIS REMOVAL, IF ENCOUNTERED, SHALL BE INCLUDED IN THE COST OF THE STONE RIPRAP.
5. IT SHALL BE THE CONTRACTORS RESPONSIBILITY TO VERIFY ALL DIMENSIONS & CONDITIONS EXISTING IN THE FIELD PRIOR TO CONSTRUCTION ORDERING OF MATERIAL.
6. THE CONTRACTOR SHALL CONTACT THE DISTRICT ONE ARTERIAL TRAFFIC CONTROL SUPERVISOR AT (847) 705-4470 A MINIMUM OF 72 HOURS IN ADVANCE OF BEGINNING WORK.
7. ALL AREAS (INCLUDING WETLAND AREAS) OUTSIDE THE LIMITS OF RIPRAP PLACEMENT AND/OR EXCAVATION WHICH ARE DISTURBED (WHERE EXISTING SOIL CONTOURS HAVE BEEN ALTERED AND/OR EXISTING VEGETATION HAD BEEN DESTROYED BY THE CONTRACTORS OPERATIONS) SHALL BE RESTORED BY REGRADING TO THE ORIGINAL CONTOURS AND/OR SEEDING WITH SEEDING, CLASS 4, AND MULCHING WITH EROSION CONTROL BLANKETS. PLACE TEMPORARY SEEDING AND TEMPORARY EROSION CONTROL BLANKETS AS NEEDED. THIS WORK WILL NOT BE PAID FOR SEPERATELY, BUT THE COSTS SHALL BE CONSIDERED INCLUDED IN THE CONTRACT UNIT PRICES FOR THE CONSTRUCTION ITEMS INVOLVED, AND NO ADDITIONAL COMPENSATION WILL BE ALLOWED.
8. THE CONTRACTOR IS ADVISED TO AVOID OR MINIMIZE ANY DISTURBANCE TO EXISTING VEGETATION OUTSIDE THE LIMITS OF RIPRAP PLACEMENT AND CHANNEL EXCAVATION.
9. THE CONTRACTOR MUST PROTECT PAVEMENT WHEN DUMPING RIPRAP ONTO PAVEMENT AND WILL BE RESPONSIBLE FOR RESTORING PAVEMENT MARKINGS.
10. ANY GUARDRAIL OR SIGNS DAMAGED BY THE CONTRACTOR'S OPERATIONS SHALL BE REPLACED IN KIND AT THE CONTRACTORS EXPENSE.
11. THE CONTRACTOR SHALL BE REQUIRED TO PROVIDE ACCESS TO ABUTTING PROPERTY AT ALL TIMES DURING THE CONSTRUCTION OF THIS PROJECT.
12. DO NOT SCALE PLANS FOR CONSTRUCTION DIMENSIONS.
13. THE CONTRACTOR SHALL SUBMIT DEWATERING AND SEDIMENT CONTROL PLANS FOR EACH SITE TO THE ENGINEER FOR APPROVAL.
14. THE CONTRACTOR SHALL CONTACT THE ENGINEER AFTER DEWATERING FOR FINAL RIPRAP OR SLOPE MATTRESS PLACEMENT.
15. NIGHT TIME CLOSURES WILL NOT BE REQUIRED FOR THIS PROJECT.
16. UNLESS OTHERWISE NOTED, EXCAVATION OF MATERIAL REQUIRED TO INSTALL STONE RIPRAP OR SLOPE MATTRESS SHALL BE INCLUDED IN THE ITEM BEING INSTALLED.

COMMITMENTS

1. FOR LOCATION 1 (ILLINOIS ROUTE 120 OVER STREAM), DUE TO THE PRESENCE OF THE STATE LISTED IOWA DARTER (ETHEOSTOMA EXILE) AT THE PROJECT LOCATION, NO INSTREAM WORK SHALL OCCUR FROM APRIL 1 THROUGH JUNE 30 OF ANY PROJECT YEAR.

COMPANY NAME: #COMPANY/NAME/ PROJECT CONTACT: #PROJECT/CONTACT/ CLIENT: #CLIENT/ DATE PLOTTED: 7/19/2011 4:56:16 PM PLOT NAME: #PROJECT/CONTACT/ PEN TABLE: #PROJECT/CONTACT/



USER NAME = SPernal	DESIGNED - C. HARTKE	REVISED -
PLOT SCALE =	DRAWN - S. PERNAL	REVISED -
PLOT DATE = 7/19/2011	CHECKED - T. HAMILTON	REVISED -
	DATE - 7/19/11	REVISED -

**STATE OF ILLINOIS
DEPARTMENT OF TRANSPORTATION**

**INDEX OF SHEETS, LIST OF STATE STANDARDS, AND GENERAL NOTES
SCOUR COUNTERMEASURES**

SCALE: SHEET NO. 1 OF 1 SHEETS STA. TO STA.

F.A. RTE.	SECTION	COUNTY	TOTAL SHEETS	SHEET NO.
VAR.	2010-124-I	VAR.	21	2
FED. ROAD DIST. NO. ILLINOIS FED. AID PROJECT			CONTRACT NO. 60M86	

TRAFFIC DATA
 SPEED LIMIT = 55 MPH
 2009 ADT = 37,900

LOCATION 1 - LAKE COUNTY
 STRUCTURE NUMBER: 049-0044 (WB) & 049-0045 (EB)
 ILLINOIS ROUTE 120 OVER A STREAM
 LOCATED IN WARREN TOWNSHIP
 VILLAGE OF GURNEE

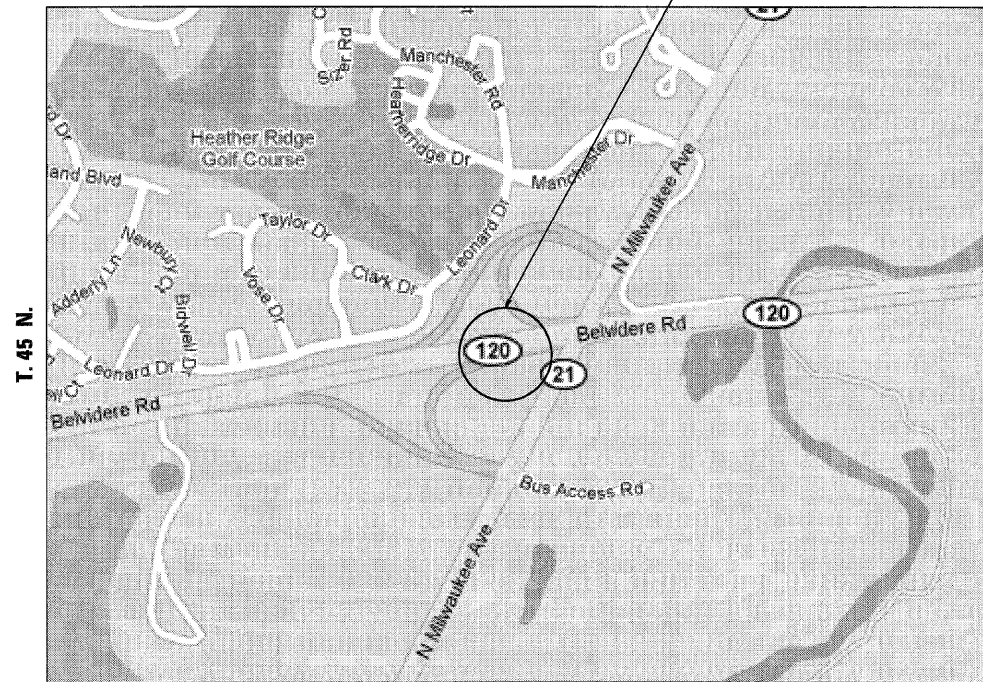

R. 11 E.

TRAFFIC DATA
 SPEED LIMIT = 45 MPH
 2009 ADT = 13,200

LOCATION 2 - MCHENRY COUNTY
 STRUCTURE NUMBER: 056-0057
 U.S. ROUTE 12 OVER NIPPERSINK CREEK
 LOCATED IN MCHENRY TOWNSHIP
 VILLAGE OF SPRING GROVE

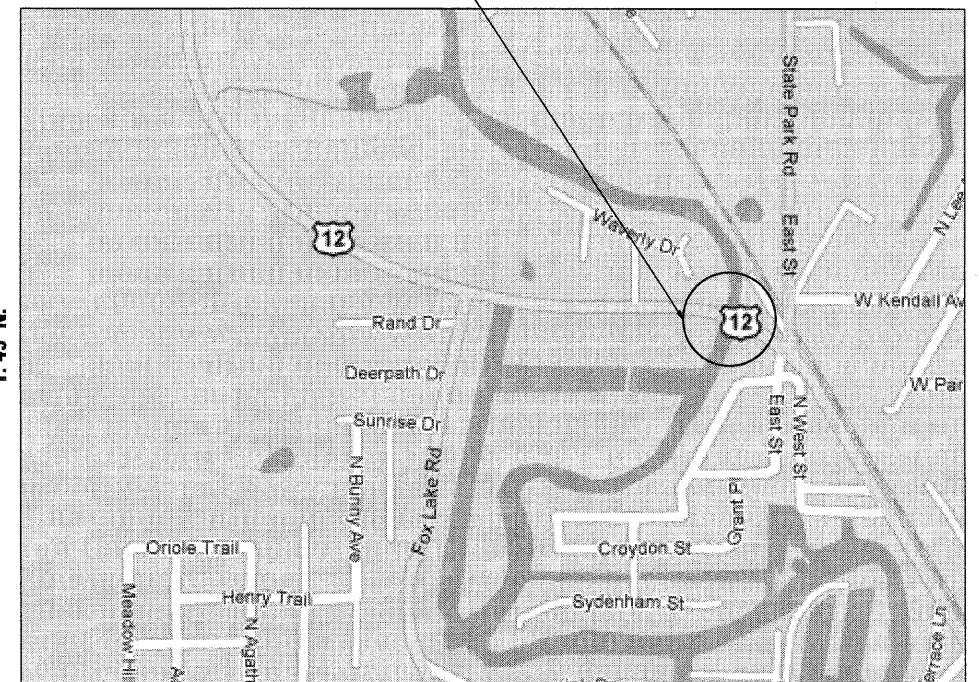

R. 9 E.

TRAFFIC DATA
 SPEED LIMIT = 45 MPH
 2009 ADT = 13,200

LOCATION 3 - MCHENRY COUNTY
 STRUCTURE NUMBER: 056-0020
 U.S. ROUTE 12 OVER NIPPERSINK CREEK OVERFLOW
 LOCATED IN BURTON AND MCHENRY TOWNSHIPS
 VILLAGE OF SPRING GROVE

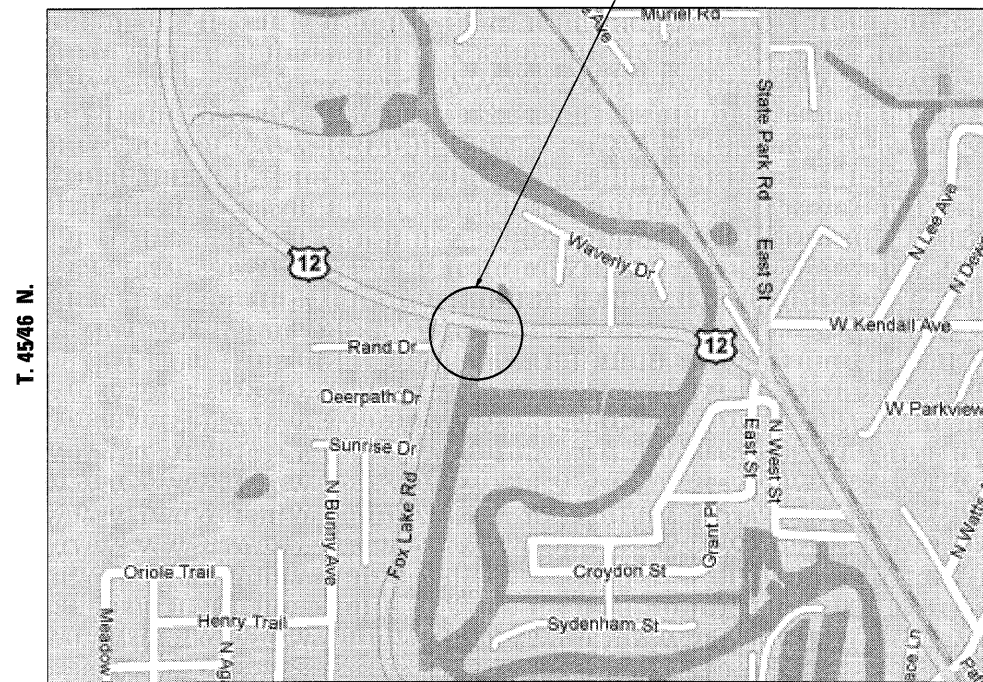

R. 9 E.

TRAFFIC DATA
 SPEED LIMIT = 55 MPH
 2009 ADT = 5,600

LOCATION 4 - MCHENRY COUNTY
 STRUCTURE NUMBER: 056-0037
 ILLINOIS ROUTE 31 OVER NIPPERSINK CREEK
 LOCATED IN RICHMOND TOWNSHIP
 VILLAGE OF RICHMOND

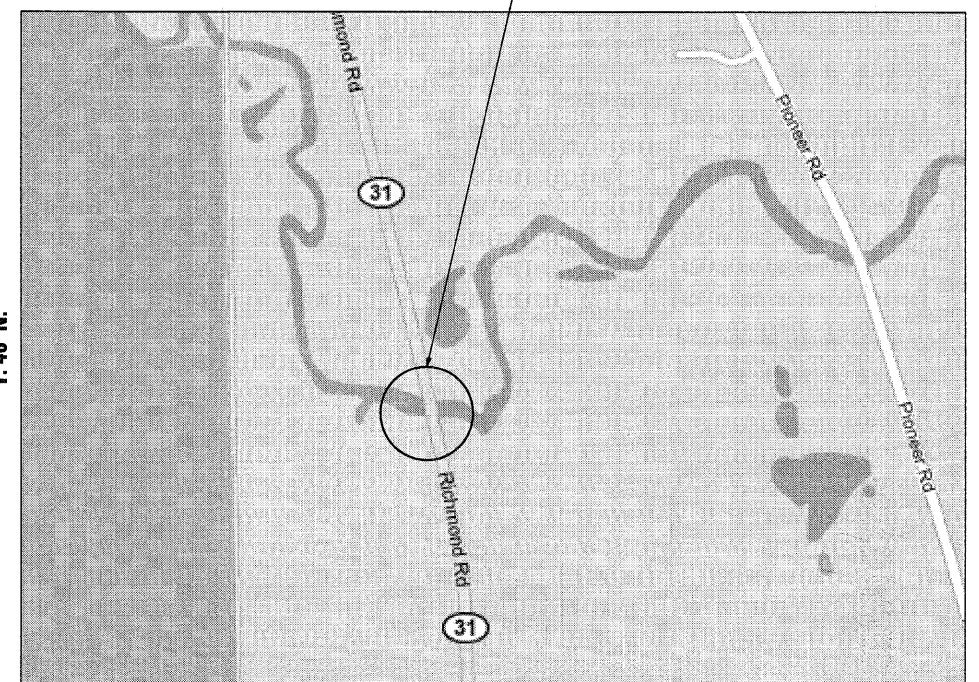

R. 8 E.



COMPANY NAME: HRGreen.com
 PROJECT CONTACT: S. PERNAL
 CLIENT: OTTEB
 FILE NAME: 0610196.05-6086-location.dgn
 PLOT DRIVER: pdf.plt
 STANDARD: TRANS.TBL



USER NAME = SPernal	DESIGNED - C. HARTKE	REVISED -
PLOT SCALE = N/A	DRAWN - S. PERNAL	REVISED -
PLOT DATE = 7/28/2011	CHECKED - T. HAMILTON	REVISED -
	DATE - 7/20/11	REVISED -

STATE OF ILLINOIS
 DEPARTMENT OF TRANSPORTATION

LOCATION MAPS
 SCOUR COUNTERMEASURES

SCALE: N/A SHEET NO. 1 OF 1 SHEETS STA. TO STA.

F.A. RTE.	SECTION	COUNTY	TOTAL SHEETS	SHEET NO.
VAR.	2010-124-1	VAR.	21	4
CONTRACT NO. 60M86				
FED. ROAD DIST. NO. ILLINOIS FED. AID PROJECT				

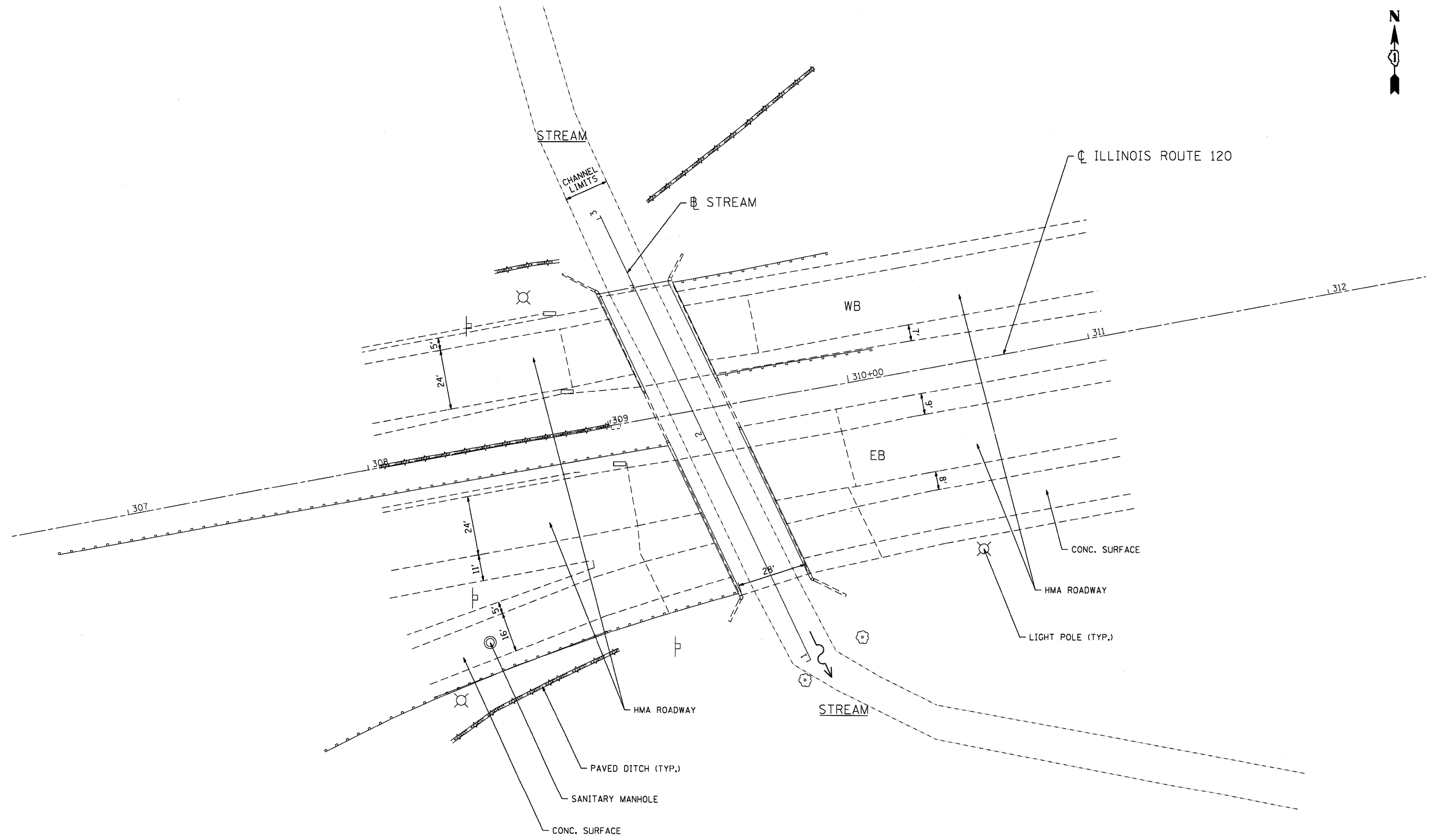

COMPANY NAME: HRGreen.com
 PROJECT CONTACT: S. PERNAL
 CLIENT: ILLINOIS DEPARTMENT OF TRANSPORTATION
 FILE NAME: 049-0044-01.dgn
 PLOT DATE: 7/19/2011



USER NAME = SPernal	DESIGNED - C. HARTKE	REVISED -
PLOT SCALE = 1"=20'	DRAWN - S. PERNAL	REVISED -
PLOT DATE = 7/19/2011	CHECKED - T. HAMILTON	REVISED -
	DATE - 7/19/11	REVISED -

STATE OF ILLINOIS
DEPARTMENT OF TRANSPORTATION

SITE PLAN
ILLINOIS ROUTE 120 OVER STREAM

SCALE: 1"=20' SHEET NO. 1 OF 2 SHEETS STA. 308+00 TO STA. 311+00

F.A. RTE.	SECTION	COUNTY	TOTAL SHEETS	SHEET NO.
VAR.	2010-124-1	VAR.	21	5
FED. ROAD DIST. NO. 049-0044-01			CONTRACT NO. 60M86	
ILLINOIS FED. AID PROJECT				

LEGEND

 SLOPE MATTRESS (18.0" THICK)

BM 1: 1 1/2" REBAR 55' WEST OF BRIDGE (BEHIND EB CORE)
ELEV. = 677.27
BM 2: 1 1/2" REBAR 70' EAST OF BRIDGE (OFF EB SHOULDER)
ELEV. = 672.32

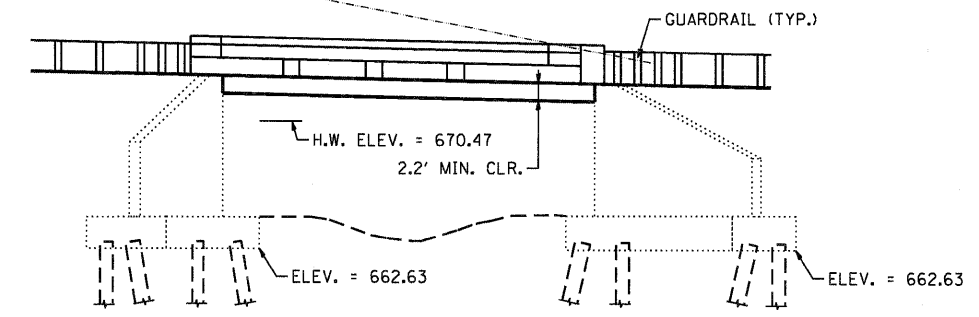
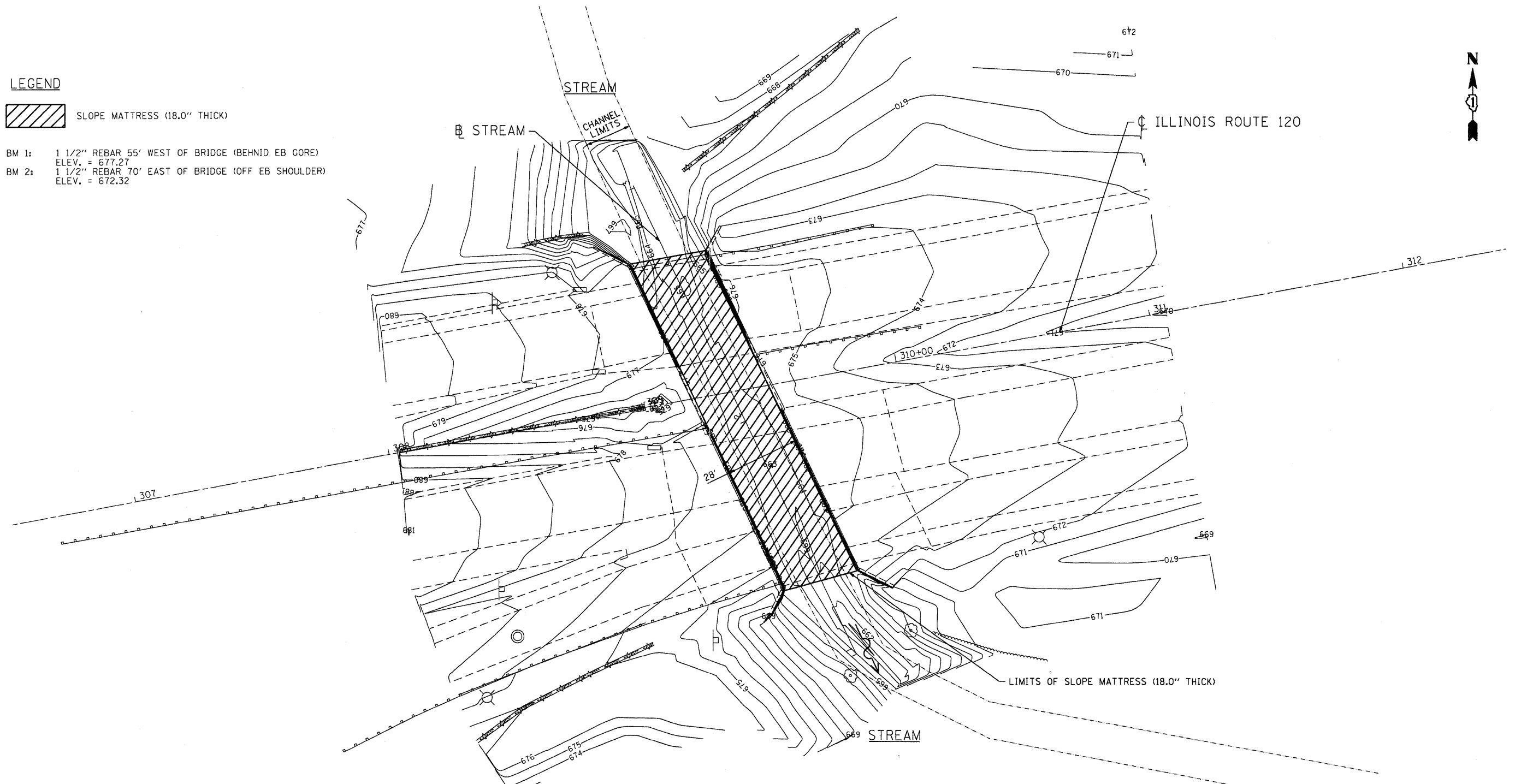

BRIDGE ELEVATION
NOT TO SCALE

ACCESS TO THIS SITE IS LIMITED. THE CONTRACTOR SHALL ONLY ACCESS THIS SITE BY RAISING AND/OR LOWERING ALL EQUIPMENT AND MATERIAL OVER THE SIDES OF THE BRIDGE. THE CONTRACTOR WILL NOT BE ALLOWED OTHER ACCESS WITHOUT WRITTEN PERMISSION FROM THE ENGINEER. THIS WORK WILL NOT BE PAID FOR SEPARATELY, BUT SHALL BE CONSIDERED AS INCLUDED IN THE CONTRACT UNIT PRICES FOR THE CONSTRUCTION ITEMS INVOLVED AND NO ADDITIONAL COMPENSATION WILL BE ALLOWED.

COMPANY NAME: HRGreen.com
PROJECT CONTACT: S.Pernal
CLIENT: ILLINOIS DEPARTMENT OF TRANSPORTATION
FILE NAME: 6086-eros-01.dgn
PLOT DRIVER: pldrvr
PEN TABLE: standard-trans.tbl



USER NAME = S.Pernal	DESIGNED - C. HARTKE	REVISED -
PLOT SCALE = 1"=20'	DRAWN - S. PERNAL	REVISED -
PLOT DATE = 7/19/2011	CHECKED - T. HAMILTON	REVISED -
	DATE - 7/19/11	REVISED -

**STATE OF ILLINOIS
DEPARTMENT OF TRANSPORTATION**

**EROSION AND SEDIMENT CONTROL PLAN
ILLINOIS ROUTE 120 OVER STREAM**

SCALE: 1"=20' SHEET NO. 2 OF 2 SHEETS STA. 308+00 TO STA. 311+00

F.A. RTE.	SECTION	COUNTY	TOTAL SHEETS	SHEET NO.
VAR.	2010-124-1	VAR.	21	6
S.N. 049-0044 & 049-0045		CONTRACT NO. 60M86		
FED. ROAD DIST. NO. [ILLINOIS] FED. AID PROJECT				

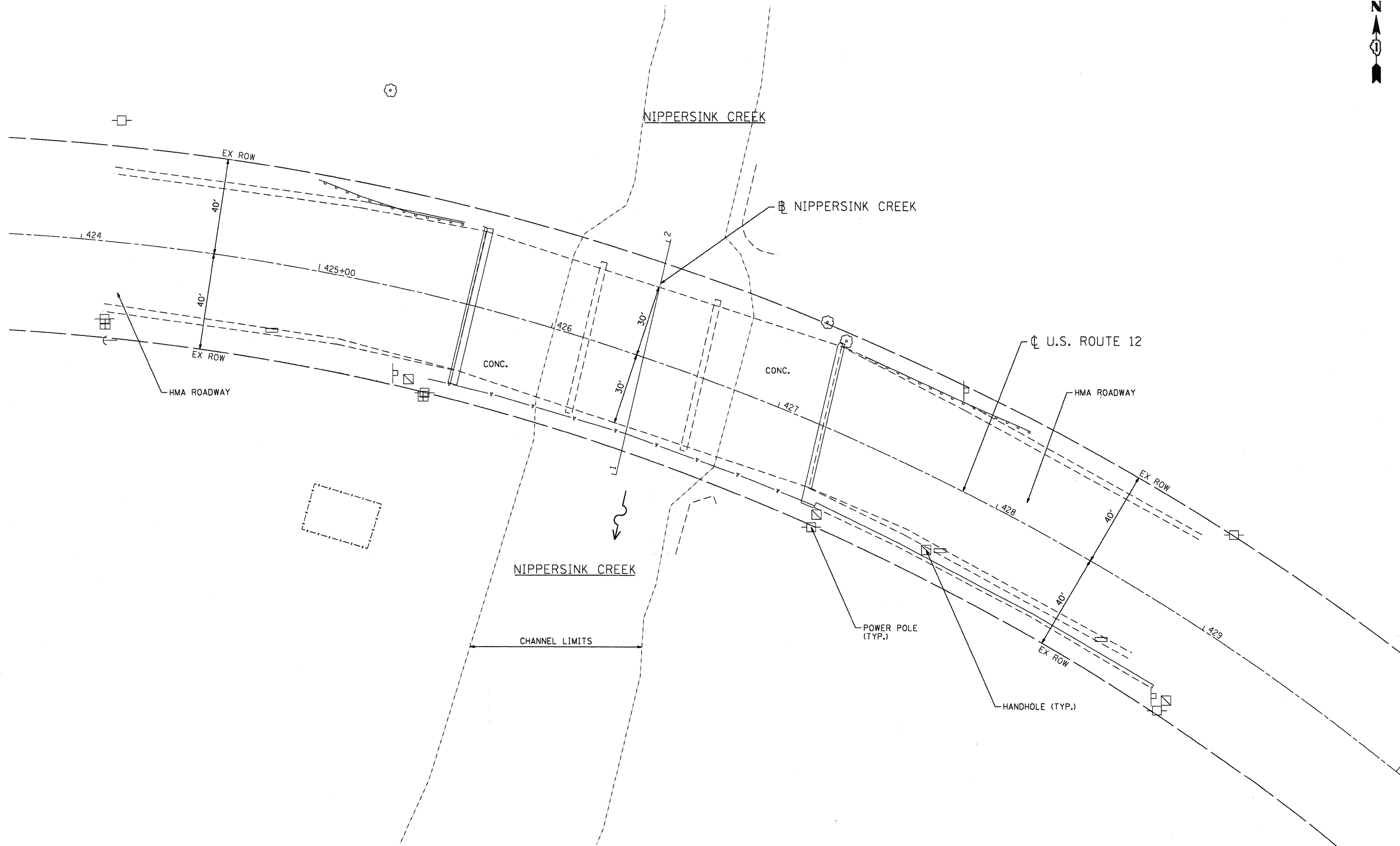

COMPANY NAME: #COMPANY_NAME
 PROJECT CONTACT: #PROJECT_CONTACT
 CLIENT: #CLIENT
 DATE PLOTTED: 7/19/2011 3:59:09 PM
 PLOT DRIVER: c:\program files\autodesk\civil 3d\bin\plotdrv14.dll
 PEN TABLE: standard-trans.tbl



USER NAME = SPernal	DESIGNED - C. HARTKE	REVISED -
PLOT SCALE = 1"=20'	DRAWN - S. PERNAL	REVISED -
PLOT DATE = 7/19/2011	CHECKED - T. HAMILTON	REVISED -
	DATE - 7/19/11	REVISED -

STATE OF ILLINOIS
DEPARTMENT OF TRANSPORTATION

SITE PLAN U.S. ROUTE 12 OVER NIPPERSINK CREEK	
SCALE: 1"=20'	SHEET NO. 1 OF 2 SHEETS
STA. 425+00	TO STA. 428+00

F.A. RTE.	SECTION	COUNTY	TOTAL SHEETS	SHEET NO.
VAR.	2010-124-1	VAR.	21	7
SN: 056-005F		CONTRACT NO. 60M86		
FED. ROAD DIST. NO. ILLINOIS FED. AID PROJECT				

86100186.03
 86100186.03 60M86-s11e-02.dgn

LEGEND

 SLOPE MATTRESS (18.0" THICK)

 STONE RIPRAP, CLASS A4 (2.3' THICK)

BM 1: MAG NAIL 45' EAST OF BRIDGE (OFF SB SHOULDER)
ELEV. = 748.81
BM 2: 5/8" IRON ROD 30' WEST OF BRIDGE (OFF NB SHOULDER)
ELEV. = 750.88

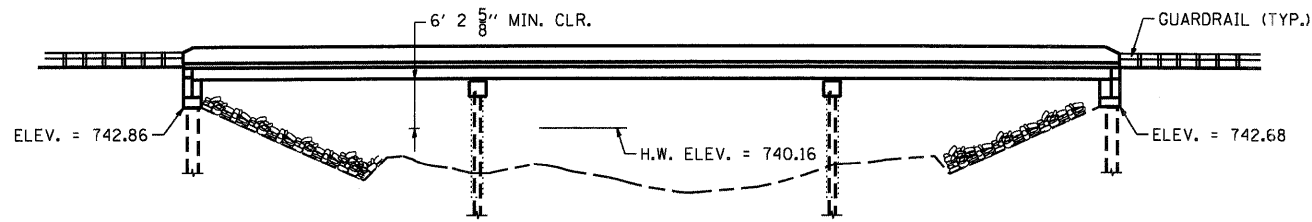
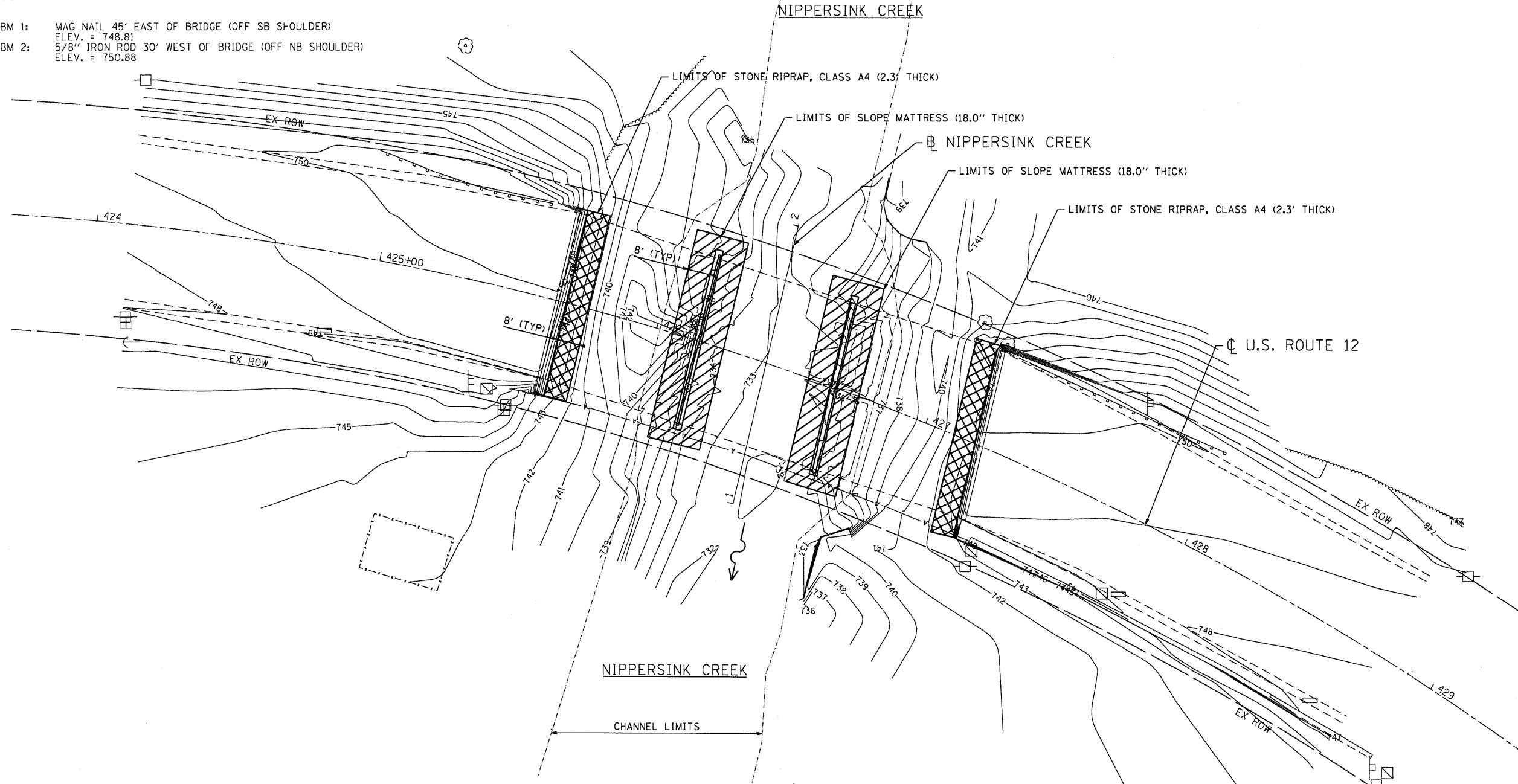

BRIDGE ELEVATION
NOT TO SCALE

ACCESS TO THIS SITE IS LIMITED. THE CONTRACTOR SHALL ONLY ACCESS THIS SITE BY RAISING AND/OR LOWERING ALL EQUIPMENT AND MATERIAL OVER THE SIDES OF THE BRIDGE. THE CONTRACTOR WILL NOT BE ALLOWED OTHER ACCESS WITHOUT WRITTEN PERMISSION FROM THE ENGINEER. THIS WORK WILL NOT BE PAID FOR SEPARATELY, BUT SHALL BE CONSIDERED AS INCLUDED IN THE CONTRACT UNIT PRICES FOR THE CONSTRUCTION ITEMS INVOLVED AND NO ADDITIONAL COMPENSATION WILL BE ALLOWED.

COMPANY NAME: HRGreen.com
PROJECT CONTACT: S. PERNAL
CLIENT: ILLINOIS DEPARTMENT OF TRANSPORTATION
FILE NAME: 6610196.03-6086-eros-02.dgn
PLOT DATE: 7/19/11
PEN TABLE: standard-trans.tbl



USER NAME = SPernal	DESIGNED - C. HARTKE	REVISED -
PLOT SCALE = 1"=20'	DRAWN - S. PERNAL	REVISED -
PLOT DATE = 7/19/2011	CHECKED - T. HAMILTON	REVISED -
	DATE - 7/19/11	REVISED -

**STATE OF ILLINOIS
DEPARTMENT OF TRANSPORTATION**

**EROSION AND SEDIMENT CONTROL PLAN
U.S. ROUTE 12 OVER NIPPERSINK CREEK**

SCALE: 1"=20' SHEET NO. 2 OF 2 SHEETS STA. 425+00 TO STA. 428+00

F.A. RTE.	SECTION	COUNTY	TOTAL SHEETS	SHEET NO.
VAR.	2010-124-1	VAR.	21	8
S.N. 056-0057			CONTRACT NO. 6086	
FED. ROAD DIST. NO. [ILLINOIS] FED. AID PROJECT				

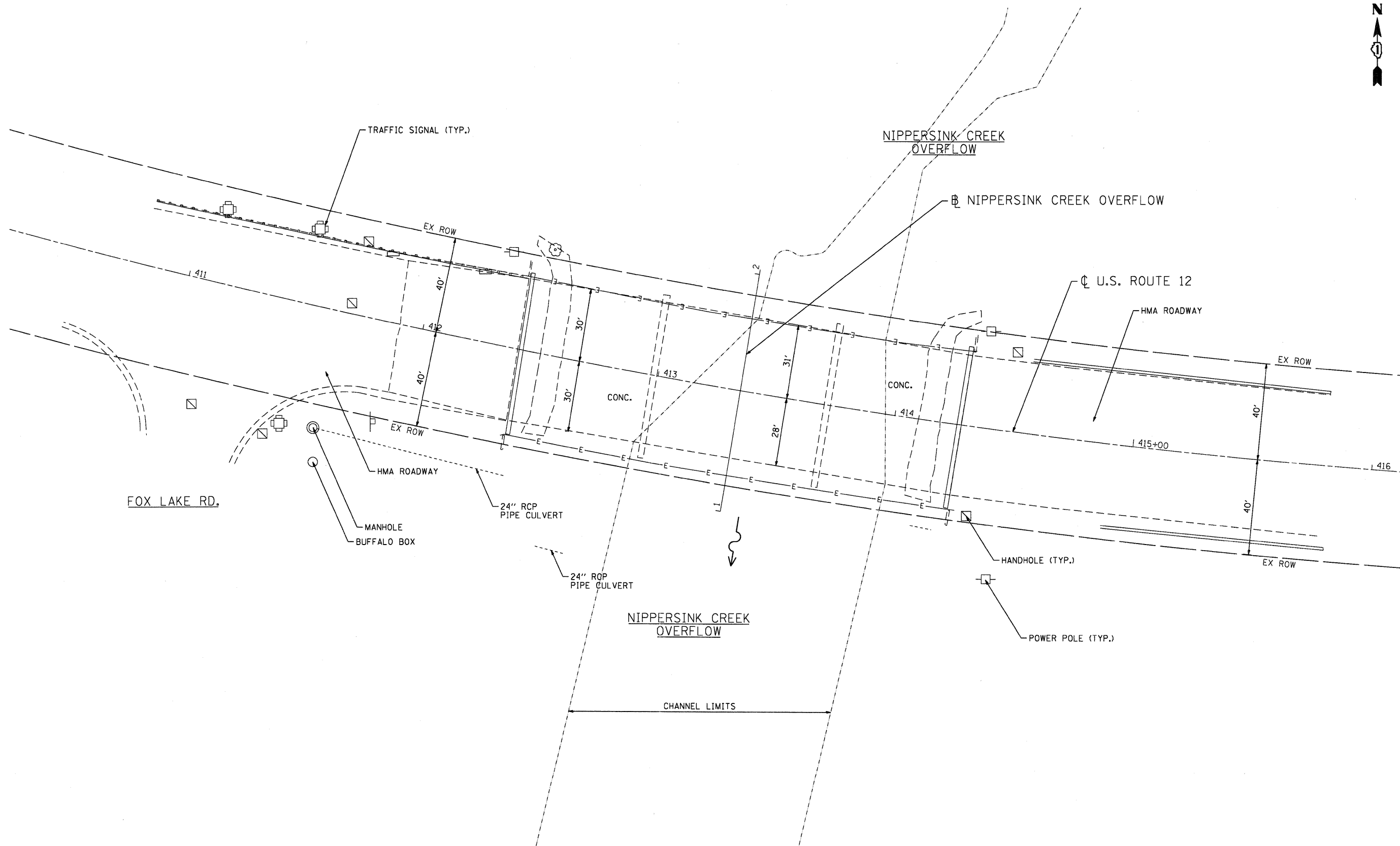

COMPANY NAME: #COMPANY_NAME/ HRGreen.com
 PROJECT CONTACT: #PROJECT_CONTACT/ Illinois Professional Design Firm
 CLIENT: #CLIENT/ #184-001322
 FILE COTTED: 3/28/11 PW
 FILE NAME: 602096.05-60M86-sf1e-03.dgn
 PLOT DRIVER: pdf.dwt
 PEN TABLE: standard-trans.tbl



USER NAME = SPernal	DESIGNED - C. HARTKE	REVISED -
PLOT SCALE = 1"=20'	DRAWN - S. PERNAL	REVISED -
PLOT DATE = 7/19/2011	CHECKED - T. HAMILTON	REVISED -
	DATE - 7/19/11	REVISED -

STATE OF ILLINOIS
DEPARTMENT OF TRANSPORTATION

SITE PLAN
U.S. ROUTE 12 OVER NIPPERSINK CREEK OVERFLOW
 SCALE: 1"=20' SHEET NO. 1 OF 2 SHEETS STA. 411+00 TO STA. 415+00

F.A. RTE.	SECTION	COUNTY	TOTAL SHEETS	SHEET NO.
VAR.	2010-124-1	VAR.	21	9
SN. 056-0020		CONTRACT NO. 60M86		
FED. ROAD DIST. NO.		ILLINOIS FED. AID PROJECT		

LEGEND

 SLOPE MATTRESS (12.0" THICK)

BM 1: CHISLED "X" 20' EAST OF BRIDGE (ON SB CURB)
ELEV. = 748.76
BM 2: CHISLED "X" 20' WEST OF BRIDGE (ON SB CURB)
ELEV. = 748.83

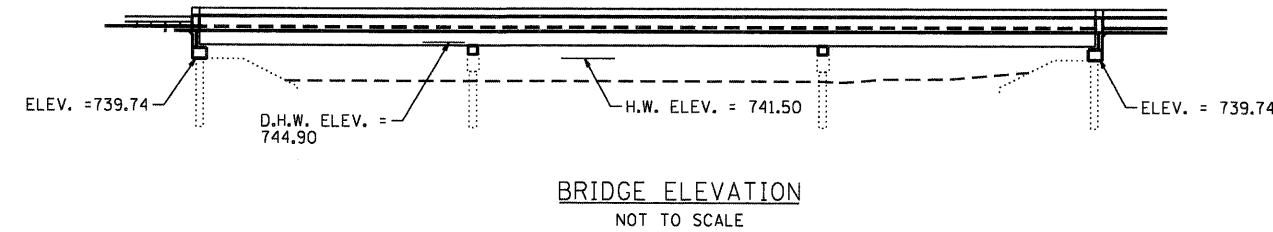
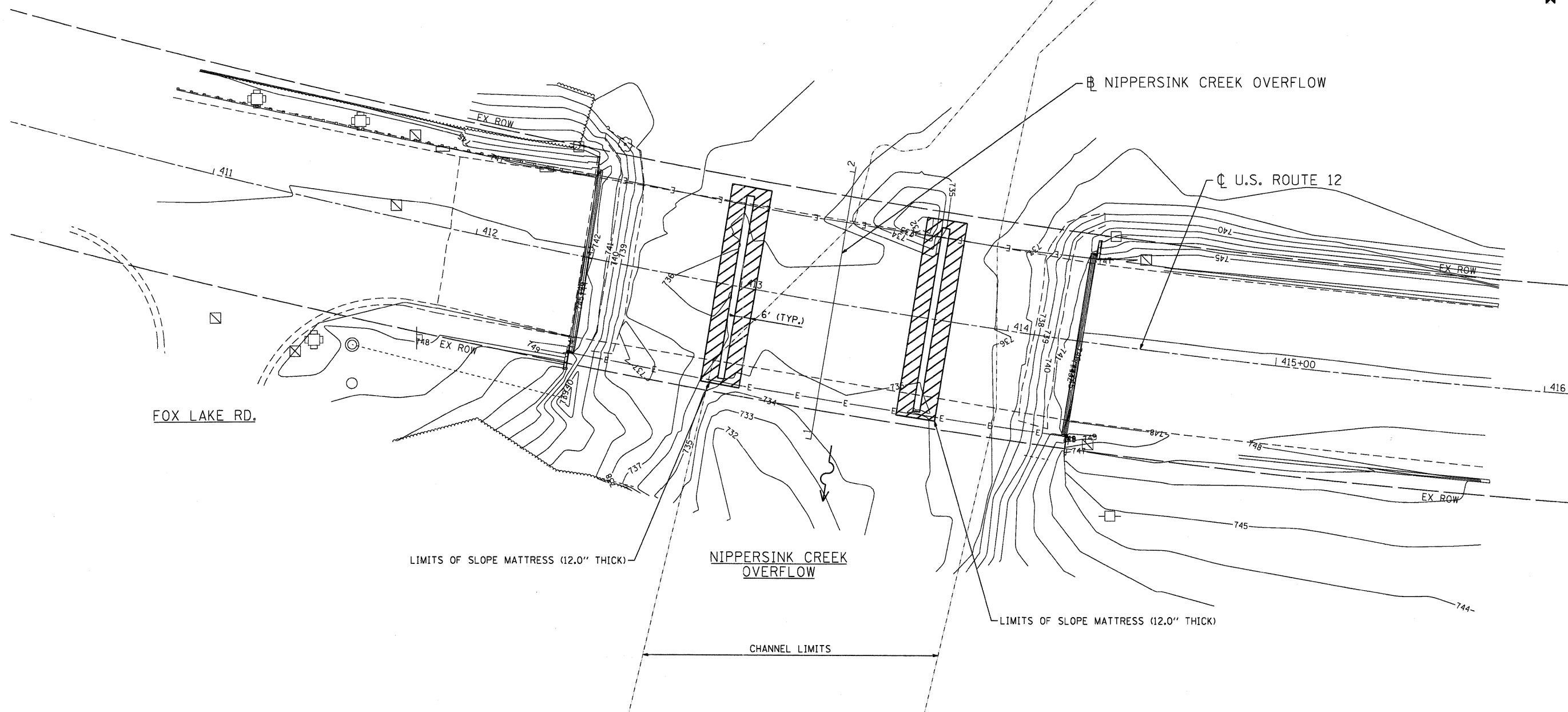

ACCESS TO THIS SITE IS LIMITED. THE CONTRACTOR SHALL ONLY ACCESS THIS SITE BY RAISING AND/OR LOWERING ALL EQUIPMENT AND MATERIAL OVER THE SIDES OF THE BRIDGE. THE CONTRACTOR WILL NOT BE ALLOWED OTHER ACCESS WITHOUT WRITTEN PERMISSION FROM THE ENGINEER. THIS WORK WILL NOT BE PAID FOR SEPARATELY, BUT SHALL BE CONSIDERED AS INCLUDED IN THE CONTRACT UNIT PRICES FOR THE CONSTRUCTION ITEMS INVOLVED AND NO ADDITIONAL COMPENSATION WILL BE ALLOWED.

COMPANY NAME: HRGreen
 PROJECT CONTACT: S. PERNAL
 CLIENT: ILLINOIS DEPARTMENT OF TRANSPORTATION
 FILE NAME: 60M86-er-os-03.dgn
 PLOT DRIVER: perf.plt
 PEN TABLE: standard-trans.tbl



USER NAME = SPernal	DESIGNED - C. HARTKE	REVISED -
PLOT SCALE = 1"=20'	DRAWN - S. PERNAL	REVISED -
PLOT DATE = 7/19/2011	CHECKED - T. HAMILTON	REVISED -
	DATE - 7/19/11	REVISED -

**STATE OF ILLINOIS
DEPARTMENT OF TRANSPORTATION**

**EROSION AND SEDIMENT CONTROL PLAN
U.S. ROUTE 12 OVER NIPPERSINK CREEK OVERFLOW**

SCALE: 1"=20' SHEET NO. 2 OF 2 SHEETS STA. 411+00 TO STA. 415+00

F.A. RTE.	SECTION	COUNTY	TOTAL SHEETS	SHEET NO.
VAR.	2010-124-1	VAR.	21	10
SN. 056-0020		CONTRACT NO. 60M86		
FED. ROAD DIST. NO. [ILLINOIS] FED. AID PROJECT				

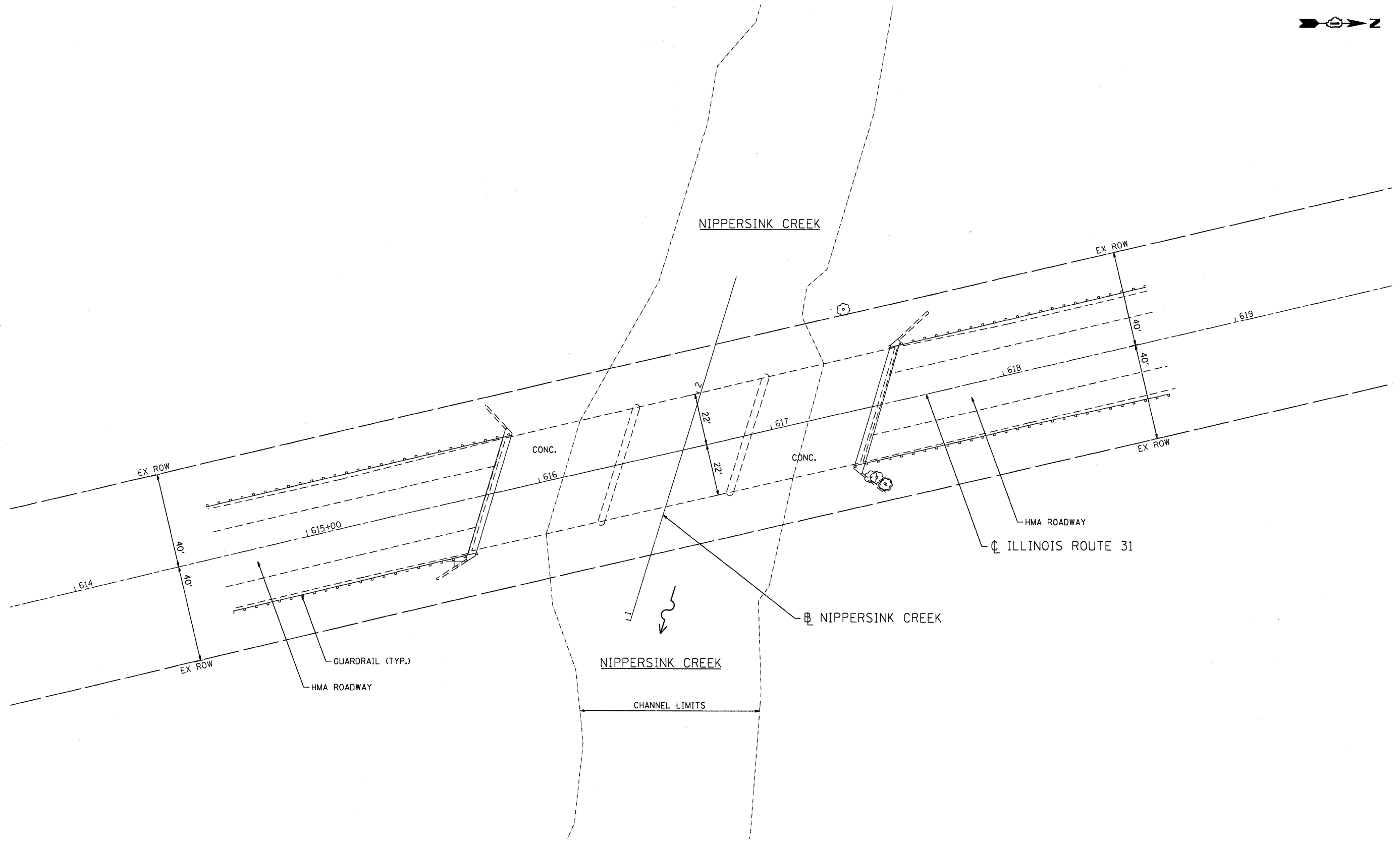

COMPANY NAME: HRGreen.com
 PROJECT CONTACT: S. PERNAL
 CLIENT: ILLINOIS DEPARTMENT OF TRANSPORTATION
 DATE PLOTTED: 7/19/2011 3:09:18 PM
 FILE NAME: 86100196.05-60M86-site-04.dgn
 PEN TABLE: Standard-trans.tbl



USER NAME = SPernal	DESIGNED - C. HARTKE	REVISED -
PLOT SCALE = 1"=20'	DRAWN - S. PERNAL	REVISED -
PLOT DATE = 7/19/2011	CHECKED - T. HAMILTON	REVISED -
	DATE - 7/19/11	REVISED -

STATE OF ILLINOIS
DEPARTMENT OF TRANSPORTATION

SITE PLAN
ILLINOIS ROUTE 31 OVER NIPPERSINK CREEK

SCALE: 1"=20' SHEET NO. 1 OF 2 SHEETS STA. 614+50 TO STA. 618+50

F.A. RTE.	SECTION	COUNTY	TOTAL SHEETS	SHEET NO.
VAR.	2010-124-1	VAR.	21	11
SN.056-003F		CONTRACT NO. 60M86		
FED. ROAD DIST. NO.		ILLINOIS FED. AID PROJECT		

86100196.05-60M86-site-04.dgn



LEGEND

 SLOPE MATTRESS (12.0" THICK)

 STONE RIPRAP, CLASS A4 (2.3' THICK)

BM 1: MAG NAIL 10' SOUTH OF BRIDGE (ON SB SHOULDER)
ELEV. = 776.86
BM 2: 1 1/2" IRON ROD 5' NORTH OF BRIDGE (BEHIND SB GUARDRAIL)
ELEV. = 776.53

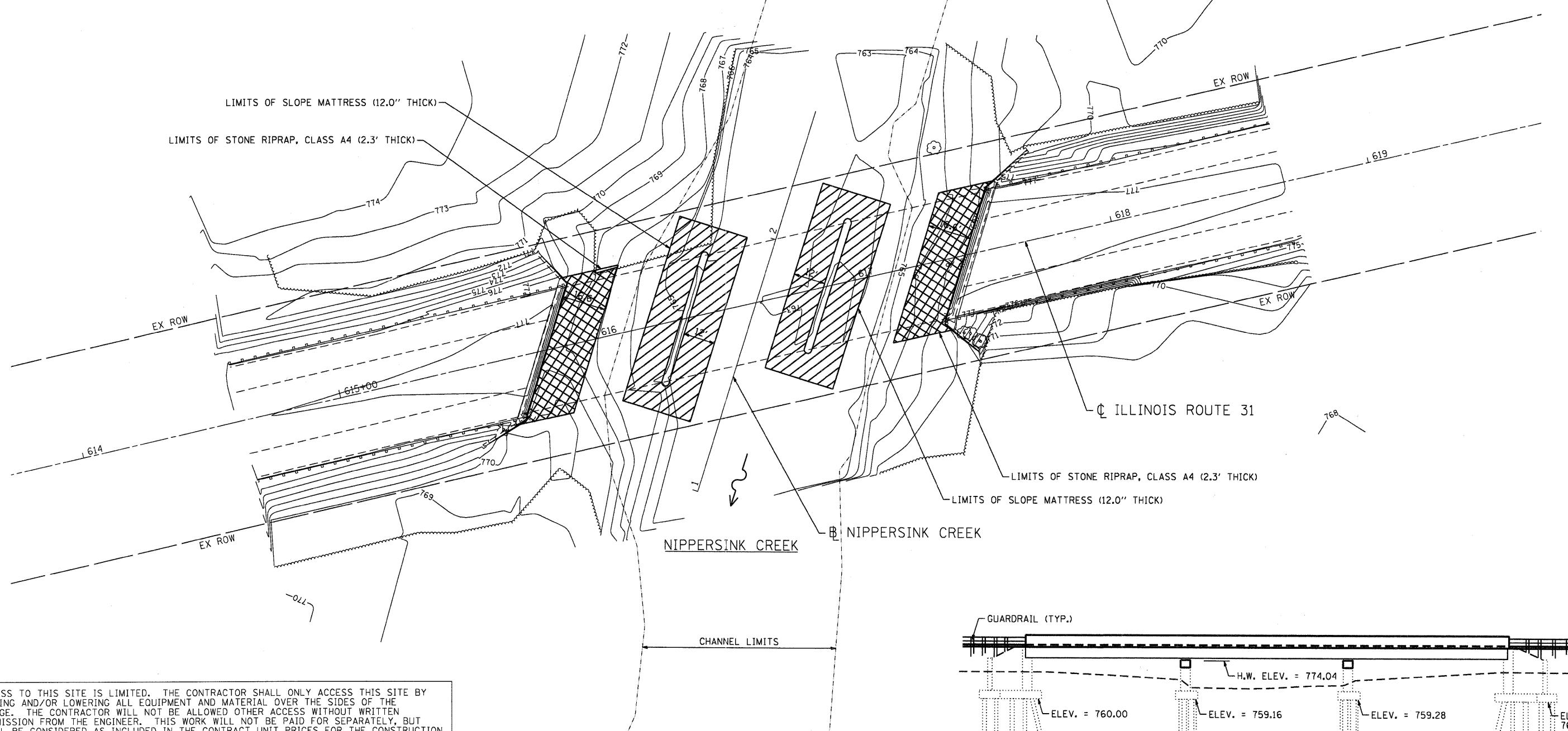

ACCESS TO THIS SITE IS LIMITED. THE CONTRACTOR SHALL ONLY ACCESS THIS SITE BY RAISING AND/OR LOWERING ALL EQUIPMENT AND MATERIAL OVER THE SIDES OF THE BRIDGE. THE CONTRACTOR WILL NOT BE ALLOWED OTHER ACCESS WITHOUT WRITTEN PERMISSION FROM THE ENGINEER. THIS WORK WILL NOT BE PAID FOR SEPARATELY, BUT SHALL BE CONSIDERED AS INCLUDED IN THE CONTRACT UNIT PRICES FOR THE CONSTRUCTION ITEMS INVOLVED AND NO ADDITIONAL COMPENSATION WILL BE ALLOWED.

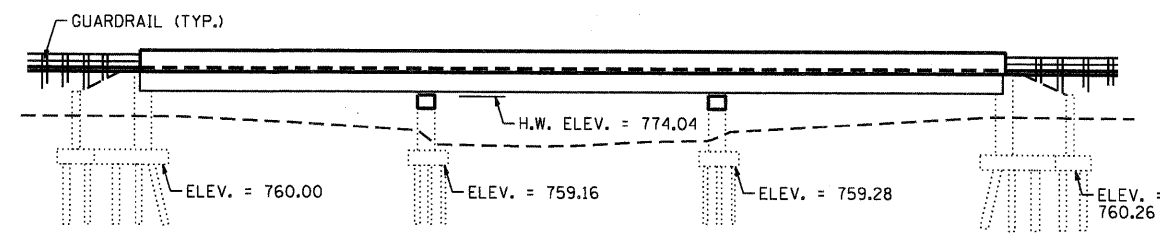

BRIDGE ELEVATION
NOT TO SCALE

COMPANY NAME: HRGreen.com
 PROJECT CONTACT: S. PERNAL
 CLIENT: ILLINOIS DEPARTMENT OF TRANSPORTATION
 DATE PLOTTED: 7/19/2011 3:59:20 PM
 PLOT DRIVER: s:\standard-trans.tbl
 PEN TABLE: s:\standard-trans.tbl



USER NAME = SPernal	DESIGNED - C. HARTKE	REVISED -
	DRAWN - S. PERNAL	REVISED -
PLOT SCALE = 1"=20'	CHECKED - T. HAMILTON	REVISED -
PLOT DATE = 7/19/2011	DATE - 7/19/11	REVISED -

**STATE OF ILLINOIS
DEPARTMENT OF TRANSPORTATION**

**EROSION AND SEDIMENT CONTROL PLAN
ILLINOIS ROUTE 31 OVER NIPPERSINK CREEK**

SCALE: 1"=20' SHEET NO. 2 OF 2 SHEETS STA. 614+50 TO STA. 618+50

F.A. RTE. VAR.	SECTION 2010-124-1	COUNTY VAR.	TOTAL SHEETS 21	SHEET NO. 12
SN 056-003F		CONTRACT NO. 60MB6		
FED. ROAD DIST. NO. ILLINOIS FED. AID PROJECT				

86100106.03
86100106.03-60MB6-eros-04.dgn

DATE _____
 BY _____
 SURVEYED _____
 PLOTTED _____
 TEMPLATE _____
 NOTE BOOK _____
 AREAS _____
 CHECKED _____
 NO. _____

DATE _____
 BY _____
 SURVEYED _____
 PLOTTED _____
 TEMPLATE _____
 NOTE BOOK _____
 AREAS _____
 CHECKED _____
 NO. _____

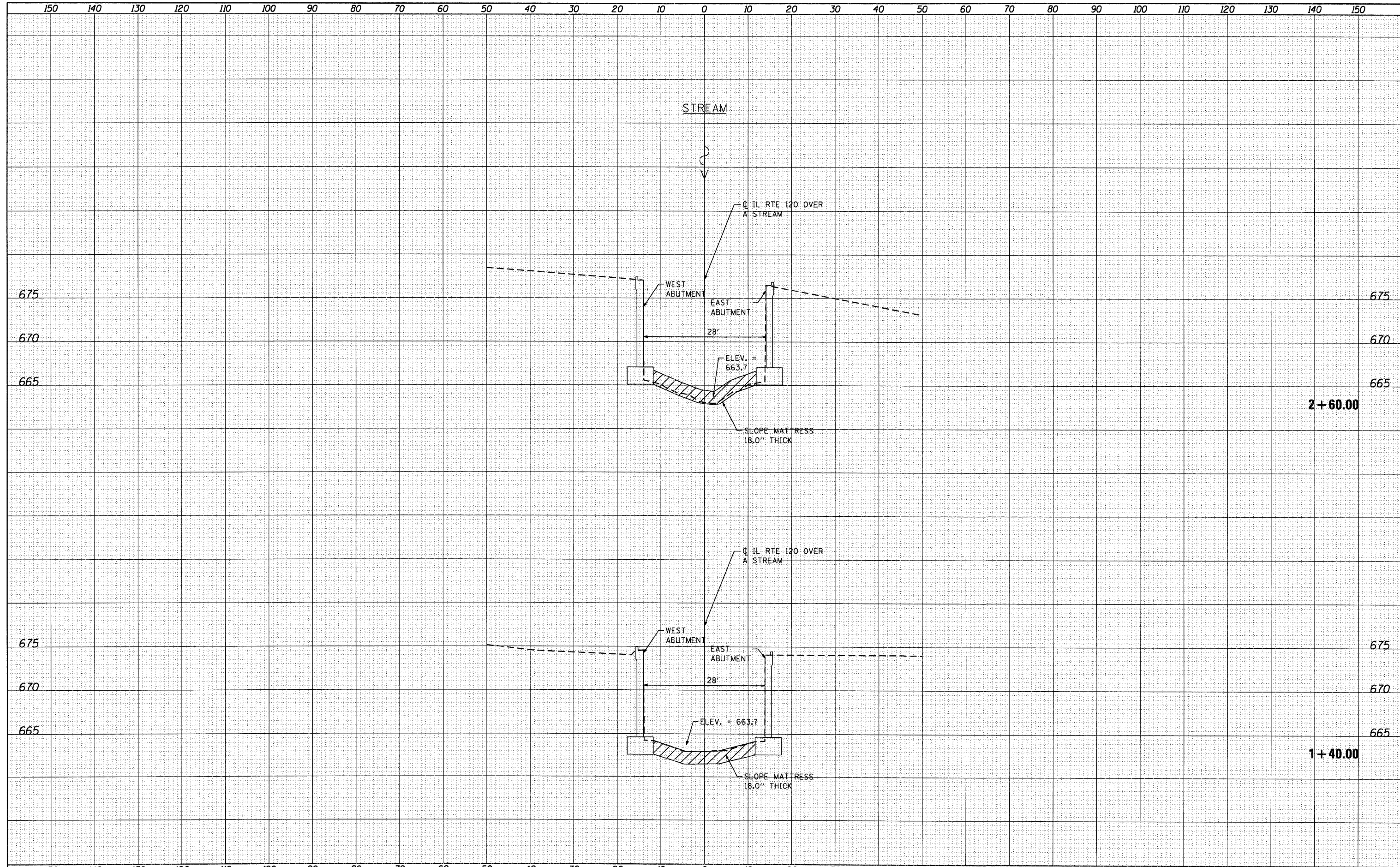

USER NAME = SPernal	DESIGNED C. HARTKE	REVISED
	DRAWN S. PERNAL	REVISED
PLOT SCALE = 1:10H, 1:5V	CHECKED T. HAMILTON	REVISED
PLOT DATE = 7/19/2011	DATE 7/19/11	REVISED

**STATE OF ILLINOIS
 DEPARTMENT OF TRANSPORTATION**

**CROSS SECTIONS
 ILLINOIS ROUTE 120 OVER STREAM**

SCALE: 1:10H, 1:5V SHEET NO. 1 OF 4 SHEETS STA. 1+40.00 TO STA. 2+60.00

F.A. RTE.	SECTION	COUNTY	TOTAL SHEETS	SHEET NO.
VAR.	2010-124-1	VAR.	21	13
SN 049-0044-049-0045		CONTRACT NO. 60M86		
[ILLINOIS] FED. AID PROJECT				

DATE	
BY	
FINAL SURVEY	
SURVEY PLOTTED	
NOTE BOOK	
AREAS CHECKED	
NO.	

DATE	
BY	
ORIGINAL SURVEY	
SURVEY PLOTTED	
NOTE BOOK	
AREAS CHECKED	
NO.	

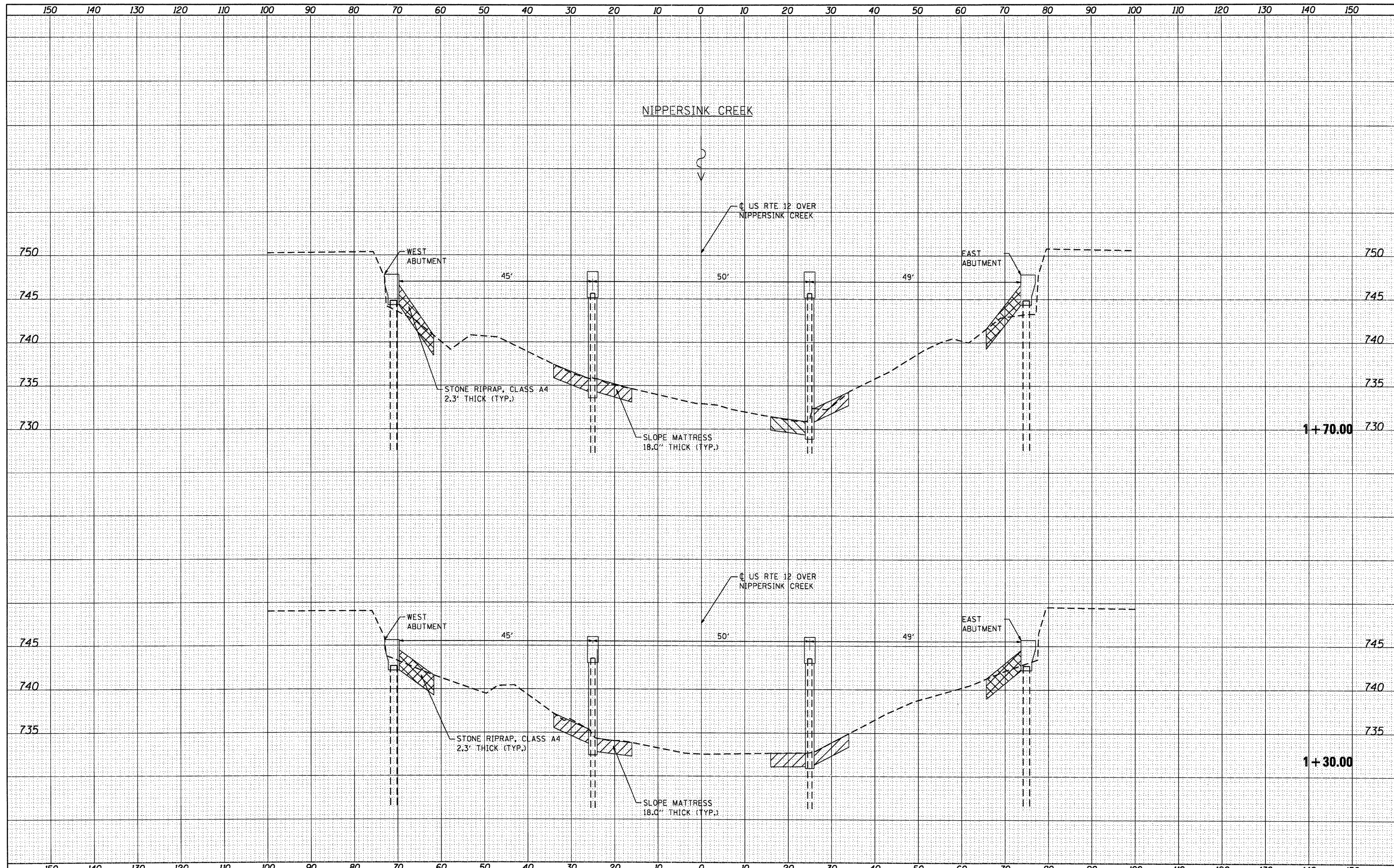

HRGreen.com
Illinois Professional Design Firm
#184-001322

USER NAME = SPernal
PLOT SCALE = 1:10H, 1:5V
PLOT DATE = 7/19/2011

DESIGNED C. HARTKE
DRAWN S. PERNAL
CHECKED T. HAMILTON
DATE 7/19/11

REVISED
REVISED
REVISED
REVISED

**STATE OF ILLINOIS
DEPARTMENT OF TRANSPORTATION**

CROSS SECTIONS U.S. ROUTE 12 OVER NIPPERSINK CREEK			
SCALE: 1:10H, 1:5V	SHEET NO. 2 OF 4 SHEETS	STA. 1+30.00	TO STA. 1+70.00

F.A. RTE.	SECTION	COUNTY	TOTAL SHEETS	SHEET NO.
VAR.	2010-124-1	VAR.	21	14
SN. 056 - 005 F		CONTRACT NO. 60M86		
[ILLINOIS] FED. AID PROJECT				

DATE	
BY	
FINAL SURVEY	
NOTED	
PLOTTED	
TEMPLATE	
AREAS	
CHECKED	
NO.	

DATE	
BY	
ORIGINAL SURVEY	
NOTED	
PLOTTED	
TEMPLATE	
AREAS	
CHECKED	
NO.	

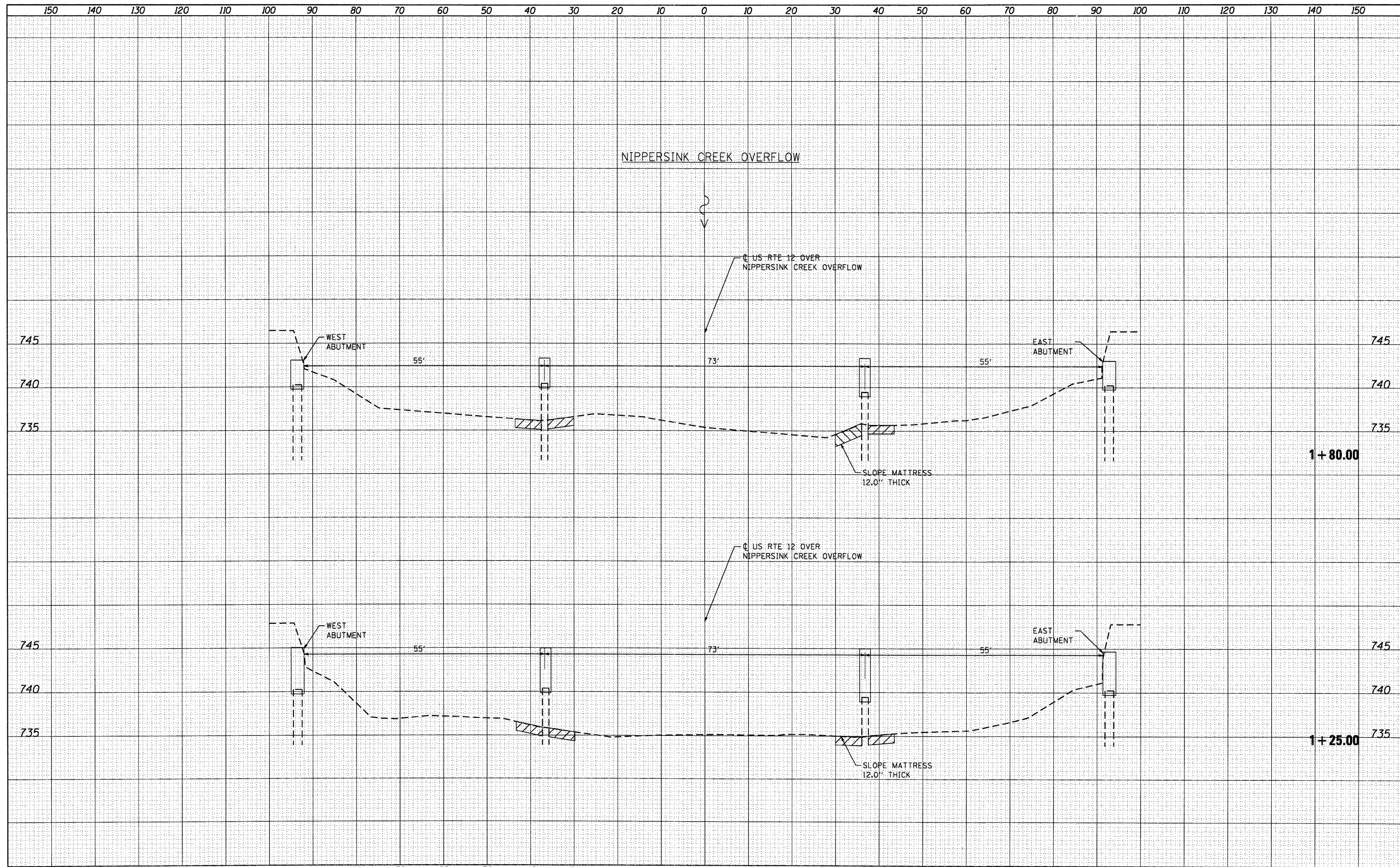

	USER NAME = SPernal PLOT SCALE = 1:10H, 1:5V PLOT DATE = 7/19/2011	DESIGNED C. HARTKE DRAWN S. PERNAL CHECKED T. HAMILTON DATE 7/19/11	REVISED REVISED REVISED REVISED	STATE OF ILLINOIS DEPARTMENT OF TRANSPORTATION	CROSS SECTIONS U.S. ROUTE 12 OVER NIPPERSINK CREEK OVERFLOW		F.A. RTE. VAR.	SECTION 2010-124-1	COUNTY VAR.	TOTAL SHEETS 21	SHEET NO. 15
					SCALE: 1:10H, 1:5V	SHEET NO. 3 OF 4 SHEETS	STA. 1+25.00 TO STA. 1+80.00	SN. 056-0020	CONTRACT NO. 60M86	ILLINOIS FED. AID PROJECT	

DATE _____
 BY _____
 SURVEYED _____
 PLOTTED _____
 TEMPLATE _____
 NOTE BOOK _____
 AREAS CHECKED _____
 NO. _____

DATE _____
 BY _____
 SURVEYED _____
 PLOTTED _____
 TEMPLATE _____
 NOTE BOOK _____
 AREAS CHECKED _____
 NO. _____

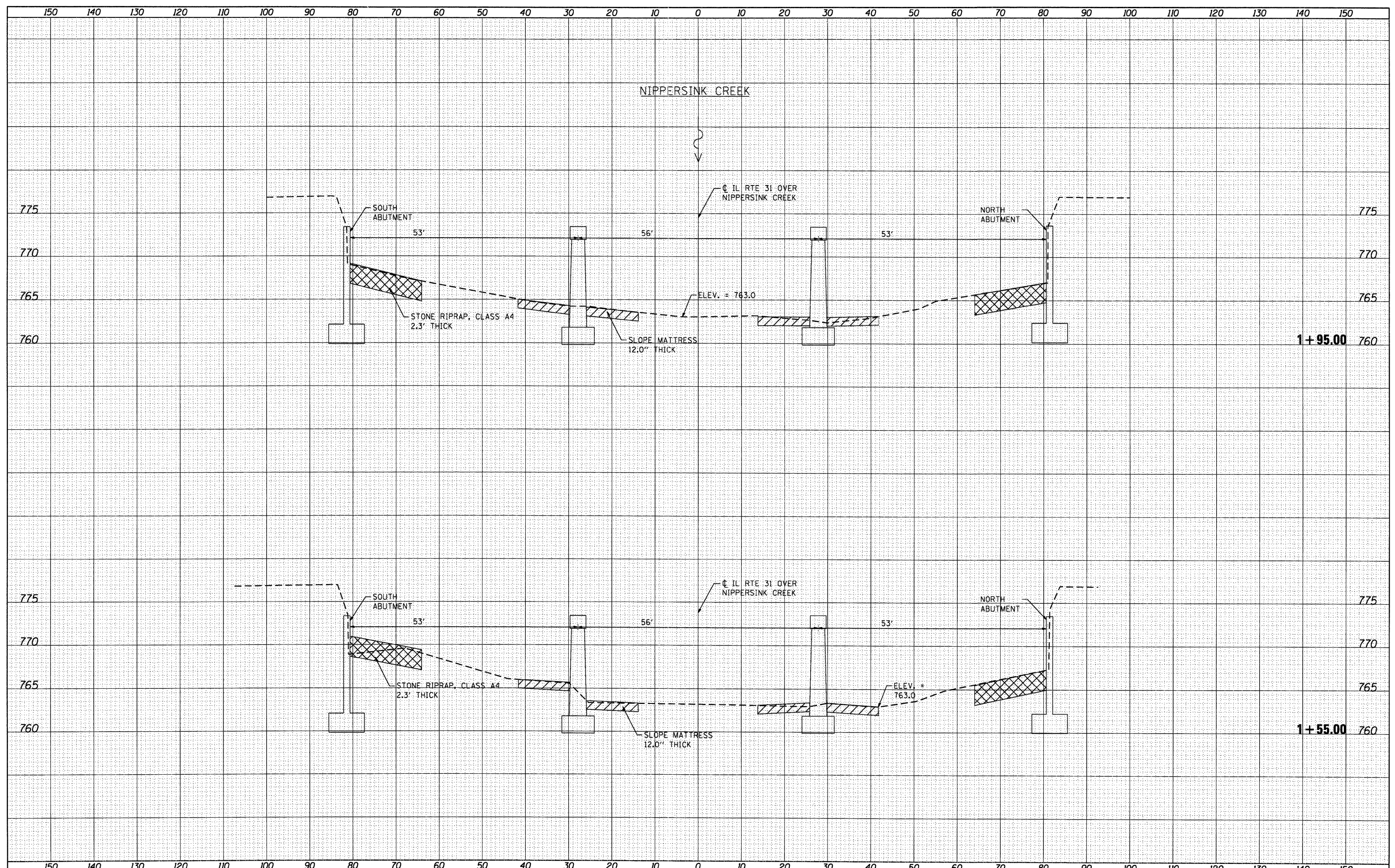

HRGreen.com
 Illinois Professional Design Firm
 #184-001322

USER NAME = SPernal	DESIGNED C. HARTKE	REVISED
PLOT SCALE = 1:10H, 1:5V	DRAWN S. PERNAL	REVISED
PLOT DATE = 7/19/2011	CHECKED T. HAMILTON	REVISED
	DATE 7/19/11	REVISED

**STATE OF ILLINOIS
 DEPARTMENT OF TRANSPORTATION**

**CROSS SECTIONS
 ILLINOIS ROUTE 31 OVER NIPPERSINK CREEK**

SCALE: 1:10H, 1:5V SHEET NO. 4 OF 4 SHEETS STA. 1+55.00 TO STA. 1+95.00

F.A. RTE.	SECTION	COUNTY	TOTAL SHEETS	SHEET NO.
VAR.	2010-124-1	VAR.	21	16
SP 056-003F			CONTRACT NO. 60MB6	
[ILLINOIS] FED. AID PROJECT				

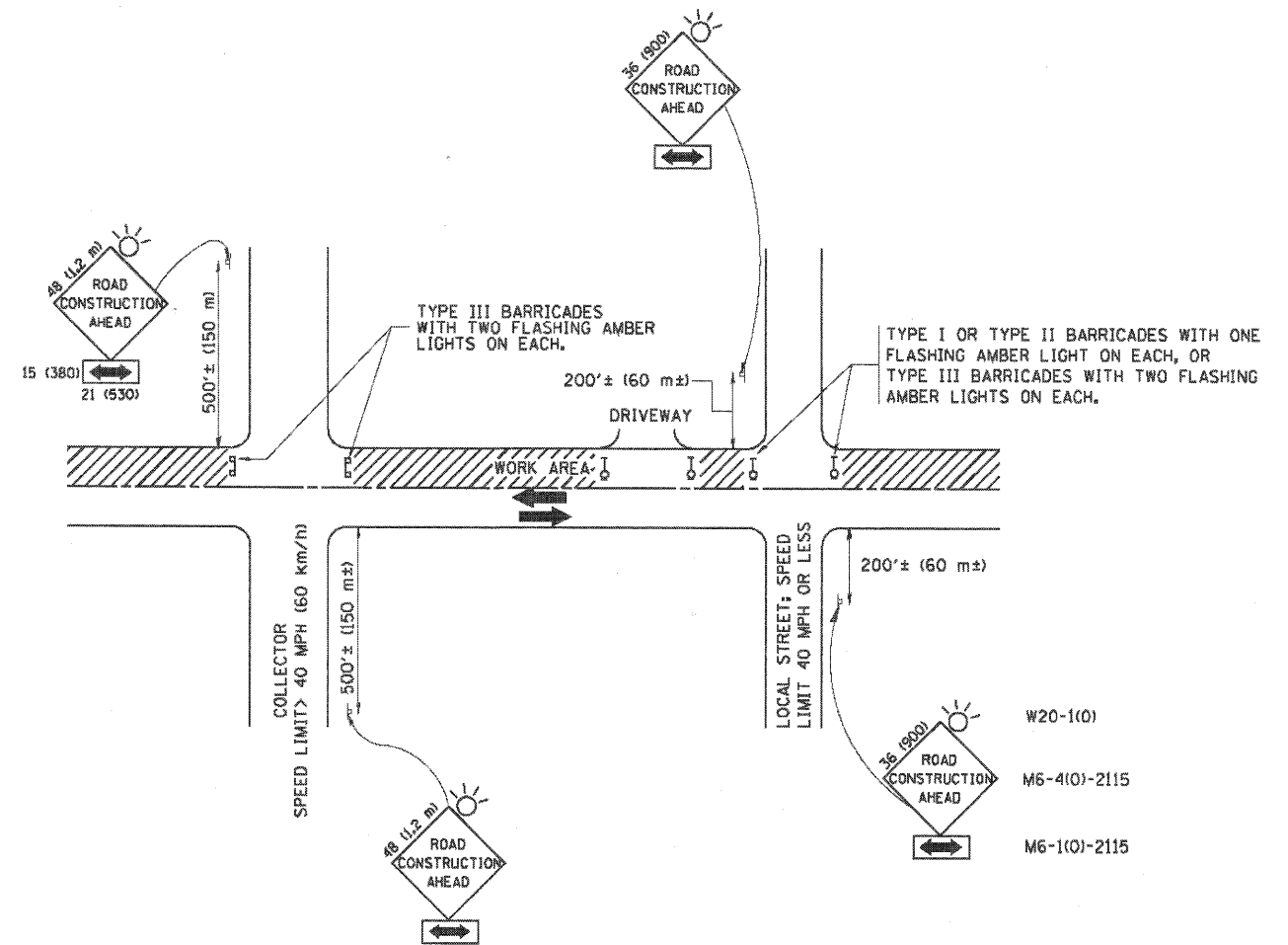

TRAFFIC CONTROL AND PROTECTION FOR SIDE ROADS, INTERSECTIONS, AND DRIVEWAYS

NOTES:

- A. FOR NO LANE RESTRICTION ON THE SIDE ROAD OR DRIVEWAYS
 1. SIDE ROAD WITH A SPEED LIMIT OF 40 MPH (60 km/h) OR LESS AS SHOWN ON THE DRAWING AND AS DIRECTED BY THE ENGINEER:
 - a) ONE ROAD CONSTRUCTION AHEAD SIGN 36 x 36 (900x900) WITH A FLASHER AND FLAG MOUNTED ON IT APPROXIMATELY 200' (60 m) IN ADVANCE OF THE MAIN ROUTE.
 - b) THE CLOSED PORTION OF THE MAIN ROUTE SHALL BE PROTECTED BY BLOCKING WITH TYPE I, TYPE II OR TYPE III BARRICADES, 1/3 OF THE CROSS SECTION OF THE CLOSED PORTION.
 2. SIDE ROAD WITH A SPEED LIMIT GREATER THAN 40 MPH (60 km/h) AS SHOWN ON THE DRAWING AND AS DIRECTED BY THE ENGINEER:
 - a) ONE ROAD CONSTRUCTION AHEAD SIGN 48 x 48 (1.2 m x 1.2 m) WITH A FLASHER MOUNTED ON IT APPROXIMATELY 500' (150 m) IN ADVANCE OF THE MAIN ROUTE.
 - b) THE CLOSED PORTION OF THE MAIN ROUTE SHALL BE PROTECTED BY BLOCKING WITH TYPE III BARRICADES, 1/2 OF THE CROSS SECTION OF THE CLOSED PORTION.
 3. WHEN THE SIDE ROAD LIES BETWEEN THE BEGINNING OF THE MAINLINE SIGNING AND THE WORK ZONE, A SINGLE HEADED ARROW (M6-1) SHALL BE USED IN LIEU OF THE DOUBLE HEADED ARROW (M6-4).
- B. FOR A LANE CLOSURE ON A SIDE ROAD OR DRIVEWAY:

USE APPLICABLE PORTIONS OF THE TYPICAL APPLICATION OF TRAFFIC CONTROL DEVICES (STD. 701501, STD. 701606 OR THE APPROPRIATE STANDARD). THE SPACING OF SIGNS AND BARRICADES SHALL BE ADJUSTED FOR FIELD CONDITIONS AS DIRECTED BY THE ENGINEER. THE DIRECTIONAL ARROW SHALL BE COVERED OR REMOVED WHEN NO LONGER CONSISTENT WITH THE SIDE ROAD LANE CLOSURE.
- C. ADVANCE WARNING SIGNS ARE TO BE OMITTED ON DRIVEWAY UNLESS OTHERWISE NOTED.
- D. THE TRAFFIC CONTROL AND PROTECTION FOR SIDE ROADS, INTERSECTIONS, AND DRIVEWAYS SHALL BE INCIDENTAL TO THE COST OF SPECIFIED TRAFFIC CONTROL STANDARDS OR ITEMS.

All dimensions are in millimeters (inches) unless otherwise shown.

COMPANY NAME: HRCGreen.com
 PROJECT CONTACT: #PROJECT CONTACT
 CLIENT: GILBERT, 34930 RM
 FILE NAME: 86100186.03-dst-01.dgn
 PLOT DRIVER: pcf.drv
 PEN TABLE: standard-trans.tbl



USER NAME = gajlienobt	DESIGNED - LHA	REVISED - J. OBERLE 10-18-95
PLOT SCALE = 500,000 / IN.	DRAWN -	REVISED - A. HOUSEH 03-06-96
PLOT DATE = 1/4/2008	CHECKED -	REVISED - A. HOUSEH 10-15-96
	DATE - 06-89	REVISED - T. RAMWACHER 01-06-00

STATE OF ILLINOIS
 DEPARTMENT OF TRANSPORTATION

TRAFFIC CONTROL AND PROTECTION FOR
 SIDE ROADS, INTERSECTIONS, AND DRIVEWAYS

SCALE: NONE SHEET NO. 1 OF 5 SHEETS STA. TO STA.

F.A. RTE. VAR.	SECTION 2010-124-1	COUNTY VAR.	TOTAL SHEETS 21	SHEET NO. 17
TC-10			CONTRACT NO. 60M86	
FED. ROAD DIST. NO. 1 ILLINOIS FED. AID PROJECT				

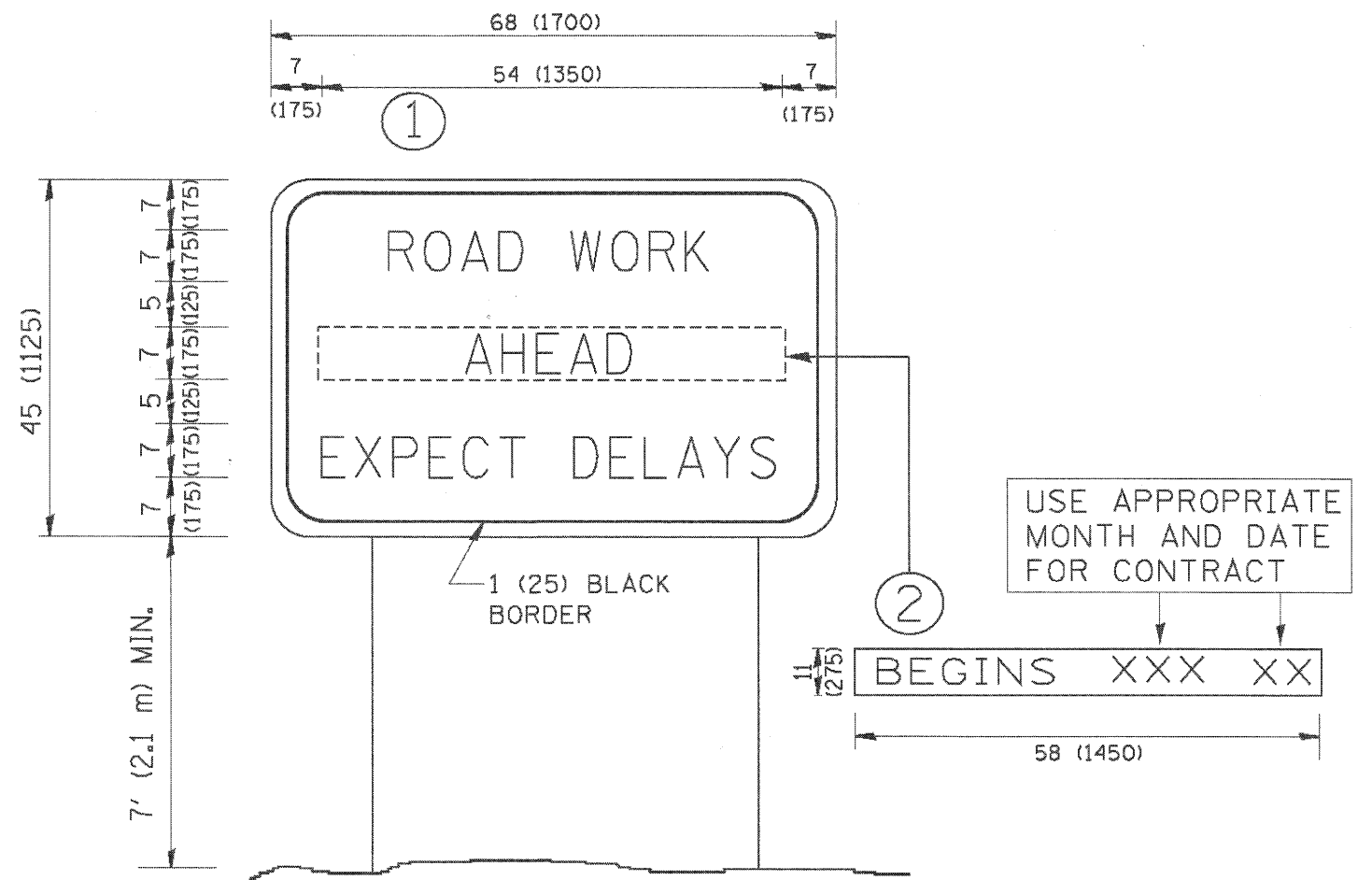

NOTES:

1. USE BLACK LETTERING ON ORANGE BACKGROUND.
2. ERECT SIGNS IN ADVANCE OF THE LOCATION FOR THE "ROAD CONSTRUCTION AHEAD" SIGN AT LOCATIONS AS DIRECTED BY THE ENGINEER.
3. ERECT SIGN ① WITH INSTALLED PANEL ② ONE WEEK PRIOR TO THE START OF CONSTRUCTION.
4. REMOVE PANEL ② SOON AFTER THE START OF CONSTRUCTION.
5. SEE SPECIAL PROVISION FOR "TEMPORARY INFORMATION SIGNING" FOR ADDITIONAL INFORMATION.
6. ONE SIGN ASSEMBLY EQUALS 25.70 SQ. FT. (2.3 SQ. M.)
7. SHALL BE PAID FOR AS TEMPORARY INFORMATION SIGNING.

ALL DIMENSIONS ARE IN INCHES (MILLIMETERS) UNLESS OTHERWISE SHOWN.

COMPANY NAME: HRGreen.com
 PROJECT CONTACT: #PROJECT CONTACT
 CLIENT: #CLIENT
 DATE PLOTTED: 7/25/2007 3:53:32 PM
 PLOT DRIVER: #PLOT DRIVER
 PEN TABLE: #PEN TABLE



USER NAME = geglennob	DESIGNED -	REVISED - R. MIRS 09-15-97
PLOT SCALE = 50.000 / 1 IN.	DRAWN -	REVISED - R. MIRS 12-11-97
PLOT DATE = 1/4/2008	CHECKED -	REVISED - T. RAMMACHER 02-02-99
	DATE -	REVISED - C. JUCIUS 01-31-07

**STATE OF ILLINOIS
 DEPARTMENT OF TRANSPORTATION**

**ARTERIAL ROAD
 INFORMATION SIGN**

SCALE: NONE SHEET NO. 2 OF 5 SHEETS STA. TO STA.

F.A. RTE. VAR.	SECTION 2010-124-1	COUNTY VAR.	TOTAL SHEETS 21	SHEET NO. 18
TC-22			CONTRACT NO. 60M86	
FED. ROAD DIST. NO. 1 ILLINOIS FED. AID PROJECT				

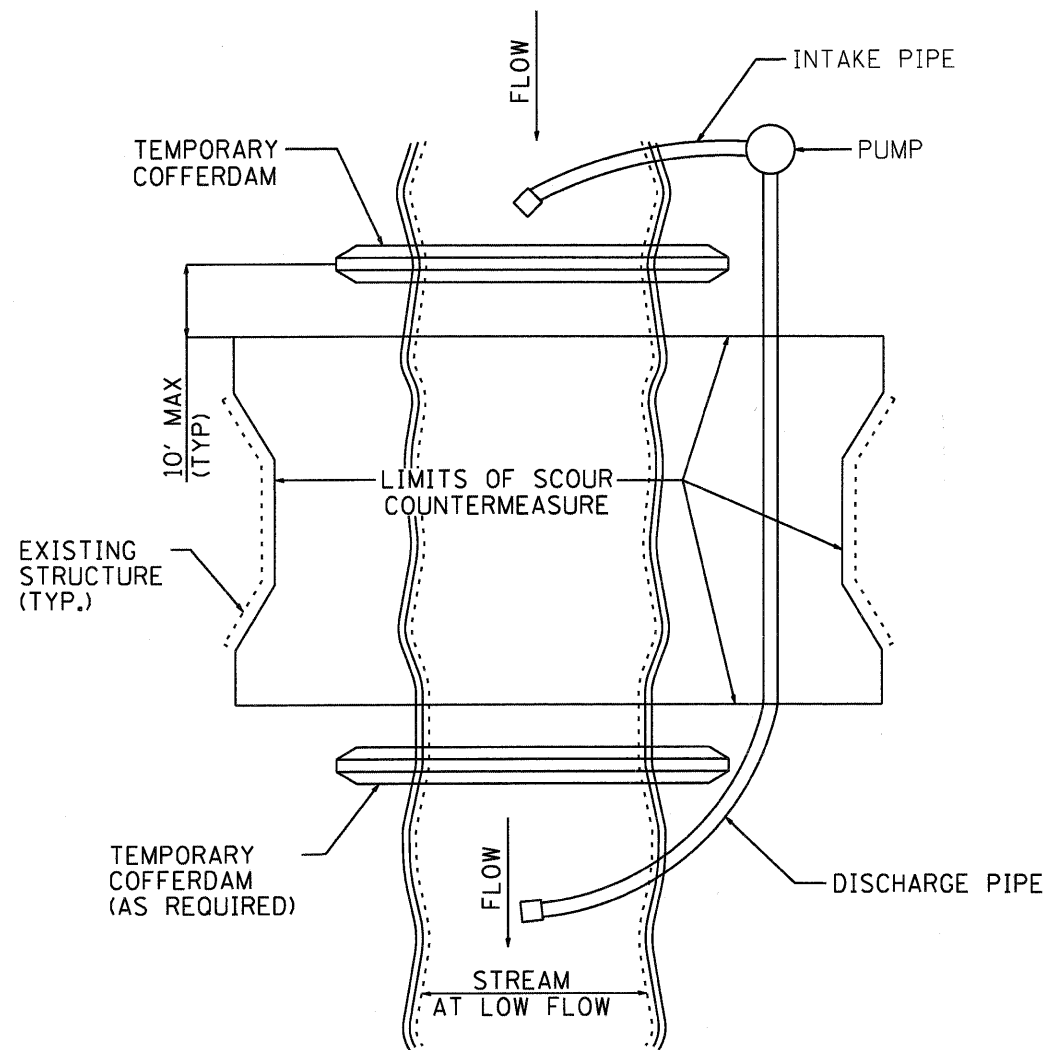

FIGURE D1. TEMPORARY COFFERDAM WITH PUMP BYPASS

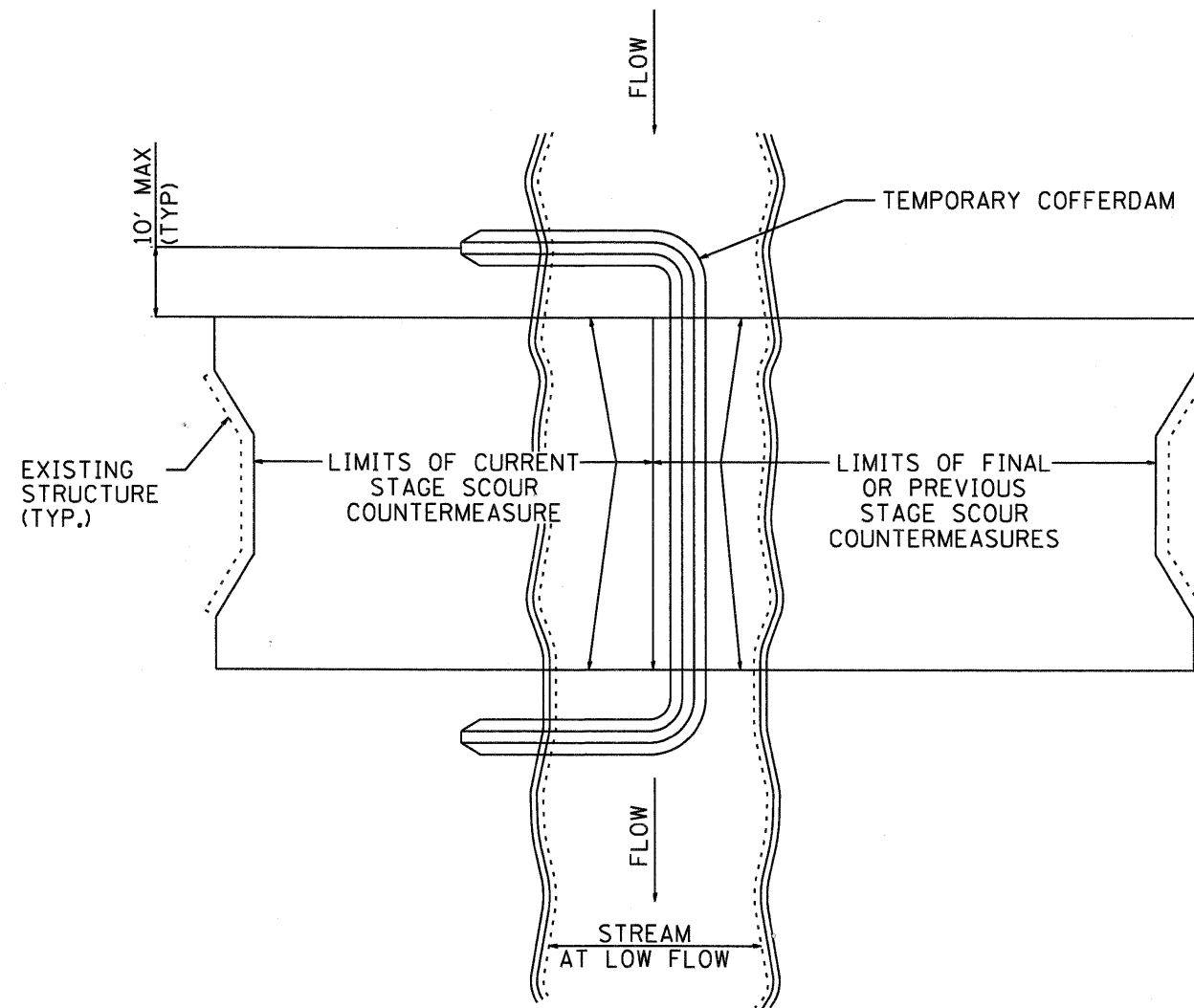

FIGURE D2. STAGED IN-STREAM COFFERDAM DIVISION

NOTE: DEWATERING SYSTEM DETAILS SHALL BE USED IN CONJUNCTION WITH THE PROJECT SPECIAL PROVISIONS.

COMPANY NAME: HRGreen.com
 PROJECT CONTACT: SPernal
 CLIENT: HRGreen.com
 DATE PLOTTED: 7/19/2011 3:49:33 PM
 PLOT DEVICE: HPGL-ET
 PEN TABLE: standard-trans.tbl



USER NAME = SPernal	DESIGNED -	REVISED -
PLOT SCALE = N/A	CHECKED -	REVISED -
PLOT DATE = 7/19/2011	DATE - 7/19/11	REVISED -

STATE OF ILLINOIS
 DEPARTMENT OF TRANSPORTATION

DEWATERING SYSTEM DETAILS
 SCOUR COUNTERMEASURES

SCALE: N/A SHEET NO. 3 OF 5 SHEETS STA. TO STA.

F.A. RTE.	SECTION	COUNTY	TOTAL SHEETS	SHEET NO.
VAR.	2010-124-1	VAR.	21	19
FED. ROAD DIST. NO. ILLINOIS FED. AID PROJECT			CONTRACT NO. 60M86	

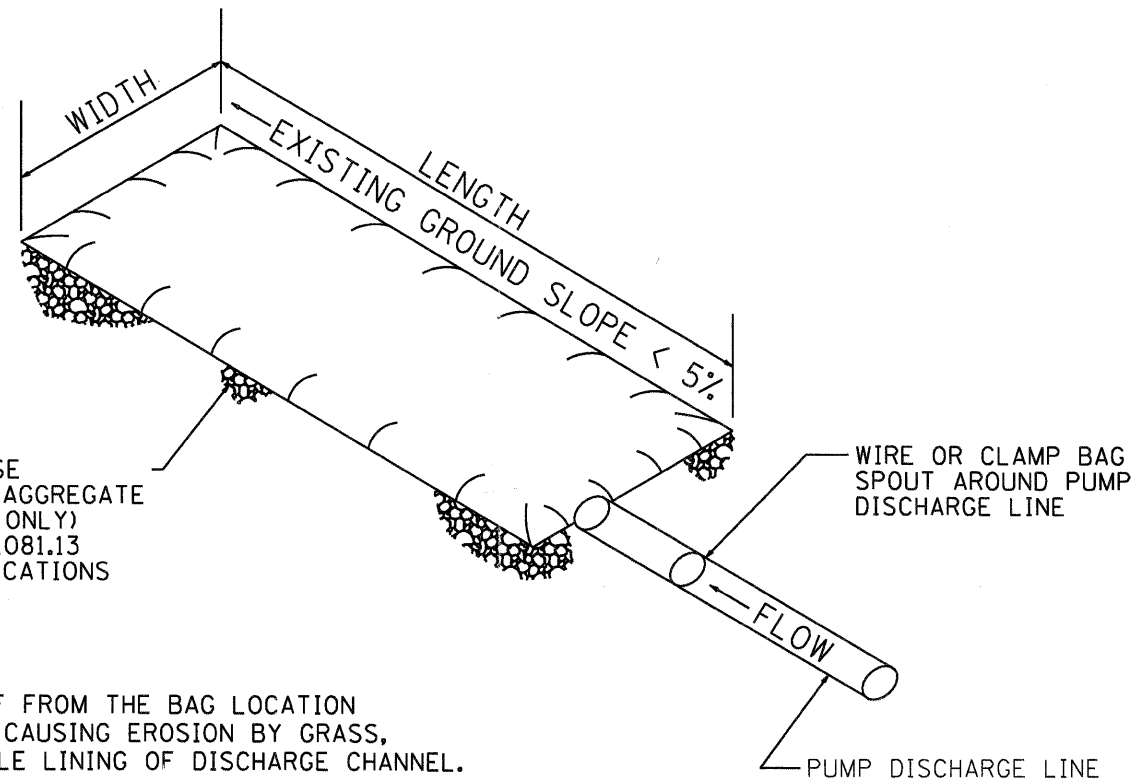

PLACE FILTERBAG ON DENSE MATURE GRASS OR ON AN AGGREGATE BASE (COARSE AGGREGATE ONLY) CONFORMING TO SECTION 1081.13 OF THE STANDARD SPECIFICATIONS

ENSURE THAT RUNOFF FROM THE BAG LOCATION IS PREVENTED FROM CAUSING EROSION BY GRASS, STONE, OR GEOTEXTILE LINING OF DISCHARGE CHANNEL.

REMOVE SILT WHEN BAG IS HALF FULL OR MORE OFTEN IF RECOMMENDED BY THE MAUNFACUTURER. DISPOSE OF SILT BY TRANSPORTING THE FILLED BAG TO DISPOSAL AREA. SLIT THE BAG, BLEND SILT INTO EXISTING TOPOGRAPHY, SEED AND MULCH

MAINTAIN EXTRA FILTER BAGS ON SITE. REPLACE DAMAGED BAGS PROMPTLY.

TYPICAL FLOW RATE: 10 GPM x W x L

FIGURE S1. SEDIMENT FILTER BAG

NOTE: DEWATERING SYSTEM DETAILS SHALL BE USED IN CONJUNCTION WITH THE PROJECT SPECIAL PROVISIONS.

COMPANY NAME: HRGreen.com
 PROJECT CONTACT: SPerna1
 CLIENT: HRGreen
 DATE PLOTTED: 7/19/2011 3:19:34 PM
 PLOT DRIVER: standard-trans.tbl
 PEN TABLE: standard-trans.tbl



USER NAME = SPerna1	DESIGNED -	REVISED -
PLOT SCALE = N/A	DRAWN -	REVISED -
PLOT DATE = 7/19/2011	CHECKED -	REVISED -
	DATE - 7/19/11	REVISED -

STATE OF ILLINOIS
 DEPARTMENT OF TRANSPORTATION

DEWATERING SYSTEM DETAILS
 SCOUR COUNTERMEASURES

SCALE: N/A SHEET NO. 4 OF 5 SHEETS STA. TO STA.

F.A. RTE.	SECTION	COUNTY	TOTAL SHEETS	SHEET NO.
VAR.	2010-124-1	VAR.	21	20
FED. ROAD DIST. NO. ILLINOIS FED. AID PROJECT			CONTRACT NO. 60M86	

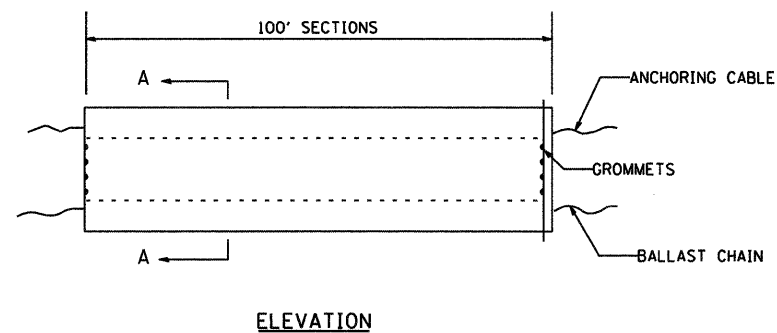

ELEVATION

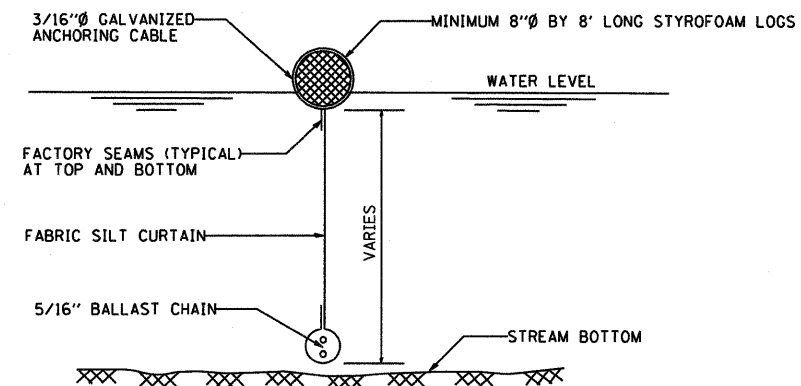

SECTION A-A

FLOTATION BOOM

NOTES:

1. FLOTATION BOOM SHALL BE ANCHORED TO PREVENT DRIFT SHOREWARD OR DOWNSTREAM. ANCHORAGES SHALL BE INSTALLED ON BOTH SHORE AND STREAM SIDE.
2. SHORE ANCHORS SHALL CONSIST OF A POST WITH DEADMAN OR APPROVED EQUAL. STREAM ANCHORS SHALL BE SUFFICIENT SIZE TO STABILIZE THE BARRIER WITH NUMBER AND SPACING DEPENDENT ON WATERWAY VELOCITIES.
3. FABRIC SECTIONS SHALL BE CONNECTED END TO END WITH MINIMUM 5/8" DIAMETER POLYPROPYLENE ROPE
4. DESIGN OF BOOM AND ANCHORAGE SHALL BE IN ACCORDANCE WITH MANUFACTURER'S RECOMENDATIONS. BOTTOM OF BOOM SHALL REACH BOTTOM OF WATERWAY USING ONE OR TWO VERTICAL SECTIONS AS REQUIRED.
5. MAINTENANCE SHALL BE PERFORMED AS NEEDED. CONTRACTOR SHALL REMOVE THE BOOM AT COMPLETION OF WORK IN A MANNER THAT WILL PREVENT SILTATION OF THE WATERWAY.

APPLICATION: FLOTATION BOOMS TO BE USED TO CONTROL EROSION, TURBIDITY AND DEBRIS WHEN WORKING IN WATERWAYS.

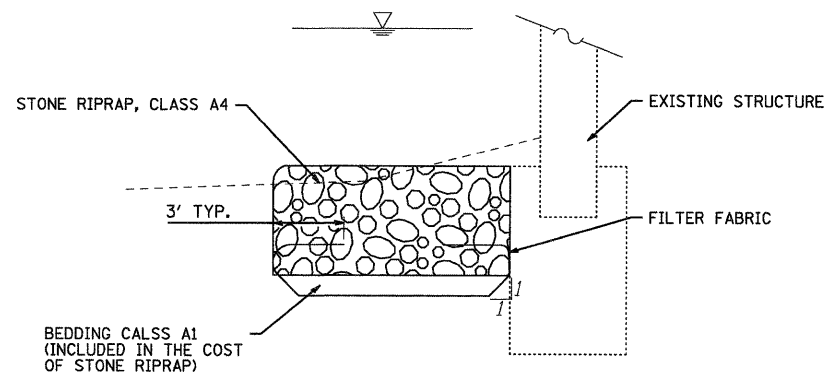

FILTER FABRIC/ RIPRAP DETAIL

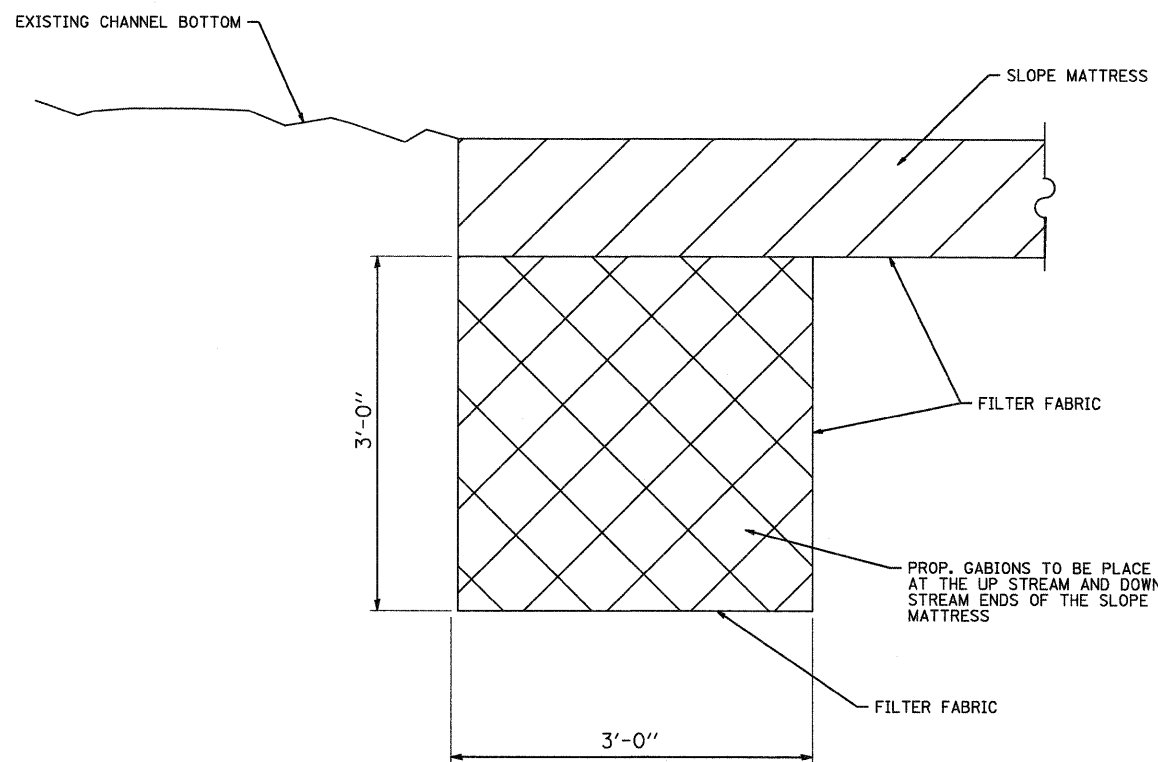

MATTRESS ANCHORING DETAIL

COMPANY NAME: #/COMPANY/NAME/ HRGreen
 PROJECT CONTACT: #/PROJECT/CONTACT/ HRGreen
 CLIENT: #/CLIENT/ 7/21/2011 4:46:27 PM
 DATE PLOTTED: 66100196.09-def-05.dgn
 FILE NAME: Def.dgn
 PLOT DRIVER: STANDARD-TRANSL
 PEN TABLE:



USER NAME = JGuerr1	DESIGNED -	REVISED -
PLOT SCALE = N/A	DRAWN -	REVISED -
PLOT DATE = 7/21/2011	CHECKED -	REVISED -
	DATE - 7/21/11	REVISED -

STATE OF ILLINOIS
DEPARTMENT OF TRANSPORTATION

DETAILS
SCOUR COUNTERMEASURES

SCALE: N/A SHEET NO. 5 OF 5 SHEETS STA. TO STA.

F.A. RTE. VAR.	SECTION 2010-124-I	COUNTY VAR.	TOTAL SHEETS 21	SHEET NO. 21
CONTRACT NO. 60M86			ILLINOIS FED. AID PROJECT	