

DATE: _____
 BY: _____
 CHECKED: _____
 DATE: _____
 NO. _____

DATE: _____
 BY: _____
 CHECKED: _____
 DATE: _____
 NO. _____

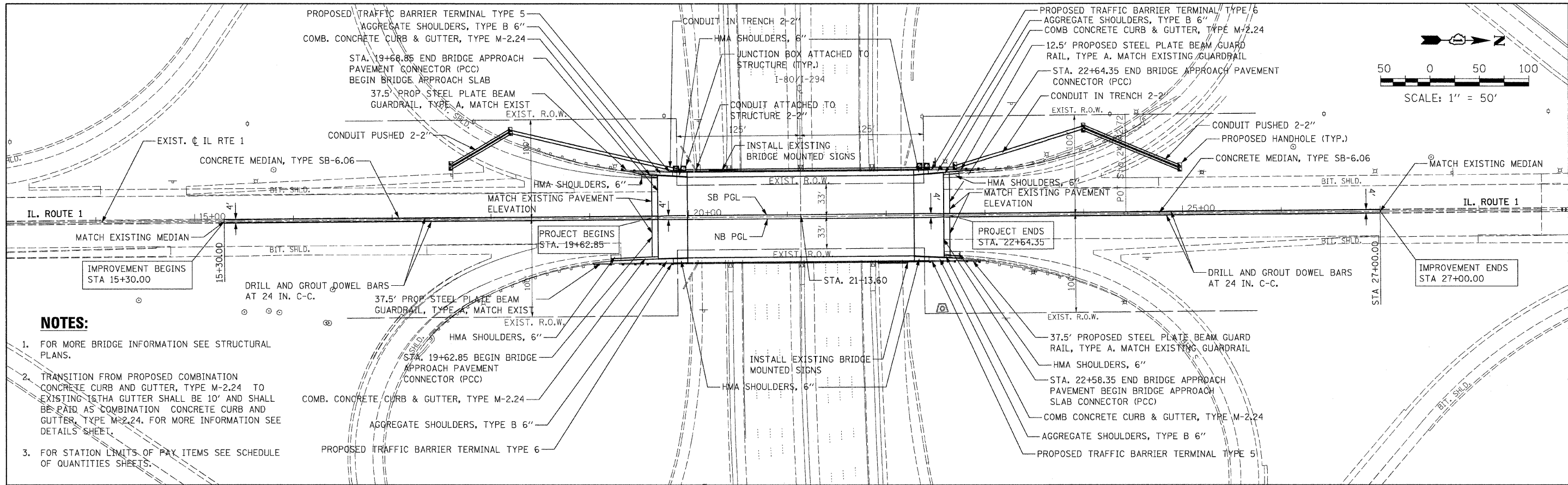

NOTES:

1. FOR MORE BRIDGE INFORMATION SEE STRUCTURAL PLANS.
2. TRANSITION FROM PROPOSED COMBINATION CONCRETE CURB AND GUTTER, TYPE M-2.24 TO EXISTING 18" GUTTER SHALL BE 10' AND SHALL BE PAID AS COMBINATION CONCRETE CURB AND GUTTER, TYPE M-2.24. FOR MORE INFORMATION SEE DETAILS SHEET.
3. FOR STATION LIMITS OF PAY ITEMS SEE SCHEDULE OF QUANTITIES SHEETS.

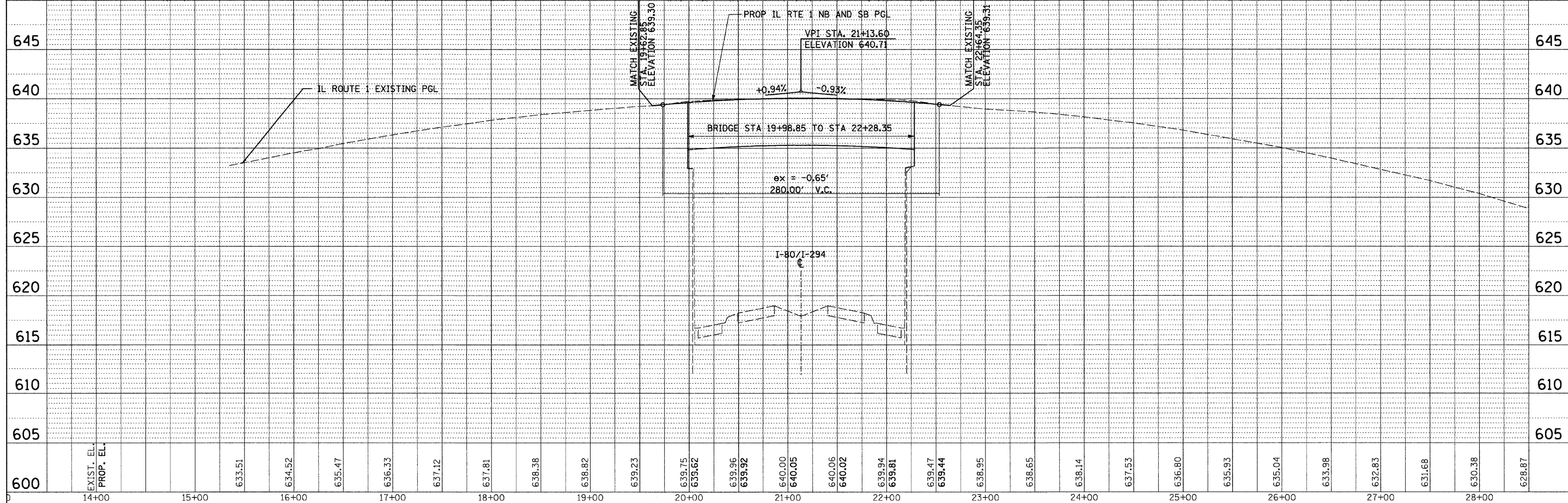

FILE NAME = 62099CPP01.DGN	USER NAME = holsted	DESIGNED - PK	REVISED -	STATE OF ILLINOIS DEPARTMENT OF TRANSPORTATION	ILLINOIS RTE 1 OVER TRI-STATE I-80 / I-294 PLAN AND PROFILE SHEET	F.A.P. RTE. 876	SECTION 2001-001BR	COUNTY	TOTAL SHEETS 62	SHEET NO. 11
PLOT SCALE = 50,000' / IN.	CHECKED - RPI	DATE - 08/05/2011	REVISED -			CONTRACT NO. 62099				
PLOT DATE = 8/3/2011	DATE - 08/05/2011	REVISED -	FED. ROAD DIST. NO. 1 (ILLINOIS) FED. AID PROJECT							
SCALE: 1"=50'		SHEET NO. OF SHEETS STA. TO STA.								