

**NORTH RETAINING WALL SOUTH ELEVATION**

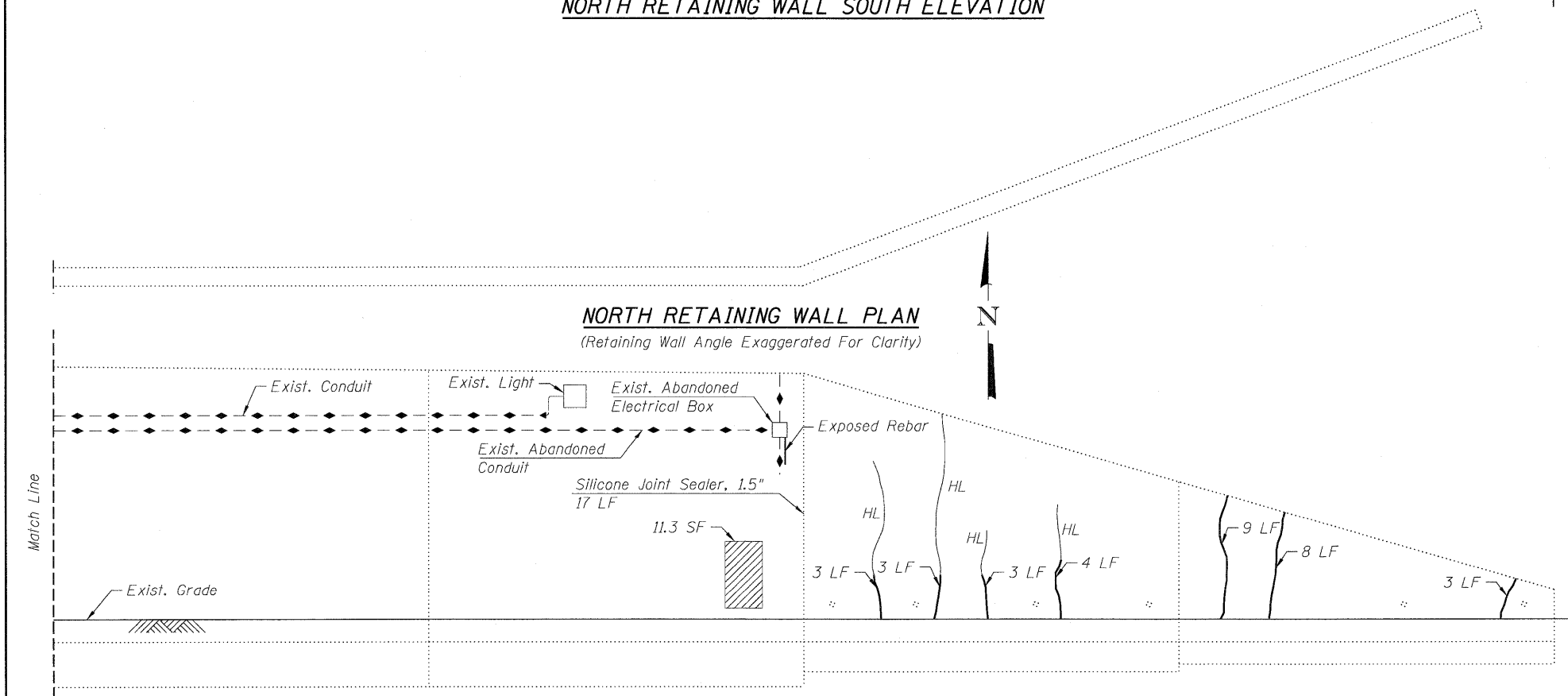

**NORTH RETAINING WALL SOUTH ELEVATION**

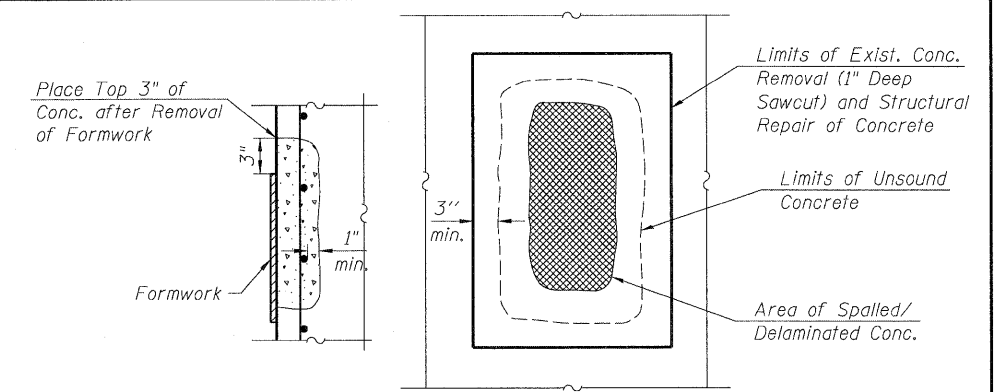

**STRUCTURAL REPAIR OF CONCRETE**

**NOTES:**

- For general notes and total bill of material, see sheet 21.
- Existing reinforcing bars that have been cut and/or damaged during repair operations shall be supplemented by new in kind reinforcing bars. New bars shall be lapped a minimum of 32 bar diameters to existing bars. A mechanical bar splicer shall be used when it is not feasible to provide the minimum bar lap. No welding of bars shall be performed. See special provisions.
- Crack widths shown to be repaired are  $\frac{1}{8}'' \pm \frac{1}{16}''$  unless otherwise noted.
- Quantities and limits shown are estimated for bidding purposes only. The actual areas to be repaired and the type(s) of repairs to be used will be determined by the engineer in the field at the time of construction. Increases to plan quantities shall be approved by the Tollway prior to performing work.
- The Contractor shall take all necessary precautions for the protection of passing vehicles from falling objects and/or materials until completion of the work. All necessary precautions shall be included in bid price for Structural Repair of Concrete (Depth Equal to or Less Than 5") and Structural Repair of Concrete (Depth Greater Than 5").
- The Contractor is responsible to remove and reinstall all existing utilities (such as drain pipes, electrical conduits, junction boxes and light fixtures) interfering with the work. Cost shall be included with Structural Repair of Concrete (Depth Equal to or Less Than 5") & Structural Repair of Concrete (Depth Greater Than 5").
- All exposed surfaces of the top and front faces of the retaining wall shall be cleaned and sealed in accordance with the special provisions for Power Washing Concrete Surfaces and Concrete Sealant, respectively.

**BILL OF MATERIAL**

Item	Unit	Total
Concrete Sealant	Sq. Ft.	2884
Low Pressure Epoxy Injection	Foot	33
Power Washing Concrete Surfaces	Sq. Yd.	321
Structural Repair of Concrete (Depth Equal to or Less Than 5 Inches)	Sq. Ft.	28
Silicone Joint Sealer, 1.5"	Foot	34

**LEGEND**

- Hairline Crack (Not to be Sealed) SF - Square Foot
- Low Pressure Epoxy Injection LF - Linear Foot
- Structural Repair of Concrete (Depth Equal To Or Less Than 5") HL - Hairline
- Structural Repair of Concrete (Depth Greater Than 5")

