

- NOTES:**
1. FLOTATION BOOM SHALL BE ANCHORED TO PREVENT DRIFT SHOREWARD OR DOWNSTREAM. ANCHORAGES SHALL BE INSTALLED ON BOTH SHORE AND STREAM SIDE. BOOMS ARE NOT TO BE INSTALLED ACROSS FLOWING BODY OF WATER.
 2. SHORE ANCHORS SHALL CONSIST OF A POST WITH DEADMAN OR APPROVED EQUAL. STREAM ANCHORS SHALL BE OF SUFFICIENT SIZE TO STABILIZE THE BARRIER WITH NUMBER AND SPACING DEPENDENT ON WATERWAY VELOCITIES.
 3. FABRIC SECTIONS SHALL BE CONNECTED END TO END WITH MINIMUM 5/8" DIAMETER POLYPROPYLENE ROPE.
 4. DESIGN OF BOOM AND ANCHORAGE SHALL BE IN ACCORDANCE WITH MANUFACTURER'S RECOMMENDATIONS. BOTTOM OF BOOM SHALL REACH BOTTOM OF WATERWAY USING ONE OR TWO VERTICAL SECTIONS AS REQUIRED.
 5. MAINTENANCE SHALL BE PERFORMED AS NEEDED. CONTRACTOR SHALL REMOVE THE BOOM AT COMPLETION OF WORK IN A MANNER THAT WILL PREVENT SILTATION OF THE WATERWAY.

SEDIMENT CONTROL SILT CURTAIN DETAIL

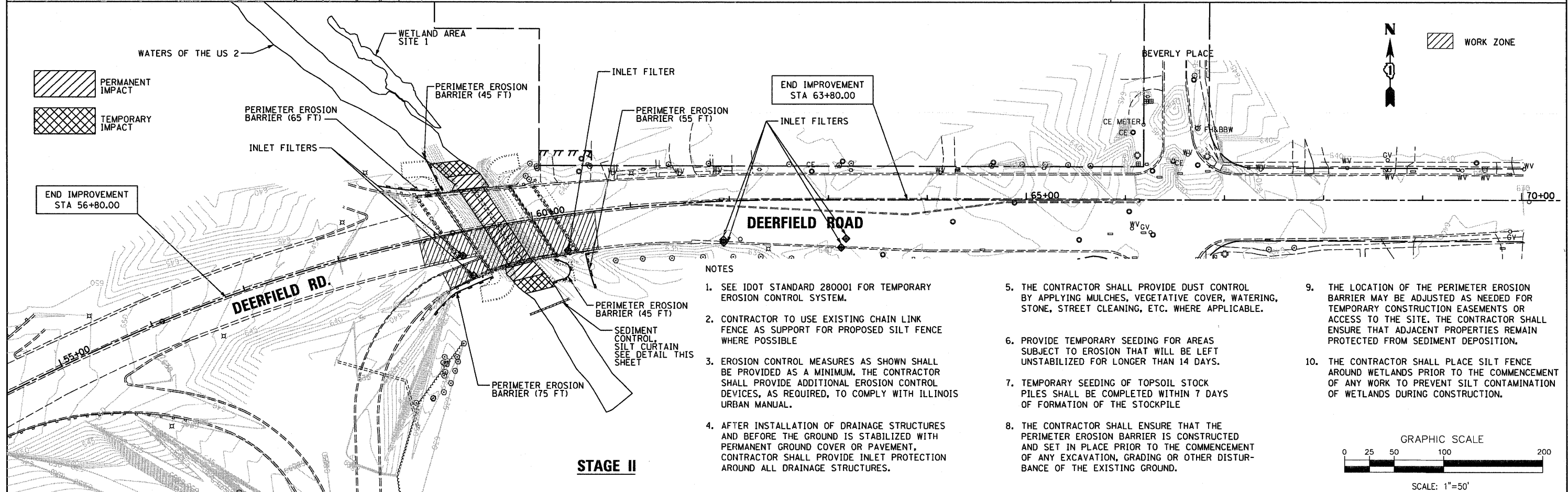

- NOTES:**
1. SEE IDOT STANDARD 280001 FOR TEMPORARY EROSION CONTROL SYSTEM.
 2. CONTRACTOR TO USE EXISTING CHAIN LINK FENCE AS SUPPORT FOR PROPOSED SILT FENCE WHERE POSSIBLE
 3. EROSION CONTROL MEASURES AS SHOWN SHALL BE PROVIDED AS A MINIMUM. THE CONTRACTOR SHALL PROVIDE ADDITIONAL EROSION CONTROL DEVICES, AS REQUIRED, TO COMPLY WITH ILLINOIS URBAN MANUAL.
 4. AFTER INSTALLATION OF DRAINAGE STRUCTURES AND BEFORE THE GROUND IS STABILIZED WITH PERMANENT GROUND COVER OR PAVEMENT, CONTRACTOR SHALL PROVIDE INLET PROTECTION AROUND ALL DRAINAGE STRUCTURES.
 5. THE CONTRACTOR SHALL PROVIDE DUST CONTROL BY APPLYING MULCHES, VEGETATIVE COVER, WATERING, STONE, STREET CLEANING, ETC. WHERE APPLICABLE.
 6. PROVIDE TEMPORARY SEEDING FOR AREAS SUBJECT TO EROSION THAT WILL BE LEFT UNSTABILIZED FOR LONGER THAN 14 DAYS.
 7. TEMPORARY SEEDING OF TOPSOIL STOCK PILES SHALL BE COMPLETED WITHIN 7 DAYS OF FORMATION OF THE STOCKPILE
 8. THE CONTRACTOR SHALL ENSURE THAT THE PERIMETER EROSION BARRIER IS CONSTRUCTED AND SET IN PLACE PRIOR TO THE COMMENCEMENT OF ANY EXCAVATION, GRADING OR OTHER DISTURBANCE OF THE EXISTING GROUND.
 9. THE LOCATION OF THE PERIMETER EROSION BARRIER MAY BE ADJUSTED AS NEEDED FOR TEMPORARY CONSTRUCTION EASEMENTS OR ACCESS TO THE SITE. THE CONTRACTOR SHALL ENSURE THAT ADJACENT PROPERTIES REMAIN PROTECTED FROM SEDIMENT DEPOSITION.
 10. THE CONTRACTOR SHALL PLACE SILT FENCE AROUND WETLANDS PRIOR TO THE COMMENCEMENT OF ANY WORK TO PREVENT SILT CONTAMINATION OF WETLANDS DURING CONSTRUCTION.

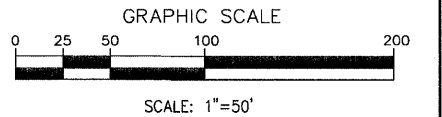

FILE NAME = ...DI-62101-shr-erosioncontrol.dgn	DESIGNED - MC	REVISED -		STATE OF ILLINOIS DEPARTMENT OF TRANSPORTATION	EROSION CONTROL PLAN	F.A.U. RTE. 1257	SECTION 104RB-R	COUNTY LAKE	TOTAL SHEETS 54	SHEET NO. 14		
PLOT TIME = 9/48:55 AM	CHECKED - TRP	REVISED -				SCALE: 1" = 50'	SHEET NO. 1 OF 1 SHEETS	STA. 52+18.93 TO STA. 70+38.82	CONTRACT NO. 62102		ILLINOIS FED. AID PROJECT	
PLOT DATE = 6/23/2011	DATE - 06/24/2011	REVISED -				<small>600 W. FULTON ST. CHICAGO, ILLINOIS 60611-1299</small> <small>TEL 312 454 8100 FAX 312 659 1217</small> <small>WWW.SEPSTEIN.COM</small>						