

LIGHTING CONTROLLER

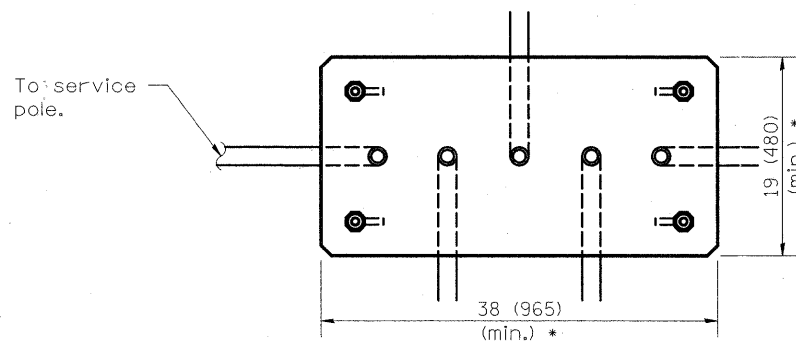

FOUNDATION (PLAN)
(Work pad not shown.)

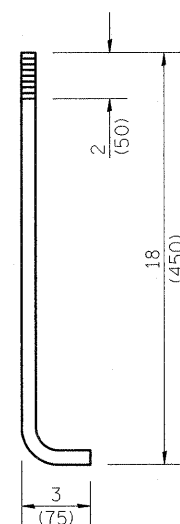

**ANCHOR ROD
DETAIL**

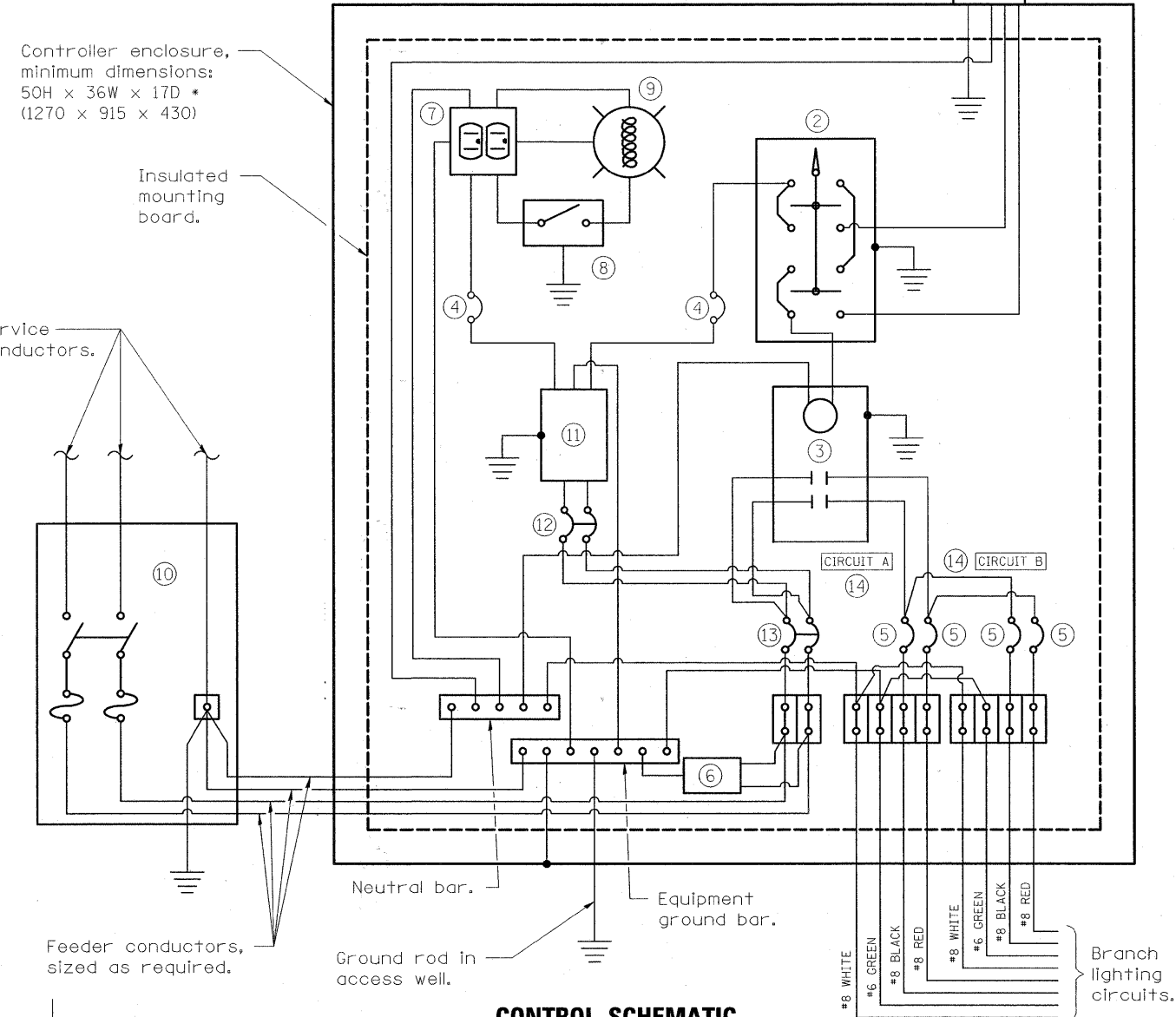

CONTROL SCHEMATIC

- ① Photocell with integral surge arrester.
- ② HAND-OFF-AUTO selector switch.
- ③ 100 amp*, electrically held contactor.
- ④ 15 amp, 1-pole circuit breaker.
- ⑤ 20 amp*, 1-pole circuit breaker (two spares required but not shown).
- ⑥ Surge arrester.
- ⑦ GFCI duplex receptacle.
- ⑧ Single-pole, single-throw switch.
- ⑨ Incandescent luminaire, enclosed and gasketed with 100 watt lamp.
- ⑩ Service disconnect switch - 2-pole, 3-wire, 100 amp*, fused at 100 amp*, solid neutral in NEMA 4X enclosure having lockable external handle.
- ⑪ Transformer - 1KVA*, 480V primary, 120/240V secondary, single-phase, 60Hz.
- ⑫ 15 amp, 2-pole circuit breaker.
- ⑬ 100 amp*, 2-pole circuit breaker.
- ⑭ Engraved name plates as shown.

* Size larger as needed.

All dimensions are in inches (millimeters) unless otherwise shown.

FILE NAME =	USER NAME = #USER#	DESIGNED -	REVISED -	STATE OF ILLINOIS DEPARTMENT OF TRANSPORTATION	ILL RTE 176 AND BRIARWOOD LIGHTING CONTROLLER BASE MOUNTED, 480V			F.A.P. RTE. 335	SECTION 11-00114-00-CH	COUNTY McHENRY	TOTAL SHEETS 56	SHEET NO. 39
P:\2010\100174\oad\phase 2\dwg\100174-lighting.dgn		DRAWN -	REVISED -		SCALE: 1"=50'	SHEET NO.	OF SHEETS	STA.	TO STA.	CONTRACT NO. 63551		
		CHECKED -	REVISED -		ILLINOIS FED. AID PROJECT							
		DATE = 7/1/2011	REVISED -									