

LEGEND	
	CONSTRUCTION WORK ZONE
	TEMPORARY PAVEMENT TO BE CONSTRUCTED PRIOR TO STAGE 1
	ARROW BOARD
	SIGN TO BE PLACED ON PERMANENT OR PORTABLE SUPPORT
	MONODIRECTIONAL FLASHING LIGHT
	DRUMS OR TYPE II BARRICADE WITH STEADY BURN LIGHT @ 50' C-C (TYP), 25' C-C IN CURVES AND RADII, AND 20' C-C IN TAPERS
	TYPE III BARRICADE
	DIRECTION INDICATOR BARRICADES WITH STEADY BURN LIGHTS AT 25' C-C
	DIRECTION OF TRAFFIC FLOW

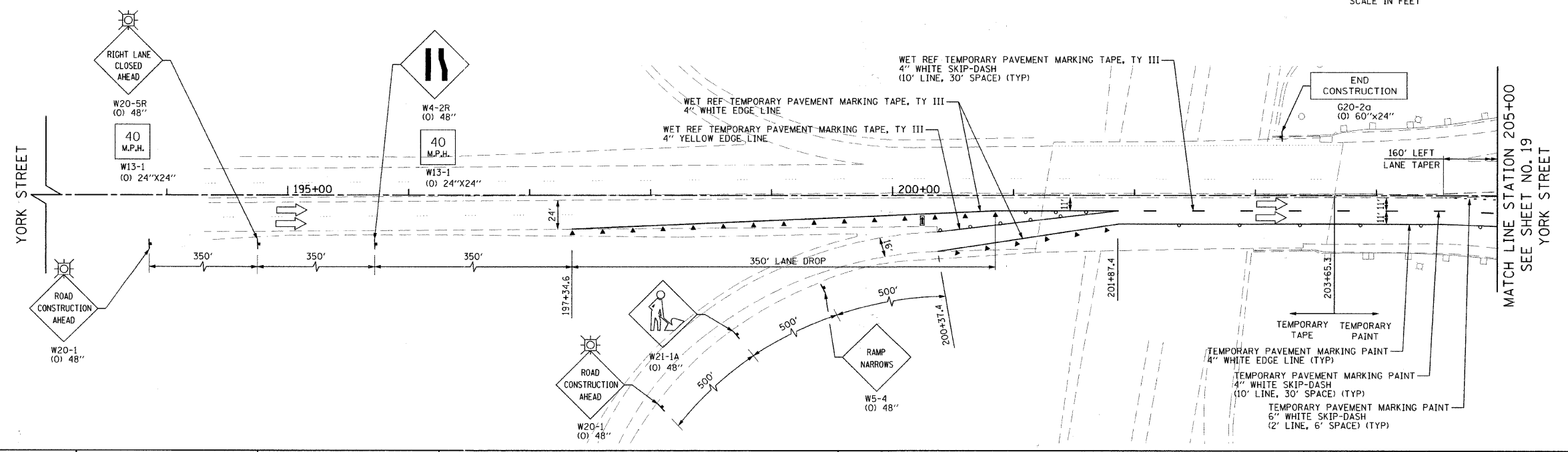
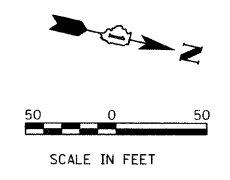
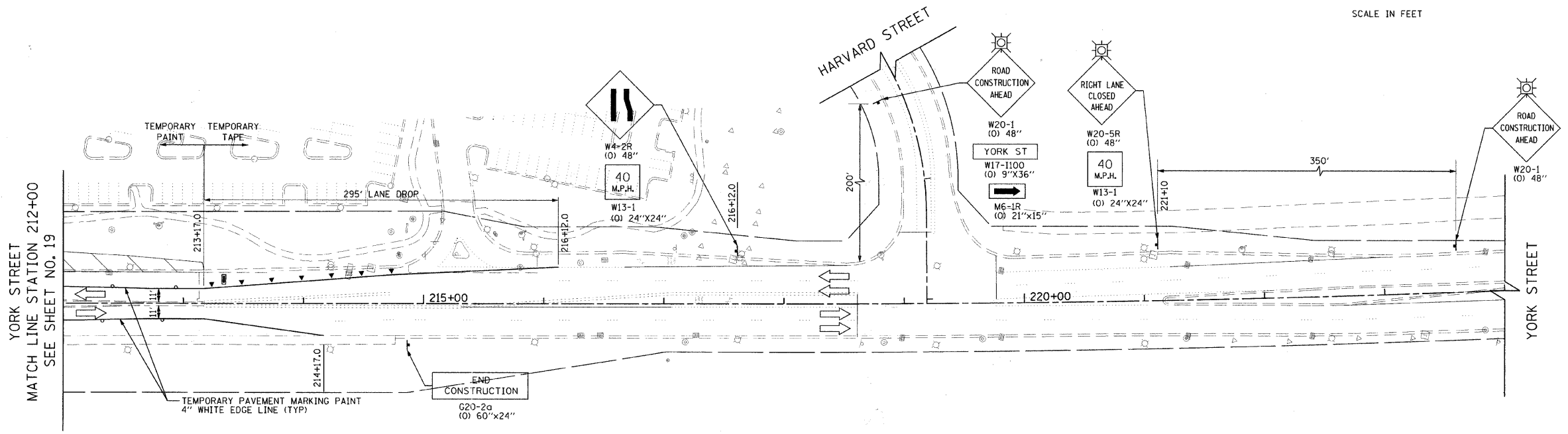
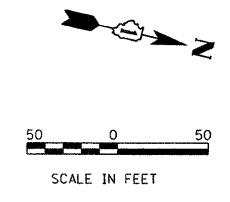

PLAN	DATE
SURVEYED	
PLOTTED	
CHECKED	
BY	
NOTE BOOK NO.	
CAD FILE NAME	

PROFILE	DATE
SURVEYED	
PLOTTED	
CHECKED	
BY	
NOTE BOOK NO.	
STRUCTURE NOTATION	

FILE NAME =	USER NAME = jmgolemba
g:\ch\08\0007\road\phase 2\sheet\01X0007	MOTSheet1-2.dgn
PLOT SCALE = 58.0000' / IN.	
PLOT DATE = 8/4/2011	

DESIGNED - TKH	REVISED -
DRAWN - TKH	REVISED -
CHECKED - JMG	REVISED -
DATE - 7/4/2011	REVISED -

**STATE OF ILLINOIS
DEPARTMENT OF TRANSPORTATION**

**SUGGESTED CONSTRUCTION PROCEDURES AND TRAFFIC CONTROL
YORK STREET AT ILLINOIS RTE 38 RAMPS/BRUSH HILL ROAD - STAGE 1**

F.A.U. RTE.	SECTION	COUNTY	TOTAL SHEETS	SHEET NO.
2678	09-00171-00-CH		85	20
CONTRACT NO. 63610			FED. ROAD DIST. NO. 7 [ILLINOIS] FED. AID PROJECT	

SCALE: 1"=50' SHEET NO. 20 OF 85 SHEETS STA. 202+50 TO STA. 214+50