

LEGEND	
	CONSTRUCTION WORK ZONE
	TEMPORARY PAVEMENT TO BE CONSTRUCTED PRIOR TO STAGE 1
	ARROW BOARD
	SIGN TO BE PLACED ON PERMANENT OR PORTABLE SUPPORT
	MONODIRECTIONAL FLASHING LIGHT
	DRUMS OR TYPE II BARRICADE WITH STEADY BURN LIGHT @ 50' C-C (TYP), 25' C-C IN CURVES AND RADII, AND 20' C-C IN TAPERS
	TYPE III BARRICADE
	DIRECTION INDICATOR BARRICADES WITH STEADY BURN LIGHTS AT 25' C-C
	DIRECTION OF TRAFFIC FLOW

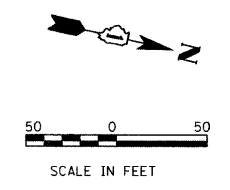

PLAN	DATE	BY
SURVEYED		
PLOTTED		
CHECKED		
NO. OF WAY CHECKED		
FILE NAME		

PROFILE	DATE	BY
SURVEYED		
PLOTTED		
CHECKED		
STRUCTURE NOTATIONS CHECKED		

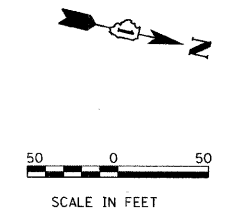
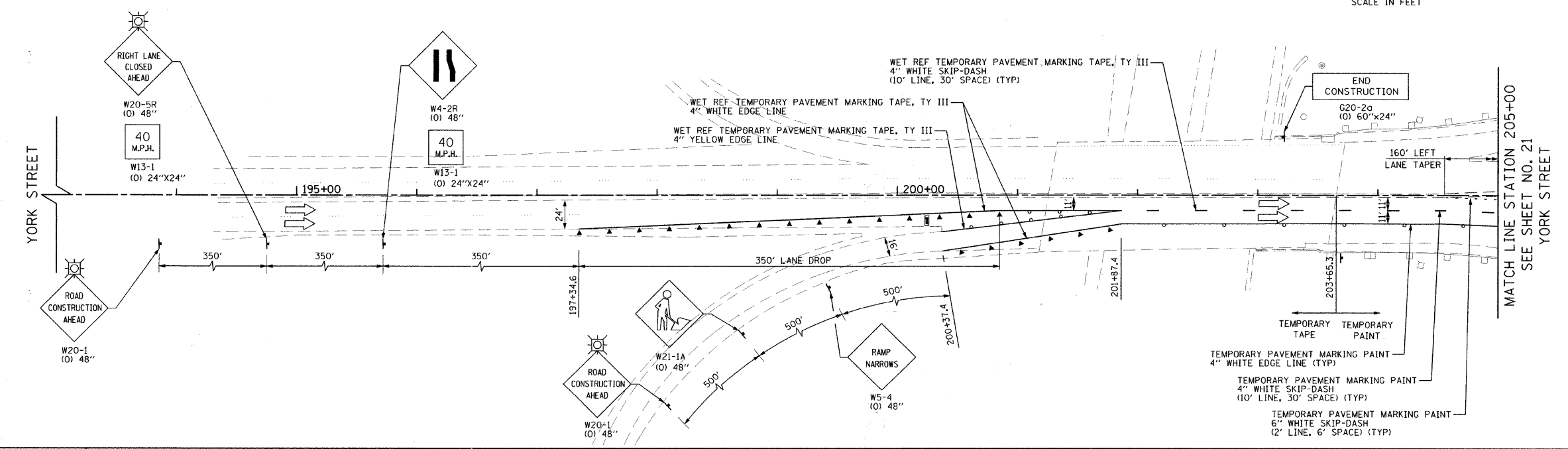
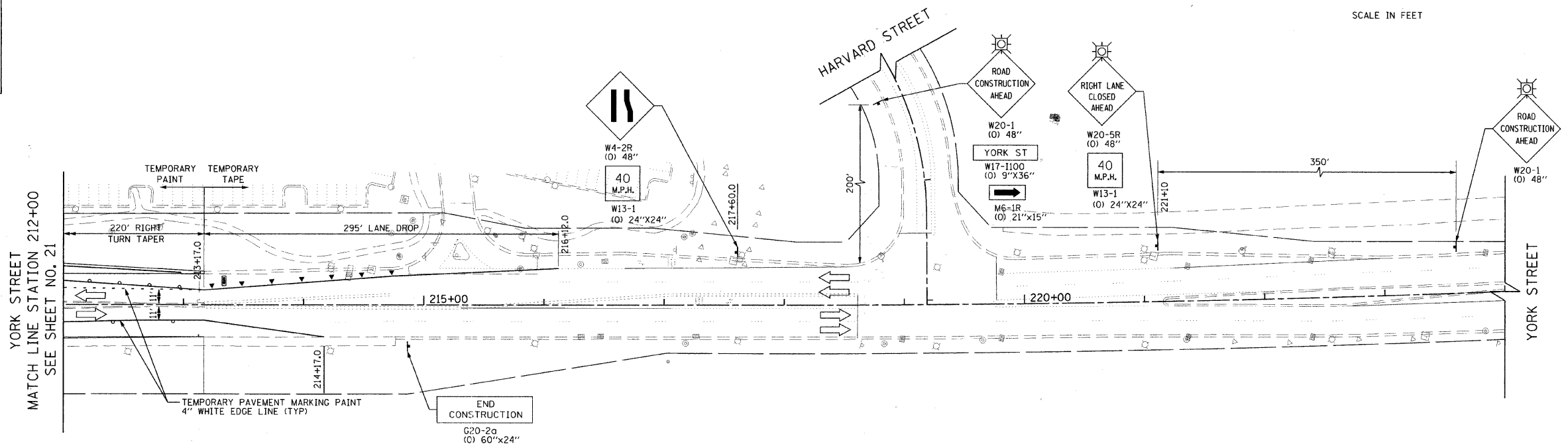

FILE NAME = g:\ch\88\8887\road\phase 2\sheet\01X2007	USER NAME = jmgolemba	DESIGNED - TKH	REVISED -	STATE OF ILLINOIS DEPARTMENT OF TRANSPORTATION	SUGGESTED CONSTRUCTION PROCEDURES AND TRAFFIC CONTROL YORK STREET AT ILLINOIS RTE 38 RAMPS/BRUSH HILL ROAD - STAGE 2	F.A.U. RTE. = 2678	SECTION = 09-00171-00-CH	COUNTY =	TOTAL SHEETS = 85	SHEET NO. = 22	
PLOT SCALE = 50.0000' / IN.	CHECKED - JMG	REVISED -	SCALE: 1"=50'			SHEET NO. 22 OF 85 SHEETS	STA. 202+50 TO STA. 214+50	CONTRACT NO. 63610			
PLOT DATE = 8/4/2011	DATE = 7/4/2011	REVISED -	FED. ROAD DIST. NO. 7 ILLINOIS FED. AID PROJECT								