

LEGEND	
	CONSTRUCTION WORK ZONE
	TEMPORARY PAVEMENT TO BE CONSTRUCTED PRIOR TO STAGE 1
	ARROW BOARD
	SIGN TO BE PLACED ON PERMANENT OR PORTABLE SUPPORT
	MONODIRECTIONAL FLASHING LIGHT
	DRUMS OR TYPE II BARRICADE WITH STEADY BURN LIGHT @ 50' C-C (TYP), 25' C-C IN CURVES AND RADII, AND 20' C-C IN TAPERS
	TYPE III BARRICADE
	DIRECTION INDICATOR BARRICADES WITH STEADY BURN LIGHTS AT 25' C-C
	DIRECTION OF TRAFFIC FLOW

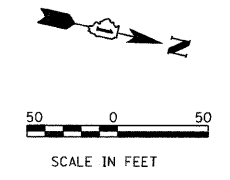

PLAN	DATE
SURVEYED	BY
PLOTTED	BY
NOTE BOOK	NO.
NO. OF SHEETS	NO.
FILE NAME	

PROFILE	DATE
SURVEYED	BY
PLOTTED	BY
NOTE BOOK	NO.
NO. OF SHEETS	NO.
FILE NAME	

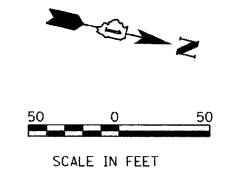
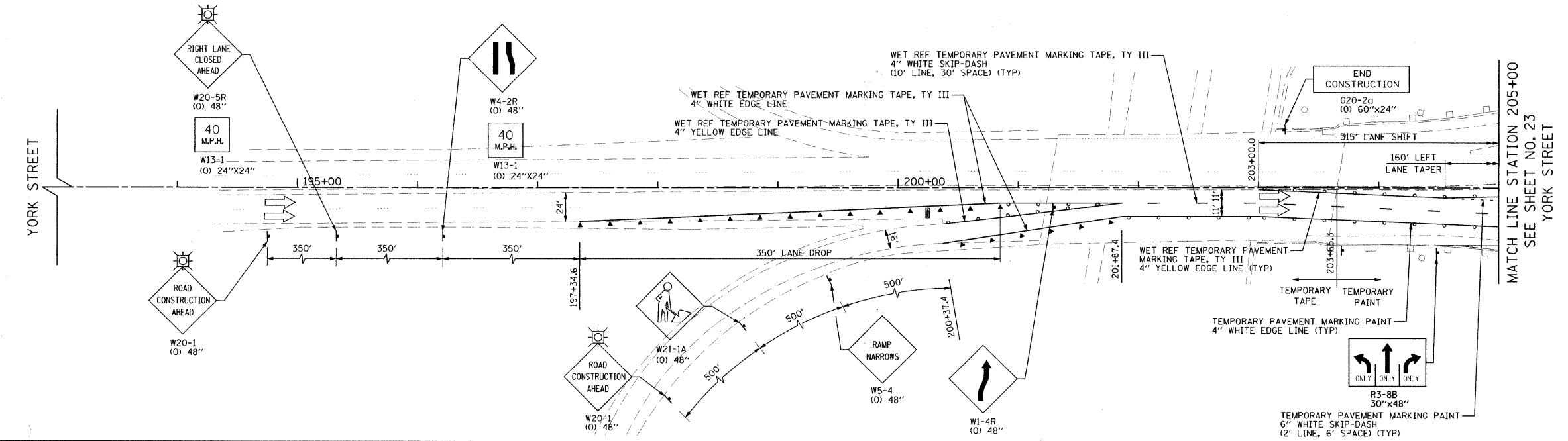
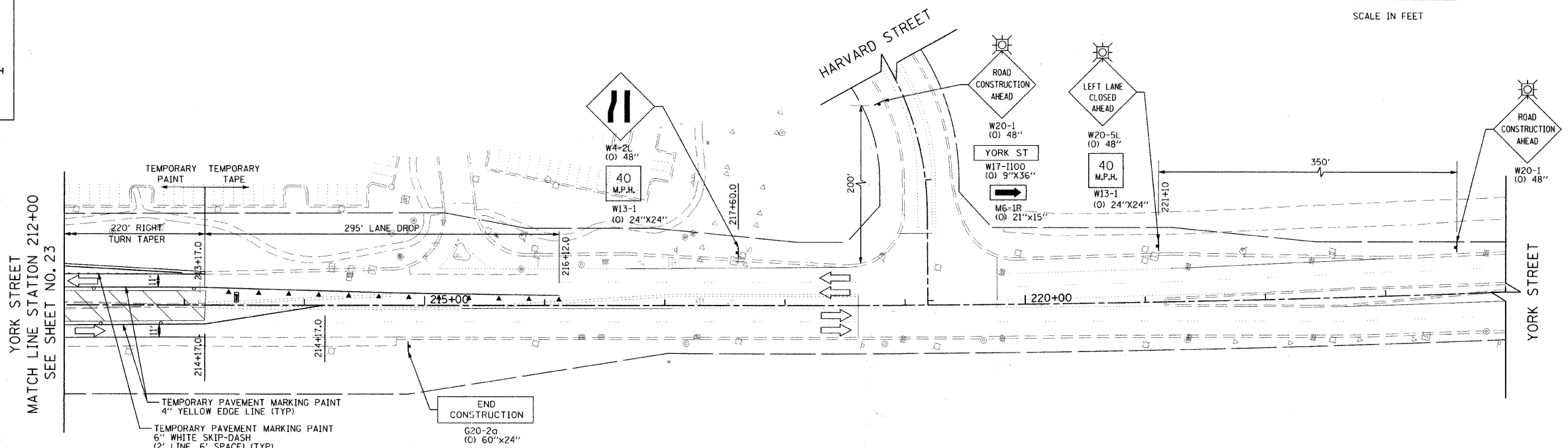

FILE NAME = g:\ch08\0007\road\phase 2\sheeta\01\0007	USER NAME = jmgolemba	DESIGNED - TKH	REVISED -	<b>STATE OF ILLINOIS DEPARTMENT OF TRANSPORTATION</b>	<b>SUGGESTED CONSTRUCTION PROCEDURES AND TRAFFIC CONTROL YORK STREET AT ILLINOIS RTE 38 RAMPS/BRUSH HILL ROAD - STAGE 3</b>		F.A.U. RTE. 2678	SECTION 09-00171-00-CH	COUNTY	TOTAL SHEETS 85	SHEET NO. 24	
PLOT SCALE = 50.0000' / IN.	PLOT DATE = 8/4/2011	DRAWN - TKH	REVISED -		SCALE: 1"=50'	SHEET NO. 24 OF 85 SHEETS	STA. 202+50	TO STA. 214+50	DUPAGE	CONTRACT NO. 63610		
		CHECKED - JMG	REVISED -		FED. ROAD DIST. NO. 7   ILLINOIS FED. AID PROJECT							
		DATE - 7/4/2011	REVISED -									