

**TEMPORARY EROSION CONTROL NOTES**

1. THE ENGINEER WILL CONDUCT A FIELD REVIEW FOR EROSION AND SEDIMENT CONTROL WITH THE PRIME AND SUBCONTRACTORS PRIOR TO ANY EARTHWORK OPERATIONS TO DETERMINE TIMING ADVANCEMENT OF CONTROL MEASURES.
2. THE CONTRACTOR SHALL BE REQUIRED TO IMPLEMENT AND MAINTAIN EROSION CONTROL MEASURES IMMEDIATELY AFTER STRIPPING OF EXISTING VEGETATION.
3. NO CONCENTRATED RUNOFF FLOW FROM STRIPPED AREAS SHALL LEAVE THE SITE WITHOUT BEING TREATED. THE CONTRACTOR SHALL ADJUST HIS OPERATIONS AND IMPLEMENT EROSION CONTROL MEASURES ACCORDINGLY.
4. INLET FILTERS SHALL BE PROVIDED ON ALL PROPOSED INLETS AND CATCH BASINS WITHIN THE PROJECT LIMITS. INLET FILTER CLEANING WILL BE REQUIRED DURING THE CONSTRUCTION PERIOD AS NEEDED. THE COST OF THE CLEANING SHALL BE INCLUDED IN THE COST OF THE INLET FILTERS.
5. EROSION CONTROL MEASURES SHALL BE INSPECTED BY THE CONTRACTOR AND ENGINEER AT LEAST ONCE EVERY SEVEN DAYS AND WITHIN 24 HOURS OF ANY STORM EXCEEDING 1/2" OF PRECIPITATION OR EQUIVALENT SNOWFALL.
6. THE CONTRACTOR SHALL TAKE ALL PRECAUTIONS TO PREVENT POLLUTION OF STORM WATER AND SHALL FOLLOW IEPA & IDOT CONSTRUCTION MEMORANDUM NO. 06-60.
7. STABILIZATION MEASURES SHALL BE INITIATED AS SOON AS PRACTICAL, BUT NO MORE THAN 14 DAYS AFTER CONSTRUCTION ACTIVITY HAS CEASED IN AN AREA WHERE CONSTRUCTION ACTIVITY WILL NOT OCCUR FOR A PERIOD OF 21 OR MORE CALENDAR DAYS.
8. THE CONTRACTOR SHALL APPLY TEMPORARY EROSION CONTROL SEEDING TO ALL ERODIBLE BARE EARTH AREAS WITHIN THE CONTRACT LIMITS EACH WEEK, REGARDLESS OF WEATHER CONDITIONS OR PROGRESS OF THE WORK, UNLESS OTHERWISE DIRECTED BY THE ENGINEER. ERODIBLE EMBANKMENT AND EXCAVATION AREAS WHERE WORK IS IN PROGRESS SHALL BE INCLUDED ON THE AREAS TO BE SEEDING.
9. THE CONTRACTOR SHALL PLACE SEDIMENT CONTROL AND SILT FENCE AROUND ALL EARTH STOCKPILES.
10. THE CONTRACTOR SHALL USE ROLLED EXCELSIOR FOR THE TEMPORARY DITCH CHECKS UNLESS OTHERWISE DIRECTED BY THE ENGINEER.
11. ANY PIPE CULVERTS FOR TEMPORARY DRAINAGE TO BE ABANDONED SHALL BE CUT BACK TO 1' BENEATH THE PROPOSED GRADE, PLUGGED WITH CLASS SI CONCRETE OR BRICK AND MORTAR AND BURIED. THE COST SHALL BE INCLUDED IN THE COST OF THE PIPE CULVERT.

**ESTIMATED QUANTITIES**

TEMPORARY DITCH CHECKS	91 FEET
INLET FILTERS	13 EACH
SEDIMENT CONTROL, SILT FENCE	2,661 LF
PAVEMENT PATCHES	153 SY
PIPE CULVERT, CLASS C, TYPE 2 (TEMPORARY), 18"	59 LF
METAL END SECTION, 18"	2 EACH
TRENCH BACKFILL	15.1 CY

**LEGEND**

SYMBOL	DESCRIPTION
	TEMPORARY DITCH CHECK, SPACED 100' (TYP) UNLESS OTHERWISE NOTED (ROLLED EXCELSIOR, SEE STANDARD 280001)
	INLET FILTERS
	SEDIMENT CONTROL, SILT FENCE (SEE STANDARD 280001)
	DOUBLE LAYER SEDIMENT CONTROL, SILT FENCE (SEE STANDARD 280001)
	PAVEMENT PATCHES (OF THE CLASS SPECIFIED)
	TEMPORARY PAVEMENT (SEE SHEET 19 TO 24 FOR DETAILS)

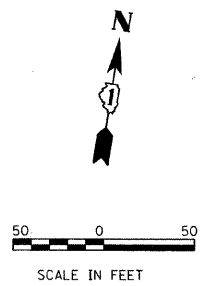
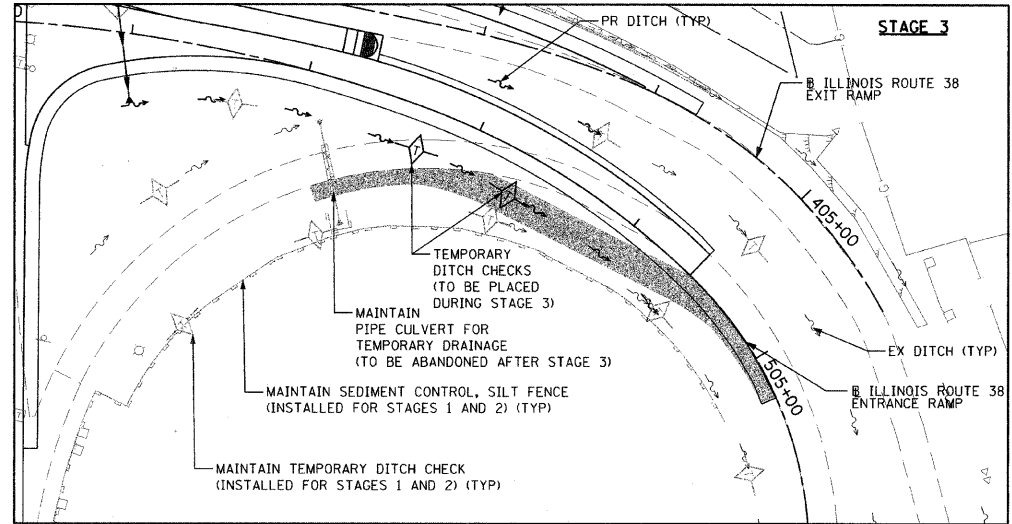
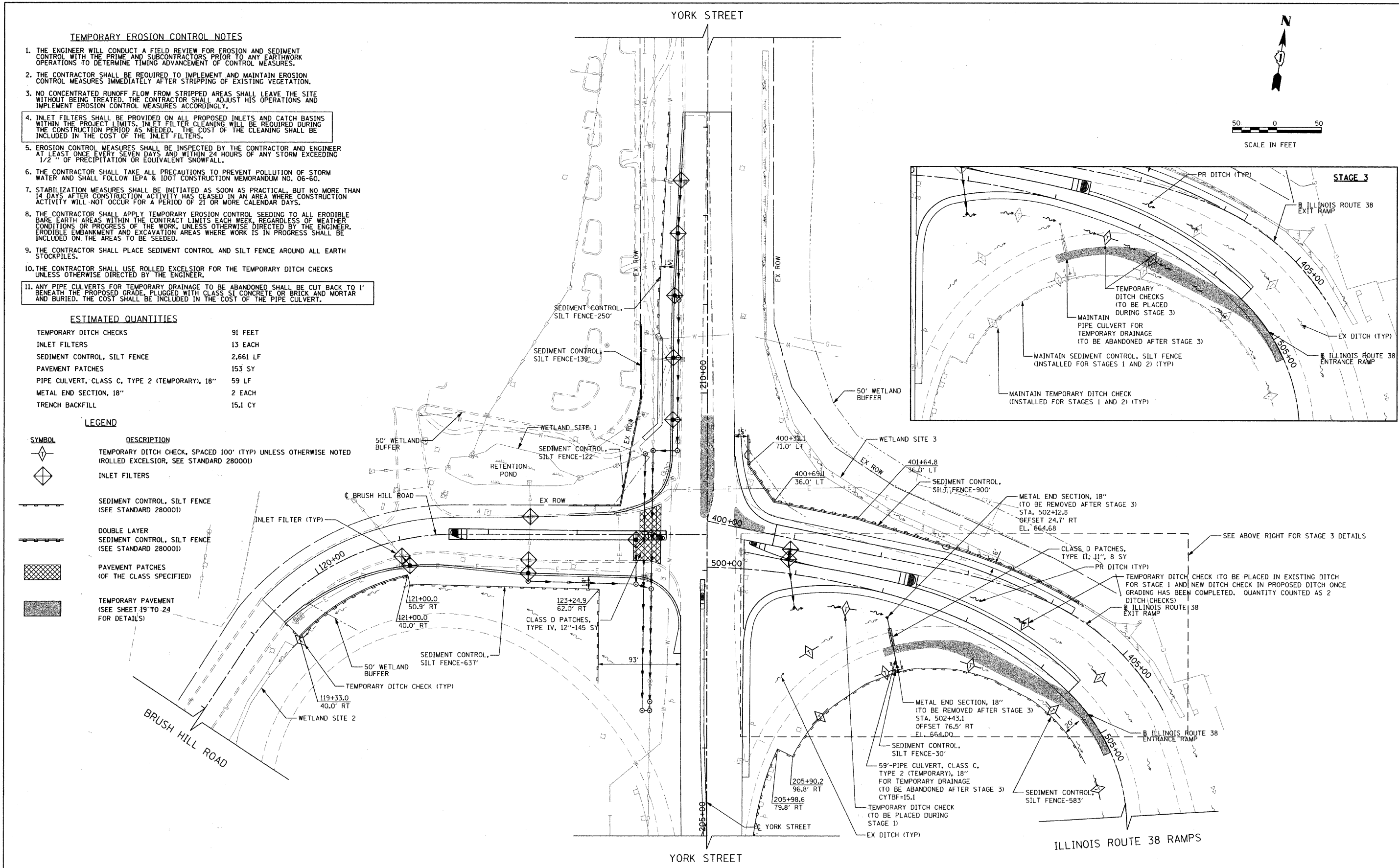

DATE	BY	DATE	BY
DATE	BY	DATE	BY

FILE NAME = g:\ch\08\0007\road\phase 2\sheet\DI\02007	USER NAME = jmgolemba	DESIGNED - ESN	REVISED -	<b>STATE OF ILLINOIS DEPARTMENT OF TRANSPORTATION</b>	<b>YORK STREET AT IL RTE 38 RAMPS/BRUSH HILL ROAD EROSION CONTROL PLAN</b>	F.A.U. RTE. 2678	SECTION 09-00171-00-CH	COUNTY	TOTAL SHEETS 85	SHEET NO. 25		
PLOT SCALE = 50.0000' / IN.	CHECKED - JMC	DATE - 7/4/2011	REVISED -			SCALE: 1"=50'	SHEET NO. 25 OF 85 SHEETS	STA. 202+50 TO STA. 214+50	CONTRACT NO. 63610			
PLOT DATE = 8/4/2011	DATE - 7/4/2011	REVISED -	REVISED -			FED. ROAD DIST. NO. 7 ILLINOIS FED. AID PROJECT						