

PLAN	SURVEYED	DATE
NOTE BOOK	PLOTTED	BY
NO.	CHECKED	
	RT. OF WAY CHECKED	
	PAID FILE NAME	

PROFILE	SURVEYED	DATE
NOTE BOOK	PLOTTED	BY
NO.	CHECKED	
	RT. OF WAY CHECKED	
	STRUCTURE NOTATIONS CHECKED	

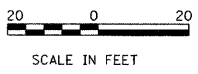

THE CONTRACTOR SHALL BE RESPONSIBLE FOR PERFORMING ALL NECESSARY EQUIPMENT AND PHASING CHANGES TO THE INSTALLATION TO COVER THE DIFFERENT SIGNAL HEAD REQUIREMENTS AND SIGNAL PHASING. THE COST OF THIS WORK WILL BE INCLUDED IN THE COST OF TEMPORARY TRAFFIC SIGNAL INSTALLATION.

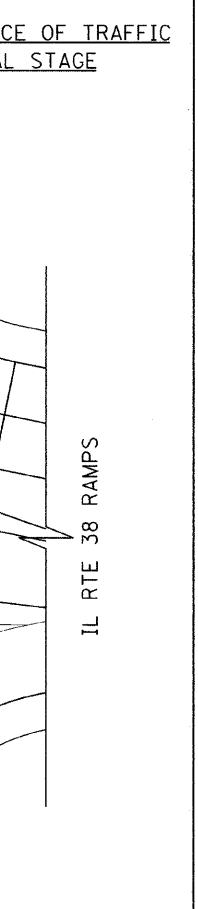
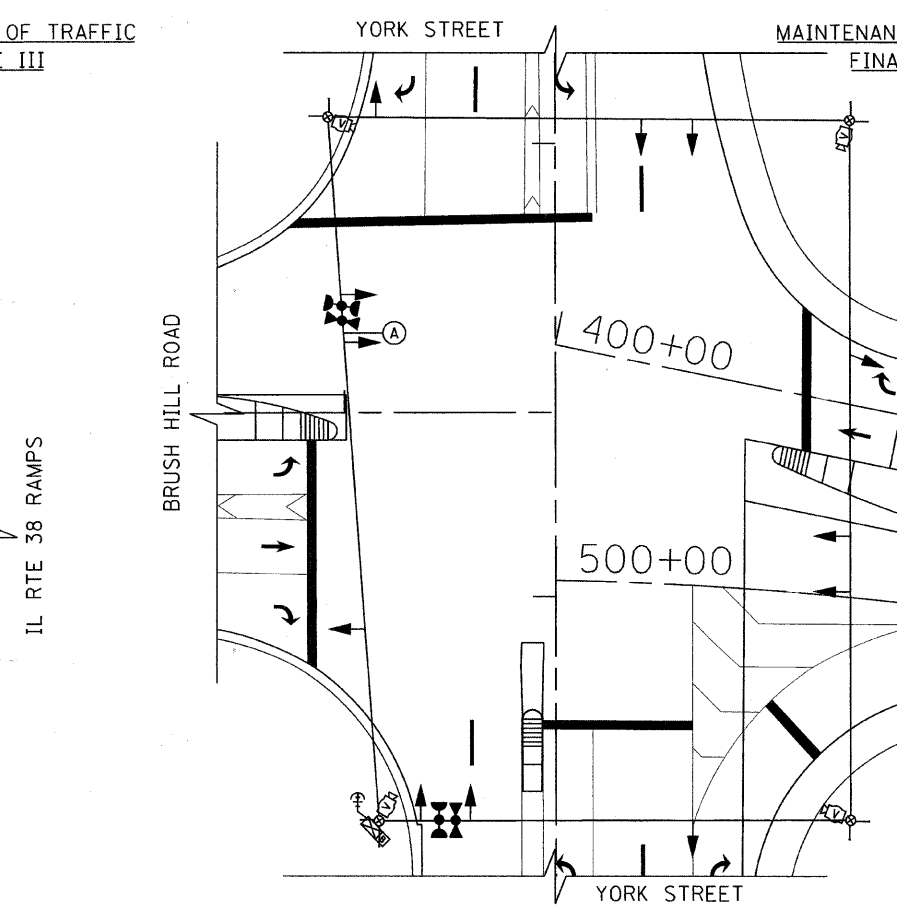
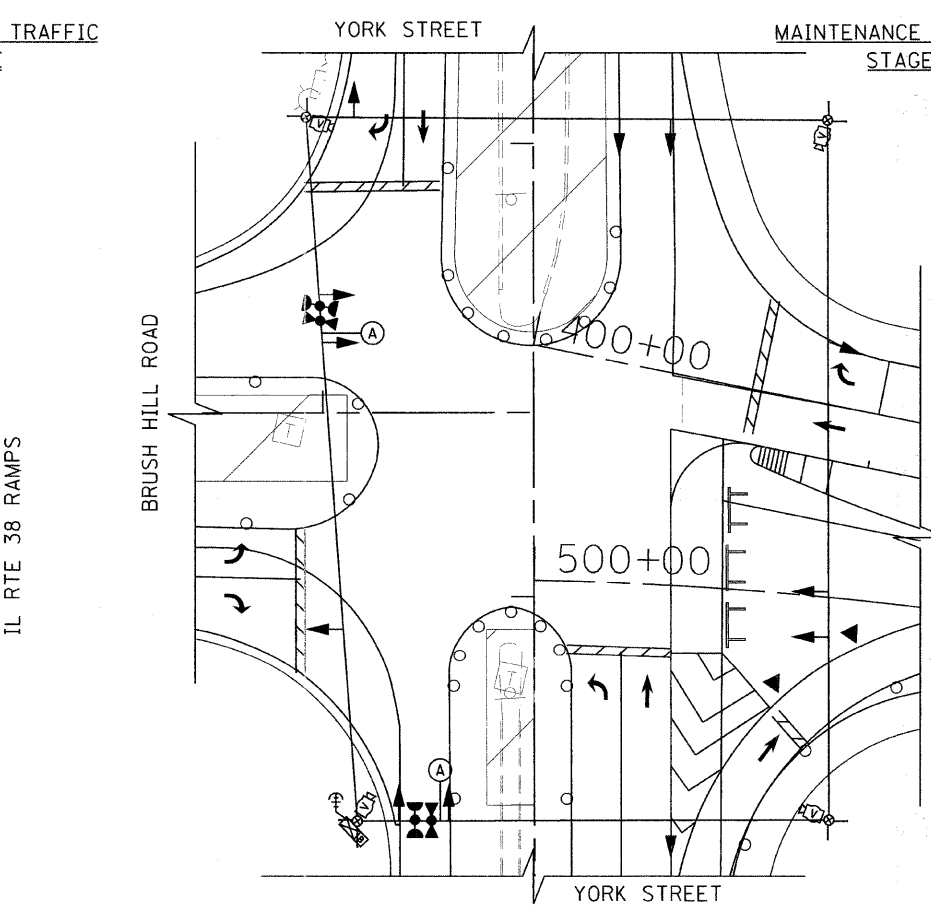
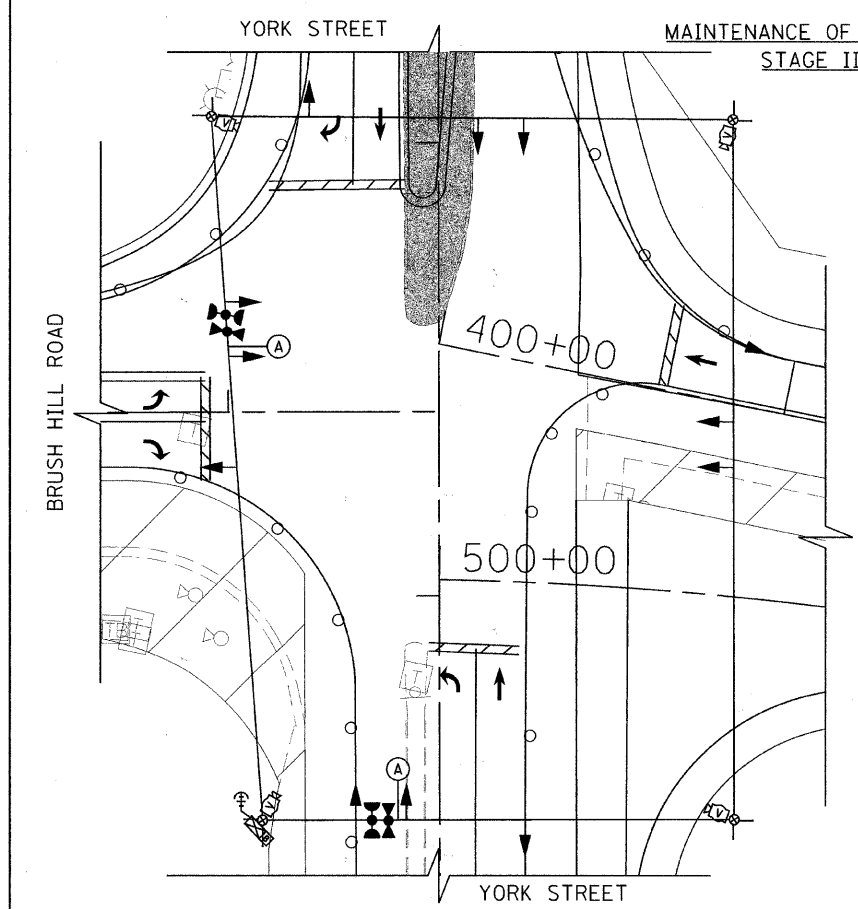
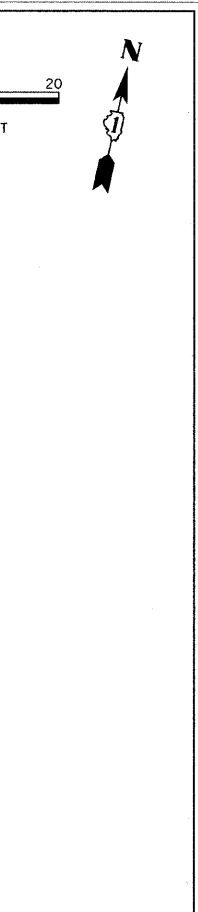
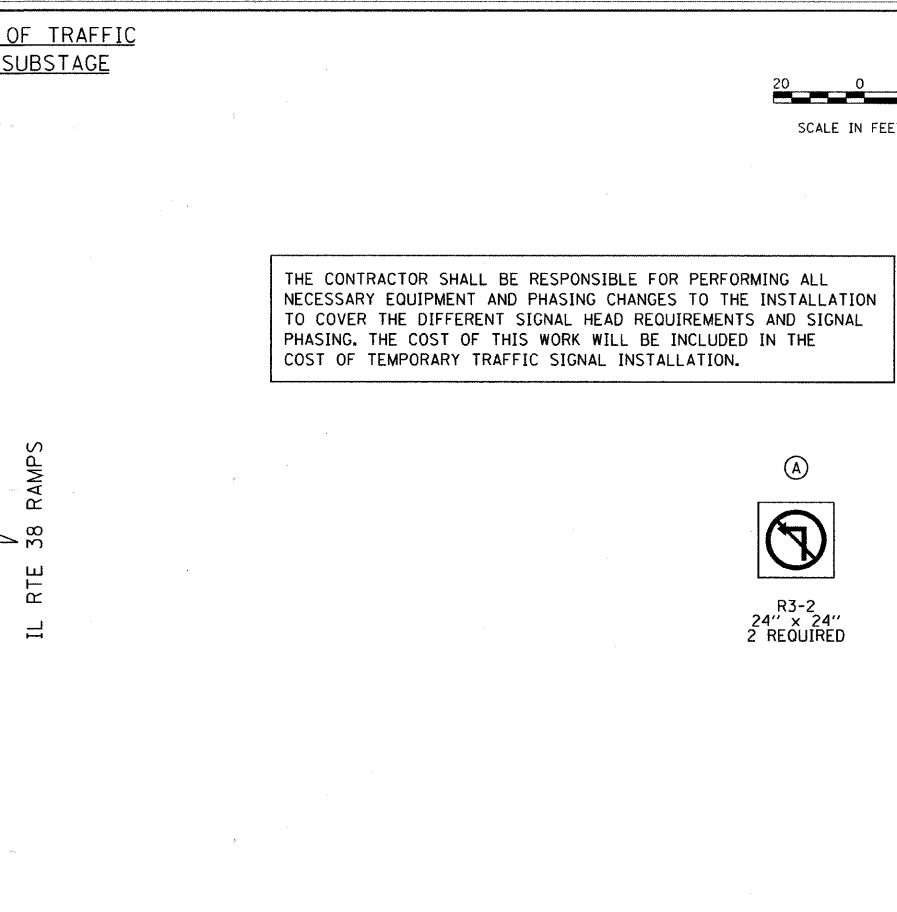
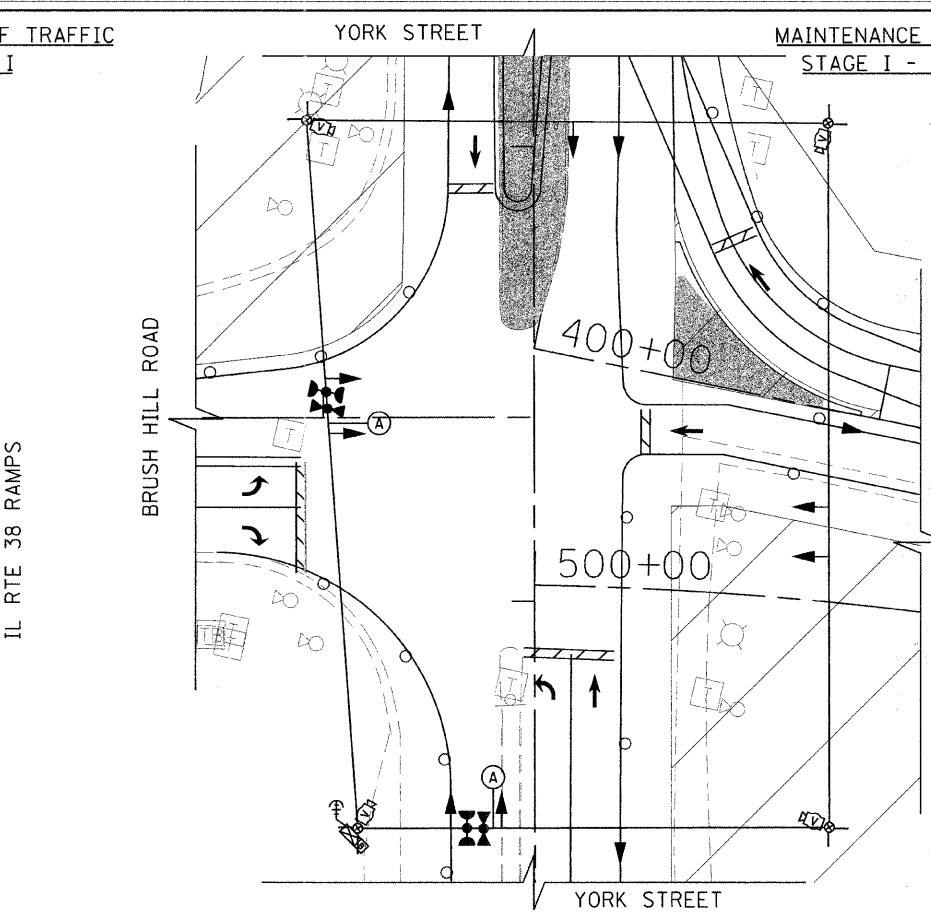
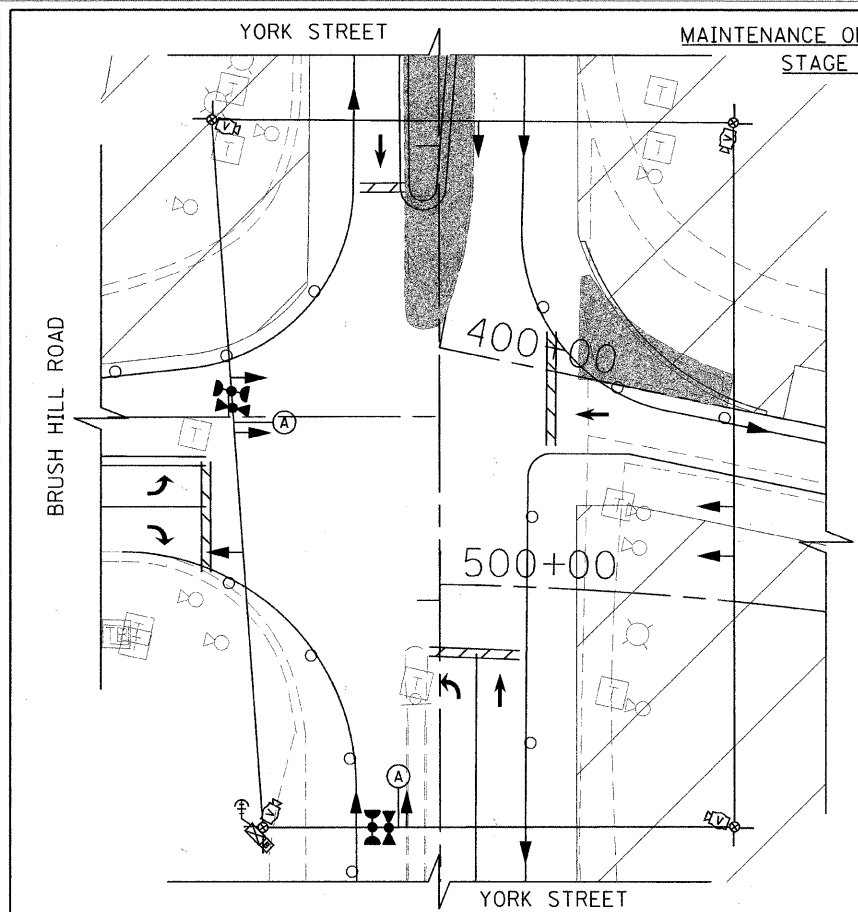

FILE NAME = g:\CH28\0007\Road\Phase 2\Sheets\01X0007

USER NAME = jmgolamba
TS-Temp-Sheet2.dgn
PLOT SCALE = 20.0000' / IN.
PLOT DATE = 6/8/2011

DESIGNED - KB
DRAWN - AJP
CHECKED - KMM
DATE - 7/4/2011

REVISED -
REVISED -
REVISED -
REVISED -

**STATE OF ILLINOIS
DEPARTMENT OF TRANSPORTATION**

**YORK STREET AT IL RTE 38 RAMPS/BRUSH HILL ROAD
TEMPORARY TRAFFIC SIGNAL M.O.T. STAGING PLAN**

SCALE: 1"=20' SHEET NO. 35 OF 85 SHEETS STA. TO STA.

F.A.J. RTE.	SECTION	COUNTY	TOTAL SHEETS	SHEET NO.
2678	09-00171-00-CH	DUPAGE	85	35
FED. ROAD DIST. NO. 7 ILLINOIS FED. AID PROJECT			CONTRACT NO. 63610	