

FINAL SURVEY	SURVEYED	DATE
NOTE BOOK	PLOTTED	BY
NO.	TEMPLATE	
	AREAS CHECKED	

ORIGINAL SURVEY	SURVEYED	DATE
NOTE BOOK	PLOTTED	BY
NO.	TEMPLATE	
	AREAS CHECKED	

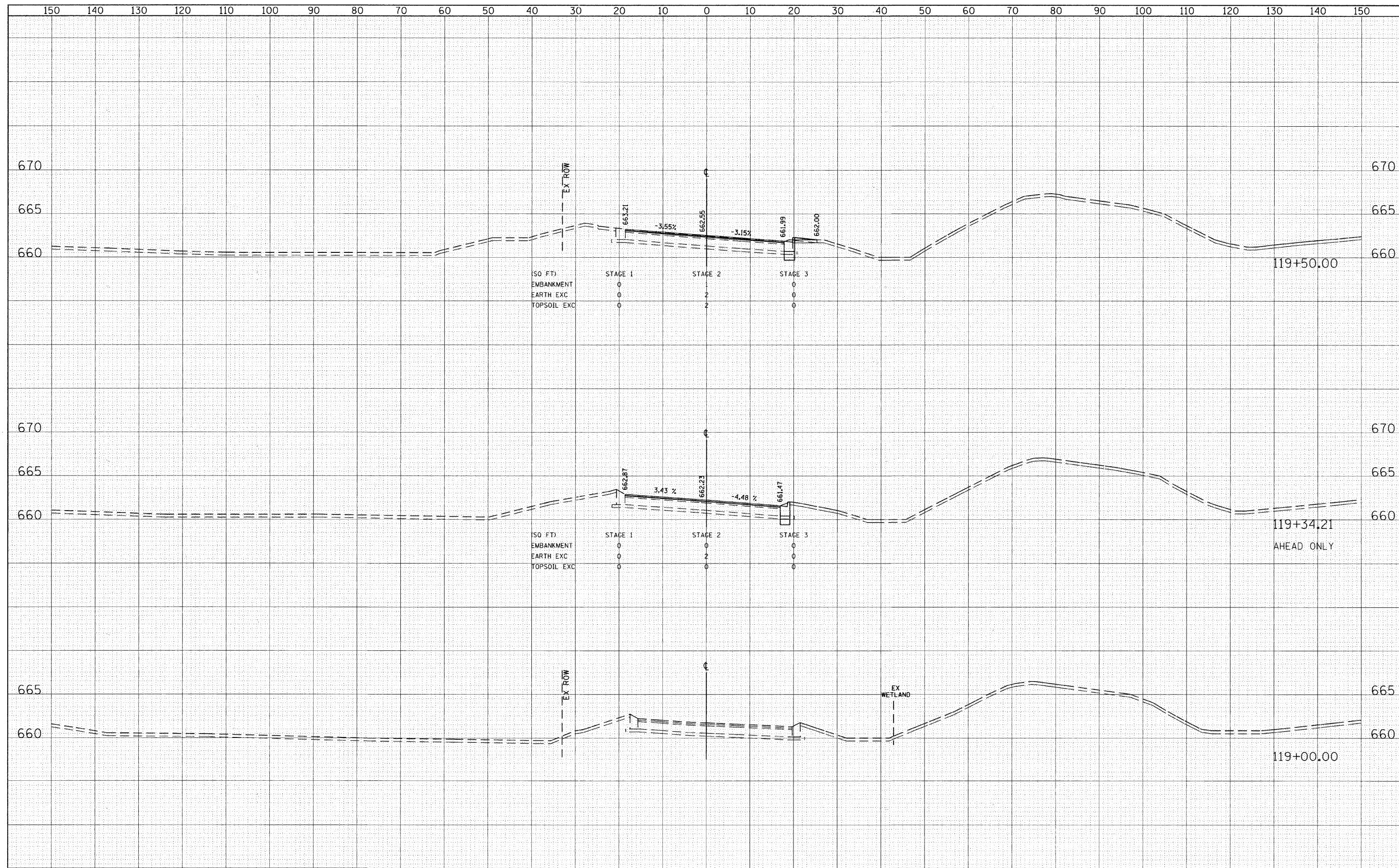

FILE NAME = g:\ch\06\0007\road\phase 2\sheets\01X0007-XSSheet_Brush.dgn	USER NAME = jmgolomb	DESIGNED - TKH	REVISED -	<b>STATE OF ILLINOIS DEPARTMENT OF TRANSPORTATION</b>	<b>PROPOSED CROSS SECTIONS BRUSH HILL ROAD</b>				F.A.U. RTE. 2678	SECTION 09-00171-00-CH	COUNTY DUPAGE	TOTAL SHEETS 85	SHEET NO. 79
PLOT SCALE = 10.0000' / IN.	PLOT DATE = 8/4/2011	CHECKED - JMG	REVISED -		SCALE: HORIZ: 1"=10'	SHEET NO. 79 OF 85 SHEETS	STA. 119+00.00 TO STA. 119+50.00	CONTRACT NO. 63610					
		DATE - 7/4/2011	REVISED -		ILLINOIS FED. AID PROJECT								