

PLAN	SURVEYED	DATE
	PLOTTED	BY
	CHECKED	
	RT. OF WAY CHECKED	
	CADD FILE NAME	
	NO.	

PROFILE	SURVEYED	DATE
	PLOTTED	BY
	CHECKED	
	STRUCTURE NOTATIONS CHKD	
	NOTE BOOK	
	FILE NAME	
	SCALE	
	USER NAME	

FILE NAME = P:\2010\ME10015\_Roselle\_DP\CDOT\CADD\Shts\Roselle-sht-DU02.dgn  
 USER NAME = Millennium Professional Services

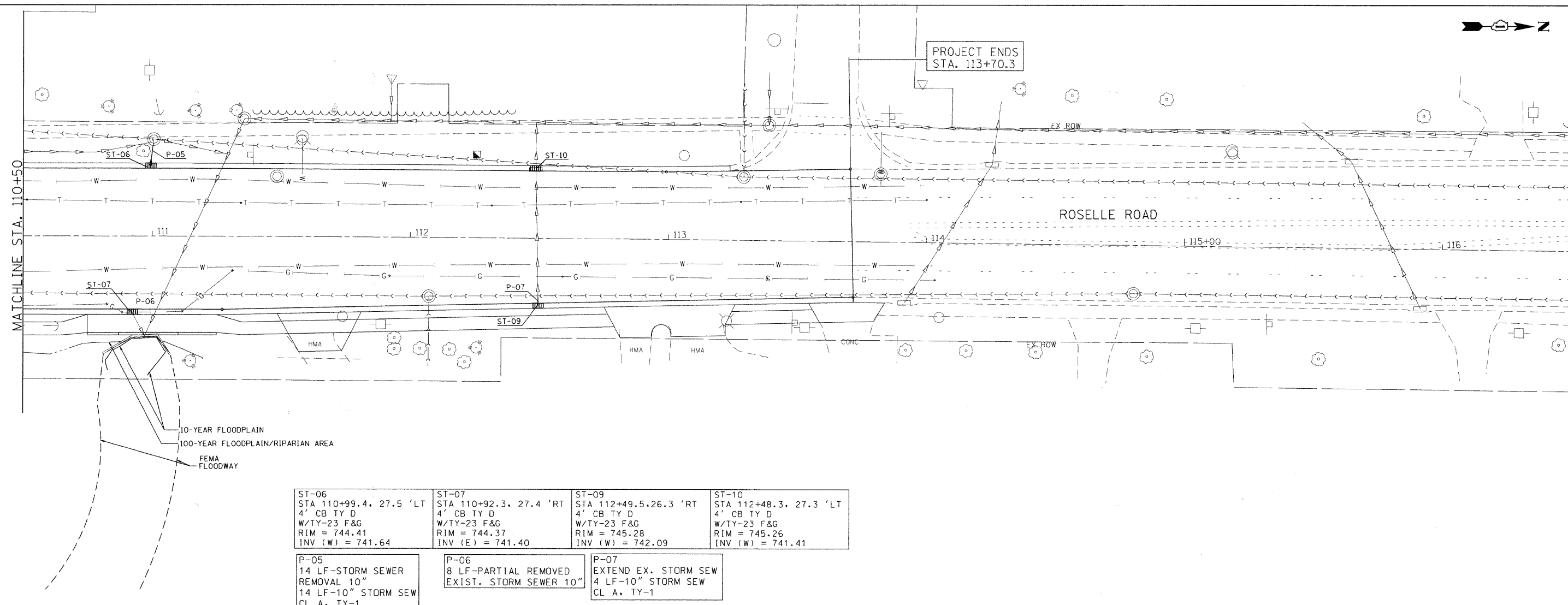

<b>ST-06</b> STA 110+99.4, 27.5 'LT 4' CB TY D W/TY-23 F&G RIM = 744.41 INV (W) = 741.64	<b>ST-07</b> STA 110+92.3, 27.4 'RT 4' CB TY D W/TY-23 F&G RIM = 744.37 INV (E) = 741.40	<b>ST-09</b> STA 112+49.5, 26.3 'RT 4' CB TY D W/TY-23 F&G RIM = 745.28 INV (W) = 742.09	<b>ST-10</b> STA 112+48.3, 27.3 'LT 4' CB TY D W/TY-23 F&G RIM = 745.26 INV (W) = 741.41
<b>P-05</b> 14 LF-STORM SEWER REMOVAL 10" 14 LF-10" STORM SEW CL A, TY-1	<b>P-06</b> 8 LF-PARTIAL REMOVED EXIST. STORM SEWER 10"	<b>P-07</b> EXTEND EX. STORM SEW 4 LF-10" STORM SEW CL A, TY-1	

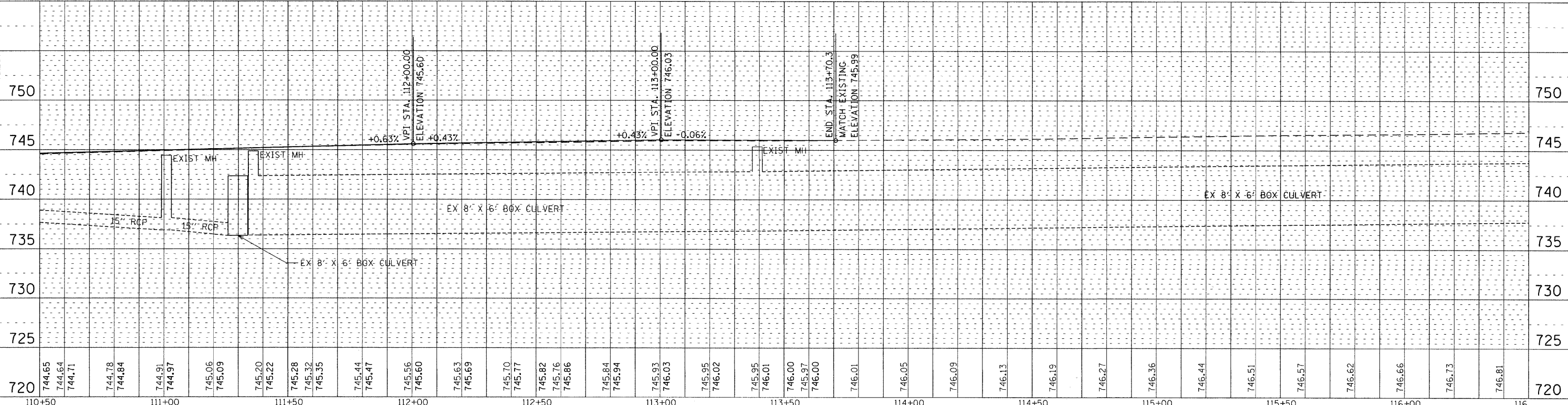

**MILLENNIA PROFESSIONAL SERVICES**  
 200 22ND Street, Suite 216, Lombard, IL 60148  
 630.705.0110 voice, 630.839.2566 fax  
 WWW.MPS-IL.COM

DESIGNED	TVN	REVISED	
DRAWN	TVN	REVISED	
CHECKED	RPD	REVISED	
DATE	8/15/2011	REVISED	

**DUPAGE COUNTY  
 DEPARTMENT OF TRANSPORTATION**

**ROSELLE RD. & WALNUT ST.  
 INTERSECTION IMPROVEMENTS**  
 DRAINAGE AND UTILITIES PLAN  
 SCALE: 1"=20' SHEET NO. 2 OF 3 SHEETS STA. 110+50 TO STA. 113+70.3

F.A.P. RTE.	SECTION	COUNTY	TOTAL SHEETS	SHEET NO.
364	07-00184-12-CH	DUPAGE	49	21
CONTRACT NO. 63611				
FED. ROAD DIST. NO. 1 ILLINOIS FED. AID PROJECT				

P:\2010\ME10015\_Roselle\_DP\CDOT\CADD\Shts\Roselle-sht-DU02.dgn