

NOTE:  
THE EQUIPMENT AND WORK REQUIRED TO MOUNT THE VIDEO DETECTION CAMERAS WILL NOT BE PAID FOR SEPARATELY, BUT SHALL BE INCLUDED IN THE COST OF THE TEMPORARY TRAFFIC SIGNAL INSTALLATION.

**TEMPORARY VIDEO DETECTION CAMERA MOUNTING DETAIL**

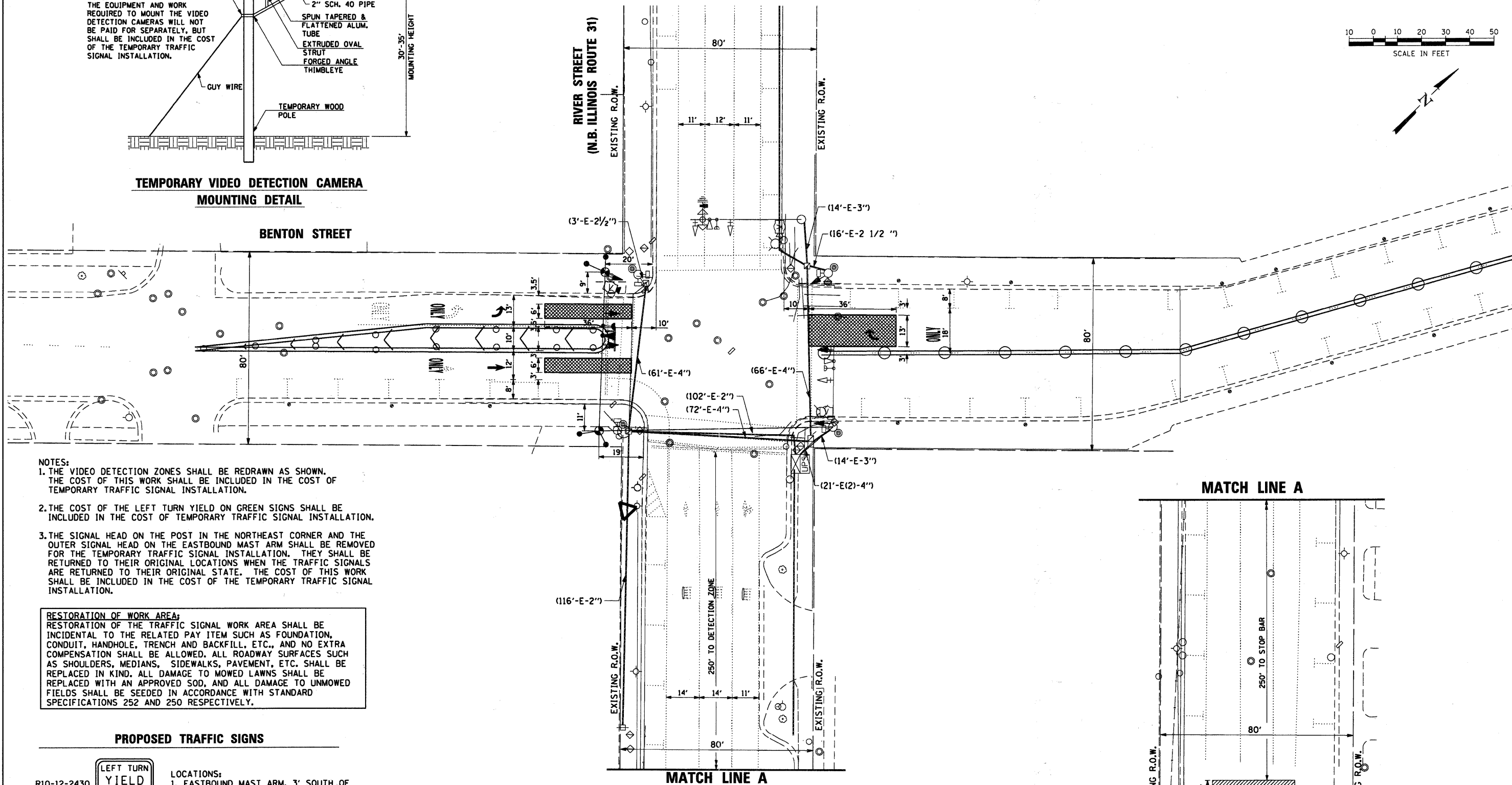
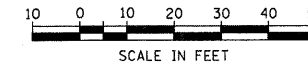

- NOTES:**
1. THE VIDEO DETECTION ZONES SHALL BE REDRAWN AS SHOWN. THE COST OF THIS WORK SHALL BE INCLUDED IN THE COST OF TEMPORARY TRAFFIC SIGNAL INSTALLATION.
  2. THE COST OF THE LEFT TURN YIELD ON GREEN SIGNS SHALL BE INCLUDED IN THE COST OF TEMPORARY TRAFFIC SIGNAL INSTALLATION.
  3. THE SIGNAL HEAD ON THE POST IN THE NORTHEAST CORNER AND THE OUTER SIGNAL HEAD ON THE EASTBOUND MAST ARM SHALL BE REMOVED FOR THE TEMPORARY TRAFFIC SIGNAL INSTALLATION. THEY SHALL BE RETURNED TO THEIR ORIGINAL LOCATIONS WHEN THE TRAFFIC SIGNALS ARE RETURNED TO THEIR ORIGINAL STATE. THE COST OF THIS WORK SHALL BE INCLUDED IN THE COST OF THE TEMPORARY TRAFFIC SIGNAL INSTALLATION.

**RESTORATION OF WORK AREA:**  
RESTORATION OF THE TRAFFIC SIGNAL WORK AREA SHALL BE INCIDENTAL TO THE RELATED PAY ITEM SUCH AS FOUNDATION, CONDUIT, HANDHOLE, TRENCH AND BACKFILL, ETC., AND NO EXTRA COMPENSATION SHALL BE ALLOWED. ALL ROADWAY SURFACES SUCH AS SHOULDERS, MEDIANS, SIDEWALKS, PAVEMENT, ETC. SHALL BE REPLACED IN KIND. ALL DAMAGE TO MOWED LAWNS SHALL BE REPLACED WITH AN APPROVED SOD, AND ALL DAMAGE TO UNMOWED FIELDS SHALL BE SEEDED IN ACCORDANCE WITH STANDARD SPECIFICATIONS 252 AND 250 RESPECTIVELY.

**PROPOSED TRAFFIC SIGNS**

R10-12-2430  
(2 EACH)



- LOCATIONS:**
1. EASTBOUND MAST ARM, 3' SOUTH OF THE OUTER 5-SECTION SIGNAL HEAD.
  2. TRAFFIC SIGNAL POST IN NORTHEAST CORNER FACING WEST.

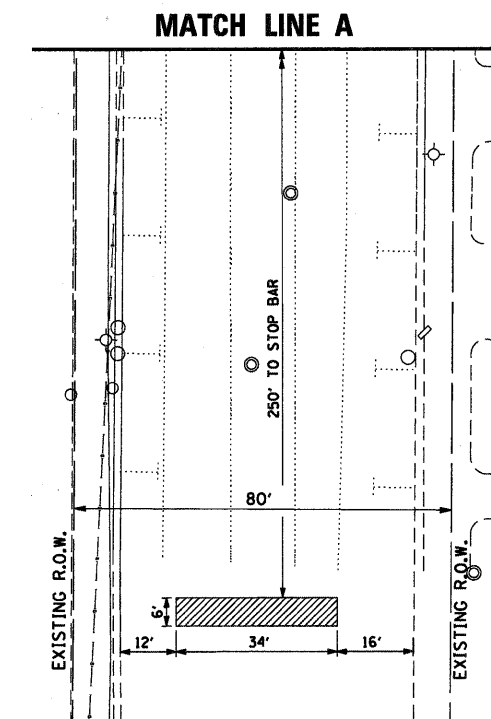

HRGREEN  
PROJECT CONTACT: Richard A. Harshbarger  
DATE PLOTTED: 7/26/2011 10:55:11 AM  
FILE NAME: 86090472-181901a.dgn  
PLOT DRIVER: pdfplot  
PEN TABLE: Struct 22x34.tbl



USER NAME = whood	DESIGNED - MJF	REVISED -
FILE NAME = 86090472-181901a.dgn	DRAWN - JMR	REVISED -
PLOT SCALE =	CHECKED - APS	REVISED -
PLOT DATE = 7/26/2011	DATE - 7/26/11	REVISED -

**CITY OF AURORA**

**TEMPORARY TRAFFIC SIGNAL INSTALLATION PLAN  
BENTON ST. AND RIVER ST. (IL RT. 31)**

SCALE: SHEET NO. 1 OF 3 SHEETS STA. TO STA.

F.A.U. RTE.	SECTION	COUNTY	TOTAL SHEETS	SHEET NO.
	07-00264-00-BR	KANE	164	27
CONTRACT NO. 63620				
FED. ROAD DIST. NO. [ILLINOIS] FED. AID PROJECT				