

PLAN	SURVEYED	DATE
	PLOTTED	
	CHECKED	
	BY	
	NO.	
	FILE NAME	

PROFILE	SURVEYED	DATE
	PLOTTED	
	CHECKED	
	BY	
	NO.	
	FILE NAME	

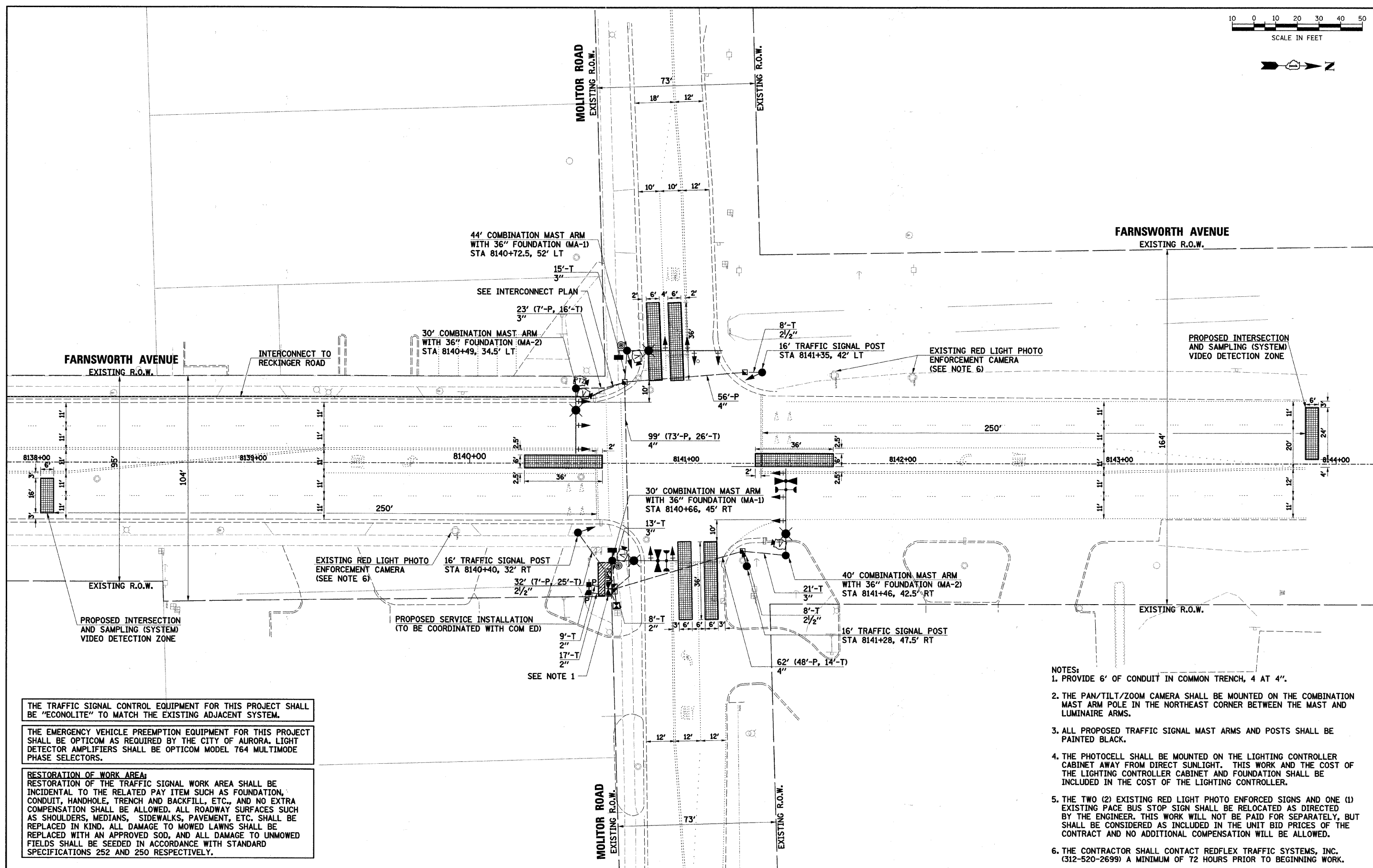

THE TRAFFIC SIGNAL CONTROL EQUIPMENT FOR THIS PROJECT SHALL BE "ECONOLITE" TO MATCH THE EXISTING ADJACENT SYSTEM.

THE EMERGENCY VEHICLE PREEMPTION EQUIPMENT FOR THIS PROJECT SHALL BE OPTICOM AS REQUIRED BY THE CITY OF AURORA. LIGHT DETECTOR AMPLIFIERS SHALL BE OPTICOM MODEL 764 MULTIMODE PHASE SELECTORS.

RESTORATION OF WORK AREA:
 RESTORATION OF THE TRAFFIC SIGNAL WORK AREA SHALL BE INCIDENTAL TO THE RELATED PAY ITEM SUCH AS FOUNDATION, CONDUIT, HANDHOLE, TRENCH AND BACKFILL, ETC., AND NO EXTRA COMPENSATION SHALL BE ALLOWED. ALL ROADWAY SURFACES SUCH AS SHOULDERS, MEDIANS, SIDEWALKS, PAVEMENT, ETC. SHALL BE REPLACED IN KIND. ALL DAMAGE TO MOWED LAWNS SHALL BE REPLACED WITH AN APPROVED SOD, AND ALL DAMAGE TO UNMOWED FIELDS SHALL BE SEEDED IN ACCORDANCE WITH STANDARD SPECIFICATIONS 252 AND 250 RESPECTIVELY.

- NOTES:
1. PROVIDE 6' OF CONDUIT IN COMMON TRENCH, 4 AT 4".
 2. THE PAN/TILT/ZOOM CAMERA SHALL BE MOUNTED ON THE COMBINATION MAST ARM POLE IN THE NORTHEAST CORNER BETWEEN THE MAST AND LUMINAIRE ARMS.
 3. ALL PROPOSED TRAFFIC SIGNAL MAST ARMS AND POSTS SHALL BE PAINTED BLACK.
 4. THE PHOTOCCELL SHALL BE MOUNTED ON THE LIGHTING CONTROLLER CABINET AWAY FROM DIRECT SUNLIGHT. THIS WORK AND THE COST OF THE LIGHTING CONTROLLER CABINET AND FOUNDATION SHALL BE INCLUDED IN THE COST OF THE LIGHTING CONTROLLER.
 5. THE TWO (2) EXISTING RED LIGHT PHOTO ENFORCED SIGNS AND ONE (1) EXISTING PACE BUS STOP SIGN SHALL BE RELOCATED AS DIRECTED BY THE ENGINEER. THIS WORK WILL NOT BE PAID FOR SEPARATELY, BUT SHALL BE CONSIDERED AS INCLUDED IN THE UNIT BID PRICES OF THE CONTRACT AND NO ADDITIONAL COMPENSATION WILL BE ALLOWED.
 6. THE CONTRACTOR SHALL CONTACT REDFLEX TRAFFIC SYSTEMS, INC. (312-520-2699) A MINIMUM OF 72 HOURS PRIOR TO BEGINNING WORK.

HRGreen.com Illinois Professional Design Firm #154-001322	USER NAME = Mfaller PLOT SCALE = PLOT DATE = 7/1/2011	DESIGNED <i>JRS</i> DRAWN <i>JRS</i> CHECKED <i>APS</i> DATE -	REVISED - REVISED - REVISED - REVISED -	STATE OF ILLINOIS DEPARTMENT OF TRANSPORTATION	TRAFFIC SIGNAL INSTALLATION PLAN MOLITOR ROAD	F.A.P. RTE. 360 SECTION 09-00289-00-TL COUNTY KANE TOTAL SHEETS 37 SHEET NO. 25 CONTRACT NO. 63627
	SCALE: SHEET NO. OF SHEETS STA. TO STA.				FED. ROAD DIST. NO. ILLINOIS FED. AID PROJECT	