

# PLANS FOR PROPOSED FEDERAL-AID BRIDGE REPLACEMENT & REHABILITATION PROGRAM

PLAN 1 INCH = 50 FEET  
 PROFILE (HOR.) 1 INCH = 50 FEET  
 PROFILE (VERT.) 1 INCH = 5 FEET  
 CROSS SECTIONS 1 INCH = 5/10 FEET

## SUMMARY OF QUANTITIES

	ITEM	UNIT	QUANTITY
20200100	EARTH EXCAVATION	CU YD	173
20900110	POROUS GRANULAR BACKFILL	CU YD	176
35101400	AGGREGATE BASE CSE, TY B	TON	208
50100100	REMOVAL OF EXISTING STRUCTURE	EA.	1
50200100	STRUCTURE EXCAVATION	CU. YD.	293
50800205	REINFORCEMENT BARS, EPOXY COATED	LB.	13,350
54003000	CONCRETE BOX CULVERT	CU. YD.	83.6
67100100	MOBILIZATION	L SUM	1
X2501000	SEEDING CL 2. SPL.	ACRE	0.12
X7010216	TRAFFIC CONTROL & PROTECTION. SPL	L SUM	1

## INDEX OF SHEETS

- INDEX OF SHEETS, SUMMARY OF QUANTITIES
- PLAN AND PROFILE, TYPICAL SECTION
- CROSS SECTIONS
- GENERAL PLAN AND ELEVATION

F.A.S. 78  
 SHANNON ROUTE  
 SECTION 10-00091-01-DR  
 CARROLL COUNTY  
 PROJECT NO. ER-0078(109)  
 CONTRACT NO. 85544  
 JOB NO. C - 92-083-11

SECTION 10-00091-01-DR  
 BEGINS AT STA. 0+00

R 6 E OF THE 4TH P.M.

SECTION 10-00091-01-DR  
 ENDS AT STA. 6+00

- STANDARDS:
- 280001-05 TEMPORARY EROSION CONTROL SYSTEMS
  - 701006-03 OFF-RD OPERATIONS, 2L, 2W 15' TO 24"
  - 701301-04 LANE CLOSURE, 2L, 2W, SHORT TIME OPERATIONS
  - 701901-01 TRAFFIC CONTROL DEVICES
  - 720011-01 METAL POSTS FOR SIGNS, MARKERS & DELINEATORS
  - 728001-01 TELESCOPING STEEL SIGN SUPPORT
  - 729001-01 APPLS. OF TYPES A & B METAL POSTS
  - BLR 21-8 TYP. APPLICATION OF TRAFFIC CONTROL DEVICES
  - BLR 22-6 TYP. APPLICATION OF TRAFFIC CONTROL DEVICES FOR CONSTRUCTION ON RURAL LOCAL HIGHWAYS

## SECTION 10-00091-01-DR

INCLUDES THE REMOVAL OF A 10' X 8' X 42' REINFORCED CONCRETE BOX CULVERT AND CONSTRUCTION OF A 10' X 8' X 52'-6" REINFORCED CONCRETE BOX CULVERT ALSO INCLUDED IS APPROACH ROADWAY CONSTRUCTION.

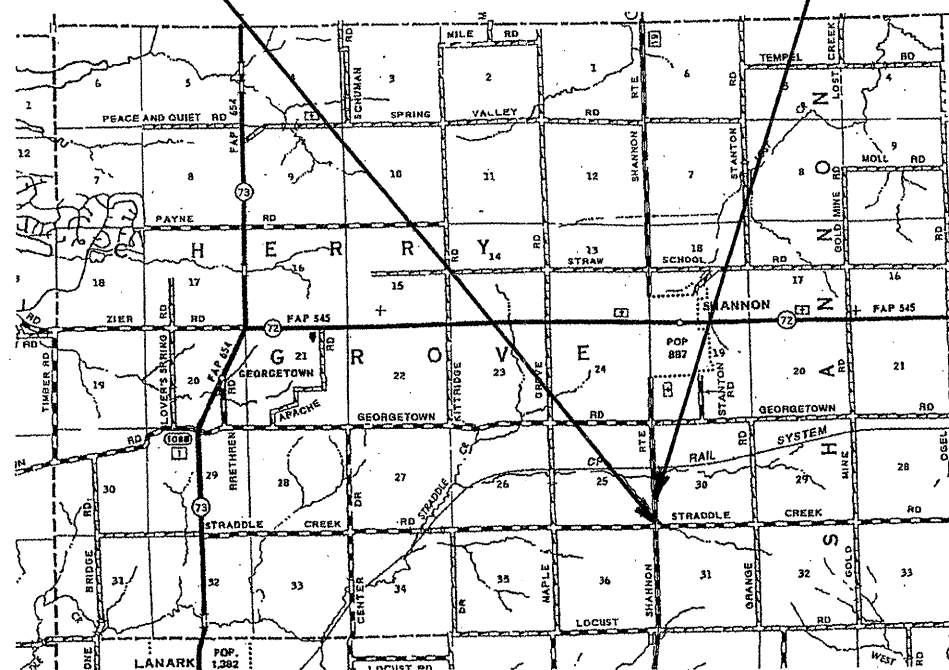

LOCATION MAP

NET LENGTH OF SECTION = 100 FT. = 0.019 MILE

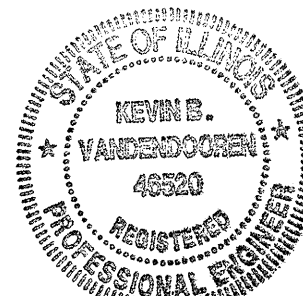

*Kevin B. Vandervooren*  
 6/24/2011  
 Expires 11/30/2011

CONSTRUCTION TYPE CODE 0040

85544

"CALL J.U.L.I.E. BEFORE YOU DIG"  
 JOINT UTILITY LOCATION INFORMATION FOR EXCAVATION  
 1-800-892-0123

DESIGN: MINOR COLLECTOR, ADT 1800 (20 YEAR), 3% TRUCKS, 50 MPH DESIGN SPEED, 3R GUIDELINES

STATE OF ILLINOIS DEPARTMENT OF TRANSPORTATION	
APPROVED <i>June 24 2011</i>	<i>Kevin B. Vandervooren</i> CARROLL COUNTY ENGINEER
PASSED <i>July 6 2011</i>	<i>Joe P. Jones</i> DISTRICT ENGINEER OF LOCAL ROADS AND STREETS
Releasing for Bid Based on Limited Review	<i>July 6 2011</i> <i>Kevin S. Thibault</i> Deputy Director of Highways, Region 2 Engineer