

B.M. # 1
 FORM PIN IN CORNER POST
 STA. 0+25.03, 41.49' LT.
 ELEV = 100.09 ASSUMED

F.A.S. DATE	SECTION	COUNTY	TOTAL SHEETS	SHEET NO.
78	10-00091-01-DR	CARROLL	4	2
STA. TO STA.				
FED. AID DIST. NO.	ILLINOIS	FED. AID PROJECT		

85544

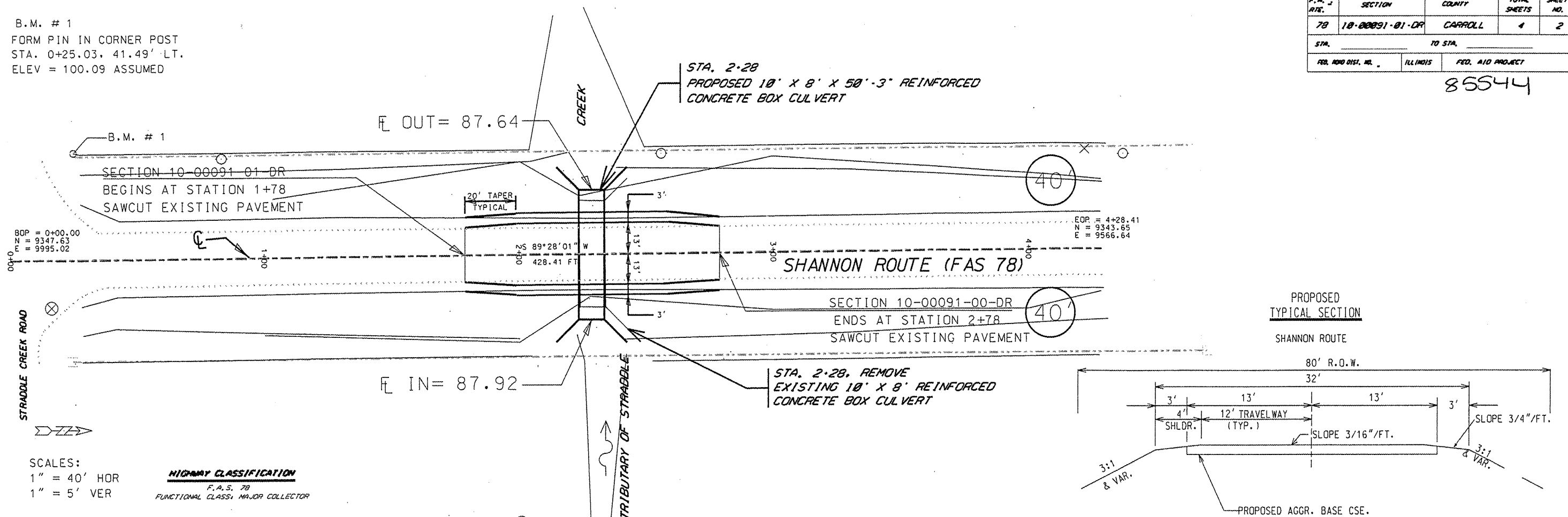

SCALES:
 1" = 40' HOR
 1" = 5' VER

HIGHWAY CLASSIFICATION
 F.A.S. 78
 FUNCTIONAL CLASS: MAJOR COLLECTOR

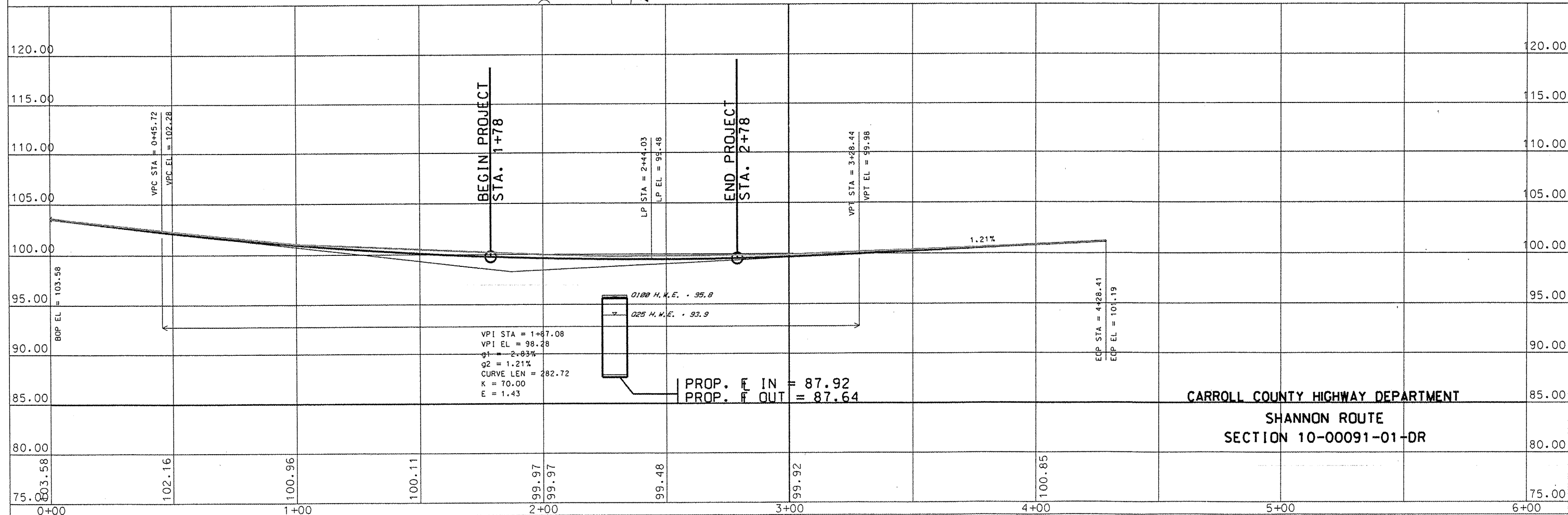

CARROLL COUNTY HIGHWAY DEPARTMENT
 SHANNON ROUTE
 SECTION 10-00091-01-DR