

STAGING TYPICAL SECTIONS

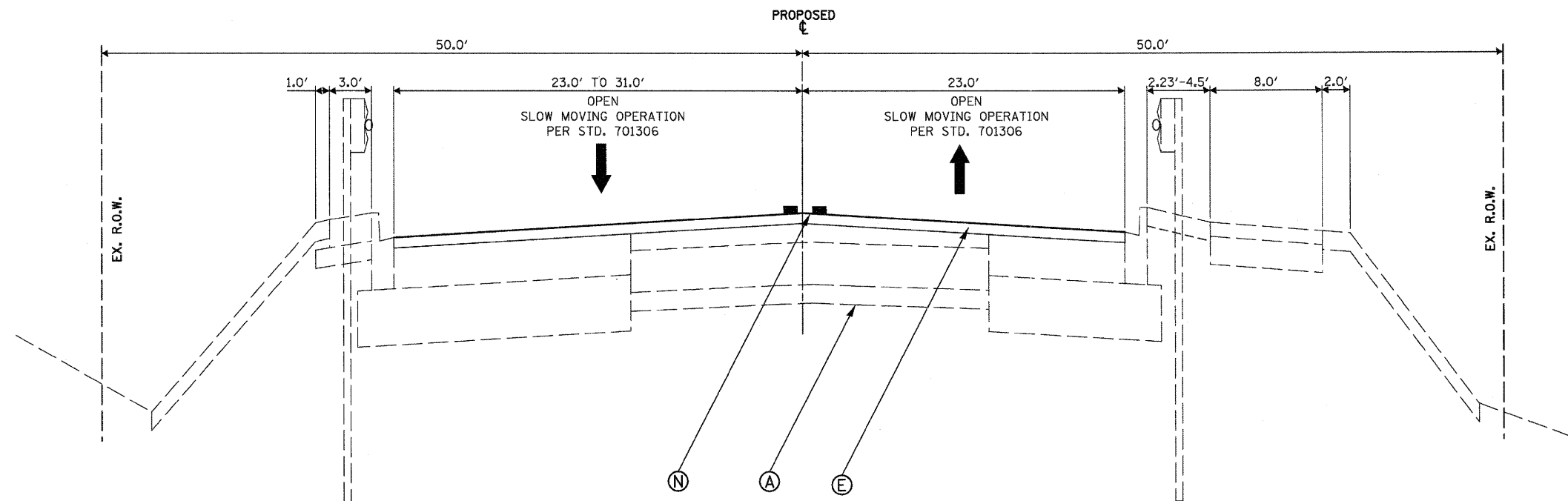

**STAGE 3
FINAL SURFACE COURSE**
STA. 15+86.6 TO STA. 16+87.2
OMIT BRIDGE
STA. 18+79.9 TO STA. 19+85.2

STAGE 3

- CONSTRUCT TEMPORARY RAMP STA. 17+10.4 TO STA. 17+17.2, RT AND STA. 18+49.9 TO STA. 18+56.7, RT.
- OPEN ALL LANES TO TRAFFIC FROM STA. 13+42 TO STA. 21+57.
- CONSTRUCT PAVEMENT SURFACE REMOVAL (BUTT JOINTS) AND STA. 13+19 TO STA. 15+16 AND STA. 20+82 TO STA. 21+80.
- MAINTENANCE OF TRAFFIC FOR THE BUTT JOINT CONSTRUCTION SHALL BE COMPLETED UTILIZING TRAFFIC CONTROL STD. 701306.
- TEMPORARY RAMPS STA. 13+19 TO STA. 13+25.8 AND STA. 21+73.2 TO STA. 21+80.
- APPLY BITUMINOUS TACK COAT. MAINTENANCE OF TRAFFIC FOR THE TACK COAT SHALL BE COMPLETED UTILIZING TRAFFIC CONTROL STD. 701306.
- CONSTRUCT HMA SURFACE COURSE FROM STA. 13+19 TO STA. 17+17.2 AND STA. 18+49.9 TO STA. 21+80. THIS WORK SHALL BE COMPLETED UTILIZING TRAFFIC CONTROL STANDARDS 701306.
- PLACE ALL PERMANENT PAVEMENT MARKINGS STA. 12+19 TO STA. 22+80.
- COMPLETE RESTORATION OF THE PROJECT AREA.
- REMOVE REMAINING CONSTRUCTION TRAFFIC CONTROL DEVICES AND SIGNAGE.

LEGEND

- (A) EXIST. PAVEMENT STRUCTURE
- (B) EXIST. PAVEMENT AND SHOULDER STRUCTURE - TO BE REMOVED
- (C) EXIST. GUARDRAIL W/PROP. GUARDRAIL MARKERS
- (D) PROP. PAVEMENT STRUCTURE (AGGREGATE BASE/HMA BINDER ONLY)
- (E) PROP. SURFACE COURSE
- (F) PROP. MULTI-USE PATH/AGGREGATE BASE COURSE
- (G) PROP. AGGREGATE SHOULDERS
- (H) PROP. STEEL PLATE BEAM GUARDRAIL, TYPE A W/GUARDRAIL MKRS.
- (I) PROP. BASE COURSE WIDENING
- (J) 10" TEMPORARY PAVEMENT W/4" AGGREGATE BASE COURSE
2 1/4" - HMA SURFACE COURSE, MIX "D", N50
7 3/4" - HMA BINDER COURSE, IL-19.0 (2 LIFTS)
- (K) AGGREGATE WEDGE SHOULDER, TYPE B
- (L) TEMPORARY PAVEMENT MARKING LINE
- (M) SAWCUT - FULL DEPTH
- (N) SHORT-TERM PAVEMENT MARKINGS
- (O) TEMPORARY PAVEMENT REMOVAL
- (P) HMA SURFACE REMOVING

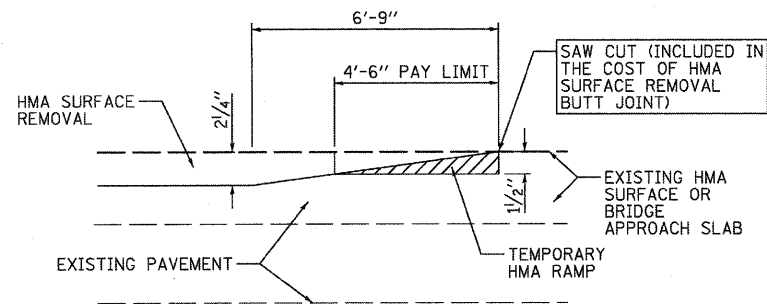

TYPICAL TEMPORARY RAMP

HMA CONSTRUCTED TEMPORARY RAMP (FOR BUTT JOINT AND HMA TAPER)

NOTES:

1. THE TEMP. RAMP SHALL BE CONSTRUCTED IMMEDIATELY UPON REMOVAL OF THE EXISTING HMA SURFACE.
2. THE BUTT JOINT SHALL BE CONSTRUCTED IMMEDIATELY PRIOR TO PLACING THE PROPOSED HMA COURSES.
3. TAPER THE TEMP. RAMP AT A RATE OF 3'-0" PER 1 INCH OF MILLING THICKNESS.
4. SEE ART. 406.08 AND 406.14 OF THE STANDARD SPECIFICATIONS FOR "HMA AND/OR PCC SURFACE REMOVAL, BUTT JOINT".

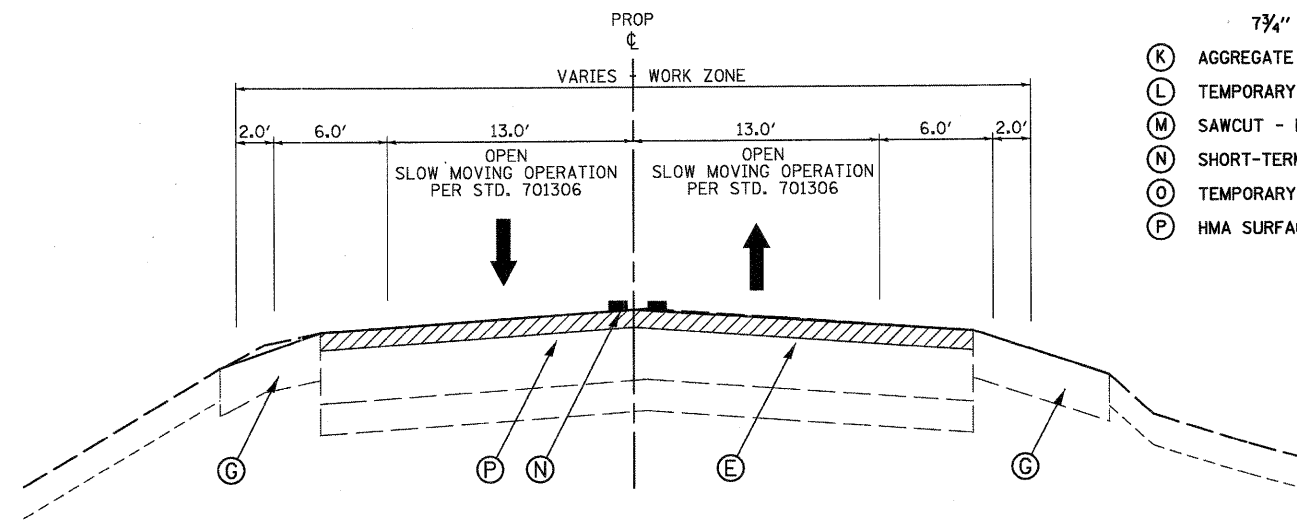

STAGE 3 - HMA TRANSITION

STA. 13+19.00 TO STA. 15+44.50
STA. 20+64.40 TO STA. 21+80.00

PAVEMENT MARKING NOTE:

ONLY TEMPORARY PAVEMENT MARKING TAPE WILL BE USED ON EXISTING PAVEMENT PAST THE PROPOSED PAVING LIMITS AND FINAL SURFACE COURSES.

FILE NAME = M:\Projects\2011\100804 - Bethel\gh\cadd\Civil\Drawings\STAGING\Typical.dwg

WILLS BURKE KELSEY ASSOCIATES LTD.
119 West Main Street, Suite 201
St. Charles, Illinois 60174
(630) 443-7755

USER NAME = #USER#	DESIGNED - DPB	REVISED -
PLOT SCALE =	DRAWN - RPD	REVISED -
PLOT DATE = 7/6/2011	CHECKED - SBP	REVISED -
	DATE - 7/8/11	REVISED -

**STATE OF ILLINOIS
DEPARTMENT OF TRANSPORTATION**

**MAINTENANCE OF TRAFFIC
TYPICAL SECTIONS**

SCALE: SHEET NO. 31 OF 88 SHEETS STA. TO STA.

F.A. RTE. 5355	SECTION 04-00167-00-BR	COUNTY DEKALB	TOTAL SHEETS 88	SHEET NO. 31
FED. ROAD DIST. NO. 3 [ILLINOIS] FED. AID PROJECT				