

LEGEND

- ◇ ROAD CLOSED AHEAD-W20-0301-48
- TYPE III BARRICADES, R-11-2-6030 (ROAD CLOSED) SIGNS, AND TYPE A LOW INTENSITY FLASHING LIGHTS
- 48" x 48" FLUORESCENT ORANGE
- ⊞ TYPE A LOW INTENSITY FLASHING LIGHT
- ⊞ BARRICADES
- ⊞ SIGNAGE
- BARRICADE OR DRUM WITH FLASHING LIGHT

NOTES

STOP SIGNS AND STREET SIGNS AT SIDEROADS SHALL BE ADJUSTED AND MAINTAINED WHETHER EXISTING SIGNS ARE UTILIZED, OR THEY ARE FURNISHED BY THE CONTRACTOR. SIGNS FURNISHED BY THE CONTRACTOR SHALL BE INCLUDED IN THE UNIT COST FOR TRAFFIC CONTROL.

SOUTH MAIN STREET SHALL BE FULLY OPEN TO TRAFFIC AT ALL TIMES.

STAGE II SHALL BE CONSTRUCTED UNDER TRAFFIC IN ACCORDANCE WITH STD. 701001, STD. 701006, STD. 701326, STD. 701801, STD. 701901, & BLR 17.

THE CONTRACTOR SHALL MAINTAIN DRAINAGE THROUGHOUT THE STAGE CONSTRUCTION.

SOUTH MAIN STREET RECONSTRUCTION PHASE 2

STAGE II - PARKING LANE, CURB AND GUTTER, AND SIDEWALK CONSTRUCTION (WEST SIDE)

1. SET UP TRAFFIC CONTROL FOR STAGE II.
2. REMOVE EXISTING PAVEMENT, CURB, SHOULDER, SIDEWALK, ETC.
3. CONSTRUCT PROPOSED CONDUIT CONNECTING TO EXISTING CONDUIT AT CENTER STREET AND TERMINATING AT SOUTH END OF PROJECT.
4. CONSTRUCT PROPOSED PARKING LANE, CONCRETE CURB AND GUTTER, SIDEWALK, AND TREE FRAME AND GRATES.
5. SET UP TRAFFIC CONTROL FOR STAGE III.

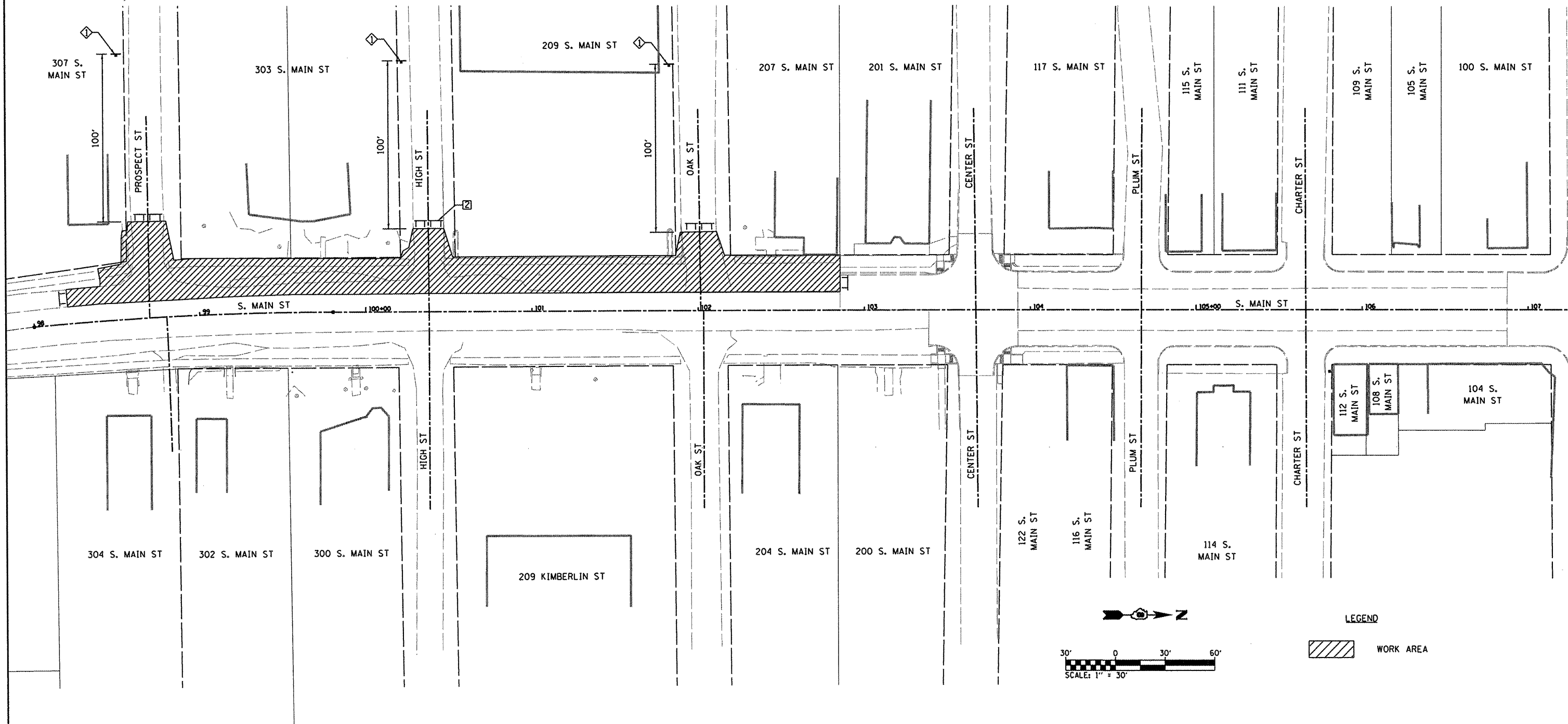

FILE NAME =	USER NAME = #USER#	DESIGNED - TLC	REVISED -	STATE OF ILLINOIS DEPARTMENT OF TRANSPORTATION	STAGING PLANS STAGE II HIGHWAY CONSTRUCTION		F.A.J. RTE. 9393	SECTION 10-00026-01-RS	COUNTY MADISON	TOTAL SHEETS 31	SHEET NO. 13
#FILE#	PLOT SCALE = #SCALE#	DRAWN - JTH	REVISED -		SCALE: 1"=30'	SHEET NO. 3 OF 7 SHEETS	S MAIN STREET RECONSTRUCTION PH 2		CONTRACT NO. 97474		
	PLOT DATE = #DATE#	CHECKED -	REVISED -				CITY OF TROY		ILLINOIS FED. AID PROJECT		
		DATE -	REVISED -								