

LEGEND

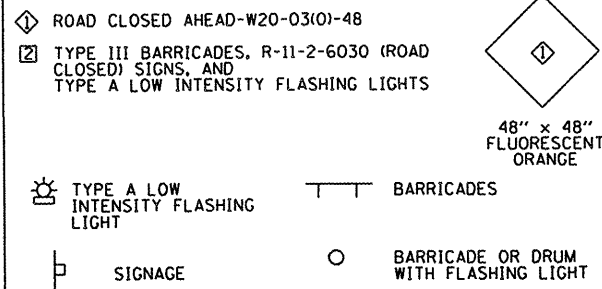

NOTES

STOP SIGNS AND STREET SIGNS AT SIDEROADS SHALL BE ADJUSTED AND MAINTAINED WHETHER EXISTING SIGNS ARE UTILIZED, OR THEY ARE FURNISHED BY THE CONTRACTOR. SIGNS FURNISHED BY THE CONTRACTOR SHALL BE INCLUDED IN THE UNIT COST FOR TRAFFIC CONTROL.

SOUTH MAIN STREET SHALL BE FULLY OPEN TO TRAFFIC AT ALL TIMES.

STAGE III SHALL BE CONSTRUCTED UNDER TRAFFIC IN ACCORDANCE WITH STD. 701001, STD. 701006, STD. 701326, STD. 701801, STD. 701901, & BLR 17.

THE CONTRACTOR SHALL MAINTAIN DRAINAGE THROUGHOUT THE STAGE CONSTRUCTION.

SOUTH MAIN STREET RECONSTRUCTION PHASE 2  
STAGE III - PARKING LANE, CURB AND GUTTER, AND SIDEWALK CONSTRUCTION (EAST SIDE)

1. SET UP TRAFFIC CONTROL FOR STAGE III.
2. REMOVE EXISTING PAVEMENT, CURB, SHOULDER, SIDEWALK, ETC.
3. CONSTRUCT PROPOSED CONDUIT CONNECTING TO EXISTING CONDUIT AT CENTER STREET AND TERMINATING AT SOUTH END OF PROJECT.
4. CONSTRUCT PROPOSED PARKING LANE, CONCRETE CURB AND GUTTER, SIDEWALK, TREE FRAME AND GRATES, ETC.
5. SET UP TRAFFIC CONTROL FOR STAGE IV.

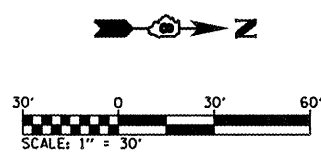
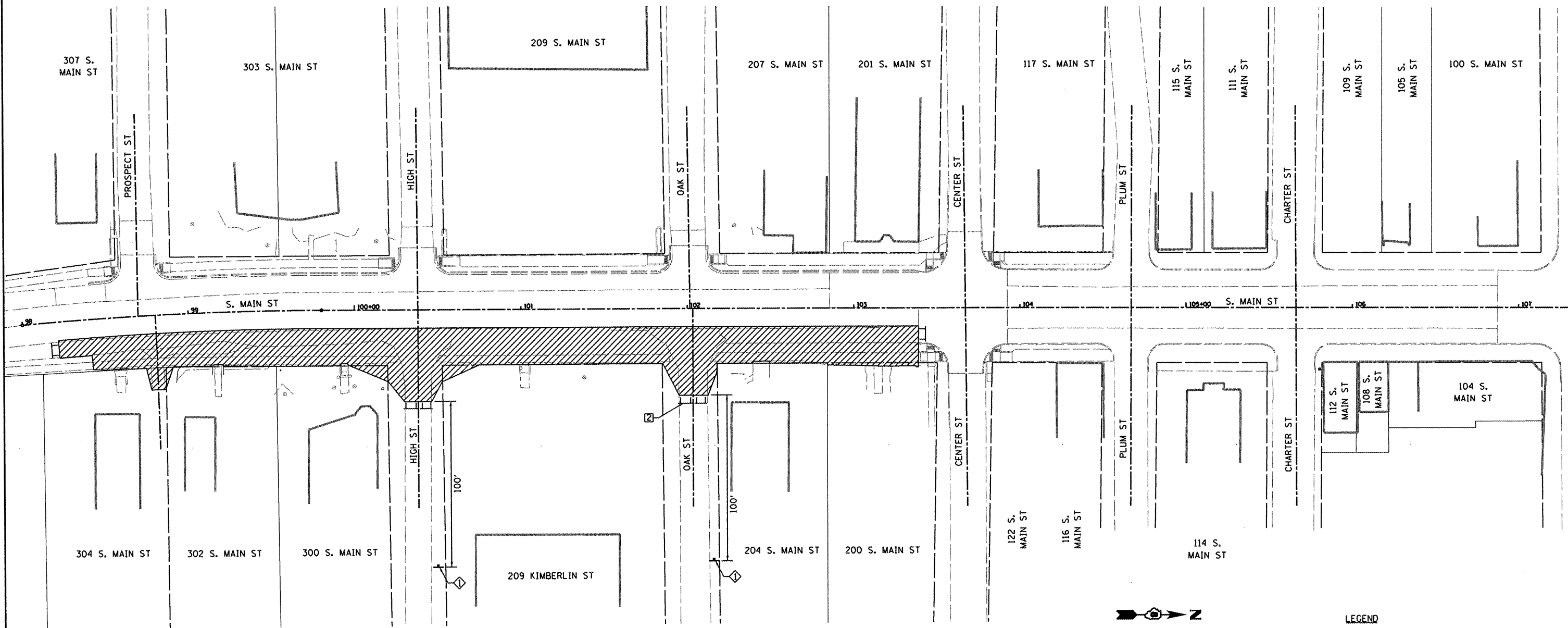

FILE NAME =	USER NAME = #USER#	DESIGNED - TLC	REVISED -	<b>STATE OF ILLINOIS DEPARTMENT OF TRANSPORTATION</b>	<b>STAGING PLANS STAGE III HIGHWAY CONSTRUCTION</b>	F.A.U. RTE. 9393	SECTION 10-00026-01-RS	COUNTY MADISON	TOTAL SHEETS 31	SHEET NO. 14	
#FILEL#	PLOT SCALE = #SCALE#	DRAWN - JTH	REVISED -			S MAIN STREET RECONSTRUCTION PH 2	CONTRACT NO. 97474				
	PLOT DATE = #DATE#	CHECKED -	REVISED -			CITY OF TROY	ILLINOIS FED. AID PROJECT				
		DATE -	REVISED -								