

**SOUTH MAIN STREET RECONSTRUCTION PHASE 2
STAGE VI - PAVEMENT MILLING, RESURFACING, AND MARKING**

1. SET UP TRAFFIC CONTROL FOR STAGE VI.
2. MILL SOUTH MAIN STREET FROM CENTER STREET TO ILLINOIS ROUTE 162 (MARKET STREET).
3. PERFORM PAVEMENT PATCHING.
4. APPLY HOT-MIX ASPHALT SURFACE COURSE ON SOUTH MAIN STREET.
5. APPLY FINAL PAVEMENT MARKINGS.
6. REMOVE ALL REMAINING TRAFFIC CONTROL.

NOTES

STOP SIGNS AND STREET SIGNS AT SIDEROADS SHALL BE ADJUSTED AND MAINTAINED WHETHER EXISTING SIGNS ARE UTILIZED, OR THEY ARE FURNISHED BY THE CONTRACTOR. SIGNS FURNISHED BY THE CONTRACTOR SHALL BE INCLUDED IN THE UNIT COST FOR TRAFFIC CONTROL.

SOUTH MAIN STREET SHALL BE FULLY OPEN TO TRAFFIC BY THE END OF EACH WORKING DAY.

THE CONTRACTOR WILL BE ALLOWED TO TEMPORARILY CLOSE ONE SIDE OF THE ROAD (TRAVEL AND PARKING LANE) AT A TIME FOR RESURFACING OPERATIONS.

STAGE VI SHALL BE CONSTRUCTED UNDER TRAFFIC IN ACCORDANCE WITH STD. 701201, STD. 701301, STD. 701306, STD. 701311, & STD. 701901.

THE CONTRACTOR SHALL MAINTAIN DRAINAGE THROUGHOUT THE STAGE CONSTRUCTION.

THE CONTRACTOR SHALL NOTIFY PROPERTY OWNERS 48 HOURS IN ADVANCE OF THE CLOSURE OF ANY TRAVEL OR PARKING LANES.

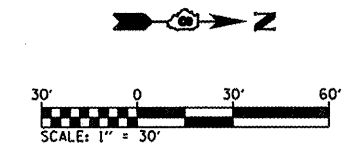
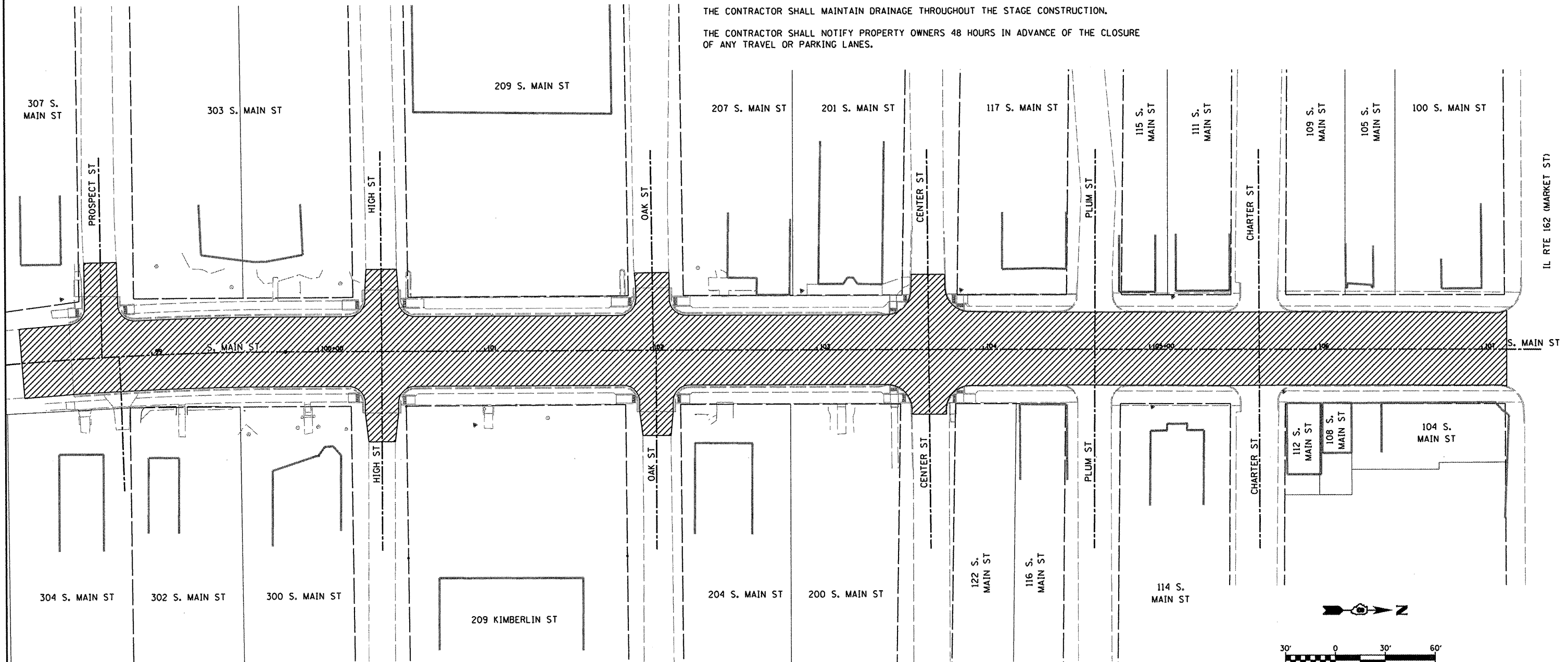

LEGEND
 WORK AREA

FILE NAME = #FILEL#	USER NAME = #USER#	DESIGNED - TLC	REVISED -	STATE OF ILLINOIS DEPARTMENT OF TRANSPORTATION	STAGING PLANS STAGE VI HIGHWAY CONSTRUCTION	F.A.U. RTE. 9393	SECTION 10-00026-01-RS	COUNTY MADISON	TOTAL SHEETS 31	SHEET NO. 17	
	PLOT SCALE = #SCALE#	DRAWN - JTH	REVISED -			S MAIN STREET RECONSTRUCTION PH 2	CONTRACT NO. 97474				
	CHECKED -	DATE -	REVISED -			CITY OF TROY	ILLINOIS FED. AID PROJECT				
	PLOT DATE = #DATE#										

SCALE: 1" = 30' SHEET NO. 7 OF 7 SHEETS