

F.A.I. RTE.	SECTION	COUNTY	TOTAL SHEET NO.
94/90		COOK	556
STA.	TO STA.		46
FED. ROAD DIST. NO.		ILLINOIS FED. AID PROJECT	
62300		1818, ETC, 2324.6-1PIR-8	

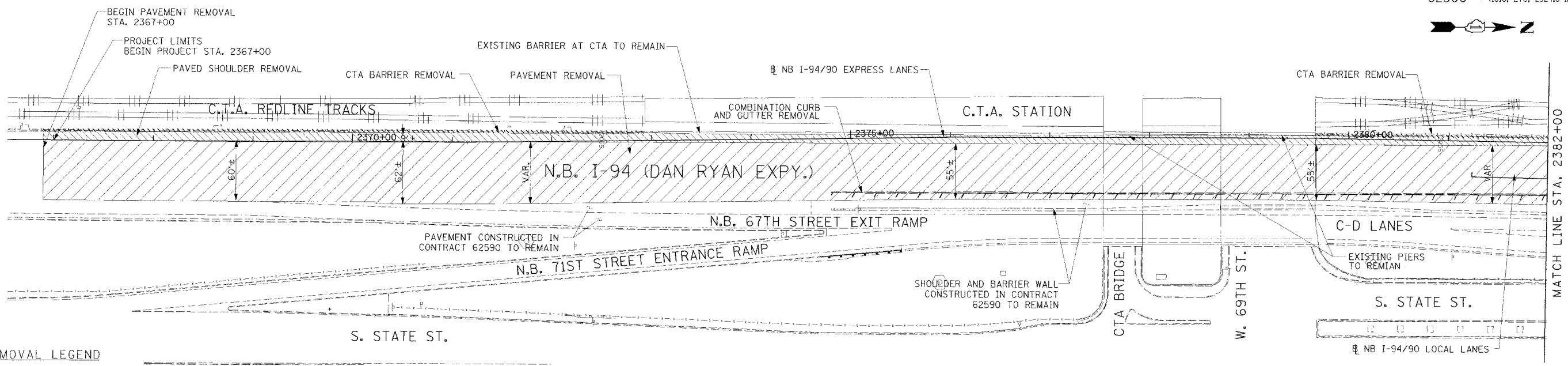

- REMOVAL LEGEND**
- PAVEMENT REMOVAL
 - PAVED SHOULDER REMOVAL
 - COMBINATION CURB AND GUTTER REMOVAL
 - CONCRETE BARRIER OR GUARD RAIL REMOVAL

NOTE:
1. THE LOCATION OF PAVEMENT CONSTRUCTED IN PREVIOUS CONTRACTS IS BASED OFF OF CONTRACT PLAN DRAWINGS. THE CONTRACTOR MUST VERIFY LIMITS OF PREVIOUS CONSTRUCTION IN THE FIELD.

EXISTING CONDITIONS & REMOVALS

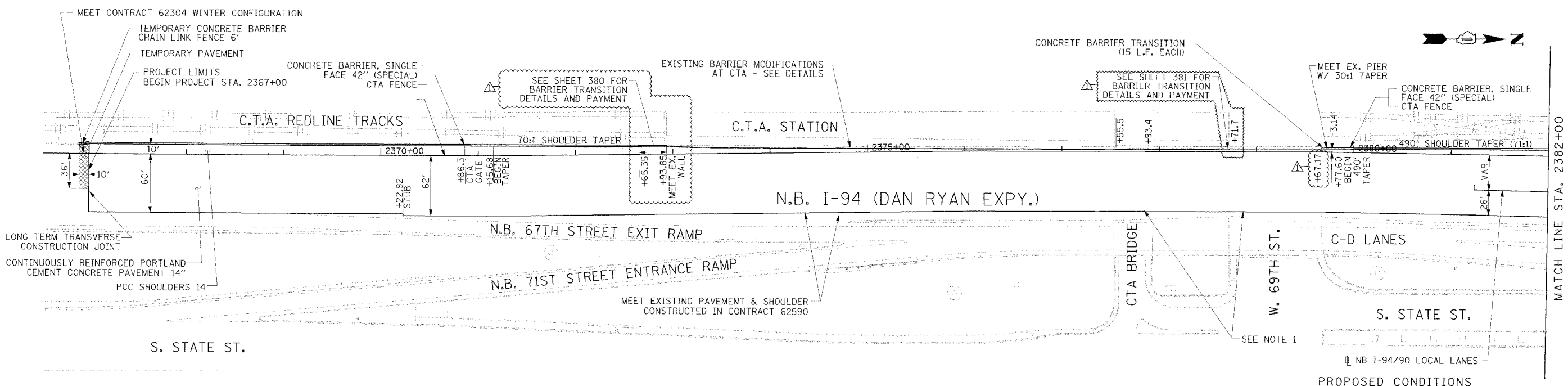

LONG TERM TRANSVERSE CONSTRUCTION JOINT
CONTINUOUSLY REINFORCED PORTLAND CEMENT CONCRETE PAVEMENT 14"
PCC SHOULDERS 14"

STATIONING
+***.## STATION PROVIDED FROM THE NB I-90/94 EXPRESS LANES
(+***.##) STATION PROVIDED FROM THE NB I-90/94 LOCAL LANES
[+***.##] STATION PROVIDED FROM THE SLIP RAMP

- LEGEND**
- TEMPORARY PAVEMENT (INTERSTATE)/TEMPORARY SHOULDER
 - TEMPORARY CONCRETE BARRIER

REVISIONS

NAME	DATE
ADDENDUM 1	8/12/05

ILLINOIS DEPARTMENT OF TRANSPORTATION
F.A.I. 94/90 (DAN RYAN EXPRESSWAY)
31ST STREET TO 71ST STREET
NB EXPRESS LANE RECONSTRUCTION
EXISTING AND PROPOSED PLAN
NORTHBOUND STA. 2367+00 TO STA. 2382+00
SCALE: 1"=50'
DATE: 7/7/05
DRAWN BY: TAI
CHECKED BY: PJM

NOTE:
1. BRIDGE OVER EXPRESS LANES OMITTED FOR CLARITY.



ONE NORTH FRANKLIN
CHICAGO, IL 60606
PHONE: (312) 251-3000
FAX: (312) 251-3005
WEB: WWW.EKCORP.COM

P:\0300\940305\940305.dwg 148015\cad\94\940305.dwg 08/09/2005 04:43 PM