

F.A.I.	SECTION	COUNTY	TOTAL SHEETS	SHEET NO.
94/90		COOK	556	97
STA. 2602+00 TO STA. 2626+00				
FED. ROAD DIST. NO. ILLINOIS		FED. AID PROJECT		
62300		11818, ETC, 2324.6-IPJR-8		

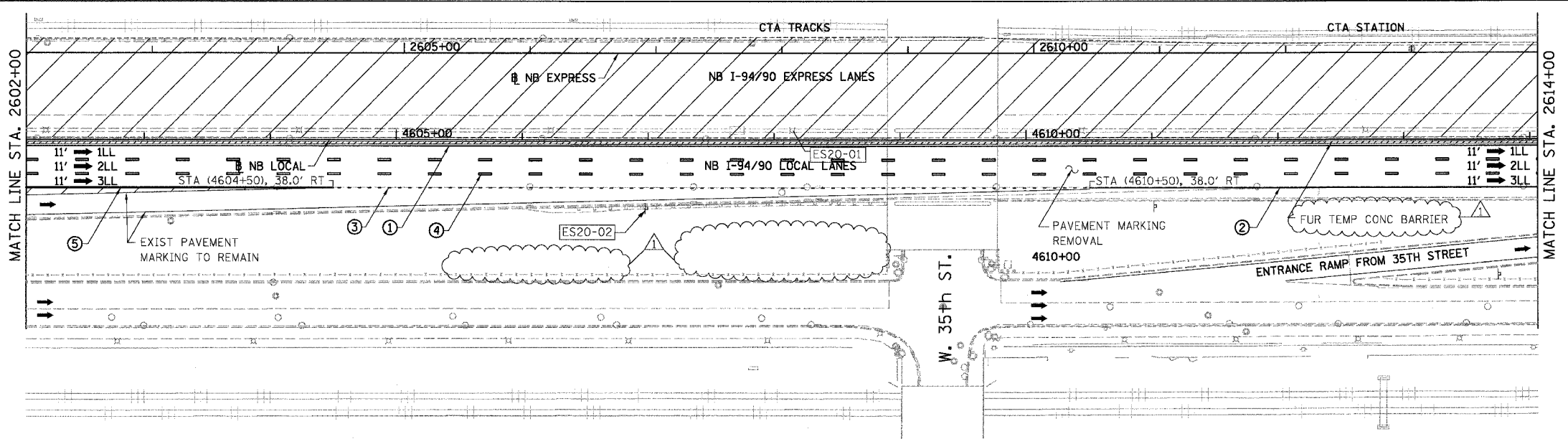

- LEGEND**
- WORK ZONE
 - TEMPORARY PAVEMENT
 - 1LL TRAFFIC LANE & DIRECTION OF TRAFFIC
 - DRUM OR BARRICADE TYPE II WITH STEADY BURN LIGHT
 - IMPACT ATTENUATORS, TEMPORARY (NON-REDIRECTIVE), TEST LEVEL 3
 - BARRICADE TYPE III
 - TEMPORARY CONCRETE BARRIER
 - ① LINE 4" (YELLOW EDGE LINE)
 - ② LINE 4" (WHITE EDGE LINE)
 - ③ LINE 4" (SKIP DASH, 6' SKIP - 2' DASH, WHITE)
 - ④ LINE 5" (SKIP DASH, 30' SKIP - 10' DASH, WHITE)
 - ⑤ LINE 8" (WHITE GORE LINE)
 - ⑥ LINE 8" (SKIP DASH, 12' SKIP - 3' DASH, WHITE)
 - ⑦ LINE 12" (DIAGONAL, 30' C-C)
 - ⑧ LINE 12" (DIAGONAL, 500' C-C)
 - ⑨ LETTERS AND SYMBOLS
 - ESX-XX EXISTING SIGNS
 - TSX-XX TEMPORARY SIGNS

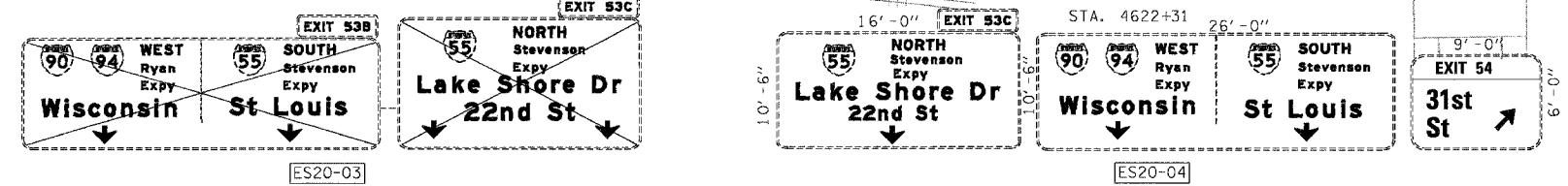
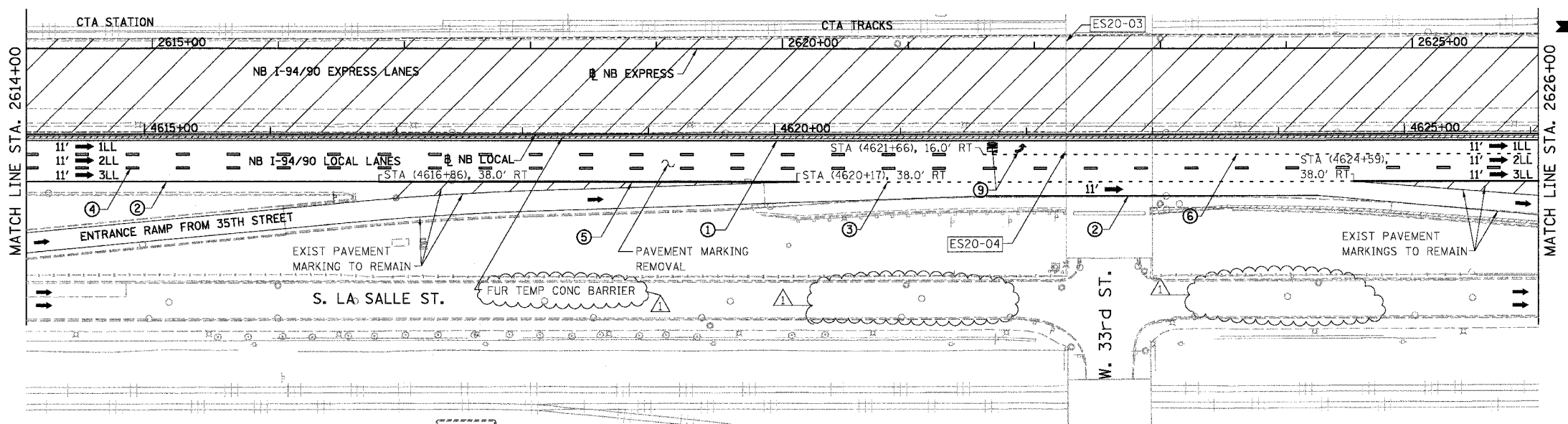

NOTE:
ALL PAVEMENT MARKINGS ON THIS SHEET WILL BE PAVEMENT MARKING TAPE, TYPE III, UNLESS OTHERWISE NOTED.

BOWMAN, BARRETT & ASSOCIATES INC.
CONSULTING ENGINEERS
Chicago, Illinois
312.228.0100
www.bbainc.com

EXISTING SIGN TO REMAIN UNDER THIS CONTRACT.
CONTRACT 62300 NEEDS TO COORDINATE WITH
CONTRACT 62580 MAINTENANCE OF TRAFFIC

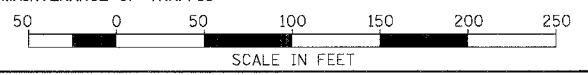

STATIONING
+**.** STATION PROVIDED FROM THE I-90/94 EXPRESS LANES
(+**.** STATION PROVIDED FROM THE I-90/94 LOCAL LANES
[+**.** STATION PROVIDED FROM THE SLIP RAMP

REVISIONS	
NAME	DATE
ADDENDUM 1	8/12/05

ILLINOIS DEPARTMENT OF TRANSPORTATION
F.A.I. 94/90 (DAN RYAN EXPRESSWAY)
31ST STREET TO 71ST STREET
NB EXPRESS LANE RECONSTRUCTION
MAINTENANCE OF TRAFFIC PLAN STAGE 1
NORTHBOUND STA. 2602+00 TO STA. 2626+00
SCALE: 1"=50'
DATE: 07/07/05
DRAWN BY: RA
CHECKED BY: RS

8/10/2005 3:29:50 PM