

SCHEDULE OF DRAINAGE STRUCTURES

F.A.I. RTE.	SECTION	COUNTY	TOTAL SHEETS	SHEET NO.
94/90	*	COOK	556	132
STA.		TO STA.		
FED. ROAD DIST. NO.		ILLINOIS	FED. AID PROJECT	
62300		* (1818, ETC, 2324.6-IPR-8		

STR. #	STATION	OFFSET	RIM ELEVATION	CB, TA, 4D, TIF OL	CB, TA, 4D, T8G	CB, TA, 4D, T20 F&G	CB, TA, 5D, T20 F&G	MH, TA, 4D, TIF CL	MH, TA, 5D, TIF CL	MH, TA, 6D, TIF CL	DR STR T1 W/2 T20 F&G	DR STR T2 W/2 T22 F&G	INLET, TYPE B, T 20 F&G	MH, DROP 6D, TIF CL	INVERT ELEVATION	TEMP SOIL RET. SYSTEM (SQ. FT)
24-08	2505+54.00	39.00	-0.9	1											-6.73N,	
24-09	2503+55.00	-8.00	-2.44										1		-8.27N,	162
24-10	2503+70.00	-7.00	-2.45												-8.58N, -8.33S, -8.09E,	162
24-11	2503+85.00	-8.00	-2.44			1									-8.74N, -8.64S,	162
24-12	2504+36.00	-7.00	-2.31			1									-9.08N, -8.98S,	
24-13	2504+31.00	58.00	-2.27						1						-9.91N, -9.41S, -9.10E,	
24-14	2506+46.00	40.00	0.45	1											7.71N, -7.61S,	
24-15	2504+86.00	58.00	-1.96						1						-10.87N, -10.77S, -8.49NE,	
24-16	2504+91.00	61.00	-1.86			1									-8.31E, -8.41SW,	
24-17	2506+50.00	62.00	0.24						1						-10.54S, -10.44W, -6.61NE,	
24-18	2506+51.00	40.00	0.45						1						-10.31N, -7.72S, -5.98W, -10.41E,	
24-19	2506+64.00	63.00	0.24			1									-6.37E, -6.47SW,	
24-20	2506+53.00	-7.00	0.08			1									-5.76E,	162
24-21	2507+51.00	40.00	1.99						1						9.46N, -10.14S, -5.71E,	
25-01	2508+37.00	41.00	3.27						1						-2.62N, -9.37S, -4.30E, -2.77NW,	
25-02	2508+37.00	66.00	2.91			1									-3.93E, -4.18W,	
25-03	2508+64.00	-7.00	3.33			1									-2.51SE,	162
25-04	411+14.00	19.00	5.64			1									-0.19NW,	
25-05	411+51.00	19.00	6.17					1							-0.4E, -0.85W,	
25-06	2510+46.00	43.00	6.44						1						-7.5N, -7.6W, 0.23E, 0.41NW, -0.97SE,	
25-07	2510+75.00	-7.00	6.58			1									0.75SE,	162
25-08	2511+82.00	45.00	8.09						1						-6.33N, -7.8S, 1.81E,	
25-09	412+85.00	19.00	7.96			1									1.91W,	
25-10	2512+84.00	46.00	8.98						1						2.69N, -5.89S, 2.7W, 0.13E,	
25-11	2512+86.00	-7.00	8.84			1									3.01E,	162
25-12	414+10.00	19.50	9.02					1							2.28N, 0.52E, 0.27SW,	
25-13	2508+43.00	42.00	3.23	1											-2.6S,	
25-14	414+59.00	19.00	9.27			1									2.7N, 2.6S,	
25-15	2510+43.00	43.00	6.42	1											0.59N,	
25-16	2512+89.00	45.00	9.02	1											2.8N, 2.7S,	
25-17	2513+89.00	46.00	9.59	1												
26-01	416+75.00	20.00	9.59			1									3.76S,	
26-02	418+68.00	24.00	8.68			1									2.63NE, 2.53SW,	
26-03	418+60.00	-6.00	8.45			1									2.20SW, 2.30NE,	
26-04	2517+86.00	44.00	9.02			1									3.19SW,	
26-05	2517+53.00	39.00	9.5						1						-4.14W, 2.25E, 2.15NE,	
26-06	2517+86.00	-7.00	8.82			1									-0.98S,	162
26-07	420+75.00	-7.00	6.23			1									0.4N,	
26-08	2519+97.00	-7.00	6.55			1									0.72NE,	162
27-01	421+43.00	19.00	5.82	1											-0.31E, -0.41SW,	
27-02	2520+14.00	44.00	6.51			1									0.2S, -0.87W, -0.62NE,	
27-03	2520+14.00	39.00	6.75						1						-4.14N, -0.9E, 0.41SW,	
27-04	422+90.00	-7.00	2.53			1									-3.30NW,	
27-05	2522+19.00	44.00	2.94			1										
27-06	2522+11.00	39.00	3.37						1						-3.45S, -3.55SW,	
27-07	2522+08.00	-7.00	3.24			1									-5.5N, -5S, -2.82W, -3.65NE,	
27-08	2522+86.00	40.00	2.19						1						-2.59E,	162
27-09	423+79.00	-5.00	1.51	1											-5.73S, -5.83W, -5.21SE,	
27-10	423+84.00	-7.00	1.3			1									-5.0NW,	
27-11	NOT USED														-4.27E, -5.11NW, -5.01SE,	
27-12	2523+27.00	-7.00	1.3			1									-4.53S,	162
27-13	425+29.00	-7.00	-1.45	1											-8.02E, -8.12NW,	
27-14	2524+37.00	44.00	-1.91			1									-8.38NW, -8.28SE,	
27-15	2524+40.00	39.00	-1.74						1						-13.06N, -8.48SE,	
27-16	2525+75.00	-5.00	-2.51			1									-8.34E,	162
27-17	2525+77.00	39.00	-4.71						1						-13.42N, -13.32S, -11.89E, -10.78W,	
28-01	2526+32.00	44.00	-5.76			1									-14.01E, -14.11NW,	
28-02	2526+32.00	39.50	-5.43						1						-17.37N, -13.52S, -14.15E,	
28-03	2527+36.00	41.00	-6.3						1						-17.71N, -17.5S,	
28-04	2527+79.00	45.00	-6.65										1		-16.04N, -16.14SW,	
28-05	2527+94.00	44.00	-6.66			1									-15.83N, -15.93S,	
28-06	2528+09.00	45.00	-6.65			1									-12.63N, -15.61S, -15.36E,	
28-07	2527+95.00	39.00	-6.3						1						-12.51N, -17.79S, -13.01E, -17.99SW,	
28-08	2527+79.00	-5.00	-4.1			1									-10.58N, -10.68S,	
28-09	2527+94.00	-4.00	-4.11			1									-10.28N, -10.53S,	162
28-10	2528+09.00	-5.00	-4.1			1									-10.12N, -10.22S,	162
28-11	2528+47.00	-10.00	-4.12			1									-9.95S,	
28-12	2528+61.00	46.00	-6.62			1									-12.45S,	
28-13	2529+50.00	-11.00	-3.44			1									-9.44E,	162
28-14	2529+70.00	44.00	-5.65			1									-11.48W,	
28-15	2529+68.00	38.00	-5.39					1							-11.68S, -11.39W, -11.58E,	

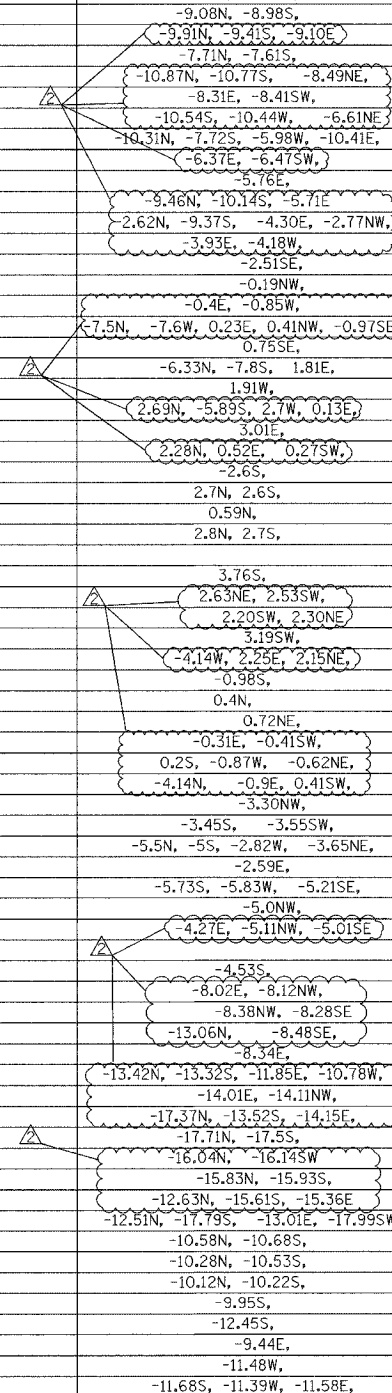

STR. #	STATION	OFFSET	RIM ELEVATION	CB, TA, 4D, T20 F&G	MH, TA, 4D, TIF CL	INVERT ELEVATION
16-07	2454+78.00	50.00	0.57		1	-6.42S, -6.29E
18-08	2471+06.00	57.00	0.47	1		-5.98N, -5.88E,
20-13	2481+33.00	57.00	5.35	1		-1.56N, -1.46E,
21-07	2489+78.00	57.00	10.15	1		3.64N, 3.74E
24-22	2507+50.00	63.00	1.45		1	-5.51E, -5.41SE

REVISIONS	NAME	DATE
ADDENDUM 2		9/16/05

ILLINOIS DEPARTMENT OF TRANSPORTATION
 F.A.I. 94/90 (DAN RYAN EXPRESSWAY)
 31ST STREET TO 71ST STREET
 NB EXPRESS LANE RECONSTRUCTION
 DRAINAGE SCHEDULE
 PROPOSED DRAINAGE STRUCTURES
 SCALE: 1" = N.T.S.
 DATE: 7/7/05
 DRAWN BY: MJO
 CHECKED BY: LPN



08/14/2005 02:49:23 PM