

|                                |              |                |                     |                   |
|--------------------------------|--------------|----------------|---------------------|-------------------|
| F.A.I. RTE.<br>90/94           | SECTION<br>* | COUNTY<br>COOK | TOTAL SHEETS<br>556 | SHEET NO.<br>384M |
| STA.                           |              | TO STA.        |                     |                   |
| FED. ROAD DIST. NO. 1 ILLINOIS |              |                |                     | FED. AID PROJECT  |
| • (1818, ETC, 2324.6-1PR-8     |              |                |                     | 62300             |

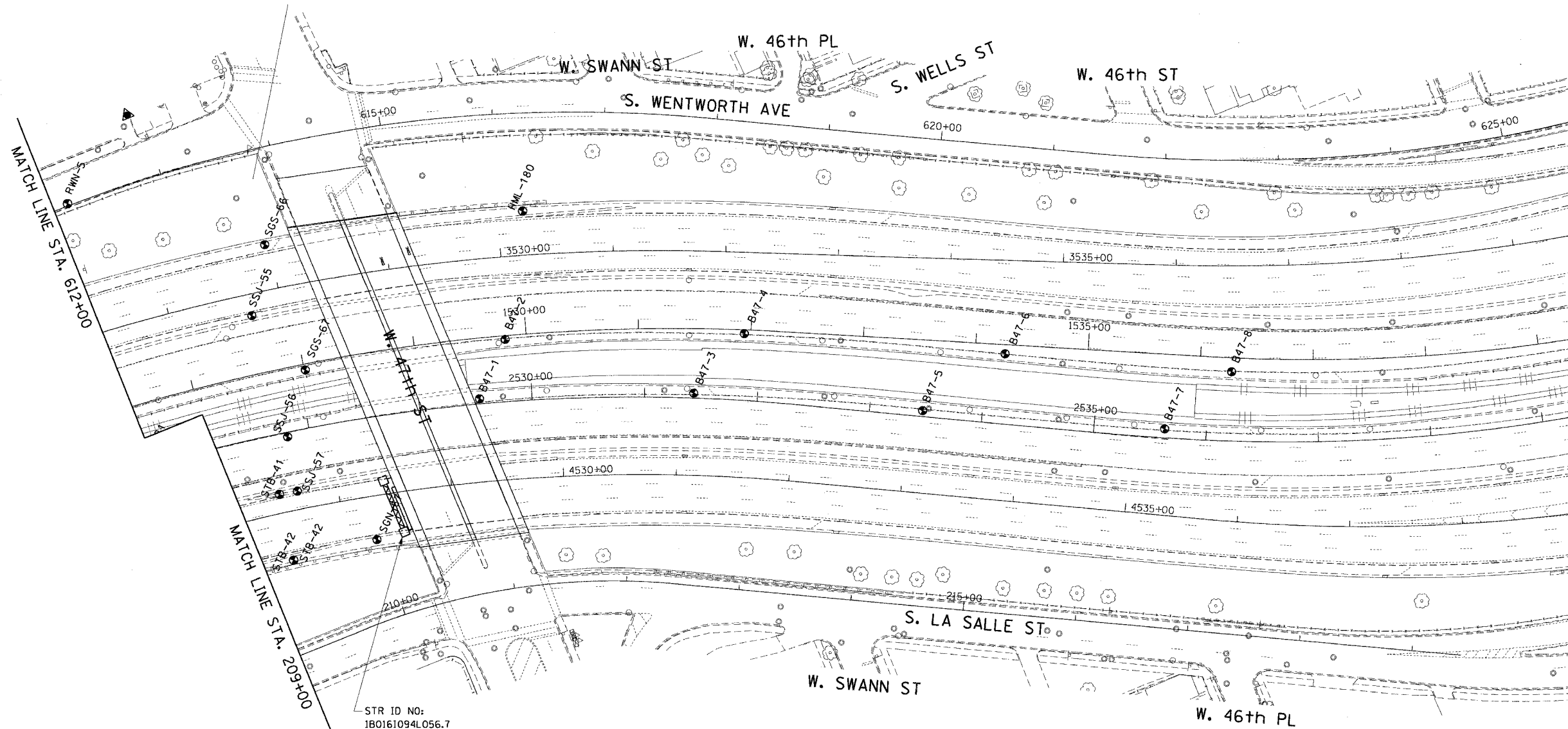

STR ID NO:  
1B0161094L056.7

LEGEND FOR BORINGS

- PROPOSED SIGN STRUCTURE
- HIGH MAST LIGHT POLE
- HML : HIGH MAST LIGHT POLE
- REO : RETAINING WALL, EAST SIDE, WALL-O
- REW : RETAINING WALL, EAST SIDE, WALL-W
- RWC : RETAINING WALL, WEST SIDE, WALL-C
- RWL : RETAINING WALL, WEST SIDE, WALL-L
- SIA : RETAINING WALL, INTERCHANGE, WALL 1A
- SSN : STORM SEWER, NORTHBOUND
- SSS : STORM SEWER, SOUTHBOUND
- SSJ : STORM SEWER, JACKING
- STB : SIGN STRUCTURE
- SSB : BRIDGE
- SEW.SWW : BRIDGE
- SGN : SUBGRADE, NORTHBOUND
- SGS : SUBGRADE, SOUTHBOUND
- BRN : 47th ST. RAMP
- C : CORING

ADDED SHEET

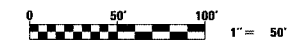

| REVISIONS   |         |
|-------------|---------|
| NAME        | DATE    |
| ADDENDUM #2 | 9-16-05 |
|             |         |
|             |         |
|             |         |
|             |         |
|             |         |
|             |         |
|             |         |

ILLINOIS DEPARTMENT OF TRANSPORTATION  
F.A.I. 90/94 (DAN RYAN EXPRESSWAY)  
71ST STREET TO 31ST STREET (NB EXPRESS LANES)

SOIL BORING LOCATIONS

SCALE: 1"=50'  
DATE: September 16, 2005  
DRAWN BY: PHP  
CHECKED BY: JAL

9/16/05 9:44:05 AM