

F.A.I. RTE.	SECTION	COUNTY	TOTAL SHEETS	SHEET NO.
90/94		COOK	556	384G
STA.	TO STA.		FED. AID PROJECT	
			• (181B, ETC, 2324.6-1P/R-8	
			62300	

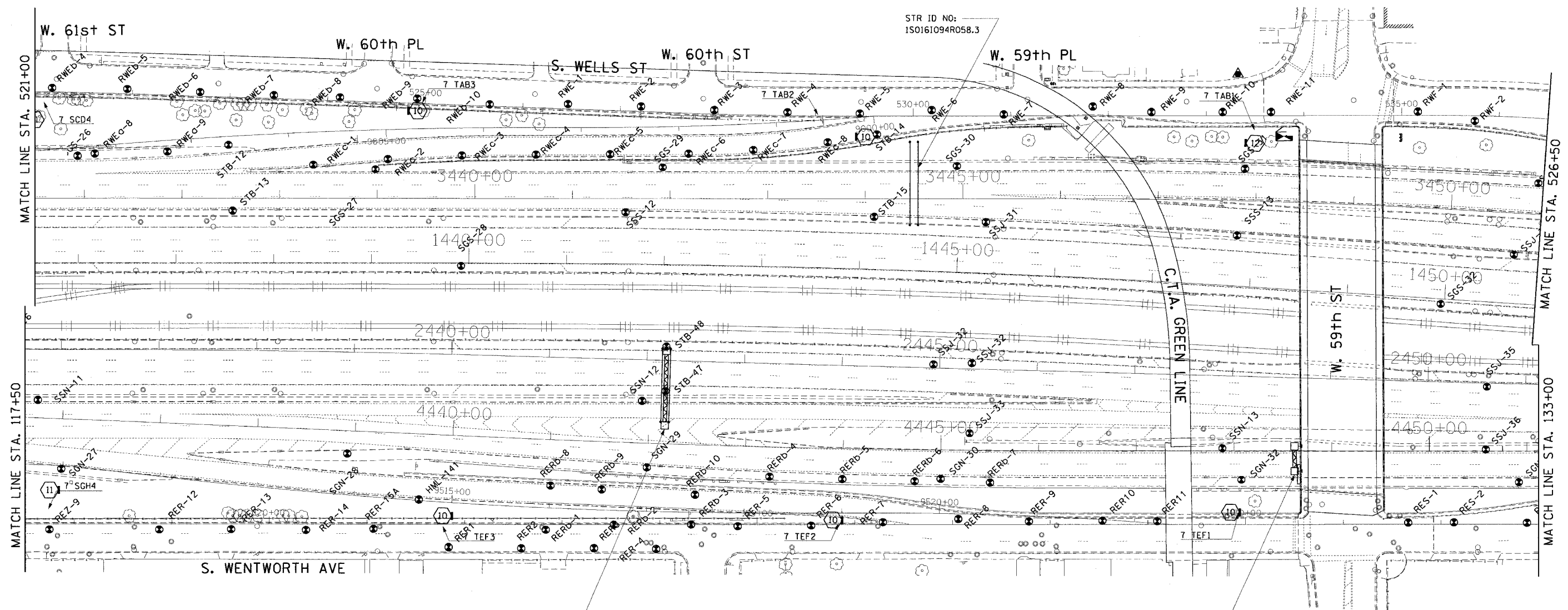
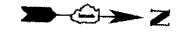

STR ID NO:  
150161094L058.4

**LEGEND FOR BORINGS**

- ===== PROPOSED SIGN STRUCTURE
- (H) HIGH MAST LIGHT POLE
- HML : HIGH MAST LIGHT POLE
- REO : RETAINING WALL, EAST SIDE, WALL-O
- REW : RETAINING WALL, EAST SIDE, WALL-W
- RWC : RETAINING WALL, WEST SIDE, WALL-C
- RWL : RETAINING WALL, WEST SIDE, WALL-L
- SIA : RETAINING WALL, INTERCHANGE, WALL IA
- SSN : STORM SEWER, NORTHBOUND
- SSJ : STORM SEWER, JACKING
- STB : SIGN STRUCTURE
- SSB : BRIDGE
- SEW,SWW : BRIDGE
- SGN : SUBGRADE, NORTHBOUND
- SGS : SUBGRADE, SOUTHBOUND
- BRN : 47th ST. RAMP
- C : CORING

STR ID NO:  
1B0161094L058.2

▲ ADDED SHEET



REVISIONS	
NAME	DATE
ADDENDUM #2	9-16-05

ILLINOIS DEPARTMENT OF TRANSPORTATION  
F.A.I. 90/94 (DAN RYAN EXPRESSWAY)  
71ST STREET TO 31ST STREET (NB EXPRESS LANES)

**SOIL BORING LOCATIONS**

SCALE: 1"=50'  
DATE: September 16, 2005  
DRAWN BY: PHP  
CHECKED BY: JAL

9/18/2005 9:30:44 AM