

F.A.I. RTE.	SECTION	COUNTY	TOTAL SHEETS	SHEET NO.
94/90		COOK	598	107
STA.	TO STA.			
62302	1818, ETC, 2324.6-1P/R-9			

- LEGEND**
- WORK ZONE
 - TEMPORARY PAVEMENT
 - TRAFFIC LANE & DIRECTION OF TRAFFIC
 - DRUM OR BARRICADE TYPE II WITH STEADY BURN LIGHT
 - IMPACT ATTENUATORS, TEMPORARY (NON-REDIRECTIVE), TEST LEVEL 3
 - BARRICADE TYPE III
 - TEMPORARY CONCRETE BARRIER
 - EXISTING SIGN
 - TEMPORARY SIGN
- 1 LINE 4" (YELLOW EDGE LINE)
 - 2 LINE 4" (WHITE EDGE LINE)
 - 3 LINE 4" (SKIP DASH, 6' SKIP - 2" DASH, WHITE)
 - 4 LINE 5" (SKIP DASH, 30' SKIP - 10" DASH, WHITE)
 - 5 LINE 8" (WHITE GORE LINE)
 - 6 LINE 8" (SKIP DASH, 12' SKIP - 3' DASH, WHITE)
 - 7 LINE 12" (DIAGONAL, 30' C-C)
 - 8 LINE 12" (DIAGONAL, 500' C-C)
 - 9 LETTERS AND SYMBOLS

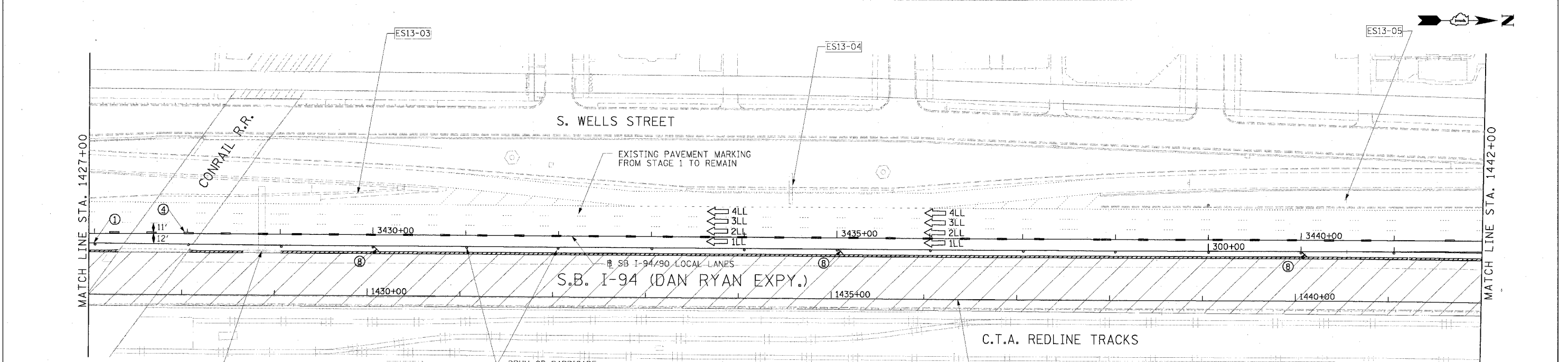
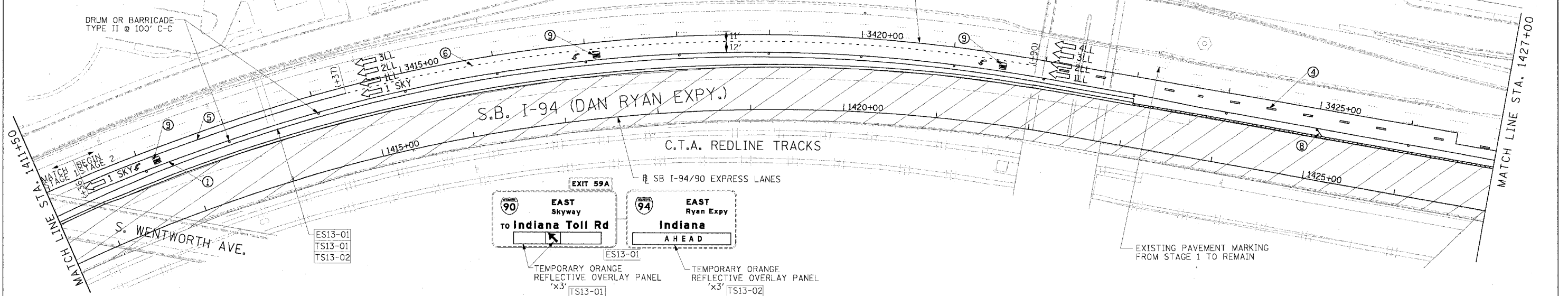

Edwards AND Kelcey

ONE NORTH FRANKLIN
CHICAGO, IL 60606
PHONE: (312) 251-3000
FAX: (312) 251-3015
WEB: WWW.EKCORP.COM

EXIT 59A
EAST Skyway
to Indiana Toll Rd
LEFT 2 LANES

EXIT 58B
EAST Ryan Expy
Indiana
RIGHT 2 LANES

EXIT 58B
63rd St

TEMPORARY ORANGE REFLECTIVE OVERLAY PANEL 'X3' TS13-03

EXISTING ORANGE REFLECTIVE OVERLAY PANEL FROM CONTRACT 62589

STATIONING

+** STATION PROVIDED FROM THE I-90/94 EXPRESS LANES

(+***) STATION PROVIDED FROM THE I-90/94 LOCAL LANES

NOTE:
ALL PAVEMENT MARKINGS ON THIS SHEET ARE PAVEMENT MARKING TAPE, TYPE III UNLESS OTHERWISE NOTED.

REVISIONS	
NAME	DATE

ILLINOIS DEPARTMENT OF TRANSPORTATION
F.A.I. 94/90 (DAN RYAN EXPRESSWAY)
31ST STREET TO 71ST STREET
SB EXPRESS LANE RECONSTRUCTION
MAINTENANCE OF TRAFFIC PLAN
SOUTHBOUND STA. 1411+50 TO STA. 1442+00
STAGE 2

SCALE: 1"=50'
DATE: 7/1/05

DRAWN BY: TAI
CHECKED BY: PJM