

F.A.I. RTE.	SECTION	COUNTY	TOTAL SHEETS	SHEET NO.
94/90	COOK	COOK	598	113

STA. TO STA. TO STA. TO STA.

FED. ROAD DIST. NO. 1 ILLINOIS FED. AID PROJECT

62302 \*11818, ETC, 2324.6-1P1R-9

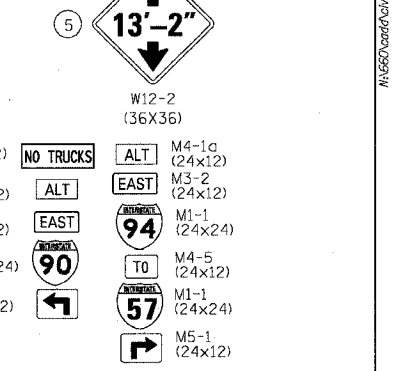

**SCHEDULE**

NO.	TYPE	SIZE (FT)	AREA (SQ. FT.)
39	M4-1a	2 x 1	78
37	M3-2	2 x 1	74
3	M3-4	2 x 1	6
78	M1-1	2 x 2	312
17	M6-1	2 x 1	34
2	M6-2	2 x 1	2
21	M6-3	2 x 1	42
2	M5-1	2 x 1	4
2	M4-5	2 x 1	4
12	W12-2	3 x 3	108

TOTAL = 664 SQ. FT.  
SIGN PANEL ASSEMBLY - TYPE 2  
WOOD SIGN SUPPORT - (942 FT)

**LEGEND:**

- ALTERNATE ROUTE
- ALTERNATE ROUTE SIGN
- DIRECTION OF TRAFFIC
- EXISTING SIGN

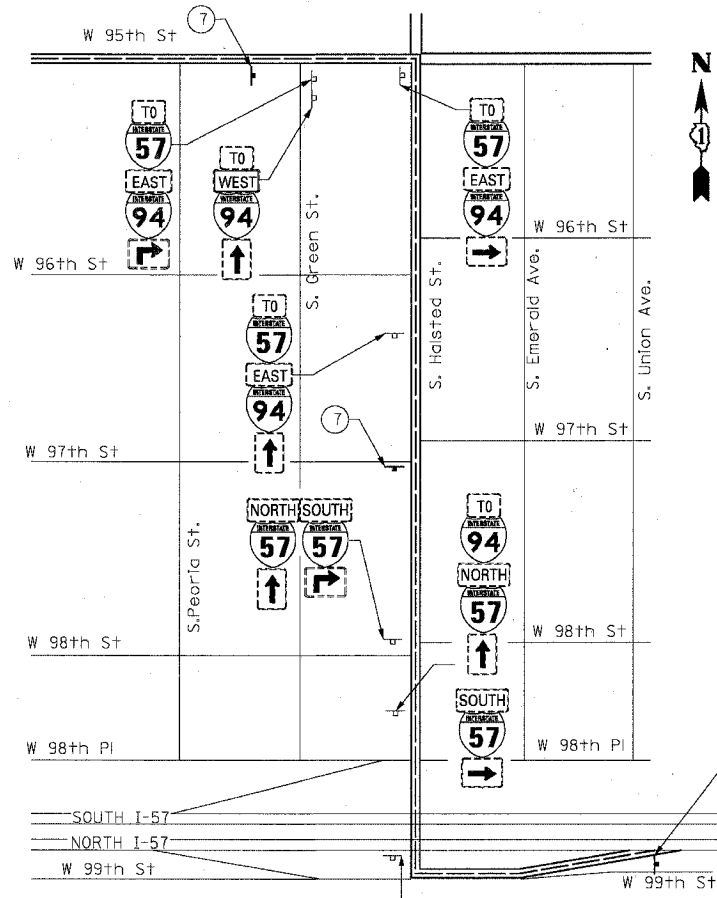
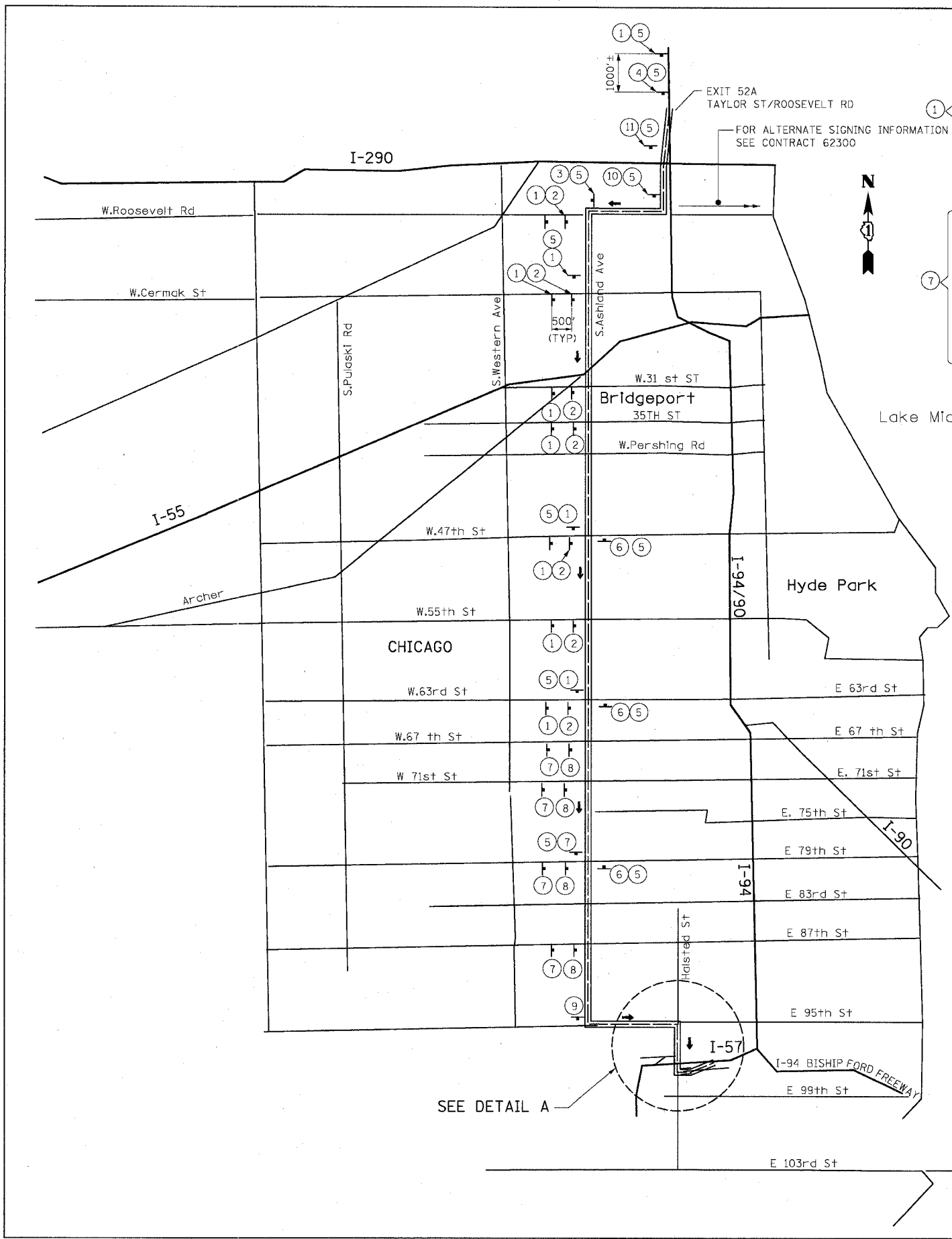

**DETAIL A**

REVISIONS	
NAME	DATE

ILLINOIS DEPARTMENT OF TRANSPORTATION  
F.A.I. 94/90 (DAN RYAN EXPRESSWAY)  
31ST STREET TO 71ST STREET  
SB EXPRESS LANE RECONSTRUCTION  
ALTERNATE ROUTE PLAN

SCALE: NTS  
DATE: 07/07/05

DRAWN BY: RV  
CHECKED BY: AS

**K&E** KAM ENGINEERING, INC.  
CONSULTING ENGINEERS  
701A Davis Road, Suite 205  
Eglin, Illinois 6023-1369

MOT-28

6/29/2005 2:55:04 PM